



C/S/B
(90.7) x

- Cycle shelters
- Entrance canopies and walkways
- Motorcycle shelters
- Smoking/waiting shelters
- Street furniture
- Umbrella systems

tough, practical,
cost-effective solutions



Apex Shelter Systems Ltd

Apex House
Unit 3
26a Hart Street
Southport
Merseyside
PR8 6BT
T: 01704 546522
F: 01704 517437
E: sales@apexshelters.co.uk
www.apexshelters.co.uk

May 2008 rev. 1

CONTENTS

Introduction	4
Colour Charts	5
Cycle And Motorcycle Shelters	6-12
Alpha P Cycle and Motorcycle Shelter	6
Alpha T Cycles and Motorcycles Shelter	7
Theta P Cycle and Motorcycle Shelter	8
Theta T Cycle and Motorcycle Shelter	9
Beta Cycle and Motorcycle Shelter	10
Delta Cycle and Motorcycle Shelter	11
Gamma Cycle and Motorcycle Shelter	12
Custom Designed Projects	13
Cycle and Motorcycle Compounds	14-20
Alpha Cycle and Motorcycle Compound	14
Theta Cycle and Motorcycle Compound	15
Opposing Alpha Cycle and Motorcycle Compounds	16
Opposing Theta Cycle and Motorcycle Compounds	17
Alpha Gamma Combination Compound	18
Theta Delta Combination Compound	19
Gamma Compound	20
Cages	20-21
Lambda Cycle Cage	21
Omega Cycle Cage	22
Cycle Lockers	23
Sigma Horizontal Cycle Locker	23
Sigma Semi-Vertical Cycle Locker	23
Racks and Stands	24-27

CONTENTS

Integral Double Entry Cycle Rack	24
Integral Cycle Rack (IR)	25
Integral Junior Cycle Rack (IR-JNR)	25
Floor Mounted Double Sided Cycle Rack (R)	26
Floor Mounted Double Sided Junior Cycle Rack (R-jnr)	26
Nu Range of Cycle Racks	27
NU Junior Sheffield Cycle Stand	27
NU Scooter Stand	27
Large Umbrellas	28
Zeta Umbrellas	28
Waiting, Smoking and Pedestrian Shelters	30-32
General Shelter	30
Theta Smoking Shelter	31
Pedestrian Waiting Shelters and Sport Dug Out Shelters	32
Helmet Lockers	33
Cigarette Bins	33
Domed Roof Pram Shelter	34
Theta Buggy Shelter/Pram Store	35
Kappa Street Furniture	36
Stainless Steel Range	38
Youth Shelters	39-41
Omicron Youth Shelter	39
Epsilon Youth Shelter	40
Sunburst Youth Shelter	41
Omega Walkways and Entrance Canopies	42
Technical Information	43

INTRODUCTION TO APEX

Apex Shelter Systems manufacture a range of quality shelters and associated street furniture at affordable prices

All shelters are supplied in kit form with comprehensive installation instructions for ease of assembly. Alternatively, we can provide a full quotation for the supply, delivery and installation including ground works, where necessary. If required, we offer a free of charge nationwide site survey to assess the site and offer expert advice on the most suitable product for the application.

As well as the standard range of products, goods can be custom made to suit a specific site or requirement.

Our team has over 23 years experience in the design, manufacture and installation of street furniture. Risk assessments and method statements are carried out in accordance with CDM regulations. All work is covered by our Personal Indemnity Insurance. If necessary, where planning permission is required, a qualified architect will facilitate the application on your behalf. Costs for this service will vary for each project.

Shelters are designed to meet the structural integrity standard BS 5950-1990 (structural use of steelwork in building, Part 1).

Goods and installations are guaranteed for 12 months parts and labour.

Delivery

From receipt of order smaller items take approximately 3-4 weeks delivery. Shelters are on a 5-6 weeks lead time from order. Bespoke products are 6-8 weeks from acceptance of drawings.



Steel Work Finishes

Hot dipped galvanizing – to BS EN ISO 1461:1999

This treatment offers a low maintenance, long lasting finish for all types of environment. It is dull silver in appearance.

Polyester Powder Coating

Powder coating has excellent outdoor exposure qualities, as well as offering an attractive consistent appearance in a variety of colours.

The importance of the finish is not only the visible top coat, but, equally, the pre-treatment of the steelwork. All Apex products are shot blast to SA2.5 to degrease the surface and provide a key for the subsequent processes. The steel is then etch primed with Zinc Phosphate anti-corrosive Primer then the final coat of Polyester Powder is electrostatically sprayed onto the surface to a thickness of 80 - 110 microns. The treated steelwork is then heat-cured, melting the Polyester Powder into a continuous phase and bonding it into the steelwork. Polyester Powder Coats give high durability and high resistance to weathering plus excellent colour stability.

Prices shown in the catalogue are for galvanised or polyester powder coated. Please call the sales office for prices of galvanising and powder coating.

Colour Chart

There are 10 standard colours to choose;



RAL 9005 – Black



RAL 6005 – Dark Green



RAL 9010 – White



RAL 5013 – Dark Blue

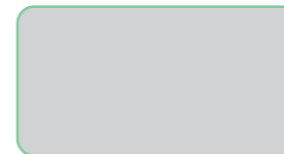

BS 00 A 05 – Light Grey



BS 04 E 53 – Poppy Red



BS 18 E 53 – Solent Blue

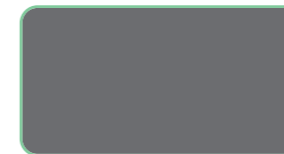

BS 18 B 25 – Merlin Grey



RAL 1023 - Yellow



RAL 3004 - Burgundy

Alternative BS or RAL Colours can be provided but they will incur an additional charge.

Galvanizing and powder coating

If requested, goods can be polyester powder coated on top of the galvanized finish to give a more durable resistance in extreme weather conditions. This does give the products a rougher texture than the standard powder coating due to the galvanized undercoat.

Roofing Materials

5mm Transparent (PET)

These high quality sheets are solid plastic manufactured from Polyethylene Terephthalate (PET). They are extremely impact resistant and have an excellent fire rating complying with BS 476:Part 7. Their resistance to weathering is guaranteed for 10 years. They have a high chemical resistance so even graffiti can be removed using an acetone free solvent cleaner. PET is environmentally friendly with ideal re-cycling properties.

Plastisol Coated Steel

Plastisol cladding (HP200®) offers excellent resistance to corrosion and moderate weather resistance. Guaranteed for a minimum of 10 years, it presents a hard wearing option available in 6 standard colours:-



BS 04 E 53 – Poppy Red

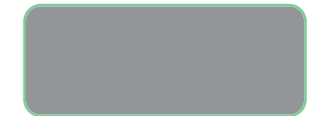

BS 10 A 05 – Goosewing Grey



BS 00 E 55 – White

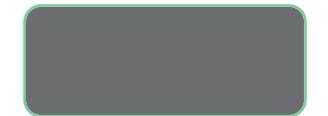

BS 18 B 25 – Merlin Grey



BS 18 E 53 – Solent Blue



RAL 6002 - Heritage Green



BS18B29 – Slate Blue



BS 08B29 – Vandyke Brown

The reverse of the plastisol sheet comes as standard in a grey polyester. The exposed face is supplied in a 200 micron external grade PVC coating. The sheeting is non combustible and will not contribute to a fire. The roofing sheets achieve a Class 0 rating in the Building Regulations.



Picture shows example of the plastisol cladding in Solent Blue BS 18 E 53

Conditions of Sale

Prices quoted are current at date of printing. The prices refer to the powder coated cost unless otherwise stated. All prices are ex works, excluding VAT.

Due to printing limitations colours may vary slightly to those shown in the brochure.

Dimensions are approximate.

Company Conditions of Sale are available upon request.

Alpha P Cycle and Motorcycle Shelter



Picture shows a bank of 2 Alpha P IR12 Shelters

DESCRIPTION

Contemporary shelter suitable to accommodate cycles and/or motorcycles. Cycles racks can be adapted to hold junior cycles and/or scooters. Motorcycles can be free standing or the shelter can be supplied with an integral locking rail to the rear of shelter so motorcycles can be secured via chain or D lock.

CONSTRUCTION

Robust construction with fully welded end panels. Manufactured from Heavy duty box section. Roofing is plastisol coated steel (P). Technical details and colours see page 5. Supplied with adjustable feet for bolting to concrete or extended legs for submerging into concrete.

DIMENSIONS

Overall width: 2100mm

Height: (to front) 2100mm

Length: standard bays 4000mm (10 bikes, 12 junior/infant bikes or 4-5 motorcycles dependent upon the style of rack) or 5000mm (12 bikes, 14 junior bikes or 5-6 motorcycles dependent upon the style of rack). The cycle and motorcycle racks can be found on Page 25-27.

INSTALLATION

Shelters have been designed for ease of installation and are supplied in a flat pack form with full technical installation instructions. Alternatively, a full nationwide installation service is available including ground-works. Please contact the sales office for further information.

OPTIONS AVAILABLE:

Alpha P5 – 5000mm General Shelter with no integral supports or end panels

Optional Stands or Racks:

IR or R – Integral rack (IR) or floor mounted double sided cycle rack (R)

NU - Sheffield parking posts

MC – Motorcycle locking rail (MC)

IR JNR or R JNR – Junior integral fully welded cycle rack (IR-JNR) or floor mounted double sided rack (R-JNR)

Optional End Panels (EP)

EP – 5mm thick transparent end panels

Additional Bays

Shelters are modular and can be supplied in any length to suit the application.

10 standard Polyester Powder Coated Colours are available for the framework. Please see colour chart on page 5.



Picture shows 2 Alpha P IR12 Shelters with End Panels

Alpha T Cycles and Motorcycles Shelter



Picture shows Alpha with End Panels and Integral Rack (Alpha T EP-IR)

DESCRIPTION

Alpha T shelter allows high visibility, which is ideal where C.C.T.V. is in operation. This shelter also suitable for cycles, motorcycles and scooters.

CONSTRUCTION

Heavy duty, robust construction with fully welded end panels. Manufactured from Heavy duty box section. Roofing is 5mm thick transparent PET (T). Technical details are shown on P5. Supplied with adjustable feet for bolting to concrete or extended legs for submerging into concrete.

DIMENSIONS

Overall width: 2100mm

Height: (to front) 2100mm

Length: standard bays 4000mm (10 bikes, 12 junior/infant bikes or 4-5 motorcycles dependent upon the style of rack) or 5000mm (12 bikes, 14 junior bikes or 5-6 motorcycles dependent upon the style of rack).

INSTALLATION

Shelters have been designed for ease of installation and are supplied in a flat pack form with full technical installation instructions. Alternatively, a full nationwide installation service is available including groundworks. Please contact the sales office for further information.

OPTIONS AVAILABLE:

Alpha T5 – 5000mm General Shelter with no integral supports or end panels

Optional Stands or Racks:

IR or R – Integral rack (IR) or floor mounted double sided cycle rack (R)

NU - Sheffield parking posts

MC – Motorcycle locking rail (MC)

IR JNR or R JNR – Junior integral fully welded cycle rack (IR-JNR) or floor mounted double sided rack (R-JNR)

Optional End Panels (EP)

EP – 5mm thick transparent end panels

Additional Bays

Shelters are modular and can be supplied in any length to suit the application.

10 standard Polyester Powder Coated Colours are available for the framework. Please see colour chart on page 5.



Picture shows bank of Alpha IR Shelters with Integral Racks (Alpha T IR)

Theta P Cycle and Motorcycle Shelter



Picture shows a bank of 3 Theta Shelters with PET end panels. The plastisol back panels have been custom made to infill between the wall.

DESCRIPTION

The Theta shelter is ideal for storing either cycle and/or motorcycles. Cycle racks can be adapted to hold junior cycles and/or scooters. Motorcycles can be free standing or the shelter can be supplied with a locking rail to rear of shelter so motorcycles can be secured via chain or d lock.

CONSTRUCTION

Robust construction with fully welded end panels. Manufactured from Heavy duty box section. Roofing is Plastisol coated steel (P). Technical details and colours are shown on P5. Supplied with adjustable feet for bolting to concrete or extended legs for submerging into concrete.

DIMENSIONS

Overall width: 2100mm

Height: (to front) 2100mm

Length: standard bays 4000mm or 5000mm for 10 bikes or 4-5 motorcycles or 12 bikes and 5-6 motorcycles respectively. Junior racks are available for 12 or 14 cycles respectively.

INSTALLATION

Shelters have been designed for ease of installation and are supplied in a flat pack form with full technical installation instructions. Alternatively, a full nationwide installation service is available including groundworks. Please contact the sales office for further information.

OPTIONS AVAILABLE:

Theta P – General Shelter with no integral supports or end panels

Optional racks or stands

IR or R – Integral rack (IR) or floor mounted double sided cycle rack (R)

NU - Sheffield parking posts

MC – Motorcycle locking rail (MC)

IR JNR or R JNR – Junior integral fully welded cycle rack (IR-JNR) or floor mounted double sided rack (R-JNR)

Optional End Panels (EP)

EP – 5mm thick transparent end panels

Additional Bays

Shelters are modular and can be supplied in any length to suit application.

10 standard Polyester Powder Coated Colours are available for the framework. Please see colour chart on page 5.

End Panels (optional)

EP – 5mm thick transparent end panels end panel

BP – Back Panel Plastisol Coated Steel. Also available in Transparent PET at an extra cost.



Picture shows Theta P Shelter with Integral Rack and Plastisol Back Panel.

Theta T Cycle and Motorcycle Shelter



Picture shows Theta T Shelter with Integral Rack and Transparent Back and Side Panels.

DESCRIPTION

The Theta shelter is suitable to accommodate cycles and/or motorcycles. Cycle racks can be adapted to hold junior cycles and/or scooters. Motorcycles can be free standing or the shelter can be supplied with a locking rail to rear of shelter so motorcycles can be secured via chain or d lock.

CONSTRUCTION

Robust construction with fully welded end panels. Manufactured from Heavy duty box section. Roofing is 5mm thick transparent PET. Supplied with adjustable feet for bolting to concrete or extended legs for submerging into concrete.

DIMENSIONS

Overall width: 2100mm

Height: (to front) 2100mm

Length: standard bays 4000mm or 5000mm for 10 bikes or 4-5 motorcycles or 12 bikes and 5-6 motorcycles respectively. Junior racks are available for 12 or 14 cycles respectively

INSTALLATION

Shelters have been designed for ease of installation and are supplied in a flat pack form with full technical installation instructions. Alternatively, a full nationwide installation service is available including groundworks. Please contact the sales office for further information.

OPTIONS AVAILABLE:

Theta T – General Shelter with no integral supports or end panels

Optional racks or stands

IR or R – Integral rack (IR) or floor mounted double sided cycle rack (R)

NU - Sheffield parking posts

MC – Motorcycle locking rail (MC)

IR JNR or R JNR – Junior integral fully welded cycle rack (IR-JNR) or floor mounted double sided rack (R-JNR)

Optional End Panels (EP)

EP – 5mm thick transparent end panels

Additional Bays

Shelters are modular and can be supplied in any length to suit application. 10 standard Polyester Powder Coated Colours are available for the framework. Please see colour chart on page 5.

End Panels (optional)

Theta T EP – 5mm thick transparent end panels per end panel

Theta T BP – Back Panel in 5mm Transparent PET. Also available in Plastisol Coated Steel.



Beta Cycle and Motorcycle Shelter



Picture shows a bank of 2 Beta P iR12 Shelters

DESCRIPTION

The Beta shelter is suitable to accommodate cycles and/or motorcycles. Cycle racks can be adapted to hold junior cycles and/or scooters. Motorcycles can be free standing or the shelter can be supplied with a locking rail to rear of shelter so motorcycles can be secured via chain or D lock.

CONSTRUCTION

Heavy duty construction with fully welded end panels. Plastisol coated steel (P) roofing panels. Technical specification and available colours can be found on P5. Can be supplied with transparent roofing panels, if required. Please contact the sales department for a full quotation. Supplied with adjustable feet for bolting to concrete or extended legs for submerging into concrete.

DIMENSIONS

Overall width: 2100mm

Height: (to front) 2100mm

Length: standard bays 4000mm or 5000mm for 10 bikes or 4-5 motorcycles or 12 bikes and 5-6 motorcycles respectively. Junior racks are available for 12 or 14 cycles respectively.

INSTALLATION

Supplied in kit form with comprehensive installation instructions. A full UK installation service is available. Please contact the sales office for further information.

OPTIONS AVAILABLE:

Beta P – General Shelter with no integral supports

Optional racks or stands

IR or R – Integral rack (IR) or floor mounted double sided cycle rack (R)

NU - Sheffield parking posts

MC – Motorcycle locking rail (MC)

IR JNR or R JNR – Junior integral fully welded cycle rack (IR-JNR) or floor mounted double sided rack (R-JNR)

Optional End Panels (EP)

EP – 5mm thick transparent end panels

Additional Bays

Shelters are modular and can be supplied in any length to suit application.

10 standard Polyester Powder Coated Colours are available for the framework. Please see colour chart on page 5.



Picture shows bank of 2 Beta Shelters with Integral Rack

Delta Cycle and Motorcycle Shelter



Above picture shows combined cycle and motorcycle shelter

DESCRIPTION

The Delta shelter is a double entry shelter suitable to hold cycles and/or motorcycles. Cycle racks can be adapted to hold junior cycles and/or scooters. Motorcycles can be free standing or the shelter can be supplied with a locking rail to rear of shelter so motorcycles can be secured via chain or D lock.

CONSTRUCTION

Robust construction with fully welded end panels. Manufactured from Heavy duty box section. Roofing is Plastisol coated steel (P). Technical details and colours are shown on P5. Can be supplied with transparent roofing panels, if required. Supplied with adjustable feet for bolting to concrete or extended legs for submerging into concrete.

DIMENSIONS

Overall width: 3800mm

Height: (to centre) 2184mm

Length: standard bays 4000mm or 5000mm for 20 bikes or 8-10 motorcycles or 24 bikes and 10-12 motorcycles respectively. Junior racks are available for 24 or 28 cycles respectively. Cycle capacity depends upon the style of racking used in conjunction with this shelter.

INSTALLATION

Shelters have been designed for ease of installation and are supplied in a flat pack form with full technical installation instructions. Alternatively, a full nationwide installation service is available including groundworks. Please contact the sales office for further information.

OPTIONS AVAILABLE:

Delta P – Plastisol Steel Roof General Shelter with no integral supports or end panels

Delta T – Transparent Roof General Shelter with no integral supports or end panels

Optional racks or stands

DIR or DR - Integral double entry rack or 2 bays of floor mounted racks

NU - Locking rails can be fitted one side or both sides

DR JNR or IR JNR - Junior double entry cycle rack of two bays of floor mounted cycle racks

Additional Bays

Shelters are modular and can be supplied in any length to suit application.

10 standard Polyester Powder Coated Colours are available for the framework. Please see colour chart on page 5.

End Panels (optional)

EP – 5mm thick transparent end panels



Picture shows a bank of Delta P IR Shelters

Gamma Cycle and Motorcycle Shelter



Picture shows Gamma P Shelter with Integral Rack

DESCRIPTION

The Gamma double entry shelter is suitable to hold cycles and/or motorcycles. Cycle racks can be adapted to hold junior cycles and/or scooters. Motorcycles can be free standing or the shelter can be supplied with a double sided locking rail to rear of shelter so motorcycles can be secured via chain or D lock.

CONSTRUCTION

Robust construction with fully welded end panels. Manufactured from Heavy duty box section. Roofing is Plastisol coated steel (P). Technical details and colours are shown on P5. Can be supplied with transparent roofing panels, if required. Please contact the sales the sales department for a full quotation. Supplied with adjustable feet for bolting to concrete or extended legs for submerging into concrete.

DIMENSIONS

Overall width: 3800mm

Height: (to centre) 2184mm

Length: standard bays 4000mm or 5000mm for 20 bikes or 24 bikes or junior racks for 24 or 28 cycles respectively (depending upon style of cycle rack used) or 8-10 motorcycles and 10-12 motorcycles respectively.

INSTALLATION

Shelters have been designed for ease of installation and are supplied in a flat pack form with full technical installation instructions. Alternatively, a full nationwide installation service is available including groundworks. Please contact the sales office for further information.

OPTIONS AVAILABLE:

Gamma P – Plastisol Steel Roof General Shelter with no integral supports or end panels

Gamma T – Pet Roofing General Shelter with no integral supports or end panels

Optional racks or stands

DIR or DR - Integral double entry rack or 2 bays of floor mounted racks

NU - Locking rails can be fitted one side or both sides

DR JNR or IR JNR - Junior double entry cycle rack of two bays of floor mounted cycle racks

Additional Bays

Shelters are modular and can be supplied in any length to suit application.

10 standard Polyester Powder Coated Colours are available for the framework. Please see colour chart on page 5.

End Panels (optional)

EP – 5mm thick transparent end panels

Custom designed projects



▲ A recent example of our custom designed shelters is at Stourport High School, Stourport on Severn. They had a requirement for secure external storage for a large quantity of lockers for the pupils.

Following an initial visit to the school, a full Computer Aided Design was presented showing the type of shelter and dimensions of the compound and also the layout of the lockers.

The picture above shows the secure compound with lighting supplied by ourselves, enclosing the lockers that the school had on site.

Free of charge nationwide surveys are available to discuss your requirements and provide a full quotation including any ground works required.

Another example of a custom designed shelter is in Eastbourne. The photograph below shows a compound manufactured to cover cycle stands already on site. Initially half of the existing cycle stands have been covered with the remainder to be covered in the next financial year.



Alpha Cycle and Motorcycle Compound



Picture shows the Alpha T Compound with integral cycle racks - Alpha T IR COMP

DESCRIPTION

Gates can be added to the Alpha Shelter to provide additional security. Gates are fitted with a hasp and staple (as standard) for padlocking. Padlocks are not supplied. Alternative locking methods such as key operated or coin retain/return can be incorporated. If the area is restricted sliding gates could reduce the footprint of the shelter.

CONSTRUCTION

Heavy duty construction with fully welded end panels clad with 5mm thick transparent PET end and roof panels (T). An alternative is Platisol coated steel (P) roofing panels together with welded mesh end panels. Please contact the sales department for a full quotation. Supplied with adjustable feet for bolting to concrete or extended legs for submerging into concrete.

DIMENSIONS

Overall width of shelter: 2100mm with gates opening 2000mm for 4m length or 2500mm for 5000mm length.
Height: (to front) 2100mm
Length: standard bays 4000mm or 5000mm for 10 bikes or 4-5 motorcycles or 12 bikes and 5-6 motorcycles respectively. Junior racks are available for 12 or 14 cycles respectively. Cycle capacity depends upon the style of rack used in conjunction with shelter.

INSTALLATION

Shelters have been designed for ease of installation and are supplied in a flat pack form with full technical installation instructions. Alternatively, a full nationwide installation service is available including groundworks. Please contact the sales office for further information.

OPTIONS AVAILABLE:

Alpha P COMP – Platisol Roof General Security Shelter with no integral supports and transparent end panels

ALPHA T COMP – Transparent PET roof General Security Shelter with no integral supports

Optional racks or stands

IR or R – Integral rack (IR) or floor mounted double sided cycle rack (R)

NU - Sheffield parking posts

MC – Motorcycle locking rail (MC)

IR JNR or R JNR – Junior integral fully welded cycle rack (IR-JNR) or floor mounted double sided rack (R-JNR)

Optional End Panels (EP)

EP – 5mm thick transparent end panels

Additional Bays

Shelters are modular and can be supplied in any length to suit application.

10 standard Polyester Powder Coated Colours are available for the framework. Please see colour chart on page 5.

Theta Cycle and Motorcycle Compound



Picture shows Theta P Compound with Integral Rack and Transparent Back and Side Panels.

DESCRIPTION

The Theta compound can be supplied with Platisol roof and back and clear sides or a clear roof, back and sides for all round visibility. Suitable for cycles and motorcycles.

CONSTRUCTION

Robust construction with fully welded end panels. Manufactured from Heavy duty box section with platisol roof and back (P) fitted as standard. Platisol technical specification and available colours can be found on P5. Please contact the sales department for more information or a comprehensive quotation. Supplied with adjustable feet for bolting to concrete or extended legs for submerging into concrete.

DIMENSIONS

Overall width: 2100mm

Height: (to front) 2100mm

Length: standard bays 4000mm or 5000mm for 10 bikes or 4-5 motorcycles or 12 bikes and 5-6 motorcycles respectively. Junior racks are available for 12 or 14 cycles respectively. Cycle capacity depends upon the style of rack used in conjunction with this shelter.

INSTALLATION

Shelters have been designed for ease of installation and are supplied in a flat pack form with full technical installation instructions. Alternatively, a full nationwide installation service is available including groundworks. Please contact the sales office for further information.

OPTIONS AVAILABLE:

Theta P COMP – Platisol Roof General Shelter with no integral supports

Theta T COMP – Transparent Roof General Shelter with no integral supports

Optional racks or stands

IR or R – Integral rack (IR) or floor mounted double sided cycle rack (R)

NU - Sheffield parking posts

MC – Motorcycle locking rail (MC)

IR JNR or R JNR – Junior integral fully welded cycle rack (IR-JNR) or floor mounted double sided rack (R-JNR)

Optional End Panels (EP)

EP – 5mm thick transparent end panels

Additional Bays

Shelters are modular and can be supplied in any length to suit application.

10 standard Polyester Powder Coated Colours are available for the framework. Please see colour chart on page 5.

Opposing Alpha Cycle and Motorcycle Compounds



Picture shows the OP/Alpha TiR Compound with integral cycle racks

DESCRIPTION

This installation shows two opposing Alpha Cycle Shelters making a secure compound. The lockable gates can be fitted to one or both sides allowing two entrances or exits. Alternatively, one side can be a fixed security panel. A variety of locking mechanisms are available including a hasp and staple which is supplied as standard or a sliding bolt (padlocks not supplied with either options), a coin return, a coin retain or a card swipe system are also available. Roof panels can be fitted to the walkway to provide enhanced weather protection. Vandal resistant lighting can also be installed as required.

CONSTRUCTION

Heavy duty construction with fully welded end panels clad with 5mm thick transparent PET end and roof panels (T) for all round visibility. An alternative to 5mm thick clear PET is Platisol coated steel (P) roofing panels together with welded security mesh end panels. Please contact the sales the sales department for a full quotation. Supplied with adjustable feet for bolting to concrete or extended legs for submerging into concrete.

DIMENSIONS

Overall width of shelter: 6000mm with gates opening 1200mm.

Height: (to centre) 2100mm

Length: : standard bays 4000mm or 5000mm for 20 bikes or 8-10 motorcycles or 24 bikes and 10-12 motorcycles respectively. Junior racks are available for 24 or 28 cycles respectively – based on maximum capacity depending upon the style of racks.

INSTALLATION

Shelters have been designed for ease of installation and are supplied in a flat pack form with full technical installation instructions. Alternatively, a full nationwide installation service is available including groundworks. Please contact the sales office for further information.

OPTIONS AVAILABLE: (Price per single 5m length unit)

OP ALPHA P COMP – Platisol Steel Roof General Security Shelter with no integral supports

OP ALPHA T COMP – Transparent Roof General Security Shelter with no integral supports

Additional Bays

Shelters are modular and can be supplied in any length to suit application.

10 standard Polyester Powder Coated Colours are available for the framework. Please see colour chart on page 5.

Enhanced Weather Protection (Optional)

5mm thick transparent PET to walkway of the compound



Opposing Theta Cycle and Motorcycle Compounds



Picture shows the OP Theta TiR Compound with integral cycle racks

DESCRIPTION

This installation shows two opposing Theta Cycle Shelters which provides secure storage for the bikes or motorcycles. The lockable gates can be fitted to one or both sides allowing two entrances/exits. Alternatively, one side can be a fixed security panel. A variety of locking mechanisms are available including a hasp and staple which is supplied as standard or a sliding bolt (padlocks not supplied with either options), a coin return, a coin retain or a card swipe system are also available. Roof panels can be fitted to the walkway to provide enhance weather protection. Vandal resistant lighting can also be installed as required.

CONSTRUCTION

Heavy duty construction with fully welded end panels clad with 5mm thick transparent PET end and roof panels (T) for all round visibility. An alternative to 5mm thick clear PET is Platisol coated steel (P) roofing panels together with welded security mesh end panels. Please contact the sales the sales department for a full quotation. Supplied with adjustable feet for bolting to concrete or extended legs for submerging into concrete.

DIMENSIONS

Overall width of shelter: 6000mm with gates opening 1200mm.

Height: (to front) 2100mm

Length: standard bays 4000mm or 5000mm for 20 bikes or 8-10 motorcycles or 24 bikes and 10-12 motorcycles respectively. Junior racks are available for 24 or 28 cycles respectively.

INSTALLATION

Shelters have been designed for ease of installation and are supplied in a flat pack form with full technical installation instructions. Alternatively, a full nationwide installation service is available including groundworks. Please contact the sales office for further information.

OPTIONS AVAILABLE: (Price per single 5m unit)

OP THETA P COMP – Platisol Roof General Security Shelter with no integral supports

OP THETA T COMP – Transparent Roof General Security Shelter with no integral supports

Additional Bays

Shelters are modular and can be supplied in any length to suit application.

10 standard Polyester Powder Coated Colours are available for the framework. Please see colour chart on page 5.

Enhanced Weather Protection (Optional)

5mm thick transparent PET to walkway of the compound

Alpha Gamma Combination Compound



Picture shows the Alpha T Gamma P Compound with integral cycle racks to hold 144 cycles

DESCRIPTION

This compound uses the Alpha and the Gamma Shelters to make valuable use of larger areas. Two lockable gates can be fitted to one or both sides of the compound allowing four entrances or exits. Alternatively, one side can be fitted with fixed security panels to prevent access. A variety of locking mechanisms are available including a hasp and staple which is supplied as standard or a sliding bolt (padlocks not supplied), a coin return, a coin retain or a swipe card system are also available. Roof panels can be fitted to the walkway to provide enhanced weather protection. Vandal resistant lighting can also be installed as required.

CONSTRUCTION

Heavy duty construction with fully welded end panels clad with 5mm thick transparent PET and available with a combination of roof panels - 5mm thick clear PET or /and Plastisol coated steel (P) roofing panels. Lockable Gates can be fitted both sides of the compound or a fixed security panel can be fitted to the far side to limit access to on side. Supplied with adjustable feet for bolting to concrete or extended legs for submerging into concrete.

DIMENSIONS

Overall width of shelter: 12000mm.

Height: (to front) 2100mm.

Length: standard bays 4000mm or 5000mm for 40 bikes or 16-20 motorcycles or 48 bikes and 40-48 motorcycles respectively. Junior racks are available for 48 or 56 cycles respectively.

INSTALLATION

Shelters have been designed for ease of installation and are supplied in a flat pack form with full technical installation instructions. Alternatively, a full nationwide installation service is available including groundworks. Please contact the sales office for further information.

OPTIONS AVAILABLE:

ALPHA P GAMMA P COMP – Plastisol Roof General Security Compound with no integral supports

ALPHA T GAMMA P COMP – Plastisol Roof Gamma and Transparent Roof Alpha General Security Compound with no integral supports

ALPHA T GAMMA T COMP – Transparent Roof Gamma and Alpha General Security Compound with no integral supports

Additional Bays

Shelters are modular and can be supplied in any length to suit application. Please call the Sales Office for a full quotation.

10 standard Polyester Powder Coated Colours are available for the framework. Please see colour chart on page 5.

Enhanced Weather Protection (Optional)

5mm thick transparent PET to walkway of the compound

Please call the sales office for a full quotation or to arrange a site survey.

Theta Delta Combination Compound



Picture shows the Theta T Delta P Compound with integral cycle racks

DESCRIPTION

The compound uses a combination of the Theta and Delta Shelters to make use of larger areas. Two lockable gates can be fitted to one or both sides of the compound allowing four entrances or exits. Alternatively, one side can be fitted with fixed security panels to prevent access. A variety of locking mechanisms are available including a hasp and staple which is supplied as standard or a sliding bolt (padlocks not supplied with either options), a coin return, a coin retain or a card swipe system are also available. Roof panels can be fitted to the walkway to provide enhanced weather protection. Vandal resistant lighting can also be installed as required.

CONSTRUCTION

Heavy duty construction with fully welded end panels clad with 5mm thick transparent PET end and available with a combination of roof panels - 5mm thick clear PET or /and Plastisol coated steel (P) roofing panels. Lockable Gates can be fitted both sides of the compound or a fixed security panel can be fitted to the far side to limit access to on side. Supplied with adjustable feet for bolting to concrete or extended legs for submerging into concrete.

DIMENSIONS

Overall width of shelter: 12000mm.

Height: (to front) 2100mm.

Length: standard bays 4000mm or 5000mm for 40 bikes or 16-20 motorcycles or 48 bikes and 40-48 motorcycles respectively. Junior racks are available for 48 or 56 cycles respectively. Cycle capacity is dependent upon the style of cycle rack used.

INSTALLATION

Shelters have been designed for ease of installation and are supplied in a flat pack form with full technical installation instructions. Alternatively, a full nationwide installation service is available including groundworks. Please contact the sales office for further information.

OPTIONS AVAILABLE:

THETA P DELTA P COMP – Plastisol Roof Theta and Delta General Security Compound with no integral supports

THETA T DELTA P COMP – Transparent roof Theta and Plastisol Roof Delta General Security Compound with no integral supports

THETA T DELTA T COMP – Transparent roof Theta and Delta General Security Compound with no integral supports

Additional Bays

Shelters are modular and can be supplied in any length to suit application.

Please call the sales office for a full quotation.

10 standard Polyester Powder Coated Colours are available for the framework. Please see colour chart on page 5.

Enhanced Weather Protection (Optional)

5mm thick transparent PET to walkway of the compound

Please call the sales office for a full quotation or to arrange a site survey.

Gamma Compound



Picture shows Gamma P Compound with Integral Rack and Transparent Side Panels.

DESCRIPTION

The Gamma compound can be supplied with Platisol roof and clear sides or a clear roof and sides for all round visibility. Suitable for cycles and motorcycles.

CONSTRUCTION

Robust construction with fully welded end panels. Manufactured from Heavy duty box section with plastisol roof and back (P) fitted as standard. Platisol technical specification and available colours can be found on P5. Please contact the sales department for more information or a comprehensive quotation. Supplied with adjustable feet for bolting to concrete or extended legs for submerging into concrete.

DIMENSIONS

Overall width of shelter: 3800mm (with opening gates at either side at 2m or 2.5m wide)
Height: (to lowest point) 2184mm
Length: standard bays 4000mm or 5000mm for 20 bikes or 8-10 motorcycles or 24 bikes and 10-12 motorcycles respectively. Junior racks are available for 24 or 28 cycles respectively. Cycle capacity depends upon the style of rack used in conjunction with this shelter.

INSTALLATION

Shelters have been designed for ease of installation and are supplied in a flat pack form with full technical installation instructions. Alternatively, a full nationwide installation service is available including groundworks. Please contact the sales office for further information.

OPTIONS AVAILABLE:

Gamma P COMP – Platisol Roof General Shelter with no integral supports

Theta T COMP – Transparent Roof General Shelter with no integral supports

Optional racks or stands

Additional Bays

Shelters are modular and can be supplied in any length to suit application.

10 standard Polyester Powder Coated Colours are available for the framework. Please see colour chart on page 5.

Lambda Cycle Cage

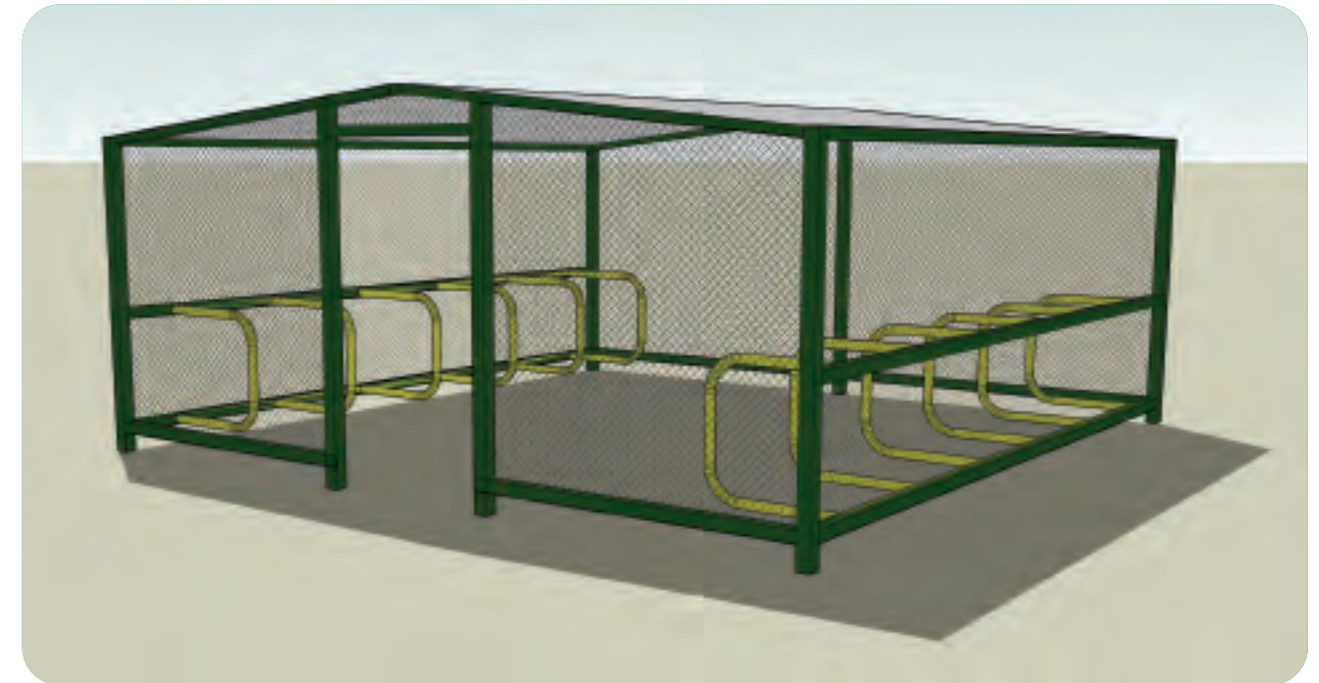

DESCRIPTION

Security cage is ideal for external storage of scooters, cycles and motorcycles. Cage can be painted on top of the galvanized finish, if desired.

CONSTRUCTION

Robust security cage manufactured from galvanized mesh panels with a galvanized corrugated roof. A lockable gate is fitted to one side of the cage as standard. Alternatively, galvanized panels can be used instead of the mesh panels. A variety of locking mechanisms are available including a hasp and staple which is supplied as standard or a sliding bolt (padlocks not supplied with either options), a coin return, a coin retain or a card swipe system. Roof panels can be transparent PET. Vandal resistant lighting can also be installed as required. Supplied with adjustable feet for bolting to concrete or extended legs for submerging into concrete.

DIMENSIONS

Overall width of shelter: 5000mm.

Height: (to lowest point) 2500mm

Length: standard bays 4085mm or 5085mm for 20 bikes or 8-10 motorcycles or 24 bikes and 12-24 motorcycles respectively. Junior racks are available for 14 or 28 cycles respectively.

INSTALLATION

Shelters have been designed for ease of installation and are supplied in a flat pack form with full technical installation instructions. Alternatively, a full nationwide installation service is available including groundworks. Please contact the sales office for further information.

OPTIONS AVAILABLE:

LAMBDA GENERAL CAGE – General Security Cage with no integral supports

Optional Stands or Racks:

IR or R – Integral rack (IR) or floor mounted double sided cycle rack (R)

NU - Sheffield parking posts

MC – Motorcycle locking rail (MC)

IR JNR or R JNR – Junior integral fully welded cycle rack (IR-JNR) or floor mounted double sided rack (R-JNR)

Optional End Panels (EP)

EP – 5mm thick transparent end panels

Additional Bays

Shelters are modular and can be supplied in any length to suit application.

Please call the sales office for a full quotation.

10 standard Polyester Powder Coated Colours are available for the framework. Please see colour chart on page 5.

Omega Cycle Cage



DESCRIPTION

Security cage is ideal for external storage of scooters, cycles and motorcycles. Cage can be painted on top of the galvanized finish, if desired.

CONSTRUCTION

Robust security cage manufactured from galvanized mesh panels with a galvanized corrugated roof. A lockable gate is fitted to the front of the shelter. Alternatively, galvanized panels can be used instead of the mesh panels. A variety of locking mechanisms are available including a hasp and staple which is supplied as standard or a sliding bolt (padlocks not supplied with either options), a coin return, a coin retain or a card swipe system. Roof panels can be transparent PET.

DIMENSIONS

Overall width of shelter: 2500mm.

Height: (to lowest point) 2150mm

Length: standard bays 4085mm or 5085mm for 10 bikes or 4-5 motorcycles or 12 bikes and 5-6 motorcycles respectively. Junior racks are available for 12 or 14 junior cycles respectively.

INSTALLATION

Shelters have been designed for ease of installation and are supplied in a flat pack form with full technical installation instructions. Alternatively, a full nationwide installation service is available including groundworks. Please contact the sales office for further information.

OPTIONS AVAILABLE:

OMEGA GENERAL CAGE – General Security Cage with no integral supports

Additional Bays

Shelters are modular and can be supplied in any length to suit application.

Please call the sales office for a full quotation.

10 standard Polyester Powder Coated Colours are available for the framework. Please see colour chart on page 5.

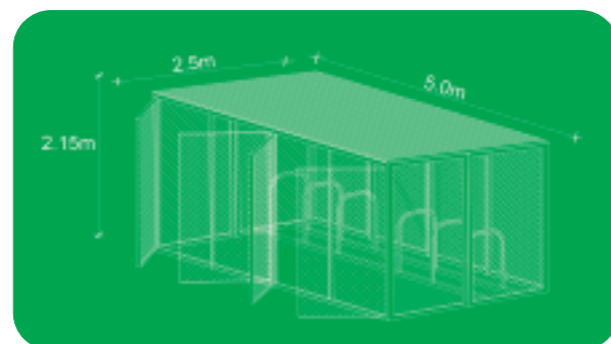

Sigma Horizontal Cycle Locker

DESCRIPTION

Individual Horizontal Cycle Security Lockers with perforated viewing panel to door. Supplied with coat hook and helmet hook and trough support to guide cycle into place with a front wheel support to hold into place. Lockers can be polyester powder coated in addition to the galvanized finish, if desired. Logos can be added to the lockers.

CONSTRUCTION

Locker manufactured from galvanized panels with a either a sloped roof or an apex roof. The door is fitted with piano hinge and three point locking mechanism. Other cladding options are available; perforated steel sheeting, transparent sheets, plastisol sheets or mesh panels. A variety of locking mechanisms are available including a hasp and staple which is supplied as standard, a t handle lock, a coin return, a coin retain or a card swipe system. Double sided lockers for 2 cycles are available, please ask the sales department for details.

DIMENSIONS

Width: 800mm

Height: 1100mm

Length: 1900mm respectively. Junior racks are available for 14 or 28 cycles respectively.

INSTALLATION

Lockers are supplied fully assembled with 4 pre-punched base plates for securing into position. A full nationwide installation service is available including groundworks. Please contact the sales office for further information.

SIGMA HORIZONTAL LOCKER – Galvanized or Galvanized and Polyester Powder Coated.

10 standard Polyester Powder Coated Colours are available for the framework. Please see colour chart on page 5.

Sigma Semi-Vertical Cycle Locker

DESCRIPTION

Individual Semi-vertical Cycle Security Lockers with perforated viewing panel to door. Supplied with coat hook and helmet hook and trough support to guide cycle into place with a front wheel support to hold into place. Lockers can be polyester powder coated in addition to the galvanized finish, if desired. Logos can be added to the lockers.

CONSTRUCTION

Locker manufactured from galvanized panels with a either a sloped roof or an apex roof. The door is fitted with piano hinge and three point locking mechanism. Other cladding options are available; perforated steel sheeting, transparent sheets, plastisol sheets or mesh panels. A variety of locking mechanisms are available including a hasp and staple which is supplied as standard, a t handle lock, a coin return, a coin retain or a card swipe system. Double sided lockers for 2 cycles are available, please ask the sales department for details.

DIMENSIONS

Width: 800mm

Height: 1950mm

Length: 1200mm

INSTALLATION

Lockers are supplied fully assembled with 4 pre-punched base plates for securing into position. A full nationwide installation service is available including groundworks. Please contact the sales office for further information.

SIGMA VERTICAL LOCKER – Galvanized or Galvanized and Polyester Powder Coated.

10 standard Polyester Powder Coated Colours are available for the framework. Please see colour chart on page 5.



Motorcycle Locking Rail (MC)

DESCRIPTION

This motorcycle rail can be fitted to any of the shelters to provide covered secure storage for motorcycles.

CONSTRUCTION

The design is supplied fully welded and is easily fitted when installing the shelter.

DIMENSIONS

Length: 4000mm **Capacity:** 4-5 Motorcycles

Length: 5000mm **Capacity:** 5-6 Motorcycles

INSTALLATION

A full UK installation service is available. Please contact the Sales Department for further details

MC4 – Locking Rail for 4-5 Motorcycles

MC5 – Locking Rail for 5-6 Motorcycles

10 standard Polyester Powder Coated Colours are available for the framework. Please see colour chart on page 5.



Above picture shows the shelter supplied with Locking Rail for securing motorcycles

Integral Cycle Rack (IR)

INSTALLATION

Due to the design of the cycle rack the integral supports can save on installation costs. If a shelter is to be installed where concrete pockets are the means of securing the shelter to the ground, there is a reduction of four pockets per shelter. This, therefore, reduces the costs of materials and working hours. Also, aesthetically, the installation is far more pleasing to the eye when as little disruption as possible has been carried out on the existing surface. This design also helps to eliminate the build-up of litter that can get lodged in the equivalent ground fixed racks.

IR-10 Integral Rack for 10 Cycles

IR-12 Integral Rack for 12 Cycles

10 standard Polyester Powder Coated Colours are available for the framework. Please see colour chart on page 5.



Above picture shows the cycle rack fitted integrally

DESCRIPTION

This cycle rack can be supplied with any of the shelters above. The double sided rack enables the storage of 2 cycles per loop.

CONSTRUCTION

The design is supplied fully welded and is easily fitted when installing the shelter.

DIMENSIONS

Length: 4000mm **Centres:** 800mm **Capacity:** 10 Cycles

Length: 5000mm **Centres:** 820mm **Capacity:** 12 Cycles

Integral Double Entry Cycle Rack

DESCRIPTION

Double entry cycle rack suitable for use with Gamma or Delta shelter.

CONSTRUCTION

Fully welded cycle rack which is easily fitted when installing shelter.

DIMENSIONS

Length: 4000mm centres 800mm **Capacity:** 20

Length: 5000mm centres 820mm **Capacity:** 22

INSTALLATION

A full UK installation service is available. Please contact the Sales Department for further details

10 standard Polyester Powder Coated Colours are available for the framework. Please see colour chart on page 5.



Integral Junior Cycle Rack (IR-JNR)

DESCRIPTION

As above except suitable for Junior and Infant Cycles.

CONSTRUCTION

The design is supplied fully welded and is easily fitted when installing the shelter.

DIMENSIONS

Length: 4000mm **Centres:** 650mm **Capacity:** 12 Cycles

Length: 5000mm **Centres:** 700mm **Capacity:** 14 Cycles

INSTALLATION

Due to the design of the cycle rack the integral supports can save on installation costs. If a shelter is to be installed where concrete pockets are the means of securing the shelter to the ground, there is a reduction of four pockets per shelter. This, therefore, reduces the costs of materials and working hours. Also, aesthetically, the installation is far more pleasing to the eye when as little disruption as possible has been carried out on the existing surface. This design also helps to eliminate the build-up of litter that can get lodged in the equivalent ground fixed racks.

IR-12 Jnr Integral Rack for 10 Cycles

IR-14 Jnr Integral Rack for 12 Cycles

10 standard Polyester Powder Coated Colours are available for the framework. Please see colour chart on page 5.

Floor Mounted Double Sided Cycle Rack (R)



DESCRIPTION

This cycle rack can be supplied on its own or to accompany any of the shelters. The double sided rack enables the storage of 2 cycles per loop. The standard centres the rack is supplied in is 700mm centres. If requested, the rack can be made to range from 800, 900mm and 1000mm centres.

CONSTRUCTION

The design is supplied fully welded with 4 pre-punches base plates for bolting to concrete. With lengths over 5000mm the racks are supplied in more than one section. This model is also available in stainless steel at an extra cost. Please ask the Sales Department for details.

DIMENSIONS

Length: 3000mm **Height:** 800mm **Width:** 750mm
Diameter: 50mm x 2.0mm wall thickness
Capacity: 10 Cycles

Length: 4400mm **Height:** 800mm **Width:** 750mm
Diameter: 50mm x 2.0mm wall thickness
Capacity: 12 Cycles

INSTALLATION

Full welded for bolting to concrete. UK installation service with full groundworks is available.

R-10 Floor Mounted Rack for 10 Cycles

R-12 Floor Mounted Rack for 12 Cycles

10 standard Polyester Powder Coated Colours are available for the framework. Please see colour chart on page 5.

Floor Mounted Double Sided Junior Cycle Rack (R-jnr)

DESCRIPTION

This junior cycle rack can be supplied on its own or to accompany any of the shelters. The double sided rack enables the storage of 2 cycles per loop. The standard centres the rack is supplied in is 650mm centres. If requested, the rack can be made to range from 700, 800, 900mm and 1000mm centres.

CONSTRUCTION

The design is supplied fully welded with 4 pre-punched base plates for bolting to concrete. With lengths over 5000mm the racks are supplied in more than one section. This model is also available in stainless steel at an extra cost. Please ask the Sales Department for details.

DIMENSIONS

Length: 4000mm **Height:** 600mm **Width:** 600mm
Capacity: 12 Cycles

Diameter: 50mm x 2.0mm wall thickness

Length: 5000mm **Height:** 600mm **Width:** 600mm
Capacity: 14 Cycles

Diameter: 50mm x 2.0mm wall thickness

INSTALLATION

Full welded for bolting to concrete. UK installation service with full groundworks is available.

R-10JNR Floor Mounted for 10 Junior Cycles

R-12JNR Floor Mounted for 12 Junior Cycles

10 standard Polyester Powder Coated Colours are available for the framework. Please see colour chart on page 5.

Nu Sheffield Cycle Stand



DESCRIPTION

This tubular cycle stand can be used for 1 or 2 cycles.

CONSTRUCTION

Available with base plates to bolt down or with extended legs to submerge into concrete. Can be manufactured in stainless steel at an additional cost. 48.3mm diameter tubing available for mild steel or stainless steel options.

DIMENSIONS

Width: 750mm **Height:** 800mm

NU Junior Sheffield Cycle Stand

DESCRIPTION

This tubular cycle stand can be used for 1 or 2 junior/infant cycles.

CONSTRUCTION

Available with base plates to bolt down or with extended legs to submerge into concrete. Can be manufactured in stainless steel at an additional cost. 48mm diameter tubing available for mild steel or stainless steel options.

DIMENSIONS

Width: 500mm **Height:** 600mm



NU Scooter Stand



DESCRIPTION

The scooter stand is supplied with pins to secure the scooter in position, this can then be locked with the users own padlock. Scooter racks can be incorporated into cycle shelters, please ask the Sales Department for further details.

CONSTRUCTION

Fully welded rack available with base plates for bolting down or with extension legs for submerged fixing. Can be supplied single or double sided.

DIMENSIONS

Nu-SCS5 Single Sided: Height: 800mm

Length: 750mm **Capacity:** 5 Scooters

Nu-SCS10 Single Sided: Height: 800mm

Length: 1675mm **Capacity:** 10 Scooters

Nu-SCD10 Double Sided: Height: 800mm

Length: 750mm **Capacity:** 10 Scooters

Nu-SCD20 Double Sided: Height: 800mm

Length: 1675mm **Capacity:** 20 Scooters



DESCRIPTION

Zeta Umbrellas offer a cheaper solution to providing valuable sun/weather protection. The umbrellas can be fitted with a guttering system to link more than one. Valances can be added to the umbrellas, with professional printing. The fabrics can be easily laundered commercially. Each umbrella is delivered in rigid cardboard tube which can be re-used or recycled.

CONSTRUCTION

The fabric of the shade is a high quality polyester fabric, 230 grammes per square metre. It is 100% water and UV proof. Even the heaviest of downpours will be resisted! Opening and closing of the umbrella is made easy with the use of a removable crank. The robust bevel gears the unique self locking, aluminium threaded spindle combined with a polyamide lifting element guarantee smooth and easy opening and closing. The umbrellas are designed to withstand winds of up to 30 km/hour.

DIMENSIONS

4m x 4m, 5m x 5m, 5.5m diameter, 7m x 7m or 10m diameter. Other sizes are available; please ask the sales department for assistance.

INSTALLATION

There are two options for the fixing method. The umbrella can either be supplied with an in ground anchor sleeve for setting into concrete (Zeta I) or with a free standing pedestal base with levelling feet (Zeta P). Concrete slabs are delivered in conjunction with this method to anchor it down. The number of flags depends upon the size of the umbrella.



- Zeta-I** 4x4 –4m x 4m square with integral base
- Zeta-P** 4x4 –4m x 4m square with portable base
- Zeta-I** 5x5 –5m x 5m square with integral base
- Zeta-P** 5x5 –5m x 5m square with portable base
- Zeta-I** 5.5 –5.5m diameter with integral base
- Zeta-P** 5.5 –5.5m diameter with portable base
- Zeta-I** 7x7 –7m x 7m square with integral base
- Zeta-P** 7x7 –7m x 7m square with portable base
- Zeta-I** 10 –10m diameter with integral base
- Zeta-P** 10 –10m diameter with portable base

There are a wide selection of colours available. The most popular shades are listed right; however, please contact the sales department as other colours and patterns can be obtained at no extra cost.

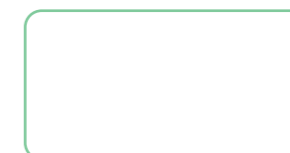

White



Navy Blue



Forest Green



Red

General Shelter



Picture shows a bank of 2 Theta Pedestrian Shelters with Back Panels

DESCRIPTION

Pedestrian/Pram Stores are available with optional back, end and front panels in both transparent PET and plastisol coated steel.

CONSTRUCTION

Heavy duty construction with fully welded end panels. Available with a combination of roof, back and end panels - 5mm thick clear PET or /and Plastisol coated steel (P) roofing panels. Supplied with adjustable feet for bolting to concrete or extended legs for submerging into concrete.

DIMENSIONS

Overall width: 2200mm **Height: (to front)** 2100mm
Length: standard bays 3000mm, 4000mm or 5000mm

INSTALLATION

Shelters have been designed for ease of installation and are supplied in a flat pack form with full technical installation instructions. Alternatively, a full nationwide installation service is available including groundworks. Please contact the sales office for further information.

THETA T- General Security Shelter with no end panels 5000mm

Additional Bays

Shelters are modular and can be supplied in any length to suit application.

10 standard Polyester Powder Coated Colours are available for the framework. Please see colour chart on page 5.

End Panels (optional)

Theta T EP – 5mm thick transparent end panels
Theta T BP – Back Panel in 5mm Transparent PET
Also available in Plastisol Coated Steel



Picture shows a Theta P waiting shelter with front panel alongside a cycle shelter

Theta Smoking Shelter



Picture shows the Theta T 3m Smoking Shelter – Theta T 3SS

DESCRIPTION

Theta Shelter complies with current UK Government Smoking Shelters Regulations, Office of Tobacco Control regulations Ireland and The Smoking, Health and Social Care (Scotland) – 50% of wall area open for ventilation. Act 2005.

CONSTRUCTION

Heavy duty construction with fully welded end panels 50% clad with 5mm thick transparent PET. Supplied with adjustable feet for bolting to concrete or extended legs for submerging into concrete.

DIMENSIONS

Overall width of shelter: 2100mm.
Height: (to front) 2100mm
Length: standard bays 3000mm, 4000mm or 5000mm.

INSTALLATION

Shelters have been designed for ease of installation and are supplied in a flat pack form with full technical installation instructions. Alternatively, a full nationwide installation service is available including groundworks. Please contact the sales office for further information.

OPTIONS AVAILABLE:

- THETA T 3 SS** – 3000mm Smoking Shelter
- THETA T 4 SS** – 4000mm Smoking Shelter
- THETA T 5 SS** – 5000mm Smoking Shelter



Pedestrian Waiting Shelters and Sport Dug Out Shelters



Picture shows an Alpha Pedestrian Shelter

DESCRIPTION

The above waiting shelter can be supplied with an all steel integral seat to the rear of the shelter

CONSTRUCTION

Heavy duty construction with fully welded end panels. Available with a combination of roof, back and end panels - 5mm thick clear PET or /and Platisol coated steel (P) roofing panels. Supplied with adjustable feet for bolting to concrete or extended legs for submerging into concrete.

DIMENSIONS

Single unit width: 1200mm **Height: (to centre)** 2184mm
Length: standard bays 4000mm or 5000mm

INSTALLATION

Shelters have been designed for ease of installation and are supplied in a flat pack form with full technical installation instructions. Alternatively, a full nationwide installation service is available including groundworks. Please contact the sales office for further information.

OPTIONS AVAILABLE:

Alpha P

Gamma T

Additional Bays

Shelters are modular and can be supplied in any length to suit application.

10 standard Polyester Powder Coated Colours are available for the framework. Please see colour chart on page 5.

End Panels (optional)

EP - 5mm thick transparent end panels



Helmet Lockers

PLASTIC LOCKERS

Cube lockers offer individual, personal security in the school or workplace. Ideal for external use, these cube lockers can be stacked together or bolted on top of other lockers for extra storage space. Available with a cam lock (supplied with 2 keys) or a hasp and staple or padlocking (padlock not supplied). Finish is Grey body available with a choice of colours for the door; blue, cream, green, grey, red or white.

DIMENSIONS

Height: 305mm
Width: 305mm
Depth: 305mm



WIRE MESH LOCKERS

1 bank of 2 nests of lockers offers 12 individual compartments ideal for the storage of cycle helmets. If these lockers are ordered in conjunction with the iR12 or R12 cycle racks and shelters, the racks can be manufactured to allow the lockers to stored beneath the shelter between the racks as shown in the photograph below.

DIMENSIONS

Height: 1980mm
Width: 305mm
Depth: 710mm



Cigarette Bins

FLOOR MOUNTED STEEL OR STAINLESS STEEL CIGARETTE BINS ARE AVAILABLE

Large Floor Mounted - CB1

Square Post Mounted Bin - CB2



Domed Roof Pram Shelter



DESCRIPTION

The Domed Roof Pram Shelter is ideal for the storage of pushchairs and prams. The shelter is supplied with 2 doors as standard in clear PET to provide optimal protection from the elements. Keypads are fitted to the doors as standard for access using a code.

CONSTRUCTION

Manufactured in heavy duty box section with 5mm thick transparent PET roofings, end and back panels.

DIMENSIONS

Length: 6000mm

Overall Width: 2100mm

Height to Front: 2700mm to highest point

Fixing: Either supplied with adjustable base plates to bolt to concrete or extended legs for root fixing into concrete.

Finish: Available in hot dipped galvanized or polyester powder coated.

Roofing: PET Transparent Cladding (5mm thick).

Shelters can be manufactured to any size to suit any area. Please call the Sales Office for a quotation.

INSTALLATION

Shelters have been designed for ease of installation and are supplied in a flat pack form with full technical installation instructions. Alternatively, a full nationwide installation service is available including groundworks. Please contact the sales office for further information.

10 standard Polyester Powder Coated Colours are available for the framework. Please see colour chart on page 5.



Theta Buggy Shelter/Pram Store

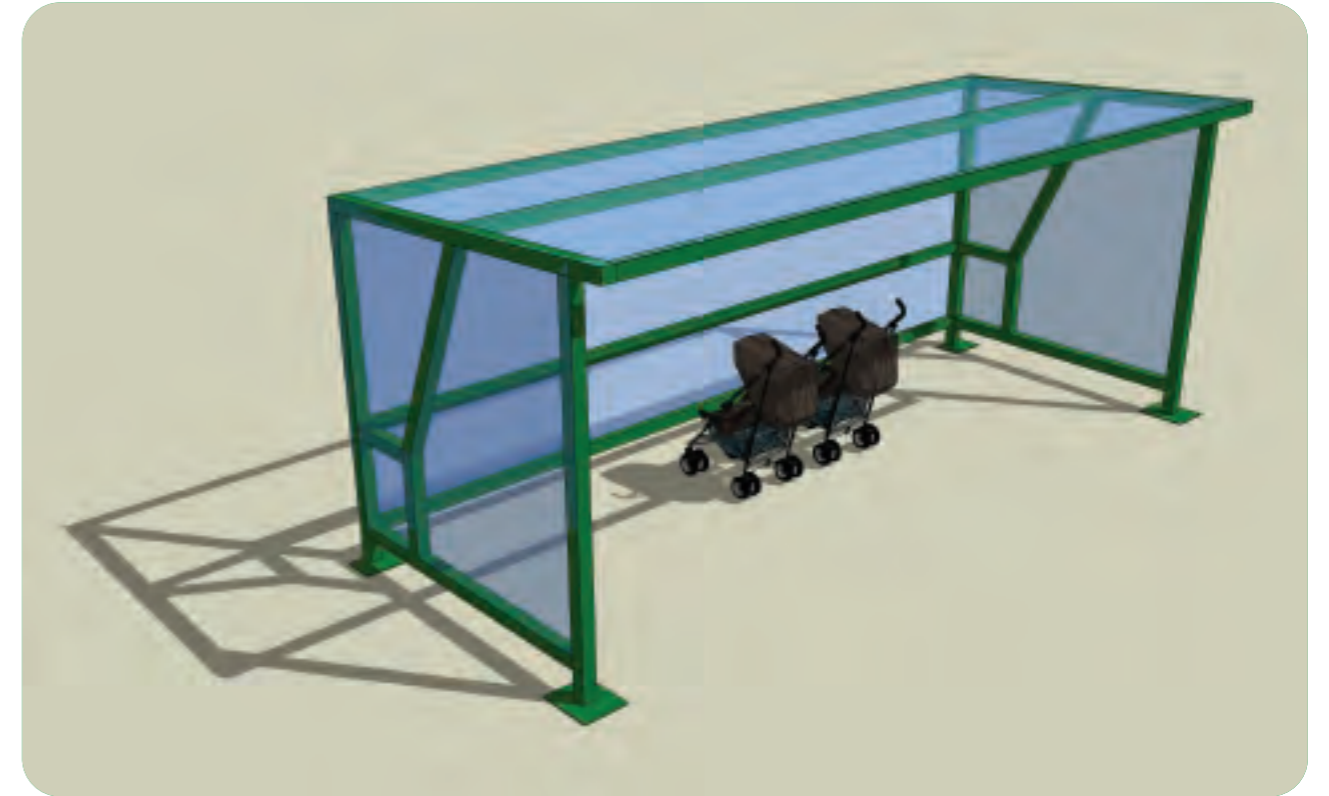

DESCRIPTION

The Theta Shelter makes an ideal pram store. It can be supplied with a locking rail at the back of the shelter so prams could be locked in position with a chain or 'D' lock or with lockable gates to the front of the shelter. These shelters can be made to fit any area.

CONSTRUCTION

Robust construction with fully welded end panels. Manufactured from Heavy duty box section. Roofing is Available in Plastisol coated steel or 5mm thick transparent PET.

Supplied with adjustable feet for bolting to concrete or extended legs for submerging into concrete.

DIMENSIONS

Overall width: 2200mm

Height: (to front) 2100mm

Length: 2085mm, 3085mm, 4085mm and 5085mm

INSTALLATION

Shelters have been designed for ease of installation and are supplied in a flat pack form with full technical installation instructions. Alternatively, a full nationwide installation service is available including groundworks. Please contact the sales office for further information.

OPTIONS AVAILABLE:

Theta P – Pram Shelter with no back or end panels

Theta T – Pram Shelter with no back or end panels

Additional Bays

Shelters are modular and can be supplied in any length to suit application.

10 standard Polyester Powder Coated Colours are available for the framework. Please see colour chart on page 5.

End Panels (optional)

EP – 5mm thick transparent end panels

BP – Back Panel Plastisol Coated Steel. Also available in Transparent PET at an extra cost.



KAPPA-SW Steel Seat with Hard Wood Slats
 Length: 1800mm
 Width: 600mm
 Height: 860mm
 Fixing: Surface mounting lugs or submerged fixing
 Finish: Hot dipped galvanized and polyester powder coated – see colour chart P5



KAPPA-AV Anti-Vandal All Steel Seat
 Length: 1800mm
 Width: 535mm
 Height: 800mm
 Fixing: Surface mounting lugs or submerged fixing
 Finish: Hot dipped galvanized and polyester powder coated – see colour chart P5



KAPPA-BW Steel Bench with Hard Wood Slats
 Length: 1800mm
 Width: 500mm
 Height: 400mm
 Fixing: Surface mounting lugs or submerged fixing
 Finish: Hot dipped galvanized and polyester powder coated – see colour chart P5



KAPPA PC Picnic Table with Hard Wood Slats
 Length: 1800mm
 Width: 1400mm
 Height: 750mm
 Fixing: Surface mounting lugs or submerged fixing
 Finish: Hot dipped galvanized and polyester powder coated – see colour chart P5



KAPPA-SPC All Steel Picnic Table
 Length: 1800mm
 Width: 1400mm
 Height: 750mm
 Fixing: Surface mounting lugs or submerged fixing
 Finish: Hot dipped galvanized and polyester powder coated – see colour chart P5



KAPPA-RC Recycled Plastic Bench
 Length: 1800mm
 Width: 500mm
 Height: 400mm
 Fixing: Base Fixed
 Material: Recycled plastic slats with mild steel powder coated legs



KAPPA-LB2 Steel Litter Bin
 Height: 800mm
 Diameter: 500mm
 Fixing: Surface mounting lugs
 Finish: Hot dipped galvanized and polyester powder coated – see colour chart P5
 Features: Galvanized Steel liner (locking on top)



KAPPA-LB3 Stainless Steel Litter Bin
 Height: 400mm (600mm if spigot mounted)
 Diameter: 375mm
 Fixing: Surface mounting lugs
 Finish: Satin or Mirror Stainless Steel
 Features: Galvanized Steel liner. Sides opening litter bins with anti vandal hinge mechanism. Doors fitted with slam locks



KAPPA-LB4 Stainless Steel Litter Bin
 Height: 700mm
 Diameter: 350mm
 Fixing: Surface mounting lugs
 Finish: Satin or Mirror Stainless Steel
 Features: Galvanized Steel liner (locking on top)

Stainless Steel



Street furniture can be supplied in stainless steel for a modern and stylish look. Stainless steel is rust-free making it ideal for low maintenance applications. There are two different grades of stainless steel available; grade 304 and grade 316. Grade 316 has a higher content chromium giving it a better resistance to corrosion, making it ideally suited to seafront locations.

Above and right are examples of some recent projects using stainless steel. Please contact the Sales Department for prices. Goods can be manufactured to suit your bespoke requirements.

Integral fully welded benches are integrated into the framework.



Omicron Youth Shelter

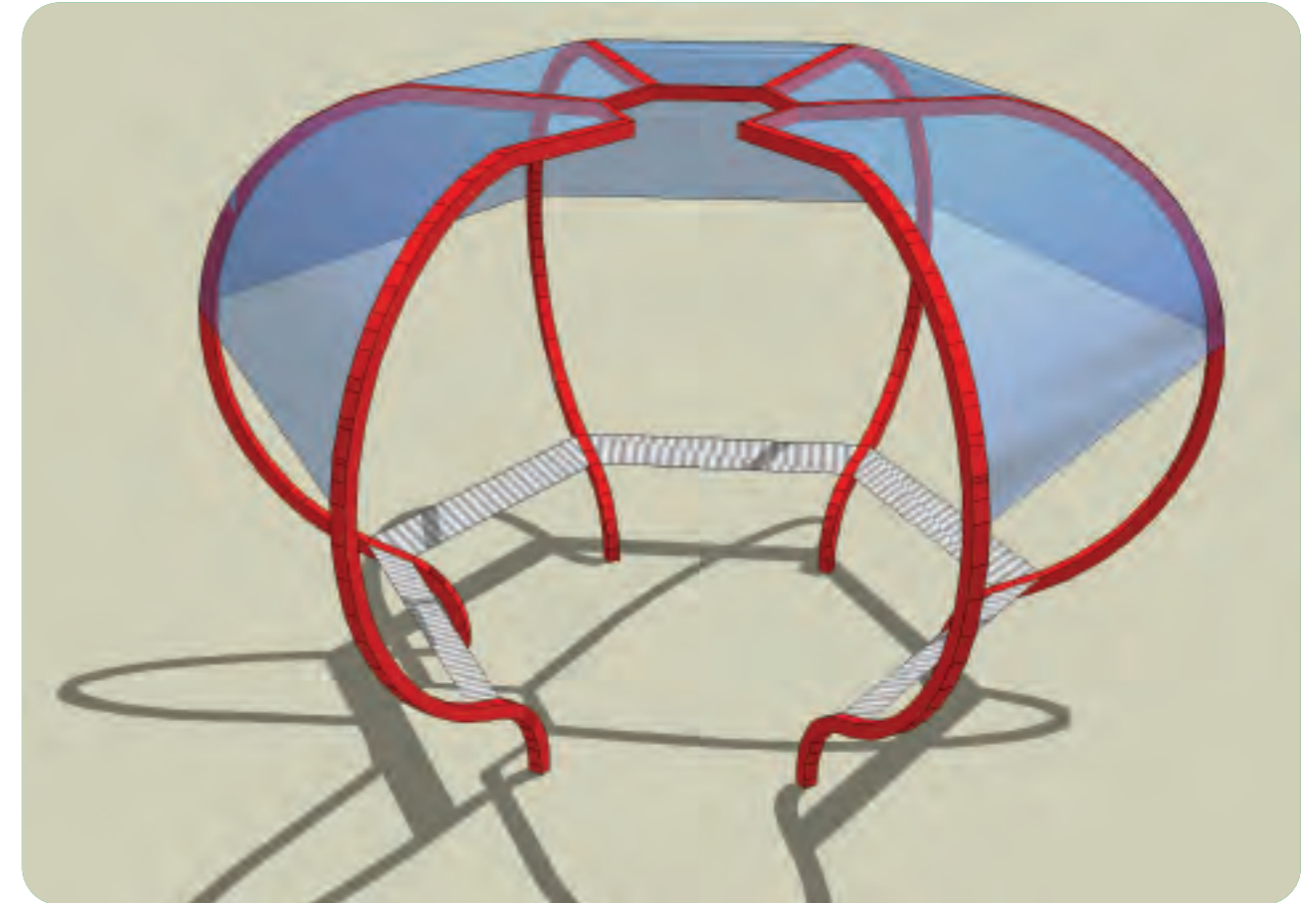

Picture shows Omicron Youth Shelter in a modern eye catching style. It has integral fitted seats designed for comfort which face each other when in modules so occupants are facing each other.

DESCRIPTION

Its modular design allows for various configurations and combinations to suit your site requirements.

CONSTRUCTION

This attractive, yet practical shelter can be produced in with 5mm thick transparent PET roof or solid galvanized powder coated steel roofing.

DIMENSIONS

Nominal Diameter - 4000mm

Nominal Height - 2100mm

Can be configured with a maximum of 5-segments fitted with bench style perch seats that can seat 3 teenagers.

INSTALLATION

Shelters have been designed for ease of installation and are supplied in a flat pack form with full technical installation instructions. Alternatively, a full nationwide installation service is available including groundworks. Please contact the sales office for further information.

OPTIONS AVAILABLE:

Omicron S – Galvanized Steel Roof Youth Shelter with Integral Seats

Omicron T – 5mm thick Transparent Roof Youth Shelter with integral seats

Additional Bays

Shelters are modular.

Please call the sales office for a full quotation.

10 standard Polyester Powder Coated Colours are available for the framework, please see colour chart on page 5.

Epsilon Youth Shelter

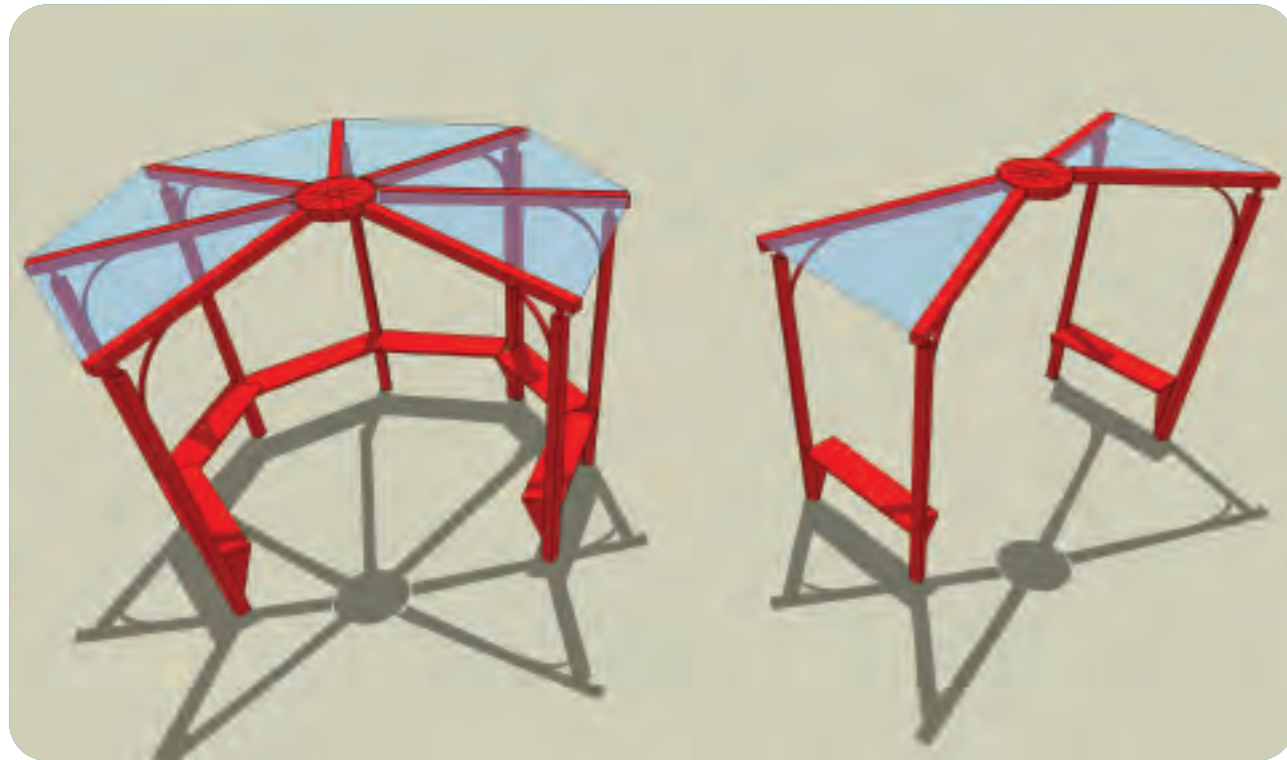

Picture shows Epsilon Youth Shelter

DESCRIPTION

Hexagonal Youth shelter available in various configurations to suit your site requirements. Integral seats are included and designed for comfort.

CONSTRUCTION

Robust, tough fully welded construction. Available with 5mm thick transparent PET roof or solid plastisol coated steel roofing.

DIMENSIONS

Nominal Diameter - 3000mm, 4000mm, 5000mm

Nominal Height At Centre - 2250mm,
2750mm, 2350mm

Nominal Height At Outside - 2100mm,
2100mm, 2100mm

Seating - 2 No. segments, 3-4 No. segments,
4-5 No. segments

INSTALLATION

Shelters have been designed for ease of installation and are supplied in a flat pack form with full technical installation instructions. Alternatively, a full nationwide installation service is available including groundworks. Please contact the sales office for further information.

CONFIGURATION

Can be configured from a minimum of 2-segments to a maximum of 7 segments with round perch seats. (Drawing shows 6 segments).

Extra Segments can easily be added at a later date.

Can Be Manufactured To Any Diameter up to 14mtr.

Anything Greater Than 5mtr Will Require A Centre Post.

OPTIONS AVAILABLE:

Epsilon C - 16mm Triple Wall Polycarbonate Roof Youth Shelter with integral seats

Epsilon T - 5mm thick Transparent Roof Youth Shelter with integral seats

Additional Bays

Shelters are modular.

10 standard Polyester Powder Coated Colours are available for the framework. Please see colour chart on page 5.

Sunburst Youth Shelter



Picture shows Sunburst Youth Shelter

DESCRIPTION

Youth shelter with open sides giving all round visibility. Integral fully welded seating with back restraints. Centre post complete with radial seating or table.

Can be configured from 2 segments to a total of 5 segments.

Extra Segments can easily be added at a later date.

Each segment fitted bench seats (with back rest) with can comfortably accommodate 4 adults or 5/6 children.

Seating on the centre post can accommodate a further 5 adults.

CONSTRUCTION

Robust, vandal resistant construction with solid steel roofing panels.

DIMENSIONS

Nominal Diameter - 5500mm

Nominal Height At Centre - 2350mm

Nominal Height At Outside - 2050mm

Total Seating - Adults - 24

Total Seating - Children - 30-35

INSTALLATION

Shelters have been designed for ease of installation and are supplied in a flat pack form with full technical installation instructions. Alternatively, a full nationwide installation service is available including groundworks. Please contact the sales office for further information.

OPTIONS AVAILABLE:

Sunburst S - Galvanised Steel Roof Youth Shelter with integral seats

Sunburst T - 5mm thick Transparent Roof Youth Shelter with integral seats

Please call the sales office for a full quotation.

10 standard Polyester Powder Coated Colours are available for the framework. Please see colour chart on page 5.



All walkways and canopies are designed in accordance to with BS5950 (Structural use of steelwork in buildings) by an in-house drawing team.

Our designers can create a bespoke design dependent upon our customers' individual site requirements.

Canopies are also an excellent way to provide shade in playgrounds, ether to cover external seating or provide shade whilst children are queuing.

A site surveyor can attend site, free of charge to measure up the area and provide a full quotation. This can include all necessary ground works and installation costs, if required.

On receipt of order CAD drawings will be supplied for your approval. Once the drawings are approved this will then go into fabrication.

The range of framework colours can be found on P5 of the catalogue.

The roofing available for the walkways and canopies are as follows:-

> **PET Cladding – as shown on P5**

Which is supplied as standard in 5mm transparent PET, however, is available in 5mm Opal, Smoke Grey Tinted and Bronze Tinted PET.

For flat roofs and shallow curves Clear and Opal PET is also available in 8mm thick

> **Plastisol Coated Steel – as shown on P5**

> **Filon GRP Cladding**

Filon is a Glass Reinforced Polyester (GRP) available in a choice of Opaque or Translucent finish. This option offers good UV resistance and is an extremely strong cladding. It also complies with the UK Building Regulations and BS476 Fire tests.

> **Triple Wall Polycarbonate**

16mm triple wall poly is available in clear, bronze and opal. Polycarbonate carries a 10-year warranty covering loss of light transmission and loss of strength due to weathering.

SITE SELECTION

Things to consider when positioning cycle/motorcycle storage

- > Ease of access, are they in a prominent position near an entrance
- > Is there lighting, if not anti vandal lighting can be provided
- > Is there CCTV surveillance, and if so transparent roofing for the shelter maybe a consideration
- > Which direction the wind tends to prevail so the shelter can be positioned against that direction
- > Are the shelters visible by security guards, staff or passers by

STAND INFORMATION AND SPACING

The Sheffield Style of stand is the preferred style of cycle parking for the majority of cyclists. The bike is well supported and it is easy to lock the bike frame and wheel to one of the supports. Also, it is economical, as two bikes can be parked onto one stand.

All the stands shown in the catalogue are based on the Sheffield Style Design. Other front wheel supports can be supplied on request.

RECOMMENDATIONS FOR THE SPACING

The recommended spacing depends not only on the end user but also the space available for the positioning of the cycle stands. A minimum of 700mm allows sufficient spacing for 2 cycles positioned per stand, however, some users find this can make it slightly awkward to stand between. Some cycle organisations recommend a spacing of 1000mm between stands. With this in mind we have listed the racks separately within the catalogue, which can be supplied with centres from 700mm – 1000mm.



Apex Fabrications

Unit 12, Ringtail Road,
Burscough Industrial Estate,
Burscough, L40 8JT

Apex Shelter Systems reserve the right to make modifications to the design, specification or prices without prior notification. Company Conditions of Sale available upon request.