

JOHNSON



technical

SUPPORT SERVICES

JOHNSON

technical index

	04	introduction
TECHNICAL	06	overview
	08	cad
	10	visualisation
	12	guidance
	13	dda
	14	support materials

overview
06

cad
08

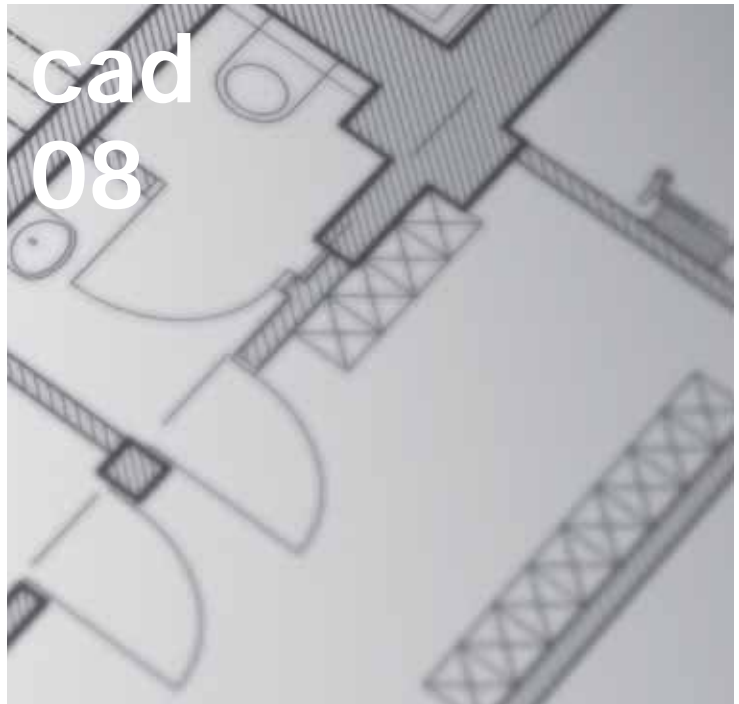

visualisation
10



guidance
12

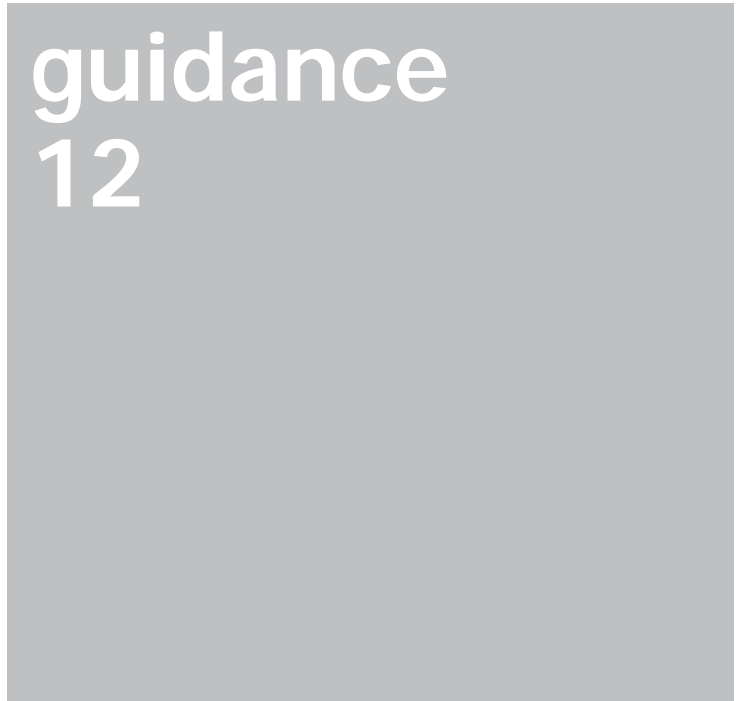

dda
13



support
materials
14

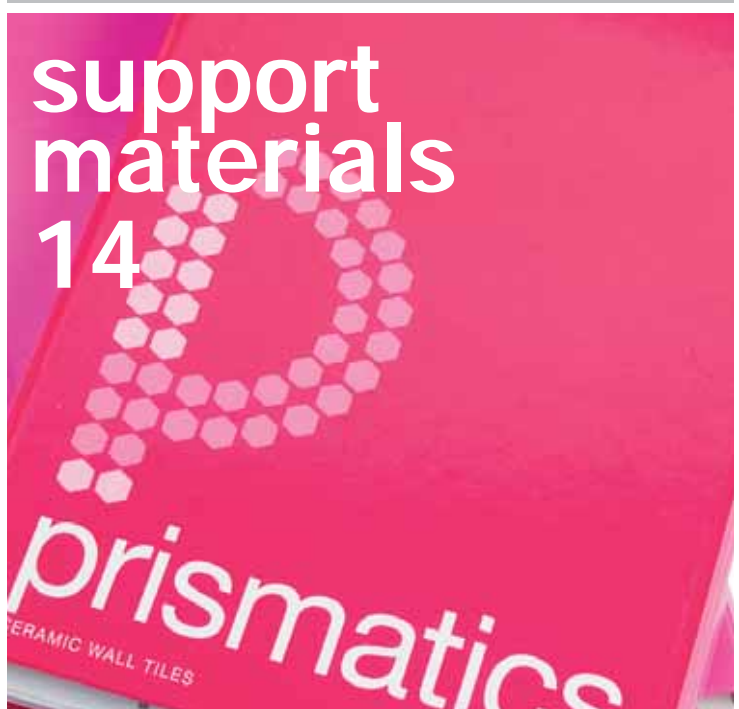

introduction

company credentials

Founded in 1901 H & R Johnson Ltd. is the leading manufacturer and supplier of ceramic tiles in the UK, with a long history of market leadership and industry production development.

Part of the Norcros Group we have sister manufacturing bases in South Africa, Greece and India with additional offices in Dubai, USA and Australia.

In 2001 an investment in excess of £35 million allowed us to develop a new fully automated production facility on a single integrated site in Stoke-on-Trent.

Our UK factory produces over 5 million square metres of ceramic tiles for use in the UK and overseas markets.

H & R Johnson products are used in a wide range of commercial and non commercial projects and we supply ceramic tiles to almost every country of the world.

Our strength is based on a comprehensive portfolio of leading edge quality products combined with very high levels of customer service. As manufacturers we have extremely stringent quality and environmental control standards.

In 2006 we created and opened the award winning Material Lab design resource centre at 10 Great Titchfield Street, London, offering designers and architects an environment where products such as ceramics, glass, wallpaper, carpet tiles, trims, eco-resins, fabrics and many more materials can be explored.

We have a longstanding commitment to environmental management and have had a formal environmental policy since 1992. Our environmental management system is certified against the ISO14001 standard.

We were the first ceramics company within the whitewares sector to gain certification against the ISO14001 standard in 1998 and have since successfully upgraded our certification to meet the latest requirements of ISO14001:2004. We are the only UK wall tile manufacturer to have ISO14001 accreditation.

The company has never been subject to any prosecutions or formal environmental regulatory action for any breaches of environmental legislation.

In 1997 H & R Johnson were awarded the Queens Award for Environmental Achievement for our ceramic waste recycling scheme.

To our knowledge we are the only manufacturer in the world to operate such a scheme. This scheme which has been in continuous use since 1992 also enabled H & R Johnson to win the Manufacturing Industry Achievement Award for Environmentalist of the Year in 1997.

Approximately 25% of the material used to produce our wall tiles comes from recycled ceramic materials from our own and other local companies.

Various recycling and energy saving schemes throughout our production and office processes allow us each year to:-

Save 20,000 tonnes of ceramic landfill from our own and local ceramic factory waste saving 360 tonnes of CO₂ in transportation costs

Save 1250 tonnes of virgin timber

Use 92% recycled materials in our packaging

Re-use 32 million litres of water (30% of the total factory usage)

Save 42 million kWh of energy

Save 2400 tonnes of CO₂

Our energy and material savings are detailed in our "Ceramic Tile Environmental Strategy" document.



Recycling - responsible manufacturing



Material Lab - London

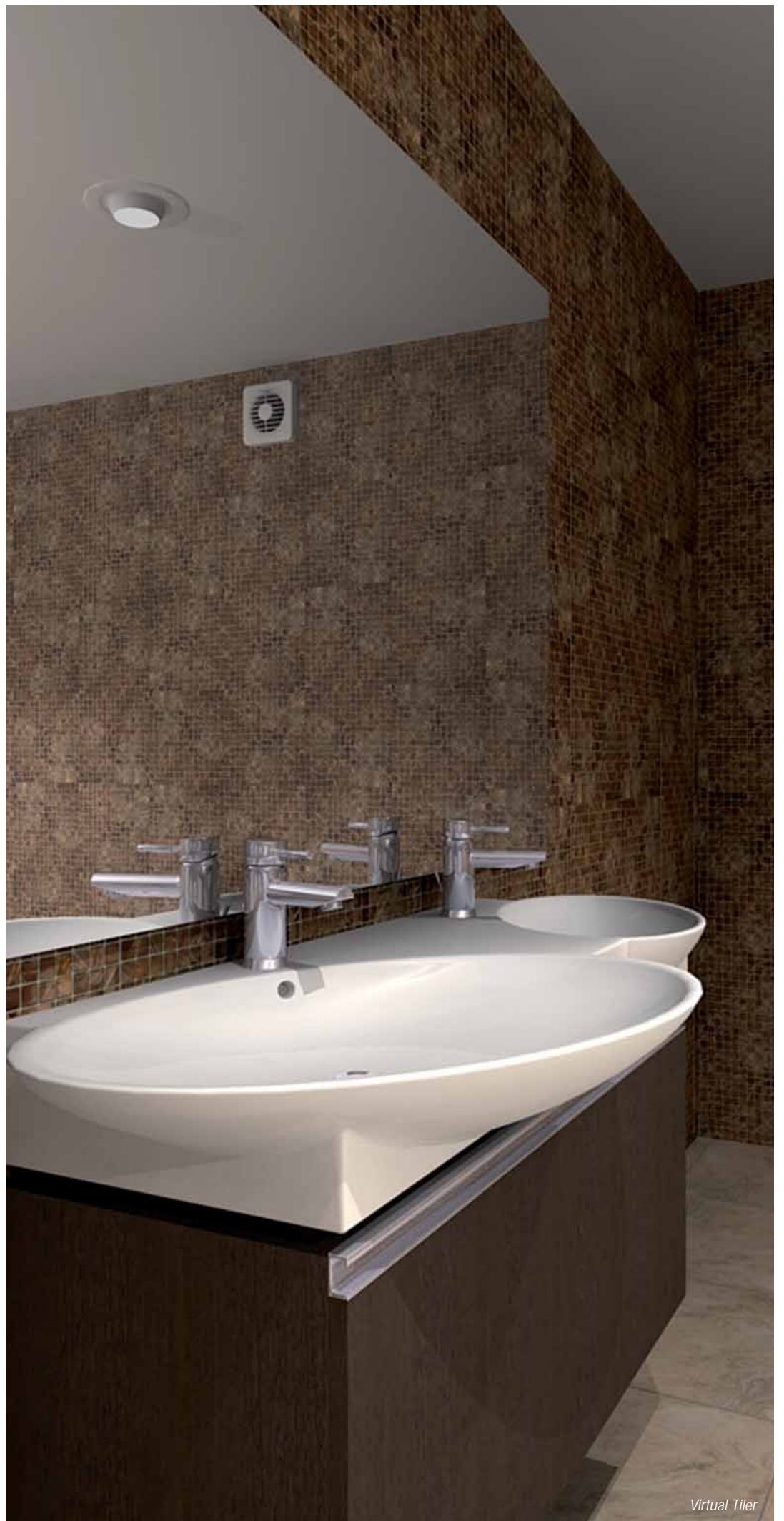

Virtual Tiler



prismatics

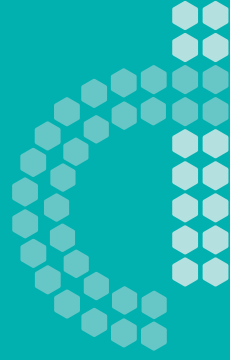

decorative



kerastar



elements



pools



ceramic mosaic



glass mosaic



art ceramics

H & R Johnson Tiles Ltd are the UK's largest producer of ceramic tiles and have been manufacturing ceramic tiles in Stoke-on-Trent for over 100 years. Products such as Opal White have been in continuous production for over 40 years. We have a long history of product consistency and also product innovation.

Our range of commercial products covers almost every conceivable aspect of ceramic tile requirement from small glass mosaics to large format 1200 x 600mm rectified porcelain floor tiles and from heavy duty textured floor tiles to delicate metallic decorated wall tiles.

Products for the commercial specifier are split into 8 separate categories:

Prismatics – a range of 92 colours in 7 sizes ranging from small format 100 x 100mm to large format 600 x 300mm wall tile products. The range is supplemented by a comprehensive package of ceramic fittings available in most colours.

Decorated Products – a collection of over 100 wall field tiles and 50 borders in sizes ranging from small format 100 x 100mm to large format 600 x 300mm.

Kerastar – un-glazed porcelain floor and cladding tiles available in 33 colours, 5 sizes and 7 surface finish options supported by a comprehensive fittings package of coves and step edgings. Sizes range from small format 100 x 100mm to medium format 300 x 300mm. Finishes include 6 enhanced slip resistance textures suitable for wet barefoot areas.

Elements – a range of un-glazed porcelain floor and cladding tiles available in 7 sizes, 6 surface finishes and 37 colours. Products range from medium format 300 x 300mm to large format 1200 x 600mm. Finishes range from heavily textured slip resistant products to fully honed and polished surfaces with a colour palette that replicates naturally occurring stones and marbles.

Pools – industry standard 250 x 125mm format glazed porcelain tiles and extruded pool fittings for almost any swimming pool requirement. Architectural tiles are available in 5 standard pool colours as plain or gritted tiles. An additional palette of colours creates a range of frost resistant cladding tiles. Pool fittings are available for almost any type of pool or pool detail.

Ceramic Mosaic – more than 250 products in 14 ranges varying from 17 x 17mm mosaic to 50 x 50mm and mixed size mosaics. Products are all glazed or un-glazed porcelain with products suitable for almost any application type.

Glass Mosaics – over 100 products in 7 ranges varying from 20mm square glass mosaic to randomly shaped and sized glass droplets individually hand placed for accuracy. Most of the product designs in our glass mosaics portfolio are unique in the UK marketplace.

Art Ceramics – our collection of bespoke products created by digital imaging or water jet cutting. Our Artile photographic tile products are fully fade, UV and scratch resistant and suitable for all wall, cladding and pool lining environments. Water jet cutting offers the ability to create low cost bespoke murals, friezes or shapes from any of our standard wall or floor tiles.

technical cad

Usage of the most up to date Autocad and Microstation software allows our inhouse team of experienced CAD designers to produce bespoke layout drawings for all sizes and types of commercial projects. Fixing layouts for easy on-site installation or design drawings for client approval can be created from .dwg, .dxf or .dgn files and drawings can be output as high res pdf's or coloured paper copies for client approval.

The CAD service is supplemented by our Virtual Tiler visualisation service and Bills of Quantities calculation service.

These, combined with NBS specification writing, COSHH data sheets and product data sheets represent the most comprehensive support service for UK ceramic tile specification.

Email technical@johnson-tiles.com or telephone the Technical Helpline 0845 210 3000 for further information.

cad

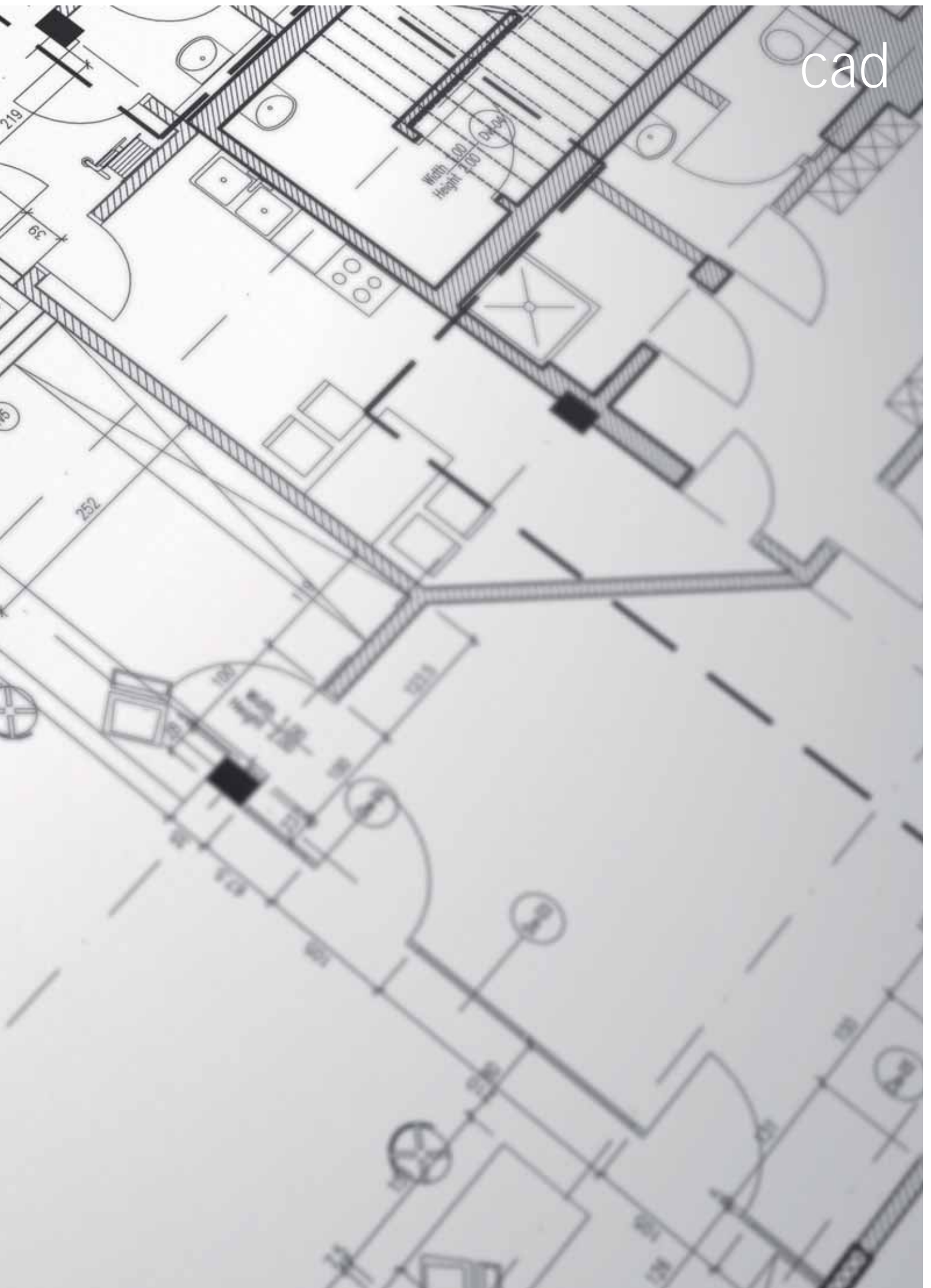

visualisation



technical visualisation

The introduction of our Virtual Tiler service allows the creation of photo realistic 3D images for client approval of tiling schemes. Virtual Tiler is a true 3D system which allows 360 degree views of your chosen room or rooms. The incorporation of realistic lighting and ancillary products completes this un-rivalled visualisation tool to the ceramic industry.

Images can be supplied as pdf's or printed copies.

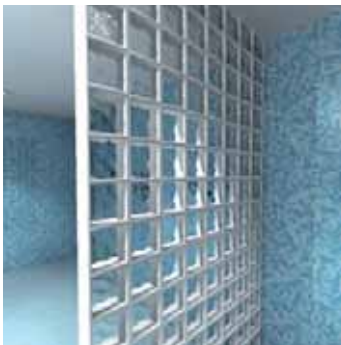

installation

Our technical helpline team have over 100 years combined experience in the ceramic tile industry and are on hand to answer your queries on commercial tile specification.

COSSH and Product Data sheets as well as cleaning and maintenance guidelines for O & M manuals are also available upon request for commercial projects.

Please contact technical@johnson-tiles.com or the Technical Helpline on 0845 210 3000 for further information.

For the reassurance of single source supply we offer a free of charge NBS M40 specification writing service featuring the Johnson Professional range of tile fixing products for all commercial projects.

Full details can be obtained by phoning the Johnson Professional Helpline on 0870 609 2851.

certification

All product technical values quoted in our literature are supported by laboratory testing from our own and independent ceramic test houses. We are a British Standard registered firm and all products conform to the relevant standards set out in BS EN 14411 (formerly BS6431). Copies of test certificates for slip resistance to aid in the specification of fit for purpose products are available by special request (please email technical@johnson-tiles.com).

understanding dda - disability discrimination act

The Disability Discrimination Act 1995 (DDA) introduced new measures to prevent discrimination against disabled people. The Act was broadened in 2005 to form the current Disability Discrimination Act 2005.

The DDA requires accessible environments to be provided for disabled people, either in their place of work or for access to goods, services or facilities (public spaces). Those commissioning new buildings or adaptations to existing buildings must consider the implications of the DDA and their ability to provide buildings that do not discriminate against disabled people (physical or mental impairments).

When specifying ceramics there are 2 main areas of relevance within the DDA.

Colour Reflectance (Contrast)

The DDA gives guidance on good visual contrast for the visually impaired between various elements of a building by the use of Light Reflectance Values (LRV).

LRV is a general term for contrast and is measured as the proportion of useful light reflected by a coloured object, floor, wall or ceiling. LRV is measured on a scale of 0 to 100 where 0 is perfect black and 100 perfect white (in reality 0 and 100 are unobtainable colours). According to NCS Colour Centre in practical terms black is approx 6 and white approx 85.

The current guidelines from Building Regulations Approved Document M on contrast are that a minimum difference of 30 LRV points should be specified for adjacent surfaces to ensure that visually impaired people are not discriminated against. In the specific example of ceramic tiles this difference should be between:

Floors to walls

Ceiling to walls

Handrails to walls

Sanitary fittings to walls

Visual contrast between floors and walls is important in enabling visually impaired people to assess and gauge the size and shape of a room. It is important that the greatest visual contrast occurs where the floor meets the wall (skirting) as this gives the most accurate visual indication of the extent of the room. Where provided, skirtings should contrast visually with the floor and be similar in colour and tone to the wall surface.

Tactile Foot Braille (*see Kerastar or Elements literature for details*)

Recommendations from the Department of the Environment, Transport and the Regions (DETR), the joint mobility unit of the RNIB and the Centre for Accessible Environments (CAE) led to the need for Tactiles to be used as warning features for stairs, ramps and platforms.

Available in 400x400x10mm format and in 2 colour options the Johnson Tactile System offers compliance with not only the DDA requirements but also the DETR, RNIB and CAE recommendations. Specified correctly the Johnson Tactile System will ensure that any new building Access Audits will be compliant with the Access to Goods and Services part of the DDA.

The Johnson Tactile System is manufactured to the highest technical and performance standards. The surface of the Tactile products have the enhanced performance qualities of a slip resistance durandum inclusion in the surface of the tile.

The Corduroy profile is designed to warn visually impaired people of the presence of specific hazards. Such a profile is "Foot Braille" and is a warning associated with steps, ramps or the approach to on-street light rapid transit platforms. The Corduroy profile is an internationally accepted Tactile surface that conveys the message of hazard and implies proceed with caution.

The Blister profile is designed to warn visually impaired people of the edge of all off-street platforms. The profile consists of a series of offset, flat topped dome studs. The parallel rows of studs are designed to be installed at right angles to the direction of traffic and are normally located behind the platform edge coping.

This information is not exhaustive and the requirements at the time of specification must be checked.

BS8300:2001 Amendment 1 indicates that there is anecdotal evidence to suggest that a 20 point LRV difference may be sufficient – especially where large adjacent areas are involved.

It must be noted that the guidance on LRV values given in this brochure is correct at the time of print. This is a subject that may be reviewed by the regulatory body at any time so it is advisable to check the guidelines at the time of specification of product.

The DDA details given in this brochure are to be used as an outline guide only and are the details as H & R Johnson understand them at the time of print. If in doubt of any details contained herein the Act should be read in full.

support materials

We have the most comprehensive package of sample wallets, handboards and other support materials available to the UK specification market. Most of our ranges are available as real tile samples in bespoke and standard sample wallets with easy to follow navigation which also incorporates relevant technical information.

Our bespoke literature details all the information required for peace of mind fit for purpose specification such as technical conformance charts, slip resistance values (where applicable) in addition to the most

comprehensive and detailed colour notation and Light Reflectance referencing of any ceramic tile supplier.

For specific handboards or sample wallets please contact your sales manager or email: technical@johnson-tiles.com.



general information



Environmental Management

H & R Johnson Tiles Limited, Harewood Street, Tunstall, Stoke on Trent has achieved ISO 14001 for Environmental Management Systems at its Stoke on Trent factory.



Fitness for Purpose

For specific suitability and fitness for purpose details contact the Technical Hotline or visit the website www.johnson-ceramics.com

Important

During the course of manufacture of all ceramic tiles some variation in shade or pattern can occur. Before fixing tiles several cartons should be opened and the contents mixed to ensure that the size, shade, colour and patterning are acceptable.

H&R Johnson cannot accept responsibility for any tiles that have been fixed.

Nothing in these statements does or will affect the statutory rights of the consumer.

Samples Tel: 01782 524064

Fax: 01782 524138

Email: techsales@johnson-tiles.com

Technical Helpline Tel: 0845 210 3000

Fax: 01782 524138

Email: techadvice@johnson-tiles.com

International Technical Helpline:

+44 (0) 1782 524067

www.johnson-ceramics.com

H & R Johnson recommend the use of adhesives and grouts from the Johnson Professional range. For further information and a detailed fixing specification please contact 0870 609 2851.

Every effort has been made to ensure the accuracy of the information given in this literature. In the interests of progress, however, H & R Johnson reserve the right to change specifications and availability without prior notice.

Acknowledgements

H & R Johnson would like to thank the companies who have helped in the production of this publication.

Design & Artwork: Idiom Creative Ltd.

Print: Wood Mitchell Printers

technical helpline:

0845 210 3000

JOHNSON

H & R Johnson Tiles Limited, Harewood Street,
Tunstall, Stoke on Trent ST6 5JZ.

T: **01782 575575** F: 01782 577377

www.johnson-ceramics.com

MATERIAL LAB

10 Great Titchfield Street, London W1W 8BB

T: **020 7436 8629** F: 020 7436 9031

E: info@material-lab.co.uk www.material-lab.co.uk

Middle East Office, H & R Johnson, PO Box 50518, Dubai, United Arab Emirates.
Tel ++97 14 398 6004 Fax ++97 14 398 7066

Johnson Tiles (Pty) Ltd, Olifantsfontein, South Africa.

Johnson Tile (Pty) Ltd, Bayswater, Victoria, Australia.

Philkeram Johnson s.a., Thessaloniki, Greece.

H & R Johnson (India) Ltd, Mumbai, India.

A Norcros company

® H & R Johnson, Johnson and Material Lab are registered trade marks.
™ All product names are the trade marks of H & R Johnson Tiles Ltd.

All Rights Reserved.

Printed in England 2007

