



# VESTRA 2000

## TRANSLUCENT LOUVRE VENTILATOR



The Vestra 2000 is a louvre ventilator that can be used to provide replacement inlet air for smoke control systems. It can also be used for day to day ventilation in natural ventilation systems. The Vestra 2000 has been specifically designed for use in vertical applications and can be provided with single glazed louvres or double glazed insulated louvres. The stylish window ventilator is ideally suited for use in predominantly glass structures.

The variety of versions makes the Vestra 2000 an excellent choice for shopping centres, offices, atria and industrial buildings.

### MATERIAL



The frame of the Vestra 2000 is produced using a fully thermally broken aluminium profile. The louvre blades are available in both single glazed and double glazed versions. In the double glazed version the louvre blades incorporate mohair seals and rely on direct glass on glass contact between the louvres. In order to optimise the opening settings required, the Vestra 2000 louvres are central pivoting.

### OPTIONS



The Vestra 2000 ventilator is fitted, as standard, with fixed side, top and bottom flanges of 20mm. The thickness of the flange can range between 2mm and 30mm.

The Vestra 2000 ventilator is available in a wide variety of glass types and heights. Non-standard dimensions are offered and are available on request.

# VESTRA 2000

## TRANSLUCENT LOUVRE VENTILATOR

### VERSIONS

The Vestra 2000 is available in two versions.

#### Single glazed

**Frame:** The unit is fitted with an extruded aluminium thermally broken frame.

**Louvres:** The blades incorporate single glazed hardened glass. Depending on the width of the window the glass thickness will be 6mm, 8mm or 10mm. There are no seals on the louvre blades.

#### Double glazed

**Frame:** The unit is fitted with an extruded aluminium thermally broken frame.

**Louvres:** The louvre blades are fitted with a thermally broken insulated glass. Various types of glass can be accommodated; however the glass thickness is always 24mm. Mohair seals are provided between the ventilator louvres



### OPERATION

The Vestra 2000 ventilator can be operated in several ways:

- Double-acting compressed air cylinders
- Electric 24 Volt (24 Vdc / 0-10V) actuators
- Manually

### DIMENSIONS

Rectangular forms are available with the following limitations:

- Minimum size – 400mm x 700mm (width x height)
- Maximum size – 1600mm x 3000mm (width x height)
- Minimum 3 louvre blades
- Non-standard dimensions are available on request



### DETAILS

As the height of the louvre sections can vary depending on the size of the ventilator, filler sections are not required. This makes the unit aesthetically pleasing and also assists its aerodynamic efficiency. (Louvre blades are available from 100mm to 300mm).

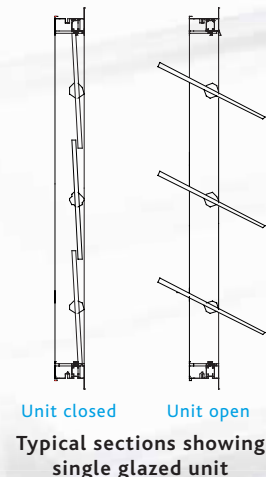
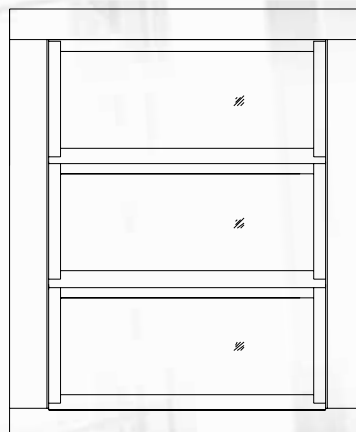
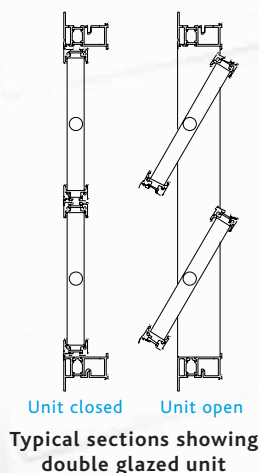

Due to a policy of continuous improvement, alterations in the specifications may be made at any time without notice. The company accepts no responsibility for any discrepancies which may occur between the specification of its equipment and the descriptions contained in its publications.

### McKENZIE MARTIN LIMITED

ETON HILL WORKS, ETON HILL ROAD, RADCLIFFE, MANCHESTER, M26 2US

TEL: 0161 723 2234 FAX: 0161 725 9531 EMAIL: [general@mckenziemartin.co.uk](mailto:general@mckenziemartin.co.uk) WEB: [www.mckenziemartin.co.uk](http://www.mckenziemartin.co.uk)