

NationPlus FDA

External steel doors



Door leaf

Thickness: 54mm

Material: 1.2mm corrosion resistant Zintec/Aluzinc sheets as standard, wide variety of colours and finishes available. Also in Stainless Steel.

Infill: Self supporting resin-impregnated honeycomb core as standard. Optional infills include mineral wool, polyurethane or solid timber.

Construction: Doorblade manufactured from two 1.2mm sheets lock-formed together, by bonding skins around a rigid core, using a no-weld construction.

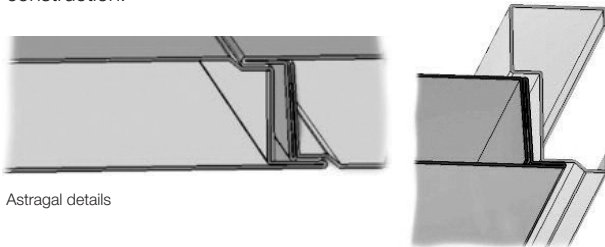

Astragal details

Door frame

Construction: Folded from 1.6mm Zintec/Aluzinc. Screw and tab construction with 4 no. adjustable fixing feet per jamb, variable sub-frame supplied as standard to accommodate site of tolerance -0/+30mm. The frame is fitted with 3 no. dog-bolt hinges as standard.

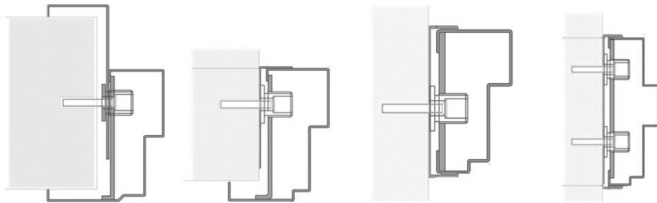

Threshold

Standard: 15mm Aluminium.

Optional: 5mm driveable (DDA compliant). 15mm rebated.

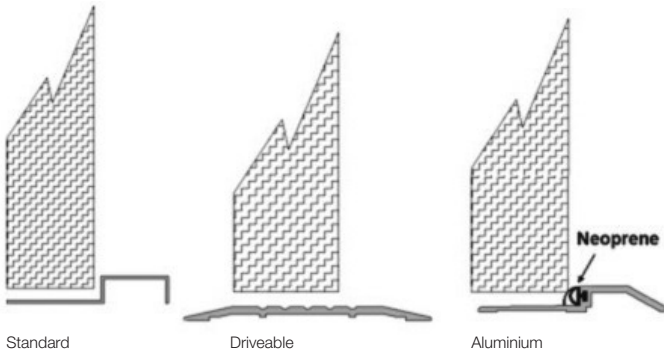

Standard

Driveable

Aluminium



Thermal

Depending on construction and infill, U-values as low as 1.6 W/m²K are achievable.

Finishes

Standard: Polyester Powder Coated from standard colour range.

Optional: Polyester Powder coated from non-standard colour range.

PVC laminate from standard range.

Woodgrain PVC laminate.

Stainless steel, brushed, polished or patterned.

Unfinished for site finishing.

Sizes

Doors are custom manufactured in 10mm increments for single openings 690mm to 1300mm and double openings 1290mm to 2600mm, at heights up to 2900mm.

Panel arrangements

Construction: Panels can be solid, glazed or louvred.

Sizes: Standard side panels are available up to 1340mm wide x 2900mm high.

Standard over panels are available up to 1340 x 2900mm (single door) or 1340 x 2600mm (double door).

Options: Hinged panels. Removable, flush, glazed or louvred are all available.

Contact Stemko Group with your specifications.

Louvre panels

Construction: Standard louvre offers 50% air flow with louvre blades constructed to stop birds. Frames are 1.2mm thick and blades 0.7mm.

Options: Fly mesh available as an optional extra, also custom sizes.

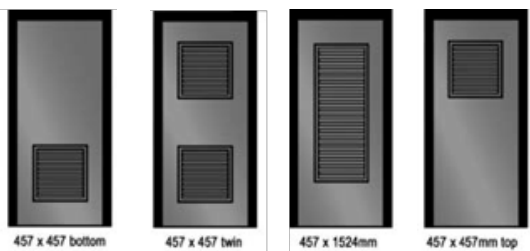

Vision panels

Guidance Notes: To comply with Building Regulations, Part M doors across circulation routes should have visibility glazing. (Vision panels less than 50% of the total door area are exempt from Part L of the Building Regulations.)

Construction: Welded construction from 1mm cold rolled steel, screwed together from one side.

Options: Standard glazing is 6.4mm clear laminate. Alternative options include 6mm GWPP or a 19mm double glazed unit (6.4/6/6.4mm laminate). Custom sizes and glass available to customer requirements.

