

m-tec

Specialist metal fabricators and consultants

Case Studies

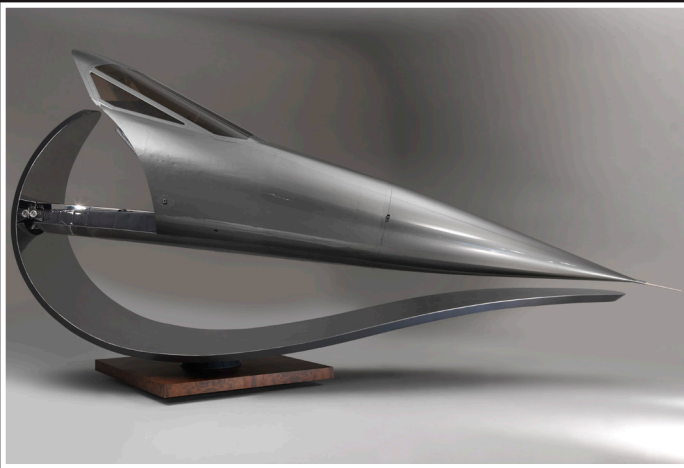
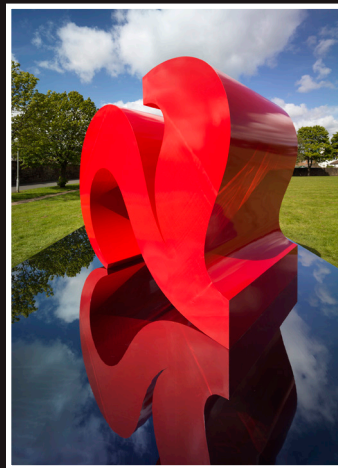

SUN MOON & TWO HEARTS



Project: Sun Moon & Two Hearts

Artist: Jephson Robb

Location: Glasgow

m-tec were chosen by public artist Jephson Robb to manufacture two eye-catching sculptures which have now taken pride of place outside Gartnavel Royal Hospital in Glasgow. The monuments reflect the experiences and stories of those using the hospital's mental health services.

The Sun-Moon sculpture is made up of a two and a half metre convex diameter circle with two different sides to represent the contrast between the Sun and the Moon. It draws its inspiration from the hospital motto 'Let there be Light Again'.

One blasted stainless steel side features highly polished dished sections to reflect the shape of the Moon, and the opposite side is made of a highly reflective, polished mirror to represent the Sun.

The Two Hearts sculpture, which is made from 316 grade stainless steel and was powder coated in-house sits on a four metre mirror-polished reflective platform to support it.

These sculptures will serve as a legacy to the past 200 years of the hospital, and point forward to 21st century mental health care and the role which the arts has to play in supporting and promoting the recovery of those living with ill mental health.

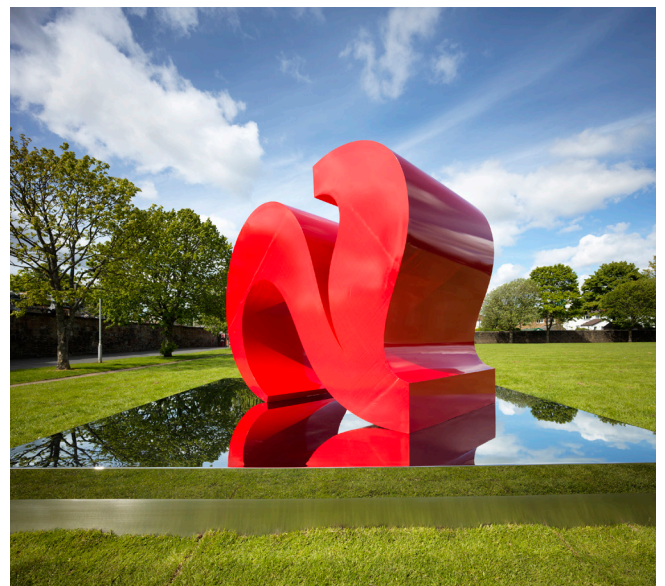

THE ABERTILLERY GATEWAY



Project: The Abertillery Gateway
Artist: Blaenau Gwent County Borough
Location: Abertillery, South East Wales

m-tec manufactured the six super satin finished stainless steel spires as part of the Abertillery Gateway Feature to represent the historic locations of former colliery sites from the surrounding area.

Working alongside Dawnus Construction who prepared the foundations for the project, we fabricated the six 8mm thick spires in two sections which were then welded together to create heights ranging from fourteen to seventeen metres.

The spires, which are made from grade 316 stainless steel with a diameter of 450mm are also fully fitted with IP 67 LED colour changing luminaires – supplied by Anolis Lighting – to create the stunning effect which penetrates through the cut outs and adds to the ambience of the project.

Each spire also has a stainless steel base plate which has been engraved with the name of the colliery it is representing.

As part of a competition, local schools were given the opportunity to produce sketches, poems or short stories to represent past and present memories. The winning designs were then engraved onto sixteen stainless steel plaques on the stone retaining wall.

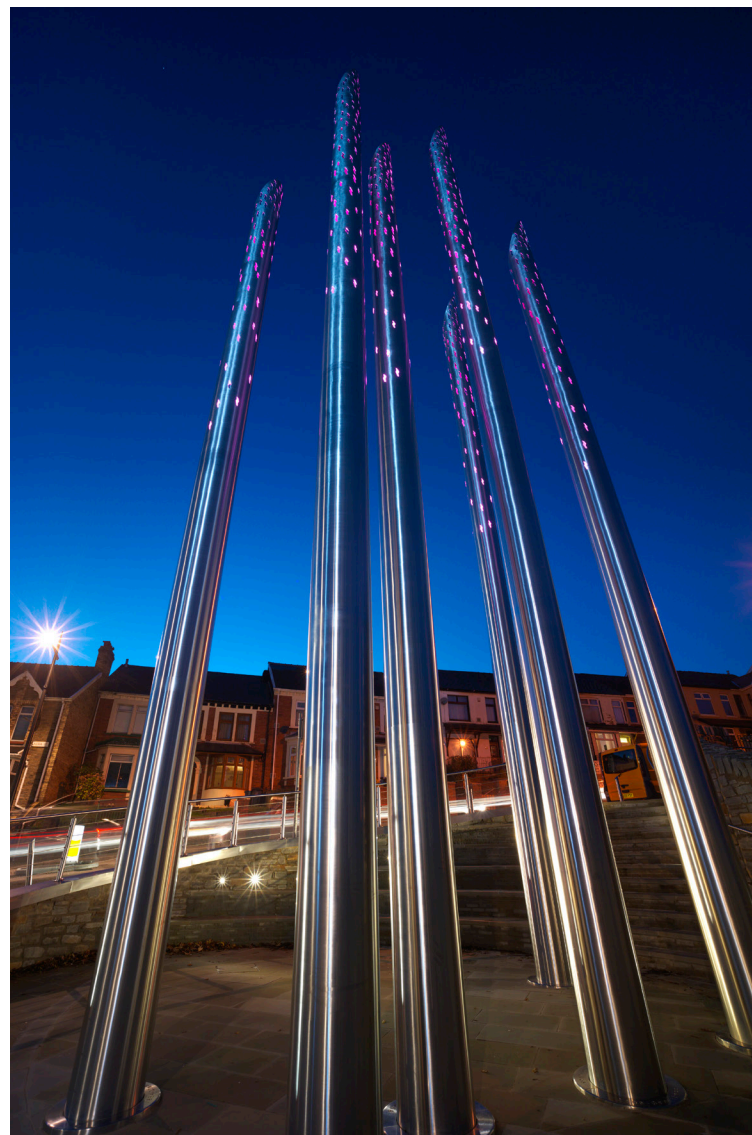

FOLKESTONE WAR MEMORIAL ARCH



Project: Folkestone War Memorial Arch
Architect: Foster Gearing
Location: Folkestone, Kent

m-tec were commissioned by educational charity Step Short to manufacture the iconic stainless steel arch and bespoke seating that was unveiled by Prince Harry.

Designed by specialist architectural company Foster Gearing, the memorial arch overlooks the harbour where ships waited to take millions of soldiers to France during the course of the war. This project marks the centenary of the outbreak of World War 1.

The associated seating made from marine grade 316 stainless steel and Iroko slats were designed and manufactured by sister company, Goose Foot Street Furniture to fit seamlessly into the recesses. They create a timeless feature within the town centre and blend into the surrounding area perfectly.

Thousands of people turned out for the ceremony to commemorate the millions of men and women who travelled to and from the Western Front during the 1914-18 conflict, and the project was delivered to international property company Lend Lease ahead of schedule.

Together, the projects create a timeless feature integrated to complete the renovation of the Road of Remembrance.

IRVINE TRINITY MIRROR

Project: Irvine Trinity Mirror
Architect: Peter McCaughey
Location: Irvine Town Centre

m-tec were selected to manufacture the nine metre, mirror polished sculpture which stands proud in the recently developed town centre of Irvine.

The sculpture was fabricated using 12mm thick grade 316 stainless steel sheets which were then welded together to form the unique shape. There is granite text lain into the ground below which is written in reverse, but when you read it using the mirror finish on the sculpture you are able to read the text which is based on the history of the town.

The project was a joint venture between artist Peter McCaughey, Irvine Bay Regeneration, Land Engineering and m-tec.



THE SWIRL



Project: The Swirl
Architect: Maria Rosa Kramer
Location: Didcot Orchard Centre, Oxfordshire

m-tec were selected by architect Maria Rosa Kramer to manufacture The Swirl sculpture for Didcot Orchard Centre.

Standing at eight metres high and supported by three vertical legs, the 316 grade stainless steel sculpture is mirror polished and finished with red paint on one of its sides to represent the colour of an apple.

Inspired by Oxfordshire's great apple growing tradition, Maria's vision for the stunning sculpture was for it to resemble the peeling of an apple and refers to the name of the town centre and surrounding area.

The owners of the shopping centre and the public in Didcot have given great feedback on this stunning sculpture and they are delighted to have it as a centrepiece for their shopping area.

STAINLESS STEEL CANOPY

Project: Stainless Steel Canopy
Architect: RH Partnership
Location: Napp Pharmaceutical, Cambridge

The bespoke stainless steel canopy was fabricated in-house from 316 grade stainless steel and installed at Napp Pharmaceutical in Cambridge.

The custom built canopy is over 22 metres long and has a striking shape which was designed by RH Partnership Architects. It also features a remote sun shade which is operated electronically depending on the weather conditions.

This project was a joint venture between m-tec, Napp Pharmaceutical, RH Partnership, and VINCI Construction Levulux.

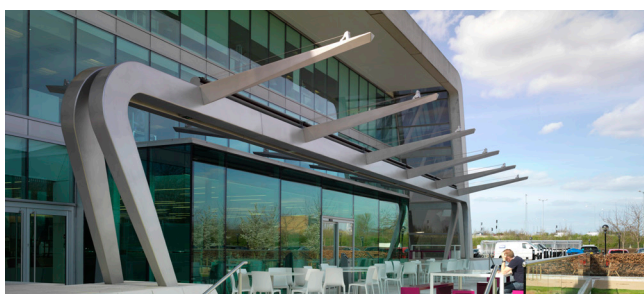

DARWEN SPITFIRE MEMORIAL



Project: Darwen Spitfire Memorial

Location: Darwen, Lancashire

The stunning stainless steel spitfire memorial sculpture, that was unveiled on Remembrance Day 2012, was overseen by m-tec and manufactured by WEC Group Training Academy apprentices.

Darwen was the smallest town in the UK to finance a spitfire during WWII, and the Spitfire memorial is a lasting reminder of the Town's contribution to the War Effort. The sculpture took two years to complete and cost around £175k. The sculpture has been 100% funded, manufactured and donated by the WEC Group to the people of Darwen.

The motivation behind the donation is to recognise and remember the massive contribution the people of Darwen made when they managed to raise the cost to purchase a spitfire for use in the WWII R.A.F.

The 3:1 ratio stainless steel sculpture, with a wing span measuring 3.8 meters and standing 6.9 meters high was hand crafted by the apprentices.

This fantastic sculpture is the town's legacy to the people of Darwen who made the contribution to the country's war efforts.

MEADS REACH BRIDGE



Project: Meads Reach Bridge
Architect: Niall McLaughlin
Location: Temple QUAY II, Bristol

The Meads Reach Bridge was a joint project between Niall McLaughlin Architects, Cyril Swett, Gleeds, Price & Myers, Dean & Dyball and m-tec for Castlemore Securities to renovate Temple QUAY II in Bristol.

m-tec fabricated the 55 metre, 75 tonne stainless steel pedestrian walkway in-house from 2205 duplex stainless steel. Its construction was made from eight sections which were delivered individually to the Bristol location. This was then reassembled and fully welded together to make one complete structure.

The arc of the bridge picks up light from the sky and water, changing with the weather and the time of day. The interior of the bridge also holds LED lights which make the whole structure glow at night, revealing the hidden ribs of the internal skeleton.

The final polishing was undertaken in-house and the completed pedestrian walkway was craned into place in one piece, making the Meads Reach Bridge of m-tec's most prestigious projects to date.



m-tec projects



Air Burst - BAE Systems HQ



Minaret - Brick Lane, London



Concorde Nose



The Swarm - O2 HQ

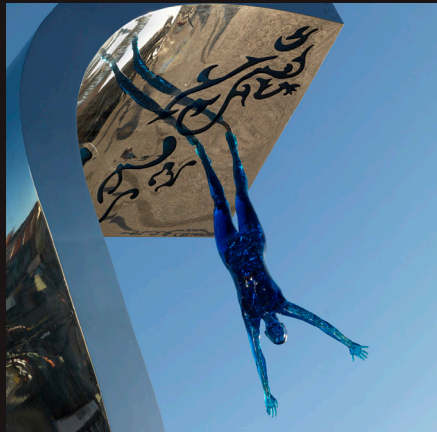

The Wave - Blackpool



Wind Shelter - Blackpool



Skyramp - Birmingham

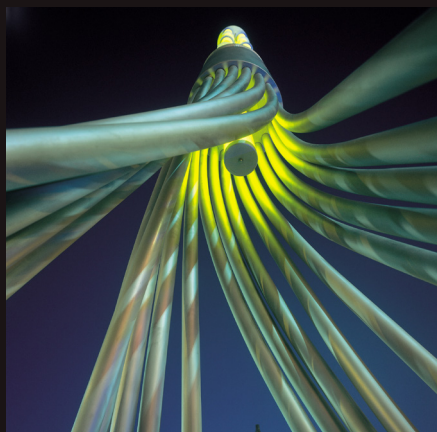

The Braid - Blackburn



Discovery - Northampton

m-tec

Specialist metal fabricators and consultants

Britannia House | Junction Street | Darwen | Lancashire | BB3 2RB
t: +44 (0)1254 773718 | e: info@m-tec.uk.com | www.m-tec.uk.com