

Hoardfast Flamescreen is a quick to install, modular, internal screening system. The white steel faced PIR foam filled panel adheres to EN13501-1 B s2 d0 fire class rating. A range of panel heights are available and panels can be installed floor-to-ceiling or freestanding using Westgate's unique universal support.

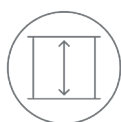

Floor-to-ceiling  
or freestanding



Euroclass fire  
rating

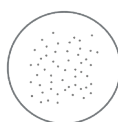

Reduce  
dust



Reusable and  
sustainable



Next day  
delivery

## FEATURES & BENEFITS

FEATURES	BENEFITS
Modular ready to install system	<ul style="list-style-type: none"> <li>Quick, clean, easy installation saves time and money on site setup</li> <li>Easy to configure as required</li> </ul>
Panels are EN13501-1 B s2 d0 fire class rating	<ul style="list-style-type: none"> <li>Easily create an effective floor to ceiling fire retardant screen that is self-extinguishing</li> <li>Foam produces minimal smoke in the event of coming in to contact with fire</li> </ul>
Sustainable product that can be reused	<ul style="list-style-type: none"> <li>Install and demount the product multiple times giving medium- and long-term savings.</li> <li>Reduces waste and environmental impact on construction projects</li> </ul>
2.25m, 2.7m, 3.5m standard panels heights	<ul style="list-style-type: none"> <li>Create quick floor to ceiling or free-standing partitions</li> <li>Configure as required</li> </ul>
Next day delivery from large UK stock*	<ul style="list-style-type: none"> <li>Get items to site when you need them to prevent delays</li> </ul>
Easy fit single and double doors (with Digi lock)	<ul style="list-style-type: none"> <li>Create restricted access to construction sites or site offices and welfare spaces</li> </ul>

\*Deliveries to mainland UK



Flamescreen is available to purchase only and is a great lighter weight alternative to Firescreen when a full 60 minute fire resistant panel is not required.

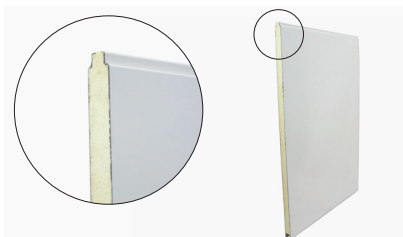

## TECHNICAL SPECIFICATIONS

Material composite	White steel faced PIR filled
Connection method	Tongue and groove push fit
Panel Fire rating	EN13501-1 B s2 d0 fire class rating
Standard panel heights	2.25m, 2.7m, 3.5m
Panel width	1m
Panel thickness	35mm
Panel weight	9.5 kg/m2
Support options	Floor to ceiling; supplied with u-channel fixing or floor to ceiling; universal support

## TECHNICAL SPECIFICATIONS

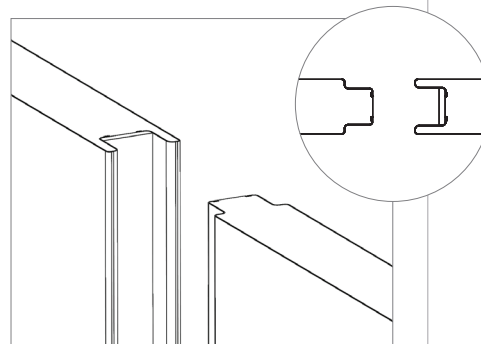

Panels join with a push fit tongue and groove system. Corner posts and T-sections also available.

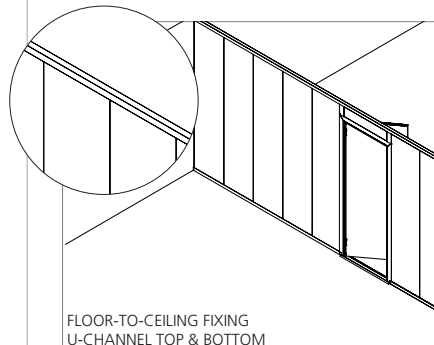

FLOOR-TO-CEILING FIXING  
U-CHANNEL TOP & BOTTOM

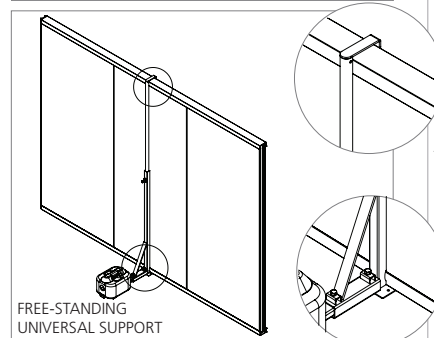

FREE-STANDING  
UNIVERSAL SUPPORT

Flamescreen can be installed floor to ceiling using supplied u-channels or for a free-standing system choose our universal support, which can hold 1 - 6 16kg weights.

HOARDFAST SOLUTIONS ARE USED BY MANY INCLUDING...

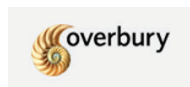

This fact sheet is for illustrative purposes only and based on the latest information at the time of print. Installation methods may vary depending on specific project requirements. Westgate reserve the right to make changes at any time without notice.

westgateuk.co.uk +44 (0)1785 242181 salesteam@westgateuk.co.uk

## SUPPORT OPTIONS

The Hoardfast Flamescreen system is available with free-standing universal support up to 2.7m or can be fixed floor-to-ceiling up to 3.5m.

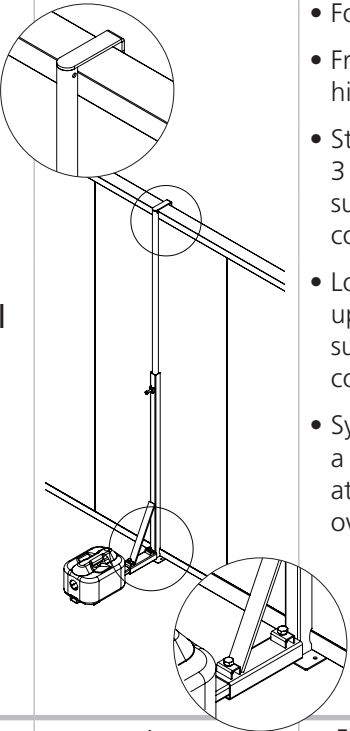
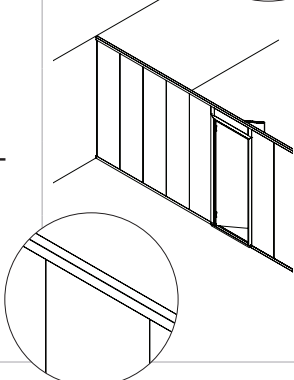
SUPPORT TYPE	SUPPORT SPECIFICATION	USED WITH: PANEL	USED WITH: PANEL HEIGHT
<b>Universal (free-standing)</b> 	<ul style="list-style-type: none"> <li>For maximum stability</li> <li>Free-standing up to 2.7m high</li> <li>Standard: allows up to 3 x 16kg weights per support (Protrudes 645mm construction side)</li> <li>Long: will accommodate up to 6 x 16kg weights per support (Protrudes 900mm construction side)</li> <li>System secured at base using a hooked in u-channel and at the top using a hooked over pole</li> </ul>	Standard PVC	2.25m / 2.7m / 3m
		Soundscreen	2.25m / 2.7m / 3.1m
		Firescreen	2.25m / 2.7m / 3.1m
		Flamescreen	2.25m / 2.7m
<b>Floor-to-ceiling</b> 	<ul style="list-style-type: none"> <li>Floor-to-ceiling fixed solution up to 3.5m high</li> <li>Installed using supplied u-channels</li> </ul>	Budget PVC	2.7m / 3.5m / 4.8m
		Standard PVC	2.25m / 2.7m / 3m 4m / 5m
		Soundscreen	2.25m / 2.7m / 3.1m
		Firescreen	2.25m / 2.7m / 3.1m 3.5m / 4m / 4.5m
		Flamescreen	2.25m / 2.7m / 3.5m

This fact sheet is for illustrative purposes only and based on the latest information at the time of print. Installation methods may vary depending on specific project requirements. Westgate reserve the right to make changes at any time without notice.