

technical datasheet

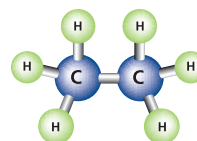

environmental protection systems

Corden EPS Hydrocarbon Membrane (Textured) (CH)



Hydrocarbons are colourless gases formed as a by-product of decomposing organic matter.

It is crucial that when gas protection is required, the site conditions, design and application are all taken into consideration to provide an impermeable membrane capable of surviving installation and subsequent traffic, to protect the most valuable asset "the building" against harmful gases that can cause future problems.

The Corden EPS Hydrocarbon Membrane (Textured) is a high quality, high density polyethylene (HDPE) produced from specially formulated, proprietary virgin polyethylene resin designed specifically for flexible geomembrane applications.

The Corden EPS Hydrocarbon Membrane (Textured) has outstanding chemical resistance, mechanical properties, environmental stress crack resistance, dimensional stability and thermal ageing characteristics. The Corden EPS Hydrocarbon Membrane (Textured) also has excellent resistance to UV radiation and is suitable for exposed conditions.

The key benefit of using Corden EPS Hydrocarbon Membrane (Textured) is that, where permitting it can be built into the masonry structure avoiding transference to a DPC.

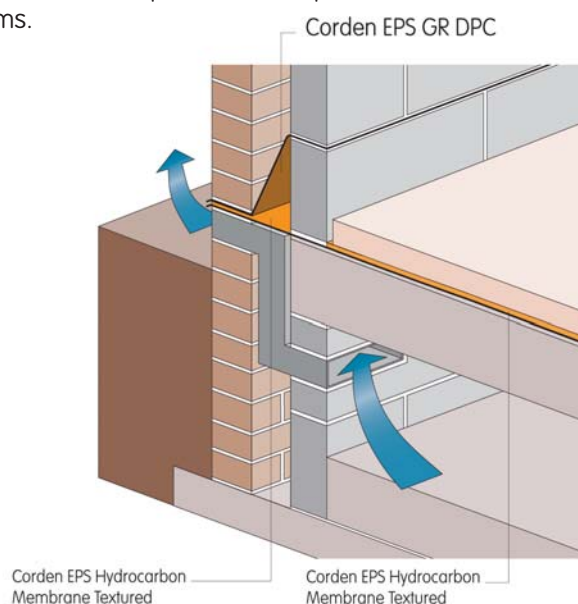

Product Specification

Physical Description	Test method	Value/Units
Thickness	ASTM D 5199	1mm
Density	ASTM D 792/1505 A	0.94g/cm ³ (min)
Colour		Black
Standard roll width		5.9/2.95m
Technical Performance		
Elongation at break	G.L.(50mm)	700%
Slip Resistance	ASTM D 5321	Excellent
Puncture resistance	ASTM D 4833	320N
Tear Resistance	ASTM D 1004	125N
Hydrocarbon permeability		2.0x10 ⁻⁶ ml/cm ³ .s

The Corden EPS Hydrocarbon membrane is available in standard roll size of 5.9m x 50m.

Advantages

- Suitable for use on hydrocarbon contaminated sites
- Excellent weld characteristics
- Very high resistance to puncture and tear
- Available 5.9m wide
- Compatible with vented systems
- Excellent resistance to chemicals and UV radiation
- Can be taped (Consult technical department)
- Low permeability to hydrocarbon gases (Consult separate data sheet)
- All sundries available

Installation Details

Corden EPS HM (Textured) is designed to exhibit superior welding properties, therefore, we recommend factory welding or on-site welding methods of jointing when the membrane is to be installed below a ground floor construction.

Placing

Although the Corden EPS Hydrocarbon Membrane (Textured) is a very robust material, it is advised that it should be laid on a blinded or smooth surface allowing adequate overlap for jointing between the sheets and avoiding bridging i.e. areas of unsupported membrane. A final floor covering should be installed above it and care should be taken to ensure the membrane is not damaged prior to this.

Inspect for damage and repair tears/holes with a piece of membrane sealed down with double sided tape and secured down with lap tape.

In certain applications, where the membrane is to be installed above a suspended in-situ concrete slab or block and beam suspended floor, the sealing of laps can be achieved using the EPS Jointing Tape system. In these instances, Corden EPS Jointing Tape should be applied approximately 50mm from the edge. The next width of Corden EPS HM (Textured) should then be overlapped. For effective protection, all laps must be a minimum of 150mm and the joint should be secured with Corden EPS Girth Jointing Tape, a single sided tape which provides added security against any potential leakage paths. Always ensure that the membrane is clean, dust free and dry at the time of jointing.

Corden EPS HM (Textured) and ancillary components must be installed in accordance with the recommendations of Building Research establishment BRE 414 "Protective measures for housing on gas contaminated land", Ciria Report 149 "Protecting development from methane", together with codes of practice CP102 and BUS 8102.

Corden EPS DPC should be installed in accordance with BUS 8215: 1991, BUS 8000: Part 3, 1989 and BUS 5628: Part 3: 1985. All horizontal DPC's must be bedded on both sides with fresh mortar. All DPC's must project through the full width of the wall, including any externally applied rendering and project 5mm beyond the finished external face.

Ancillary Products

- Corden EPS Geovent
- Corden EPS Geovent Connectors
- Corden EPS Pervients
- Corden EPS Gas Collector Pipe
- Corden EPS Gas Tape
- Corden EPS Lap Tape
- Corden EPS Top Hats
- Corden EPS GR DPC
- Corden EPS Vent Boxes
- Corden EPS Vent Stack and Cowl
- Corden EPS GRM and Prime

Separate data sheets available on request for all the above ancillary products.

leach way, burma road, blidworth industrial estate, blidworth, nottinghamshire ng21 0ru
tel 0115 965 6111 fax 0115 965 5151 email sales@cordengroup.co.uk web www.cordengroup.co.uk