

# TVS RESi-LAY TRIPLE

## TECHNICAL INFORMATION



**TVS ACOUSTICS**  
NOISE & VIBRATION CONTROL

### Description

An acoustic flooring underlay which is used extensively by private households, property companies, housing associations, contractors and builders.

**TVS RESi-Lay Triple** is primarily designed for timber floors although it can also be used with concrete floor constructions. It offers additional airborne and impact sound insulation to RESi-Lay Double so is aimed at developments where superior noise control is necessary.

This high performance composite is a sandwich laminate of two layers of TVS RESi Barrier Matt, separated by a 6mm layer of TVS ABSorb foam.

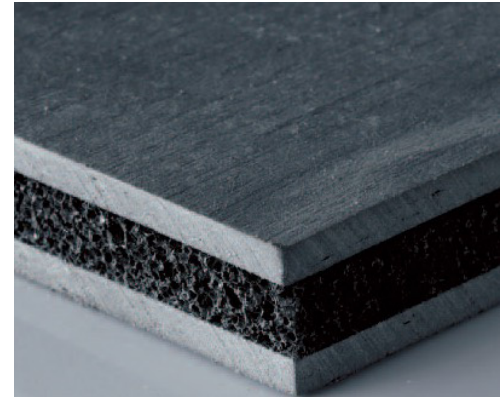

### Physical Information

<b>Standard Sheet Size</b>	1200mm x 1000mm
<b>Standard thicknesses</b>	12mm
<b>Density</b>	16 kg/m <sup>2</sup>

### Technical Information

Timber Floor Airborne and Impact Sound Insulation Data

Airborne sound insulation (Rw(C;Ctr)) 49dB  
(Part E 43/45dB minimum)

Impact sound insulation (Ln,w (Ci)) 55dB  
(Part E 62/64dB maximum)

(figures derived from acoustic testing at an independent acoustic test laboratory on a build up as shown in Figure 1)

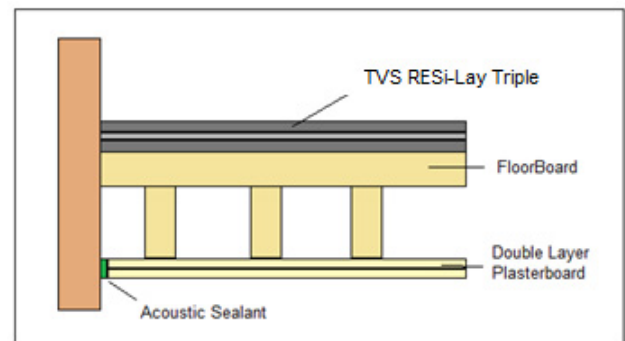

Figure 1

### Impact Sound Improvement on Concrete Floors

$\Delta L_w$  (impact improvement) 37dB

### Fire Regulations

TVS ABSorb Class O foam is a fully tested fire resistant foam that achieves the fire resistance requirements of British Building Regulations BS476: Part 6 & 7, satisfying the highest level Class 'O'.



# TVS RESI-LAY TRIPLE

## TECHNICAL INFORMATION



**TVS ACOUSTICS**  
NOISE & VIBRATION CONTROL

<b>Flammability (FMVSS 302)</b>	Self extinguishing
<b>ASTM 1692:1974</b>	Resists ignition
<b>Service temperature</b>	<80°C (continuous) <110°C (short periods)

TVS INSu barrier material is a high-density mineral loaded thermoplastic polymer. Black in colour, ecologically neutral and recyclable it conforms to the following:

<b>Flammability (FMVSS 302)</b>	Zero burn rate
<b>Service temperature</b>	<90°C (continuous) <120°C (short periods)

### Benefits

- Reduces Impact Sound
- Improves Airborne Performance
- Flexible, Easy to Cut, Simple to Install
- High Performance - Low Profile
- Suitable for use on both Timber and Concrete Floors

### Applications

- New Build
- Retrofit Constructions
- Residential Developments
- Hotels

### TVS RESI-LAY TRIPLE

Product Data Sheet PDS 1.1 TVS RESI-LAY TRIPLE

Revision: 1.1

Issued: 20/07/2017

IMPORTANT: Directions for use are given for guidance only and are not intended to form part of any contract. They should be varied or adapted to suit your particular materials or conditions of use. Goods supplied by the company are made to approved standards from the highest quality raw materials but no warranty or guarantee is given as to their suitability for any particular purpose or application, and no liability is accepted for any loss or damage arising directly or indirectly from the use of the Company's products irrespective of any information given to us as to intended use of such products. It is therefore recommended that prospective users should test a sample of this product under their own conditions to satisfy themselves that the product is suitable for the purpose intended.

T: +44 (0) 1706 260 220 | F: +44 (0) 1706 260 240  
E: Sales@TVS-acoustics.com | W: www.TVS-acoustics.com  
Low Bay | Commerce Street | Carrs Industrial Estate  
Haslingden | Rossendale | Lancashire | BB4 5JT | United Kingdom



**TVS GROUP**  
SPORT | FITNESS | PLAY | ACOUSTICS

www.TVS-Group.co.uk