



Don & Low
MEMBER OF THRACE GROUP

construction

Specified textiles for the construction industry

Roofing

Vapour Permeable Underlays
Vapour Barrier Underlays
Vapour Control Layers

Walling

Breather Membranes
Reflective Breather Membranes
Vapour Control Layers

Flooring

Vapour Control Layers
Flooring Protection

Scaffold Sheeting



Don & Low

Engineering tomorrow's technical textiles



Don & Low
MEMBER OF THRACE GROUP

About Us

From our origins in 1792 as a linen and flax textile weaver, Don & Low has evolved into an internationally recognised innovative polyolefin textile manufacturer. Today, we are part of the multinational Thrace Group, expanding our profile across the globe. We focus on producing high performance, cost effective solutions to our clients' demands, which has led us to become one of the most versatile manufacturers serving global markets.

Quality

Quality is a key focus at Don & Low. We never compromise on quality, from the raw materials we purchase, right through to the finished goods we produce. Continuous investment, quality management systems and experience have all contributed to us being awarded ISO 9001. Combined, this gives us confidence that our products meet the exact specifications required by our diverse range of customers.

Environment

The need for truly sustainable options remains one of Don & Low's crucial challenges. We are committed to improving our impact on the environment through our proactive environmental policies, energy reduction measures and recycling programs.

Innovation & Growth

Innovation, flexibility and a proactive approach to the ever evolving markets have contributed to our success. Don & Low has many long standing relationships with both customers and suppliers with whom we work closely to develop tomorrow's technical textiles. Enabling growth along with our customers, lies at the heart of our innovation philosophy.

www.donlow.co.uk

If construction is your business, then you will know that the sector continually faces demands for buildings that deliver improved technical performance, compliance with increasing regulatory standards and greater energy efficiency.

Using our extensive experience in developing products which meet the high technical criteria of the construction market, Don & Low has created a range of solutions for walls, roofs, floors and temporary site protection.

In the following pages you will find a summary of the products we produce for this sector, their applications and the benefits they provide. Simply turn the pages and discover how our capabilities can help solve the challenges you face.

Roofing Underlays

- RoofTX® Pro (vapour/air permeable)
- RoofTX® (vapour permeable/air barrier)
- MultiTX® Plus (vapour/air barrier)

Exterior Walling

- FrameTX® (breather membrane)
- FrameTX® Thermo (reflective breather membrane)

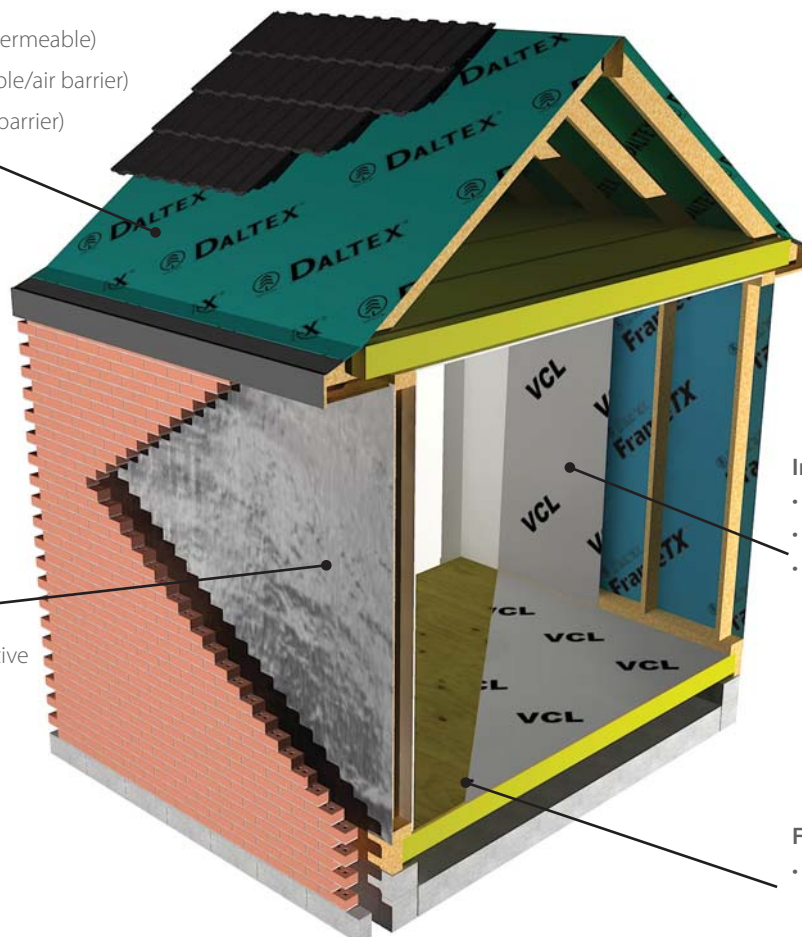

Interior Walling

- VCL 116
- VCL 146
- Reflective VCL

Flooring

- TFR Nonwoven (temporary floor protection)

Daltex[®] products

All of our products are manufactured using approved polypropylene and polyethylene materials and are available as single layer or composite fabrics, carrying national and international certification where required.

Roofing

RoofTX[®] Vapour Permeable / Air Barrier Underlays

Water vapour is created by a number of regular household activities including bathing, cooking and washing. To avoid condensation, the use of vapour permeable underlays has become common practice in construction.

RoofTX[®] is a range of low resistance (LR) underlays for all types of pitched roof construction. Durable, flexible and lightweight, they offer protection against wind driven rain, snow and dust. The RoofTX[®] range has:

- Excellent resistance to water penetration
- Excellent water vapour transmission properties
- Enhanced flammability resistance to EN 11925-2

RoofTX[®] Pro Vapour Permeable / Air Permeable Underlay

In most UK construction projects, maximising vapour permeability is critical to avoid condensation. RoofTX[®] Pro is the market leading very low resistance (VLR) vapour permeable underlay for all types of pitched roof construction. Strong, durable and flexible, it offers protection against wind driven rain, snow and dust.

- Superior breathability minimises condensation risk in roof structures
- Patented air-permeable structure
- Enhanced flammability resistance to EN 11925-2

In the UK & Ireland this product is distributed under the brand name Roofshield[®] by A Proctor Group.
(www.proctorgroup.com)

MultiTX[®] Plus Vapour Barrier / Air Barrier Underlay

Where a project requires a complete barrier, MultiTX[®] Plus high vapour resistance (HR) is the ideal solution. A modern, cost effective, lightweight alternative to traditional type 1F bitumen felts for pitched roofing, it is durable, clean, easy to cut and install, and offers excellent temporary protection against the elements.

- Lightweight fabric minimises manual handling issues
- Resistant to water penetration and stabilised against UV degradation
- Excellent low temperature flexibility



Walling

FrameTX® Vapour Permeable / Air Permeable Nonwoven Housewrap

FrameTX® is a high performance, breather housewrap for use in timber and steel frame constructions. It is flexible and lightweight allowing for easy installation, and offers temporary protection for timber and steel frames against wind driven rain, snow and dust.

- Excellent breathability minimises condensation risk
- Stabilised against UV degradation
- Extensively used in timber frame construction since 1989

In the UK & Ireland this product is distributed under the brand name Frameshield® by A Proctor Group. (www.proctorgroup.com)

FrameTX® Maxi Vapour Permeable / Air Barrier Composite Housewrap

Where greater protection is required against water or air ingress, FrameTX® Maxi is an effective air barrier housewrap that retains excellent vapour permeability properties when applied to both timber and steel frame constructions. It is durable, flexible and lightweight allowing for easy installation offering excellent protection against the elements.

- Effective air barrier with excellent water vapour transmission properties
- Enhanced flammability resistance to EN 11925-2
- Resistant to water penetration and stabilised against UV degradation

FrameTX® Thermo Reflective Breathable Membrane

Rising energy costs demand that buildings are constructed to conserve energy and reduce environmental impact. FrameTX® Thermo is a low emissivity breather membrane specifically designed to enhance the thermal performance of timber and steel frame structures. Particularly effective, as the breathability is not compromised by its thermal properties, it minimises the risk of condensation in the structure.

- Reflective surface contributes to reduced heat loss through the cavity wall
- High performance breather membranes

In the UK & Ireland this product is distributed under the brand name Reflectashield® TF by A Proctor Group. (www.proctorgroup.com)



Flooring Protection

TFR Durable Flame Retardant Nonwoven

TFR is a protective flooring nonwoven with a durable flame retardant treatment to inhibit and resist flame spread.

- Compliant with British standards
- Certificated with Loss Prevention Certification Board (LPCB)

Scaffold Sheeting

Many building projects are delayed or restricted during unfavourable weather conditions.

Lobrene® scaffold sheeting is a strong, durable polypropylene woven fabric which protects contractors working on the building and allows progress to continue regardless of weather, whilst preventing debris being scattered into the surrounding area.

- Tear resistant
- Ventilated to allow fumes and dust to escape
- Easy to secure

Accessories

Adhesive Tapes

Don & Low offer a high adhesion breathable and barrier membrane tape highly resistant to ageing and environmental factors, ideally suited for joining our breathable and barrier membranes in commercial and residential constructions.

VCL116 and VCL146 Vapour Control Layers

Certain construction designs call for a complete air and vapour barrier to control condensation and air movement within the building. VCL116 and VCL146 are high resistance vapour barriers for internal walls, ceilings and floors, specifically designed to reduce the transfer of water vapour through the structure when placed on the warm side of the insulation.

- Forms a barrier against air leakage and water vapour transfer
- Can be used in walls, ceilings and floors

Reflective Vapour Control Layer

Our reflective vapour control layer is a nonwoven composite fabric incorporating a highly reflective foil. This product offers exceptional performance as an air and vapour barrier. The reflective surface assists in enhancing overall thermal performance of the cavity.

Vapour Control Layers

	Vapour Control Layer	Vapour Control Layer	Reflective Vapour Control Layer
Function	Air / vapour barrier	Vapour control layer	Reflective air / vapour barrier control layer
Weight (g/m ²)	116	146	142
CE	✓	✓	✓



commitment

Many customers and applications have different technical requirements and Don & Low's production facility provides the flexibility to respond to these demands. Capable of manufacturing smaller production runs, specialist laminates and multi-layer composites, we can produce tailor made solutions to meet your demands.

For over 25 years we have worked in partnership with leading global manufacturers of polymers, films and additives, allowing us to say with confidence that our products meet the most demanding criteria. This global network, combined with our technical manufacturing expertise, allows us to design innovative fabrics ensuring we successfully meet our customers' needs.

Roofing and Walling Products

	RoofTX® Optima	RoofTX® Ultra	RoofTX®	RoofTX® Maxi	RoofTX® Extra	RoofTX® Pro *	MultiTX® Plus	FrameTX® *	FrameTX® Maxi	FrameTX® Thermo *
Application	Roofing and Walling					Roofing	Roofing	Walling – Housewrap, breather membrane		
Function	Vapour permeable, air barrier LR roofing underlay and breather membrane for walling					Vapour/air permeable VLR underlay	Vapour/air barrier HR underlay	Vapour/air permeable spunbond	Vapour permeable/air barrier	Reflective breathable membrane
Weight (g/m ²)	92	112	125	165	208	175	116	100	102	134
	✓	✓	✓	✓	✓	✓	✓	✓	✓	✓
	✓	✓	✓	✓	✓	✓	✓	✓		✓
	✓	✓	✓	✓		✓	✓	✓		✓
	✓	✓	✓	✓						
	✓		✓							
<p>* Exclusively sold in the UK and Ireland by A Proctor Group : www.proctorgroup.com LR = Low Vapour Resistance Vapour Permeable Underlays with a vapour resistance of <0.25MN/s/g (Sd <0.05m) VLR = Very Low Resistance Vapour Permeable Underlays with a vapour resistance of <0.08MN/s/g (Sd <0.016m) HR = High Resistance Barrier Underlays with a vapour resistance of >0.25MN/s/g (Sd >0.05m)</p>										



Don & Low Ltd

Newfordpark House Glamis Road Forfar Angus DD8 1FR Scotland UK

t +44 (0)1307 452200 f +44 (0)1307 452300 e enquiries@donlow.co.uk www.donlow.co.uk

 Printed on paper produced with 75% recycled fibre