

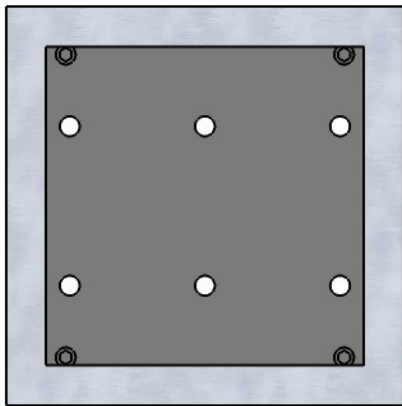

## TREE planter (small)

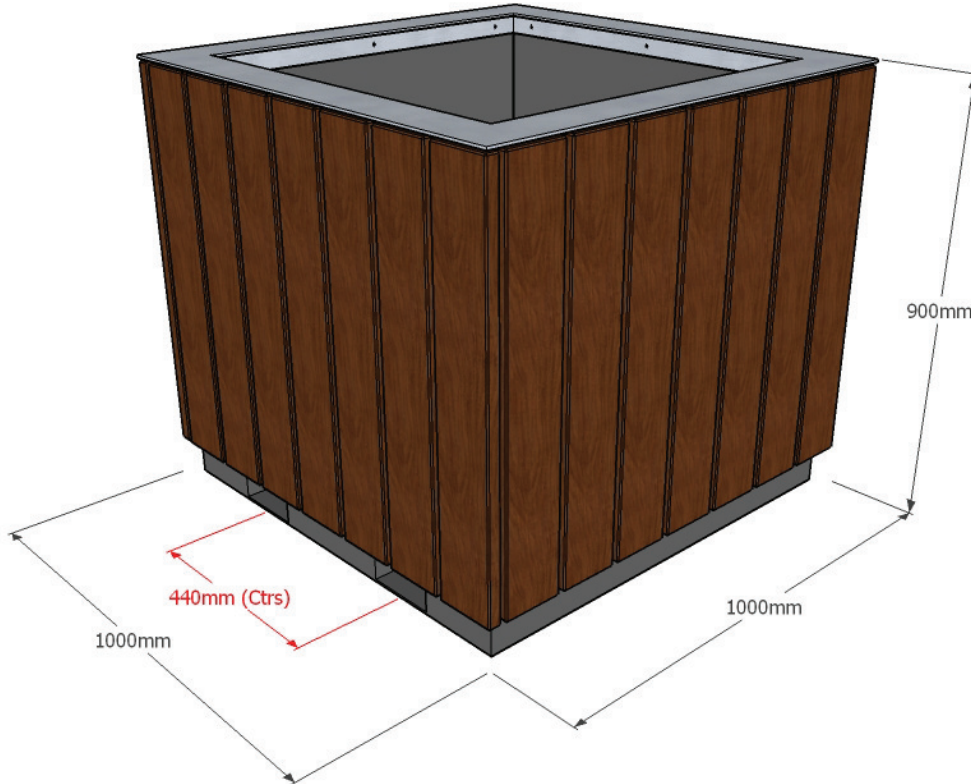

### SPECIFICATIONS

#### composition

*Sides* - FSC® certified tropical hardwood

*Rim* - Satin polished stainless steel

*Frame & Liner* - Galvanised & painted mild steel

#### finish

*Timber* - Natural finish as standard. (Oil or microporous woodstain available on request)

#### dimensions

*Metric* length 1000mm | width 1000mm | height 900mm

*Imperial* length 3' 3½" | width 3' 3½" | height 2' 11½"



**planter liner capacity**

500ltrs

**approx weight**

356kg

**forklift centres**

440mm

#### handling

Please observe health & safety lifting guidelines. A fork lift or crane will be required for off-loading & positioning of item

#### maintenance

Depends on usage / position. All elements will require annual cleaning. Wooden elements should be treated every other year if coated. Galvanised liner will require maintenance only if damaged. Stainless steel requires no maintenance