

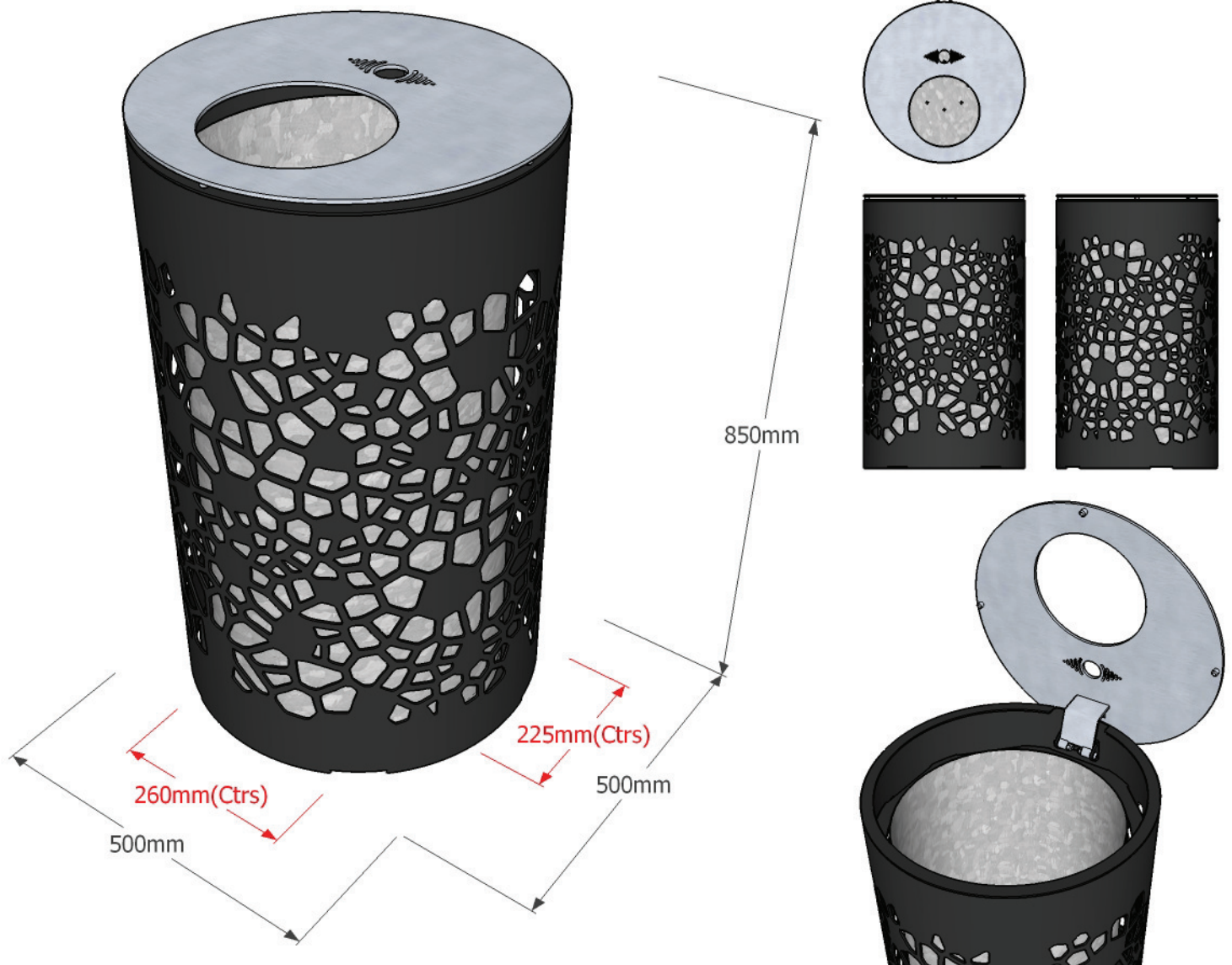

OSSO bin (large)



SPECIFICATIONS

composition

Bin - Galvanised & powder-coated mild steel*

Bin liner - Galvanised mild steel

Bin lid - Satin polished stainless steel - *hinged for access to removable bin liner*

dimensions

Metric length 500mm | width 500mm | height 850mm

Imperial length 1' 7½" | width 1' 7½" | height 2' 9½"

bin liner capacity 95ltrs

fixing centres & method

260mm (10") x 225mm (9")

3 no. sleeve anchors (*concealed in base*)

approx weight 36kg

foundation

1 no. pad 550 x 550 x 300 mm in C20 concrete (recommendation only)

handling

Please observe health & safety lifting guidelines. 2 people will be required for the off-loading & positioning of this item

maintenance

Depends on usage and position. All elements require cleaning annually. Galvanised and powder coated mild steel only require maintenance if damaged. Stainless steel requires no maintenance

**Please note that when a powdercoat is applied over a hot dip galvanised surface pinholing can occur in the surface finish - this is not considered a defect.*