

FACTORY FURNITURE

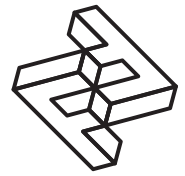

OSSO planter (1.5x0.75x0.75m)

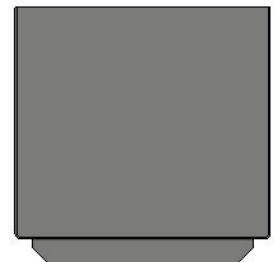
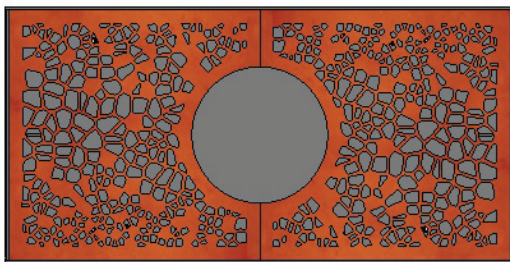
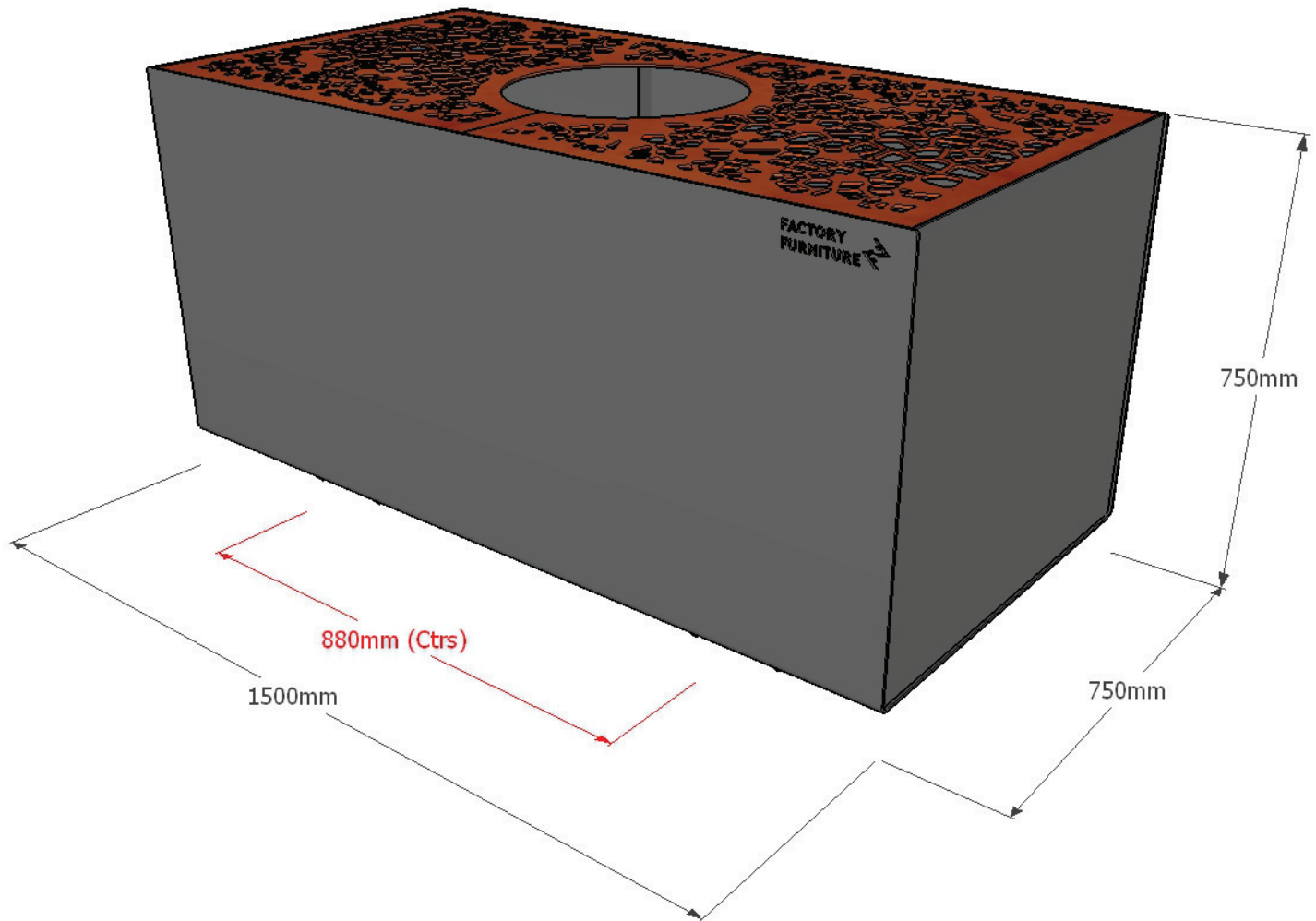

SPECIFICATIONS

Composition

Planter sides - Aluminium
Top panel - Corten Steel

Finish

Aluminium is polyester powder coated (*grey as standard or as per client specification*). Corten steel is left untreated.

Dimensions

Metric L - 1500mm | W - 750mm | H - 750mm
Imperial L - 4' 11" | W - 2' 5½" | H - 2' 5½"

Approx weight 91kg

Forklift Channel Centres 880mm (2' 10½")

Handling

Please observe health & safety lifting guidelines. A fork lift or crane will be required for off loading and positioning of items.

Maintenance

Depends on usage and position. All elements will require annual cleaning. Powder coated surfaces only require maintenance if damaged. Corten requires no further maintenance.