

FACTORY FURNITURE

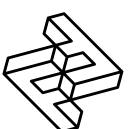

Foil Wood Bench

OPERATION & MAINTENANCE MANUAL



Introduction

Design

Design, shop drawings and development by Factory Furniture Ltd.

Manufacture

Factory Furniture manufactured components. Products are assembled in Factory workshops, checked and dispatched ready for installation. Replacement products or components thereof should be ordered direct from Factory Furniture Ltd.

Copyright

The design copyright for the product and drawing copyright remains the sole property of Factory Furniture Ltd.

General Specifications

Bench (Floor fix)

Metric length 2010mm | width 400mm | height 450mm
Imperial length 6' 7" | width 1' 6" | height 1' 5½"

Approx Weight 57kg

Fixing Centres 1265mm (4' 2") x 190mm (7½")

Bench (Wall fix)

Metric length 2010mm | width 455mm | height 250mm*
Imperial length 6' 7" | width 1' 3½" | height 10"*

*Ideally fitted with upper surface @ 450mm (1' 5½") above gnd lvl

Approx Weight 51kg

Fixing Centres 1265mm (4' 2") between base centres
Base holes 75mm (3") x 140mm (5½")

Detailed Material & Finish Specifications

Seat Top

- Slats and front and rear edge are manufactured from FSC® certified tropical hardwood (*other FSC certified timber options available upon request*).
- Slats are profiled and left untreated as standard (*oil or microporous woodstain treatment available on request*).
- End caps manufactured from cast aluminium - polyester powder coated finish (*powder coat colour grey as standard or to customer specification*).
- Supported on two bases (*see options below*) attached with 4 no. fixing points per base.

Bases (Floor fix)

- Manufactured from cast aluminium - polyester powder coated finish (powder coat colour grey as standard or to customer specification).
- Anchored via 2 no. resin fixed M8 x 110mm threaded rods and cap nuts per base

Bases (Wall fix)

- Manufactured from cast aluminium - polyester powder coated finish (powder coat colour grey as standard or to customer specification).
- Anchored via 3 no. resin fixed M10 x 130mm threaded rods and cap nuts per base.

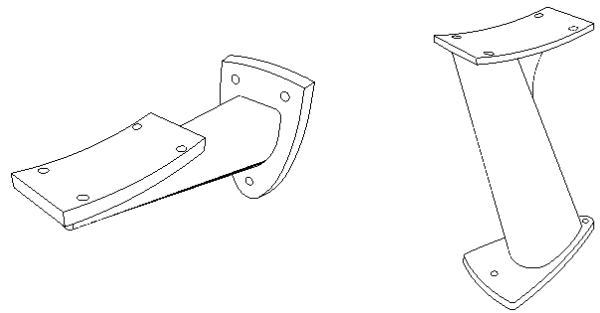

Base options (from left to right) Wall fix & Floor fix

General Maintenance

(Recommended Schedule & Guidelines)

Daily/Weekly/Monthly (or as adopted)

Visual checks of seat top and bases - check all items for superficial or physical damage.

Three Monthly

Clean all items as detailed below check all fixings are seated correctly; inspect timber for serious damage and splinters.

Six Monthly

Secure all fixings; full clean as detailed below; check that bench is firmly secured to the ground.

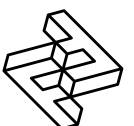

Specific Maintenance Details

FSC Timber

Clean with a stiff brush once per year, especially in more exposed locations, in order to prevent a verdigris type build up on the timber surface. Ideally this should be completed in early spring. During the cleaning stage, all exposed timber surfaces should be inspected for splits and splinters. Any splinters and graffiti should be removed and the surface sanded with 100 grit sandpaper in order to remove any uneven / sharp edges or surfaces.

During the first few months after installation the tannin naturally occurring in the timber may leach out and cause a brown staining on the bases. This may be removed with a light solution of household bleach and water.

Polyester Powder Coated & Galvanised

For general cleaning using a damp cloth and warm soapy water only. Scourers and abrasive cleaners are NOT suitable for these types of finish and may damage them. Before using any cleaning agents to remove graffiti etc. try on a small, inconspicuous area first to avoid causing more unsightly damage.

Repairs

FSC Timber

For light damage, please see section on specific maintenance details above. For instances of heavy damage, the timber item should be replaced. Please order against the part number reference in the reordering section towards the end of this manual.

Galvanised Surfaces

For light damage to hot dipped galvanised finishes repair using a high performance cold galvanising zinc spray (70% zinc or above). Spray application should be carried out in accordance with approved methods detailed by the product manufacturer.

Please note that it is advisable to use professional painters to achieve best results when touching up larger areas.

Painted Surfaces (Inc. Polyester Powder Coated)

For light damage (scratches, chips etc.) repair using touch-up paint to match original colour (available from Factory Furniture Ltd). Paint application should be carried out in accordance with approved methods detailed by the paint manufacturer.

Please note that it is advisable to use professional painters to achieve best results when touching up larger areas. Products for respraying larger areas are available from Factory Furniture Ltd.

Heavy Damage

In the event of serious damage to any component, replacements should be ordered from Factory Furniture Ltd. In this event (or if the product needs to be disassembled for any reason), please contact Factory Furniture for detailed technical advice.

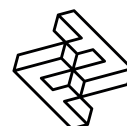

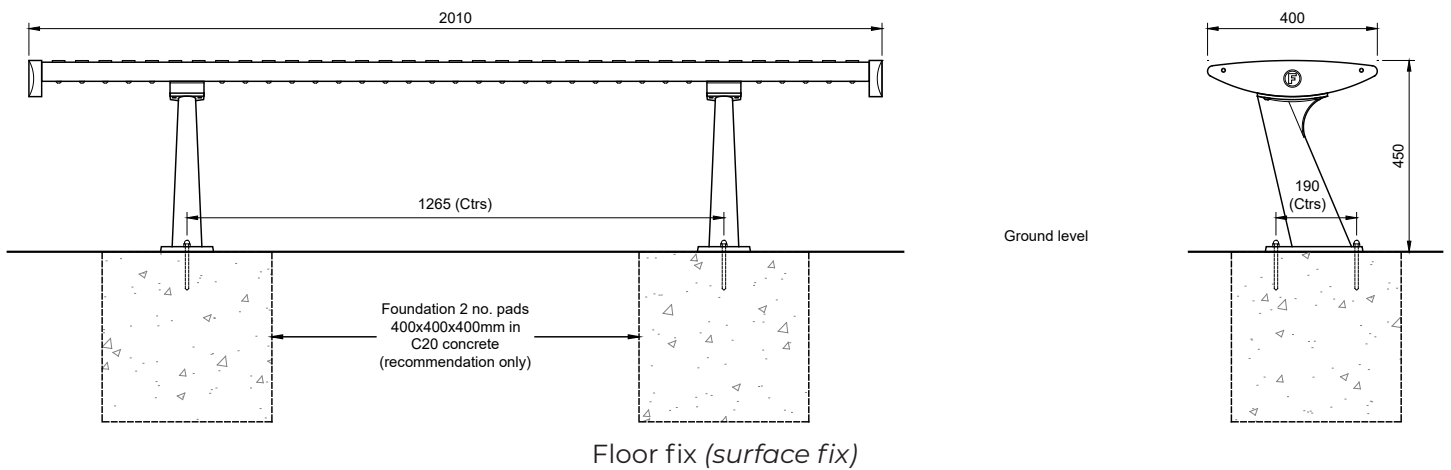

Installation Instructions

All installation works to be carried out by competent personnel - install as complete unit.

Foil bench (wood)

Floor fix (surface fix)

1. Install suitable foundation with top face at ground level.
2. Unpack pair of bases and attach to the bench using 8 no. M8 x 25mm bolts provided and tighten to 14Nm.
3. Position bench in correct orientation on centre of foundation pads, then mark hole positions through base plates.
4. Remove the bench; drill holes $\text{\O}10\text{mm}$ x 110mm deep (or as per manufacturer's instructions)
5. Clear debris from holes.
6. Fill the holes to within approximately 35mm from the top with Hilti HY150 resin (or similar). Lift the bench (with threaded anchor rods / capnuts in place) and carefully lower the anchors into the holes, leave for two hours before using.
7. Check level & re-instate ground level if necessary.

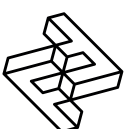
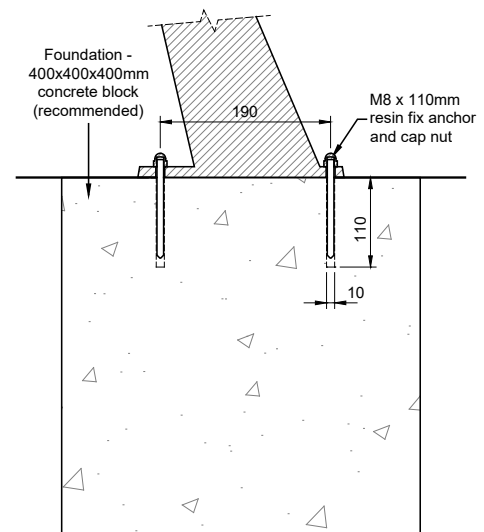

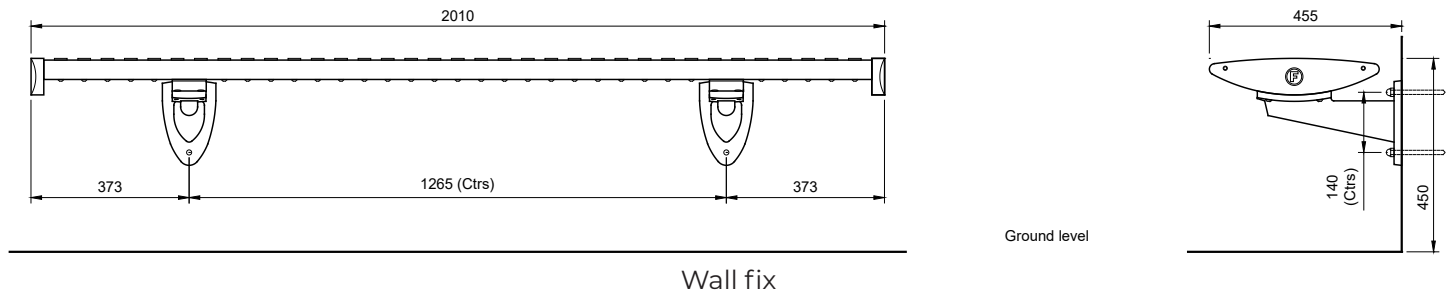

Wall fix

Installation Instructions

All installation works to be carried out by competent personnel - install as complete unit.

Foil bench (wood)

Wall fix

1. Prepare suitable wall surface - suitable substrates include concrete, brick, stone or similar
2. Unpack pair of bases and attach to the bench using 8 no. M8 x 25mm bolts provided and tighten to 14Nm
3. Position bench in desired position on wall, then mark hole positions through base plates.
4. Remove the bench; drill holes $\text{\O}12\text{mm}$ x 125mm deep in wall (or as per manufacturer's instructions)
5. Clear debris from holes.
6. Fill the holes to within approximately 35mm from the opening with Hilti HY150 resin (or similar). Lift bench (with threaded anchor rods / capnuts in place) and carefully push the anchors into the holes. Securely prop bench in position and leave for two hours before using.
7. Using a torque wrench, tighten nuts and washers over base plate to 30Nm to secure the bench ensuring that it remains level.

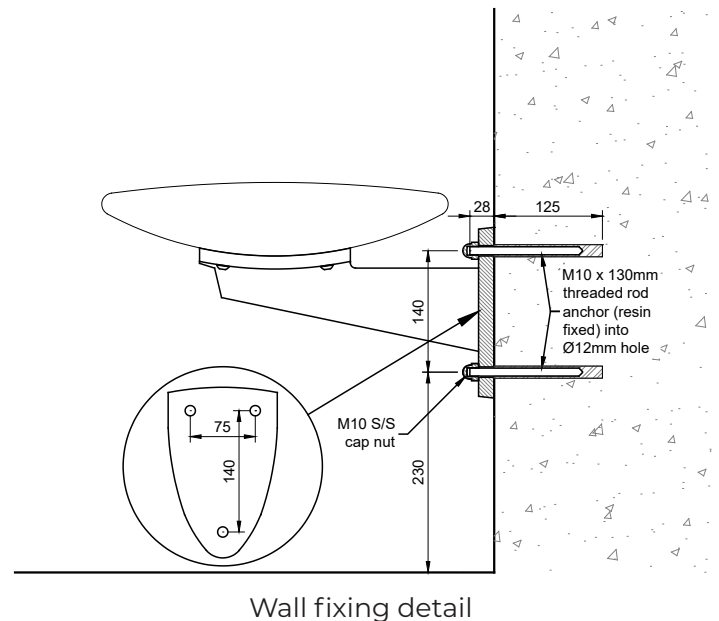

Wall fixing detail

5 Pioneer Road, Faringdon,
Oxfordshire SN7 7BU
+44 (0)1367 242731
hello@factoryfurniture.co.uk

factoryfurniture.co.uk

