

FACTORY FURNITURE

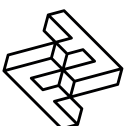

Osso Bin (Small)

TECHNICAL SHEET



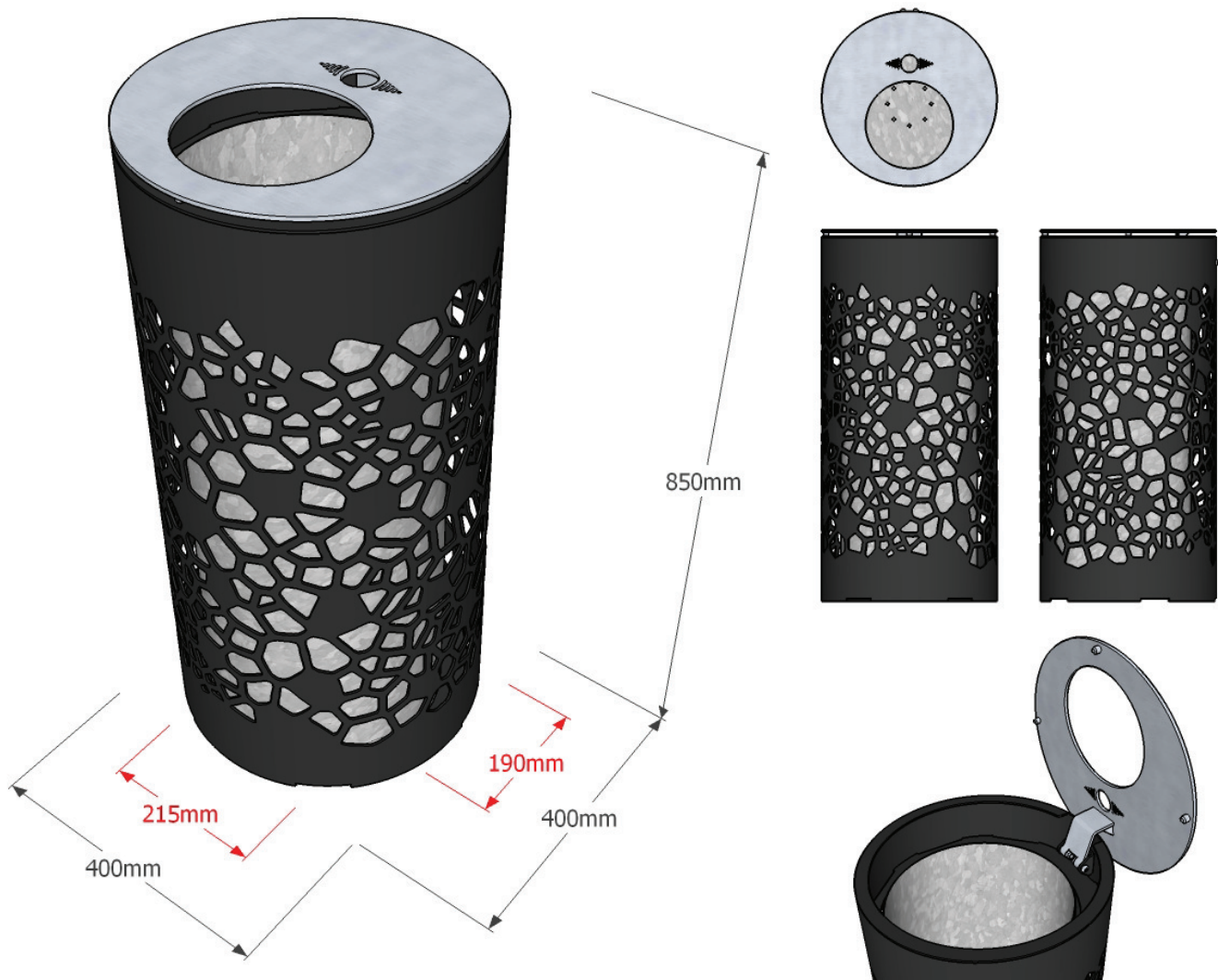

Composition

Bin - Galvanised & powder-coated mild steel*

Bin liner - Galvanised mild steel

Bin lid - Satin polished stainless steel - hinged for access to removable bin liner

Dimensions

Metric L 400mm | width 400mm | height 850mm

Imperial L 1' 3½" | width 1' 3½" | height 2' 9½"

Bin liner capacity

55ltrs

Approx weight

27kg

Fixing centres & method

215mm (8½") x 190mm (7½")

3 no. sleeve anchors (concealed in base)

Foundation

1 no. pad 450 x 450 x 300 mm in C20 concrete (recommendation only)

Handling

Please observe health & safety lifting guidelines.

2 people will be required for the off-loading and positioning of this item

Maintenance

Depends on usage and position. All elements require cleaning annually. Galvanised and powder coated mild steel only require maintenance if damaged.

Stainless steel requires no maintenance

**Please note that when a powdercoat is applied over a hot dip galvanised surface pinholing can occur in the surface finish - this is not considered a defect.*

