



CONTEMPORARY SEATING & TABLES



# CONTEMPORARY SEATING

© Furnitubes Ref: 5-273-04-17

[www.furnitubes.com](http://www.furnitubes.com)



tel: 020 8378 3200

# INTRODUCTION

## Boldly-designed individual products and small ranges

Outdoor seating is a major component in most landscape schemes and makes a significant contribution to the overall character of any development. Our Contemporary Seating range is a collection of individual seating products and small ranges generally characterised by their straightforward aesthetic and often bold design, with particular attention to detail. Seats such as the Fan and Wave are even sculptural in their appearance, thereby making a strong visual statement that helps reinforce the visual identity of an area. The range includes a wide variety of styles and materials, including steel in galvanised or coated finishes, stainless steels in various finishes, and with the majority of products employing timber slats for a warm and comfortable seating platform. As with all products across all our ranges, these seats are built to last.



Whilst our Contemporary Seating brochure contains mainly individual products and those which are part of small ranges, other contemporary-styled products which are part of larger families can be found in their own brochures, and can be viewed and downloaded at the following link:  
<http://www.furnitubes.com/brochures/seating-e-brochures>



**RailRoad Seating**  
Straight and curved modules ideal for long continuous seating runs, in an endless number of layout options



**Seven Seating**  
A range of five standard products that can be used independently or together in interesting assembly forms

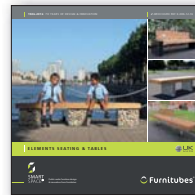

**Elements Seating**  
A unique range of interchangeable components in a choice of conventional & unusual materials & finishes



**Zenith Seating**  
A longstanding popular range of steel & timber seats, benches & tables, including curved units

If you are unable to find a product to meet the exact requirements of your scheme, please call us to discuss the feasibility of adapting existing products or designing bespoke solutions, some examples of which are shown at the following link:  
<http://www.furnitubes.com/street-furniture/seating-benches-special-commissions>



## FORDHAM RANGE

### Heavy duty seat, bench & table range

The Fordham steel and timber seating offers a bold appearance, heavy duty materials and a robust construction designed to offer the maximum resistance to vandalism required in tough urban environments. The bench is the basic form of the range, to which a backrest can be added to form a seat. Bench supports are fabricated I-beam profiles hot dipped galvanised as standard, on which are mounted iroko timbers (in the largest timber section profile across our entire seating range) with selected visible fixings, all combining to give a contemporary industrial aesthetic. Backrest slats are supported by a durable galvanised steel frame. Armrests in folded steel plate are available on all seats and benches, with standard fixing positions to maximise the useable seating space. Seats and benches are available in 6 standard lengths to comfortably accommodate up to 5 people, and the table is offered in 2 standard sizes, corresponding to 2 mid-size seating lengths.



# FORDHAM RANGE

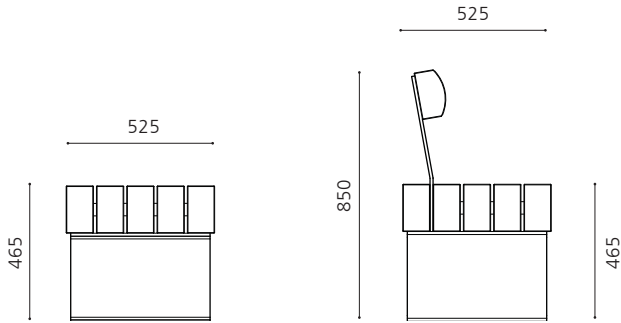

## FORDHAM SEATING

Galvanised steel support frame with iroko timber slats, smooth planed finish

### BENCHES

#### FOR B5

1500mm long

#### FOR B6

1800mm long

#### FOR B7

2100mm long

#### FOR B8

2350mm long

#### FOR B9

2685mm long

#### FOR B10

3000mm long

### SEATS

#### FOR 5

1500mm long

#### FOR 6

1800mm long

#### FOR 7

2100mm long

#### FOR 8

2350mm long

#### FOR 9

2685mm long

#### FOR 10

3000mm long

### OPTIONS:

- Polyester powder coated steelwork
- Armrests
- Timbers with UV protective finish

### Installation:

Both seat / bench supports are pre-drilled with 4no. holes for M16 ground fixings (not supplied).

## Seat backrests

Backrests, comprising a single timber supported on wide steel plates attached to the seat supports, are shorter than the seating platforms, as shown below.

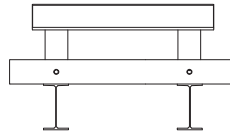

- **FOR 5** seat platform 1500mm long, backrest 1200mm long

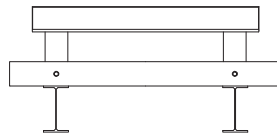

- **FOR 6** seat platform 1800mm long, backrest 1500mm long

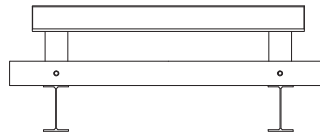

- **FOR 7** seat platform 2100mm long, backrest 1800mm long

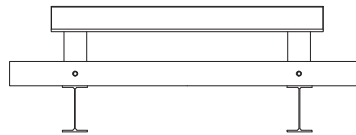

- **FOR 8** seat platform 2350mm long, backrest 1800mm long

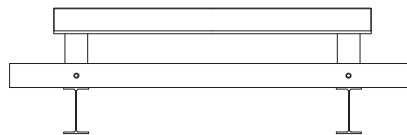

- **FOR 9** seat platform 2685mm long, backrest 2100mm long

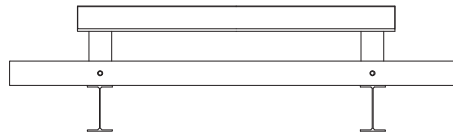

- **FOR 10** seat platform 3000mm long, backrest 2100mm long

## FORDHAM RANGE



### Armrests

Armrests are manufactured from heavy duty folded steel bars and can be pre-fitted to both benches and seats. Shown below are the maximum number of armrests for each seat / bench length that maintain suitable width seating spaces between.

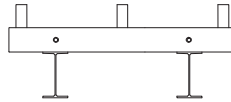

- **FOR B5 / FOR 5** 1500mm long, 3 arms max, 600mm spaces between

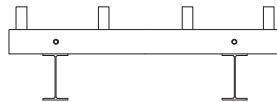

- **FOR B6 / FOR 6** 1800mm long, 4 arms max, 475mm spaces between

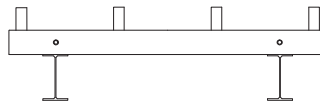

- **FOR B7 / FOR 7** 2100mm long, 4 arms max, 575mm spaces between

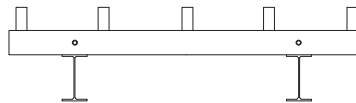

- **FOR B8 / FOR 8** 2350mm long, 5 arms max, 475mm spaces between

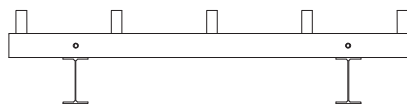

- **FOR B9 / FOR 9** 2685mm long, 5 arms max, 560mm spaces between

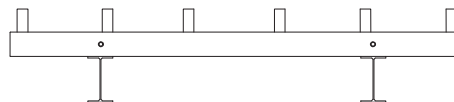

- **FOR B10 / FOR 10** 3000mm long, 6 arms max, 500mm spaces between

## FORDHAM RANGE

### Coordinated tables

The Fordham table is of a similar construction to the bench and seat from the same range, though the timber top slats are less deep, so more comfortable for the table user. Tables are available in 2 lengths, corresponding with 2 of the standard seating lengths. The option of a finish treatment to the table-top slats is advisable, as it provides not only UV protection that maintains the colour of the timber for longer, but also provides a degree of resistance to general grime and is easier to wipe clean.

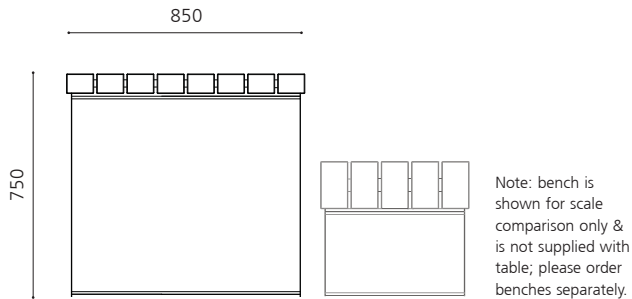

### FORDHAM TABLES

Galvanised steel support frame with iroko timber slats, smooth planed finish

#### FOR T6

1800mm long

#### FOR T8

2350mm long

#### OPTIONS:

- Polyester powder coated steelwork
- Timbers with UV protective finish

#### Installation:

Both table supports are pre-drilled with 4no. holes for M16 ground fixings (not supplied).



## VEEVA RANGE

### Heavy duty straight & curved seating

The Veeva range is characterised by the wedge-shape seat supports, heavy duty timbers and its array of standard configuration options. Veeva offers independent units and modules that can be joined side-by-side to form longer seating runs, both in straight lines and four standard curved sizes. Curved modules can furthermore be arranged in full or broken circles and wave-forms. Backrests are straight, including those on curved seating, providing a cost-effective add-on feature that is available on all but the smallest radius version. Armrests are offered on all seating configurations. Iroko hardwood slats are arranged in a front-to-back orientation on straight and curved seating. On the straight versions only slats can also be used in a side-to-side arrangement, which changes the character of the seat and also reduces costs.





## VEEVA RANGE



## VEEVA RANGE

### Independent benches and seats

A stand-alone independent unit is the traditional way of providing seating in many outdoor locations, allowing small groups of people to sit together. Standard length modules of straight and curved units in the Veeva range comfortably accommodate 3 people, and up to 4 at a tighter fit where armrests are not used.

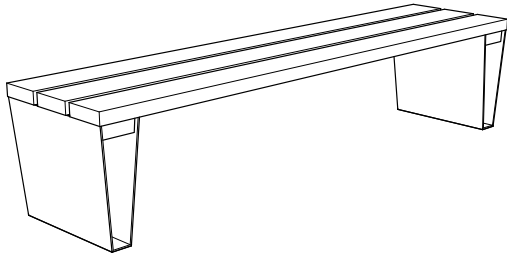

#### Independent Bench

Benches offer double aspect seating, which is useful where there are views or points of interest in both directions. Without a backrest, a bench is ideal as a short term rest point.

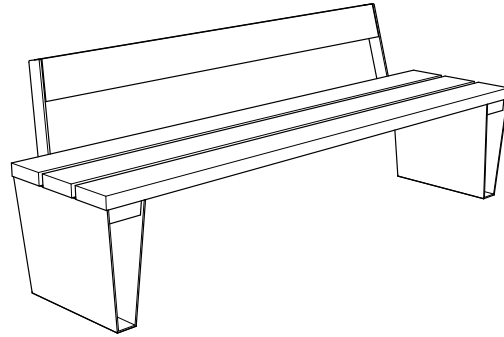

#### Independent Seat

The addition of a backrest improves the comfort of the seat for the user and encourages people to sit for longer.

### Continuous run benches and seats

Longer runs of joined-up seating are a neat solution where high volume seating provision is required, taking up less space and also encouraging more social interaction compared with separated seats. Backrests can be used on all or just selected modules as required, as shown in this illustration.

#### Starter module (bench)

Seat platform + 2 supports

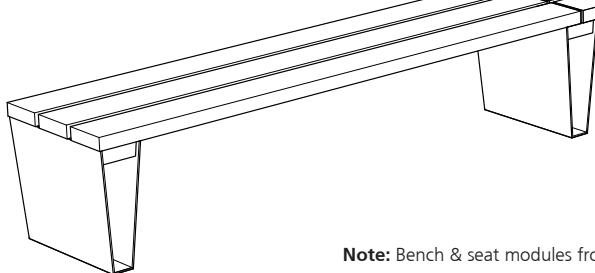

#### Mid module (bench)

Seat platform + 1 support

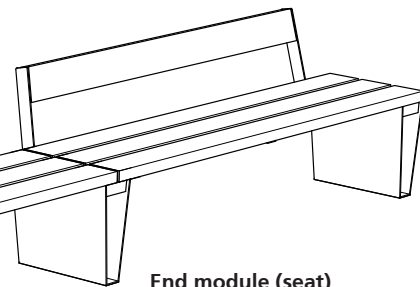

#### End module (seat)

Seat platform / backrest + 1 support

**Note:** Bench & seat modules from the same family (straight + curved x 4 sizes) can be adjoined to form continuous seating runs, but cannot be mixed across families, e.g. straight modules cannot be joined to curved modules.

# VEEVA RANGE

## Continuous run seating dimensions

The illustration below shows the points of measurement for starter, mid and end modules in a continuous straight seating run, and also the ground fixing points.

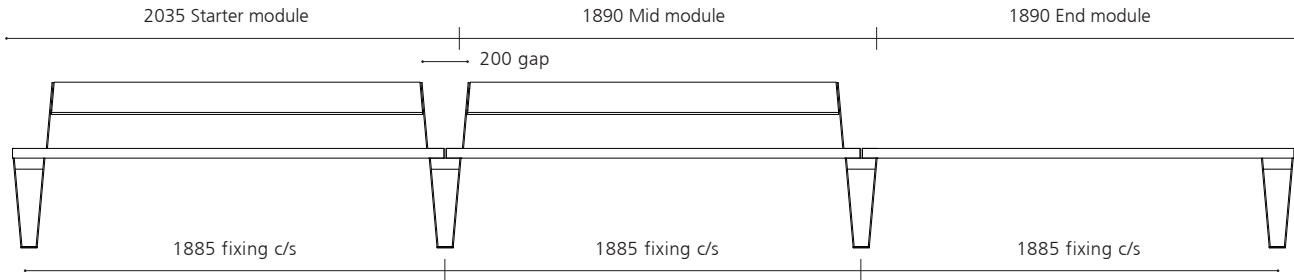

## Armrests

Armrests define individual seating spaces and are particularly useful to less able-bodied people as an aid to lowering onto and alighting from a seat. Placement of armrests can also deter rough sleeping. The positions of armrests on all Veeva seating are pre-determined, set out as shown below, to provide a comfortable seating width and not to divide the seat into areas that result in unusable 'dead space'.

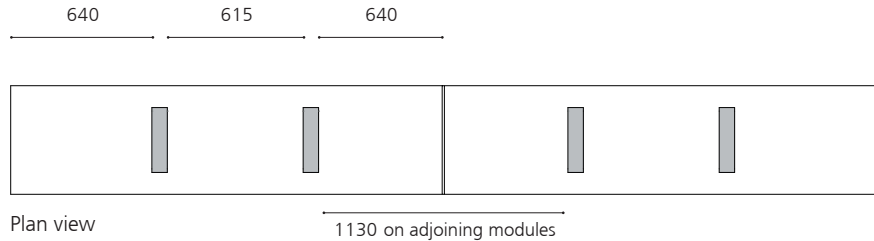
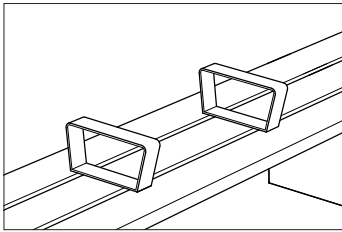

## Installation

Each steel support on all Veeva seating units is pre-drilled with 2 no. holes for M10 ground fixings (not supplied). The internal spaces between the side plates of the supports are shown below. If there is insufficient space to use a spanner or socket to tighten a fixings, we suggest that a stud is pre-fixed to the underside of the support, which can then be set into a concrete foundation block or a cored hole in the paving.

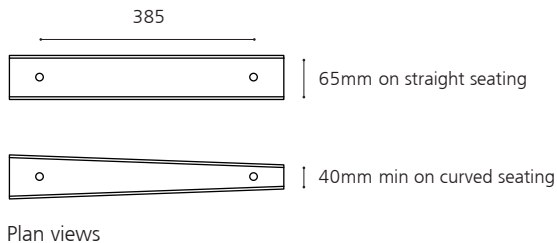

### Pre-fixing a stud

Insert stud through support fixing hole and hand tighten the top nut.

Tighten locking nut onto stud on underside of support, holding top nut with a spanner to prevent rotation.

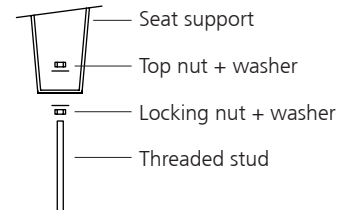

## VEEVA RANGE

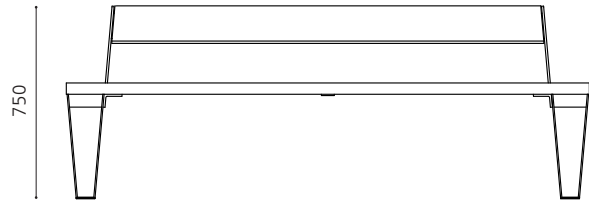
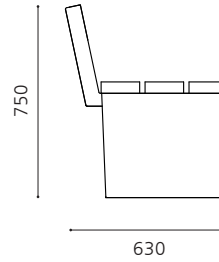
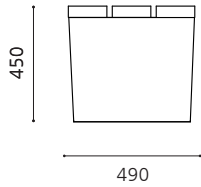

### VEEVA STRAIGHT WITH SIDE-TO-SIDE PLATFORM SLATS

Standard assembly: steel supports & frames (where applicable) for bolt-down fixing in hot dip galvanised finish, with iroko timber slats in smooth planed finish

#### BENCHES

##### VEE B 2035

Independent, 2035mm long

##### VEE B 204 S

Starter module, 2035mm long

##### VEE B 189 M

Mid module, 1890mm long

##### VEE B 189 E

End module, 1890mm long

#### SEATS WITH BACKRESTS

##### VEE 2035

Independent, 2035mm long

##### VEE 204 S

Starter module, 2035mm long

##### VEE 189 M

Mid module, 1890mm long

##### VEE 189 E

End module, 1890mm long

#### OPTIONS:

- Armrest(s)
- Steelwork in polyester powder coated finish to any RAL colour reference, over plain steel or galvanising
- Timbers with UV protective finish

# VEEVA RANGE

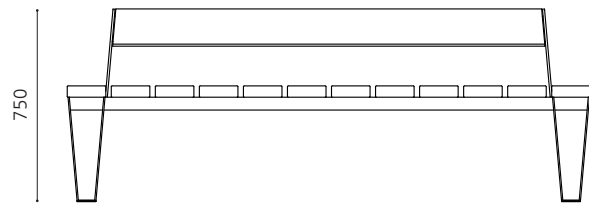
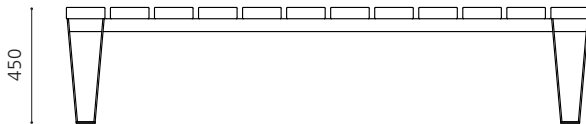
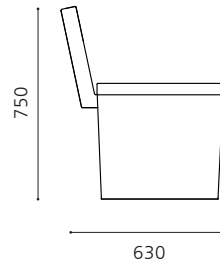
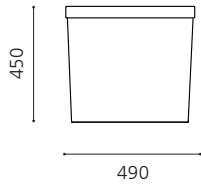

## VEEVA STRAIGHT WITH FRONT-TO-BACK PLATFORM SLATS

Standard assembly: steel supports & frames (where applicable) for bolt-down fixing in hot dip galvanised finish, with iroko timber slats in smooth planed finish

### BENCHES

#### VEE FB 2035

Independent, 2035mm long

#### VEE FB 204 S

Starter module, 2035mm long

#### VEE FB 189 M

Mid module, 1890mm long

#### VEE FB 189 E

End module, 1890mm long

### SEATS WITH BACKRESTS

#### VEE F 2035

Independent, 2035mm long

#### VEE F 204 S

Starter module, 2035mm long

#### VEE F 189 M

Mid module, 1890mm long

#### VEE F 189 E

End module, 1890mm long

### OPTIONS:

- Armrest(s)
- Steelwork in polyester powder coated finish to any RAL colour reference, over plain steel or galvanising
- Timbers with UV protective finish

## VEEVA RANGE

### Standard curved options to suit most sites

Curved seats and benches serve to visually break up orthogonal site layouts and emphasise features such as trees. They can be used independently, in pairs or multiples to create arcs and wave-forms, or linked to form complete circles. Four radii - from 1.8m up to 3.6m - are offered as standard in the Veeva range, all configured around a given number of units to form a complete circle, with each segment designed to accommodate 3 people. Backrests are straight and are inset from the ends of the seating platforms, meaning the backrest is not continuous when curved modules are directly adjoined. Unlike most other seating in our range, the timber slats on curved Veeva seating are tapered in plan so that the gaps between slats are parallel.

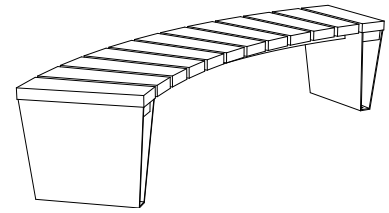

#### Bench

Benches are a popular choice where access can be gained from both sides, allowing people to sit facing opposite directions. Benches are most often used for 'short stay' seating locations.

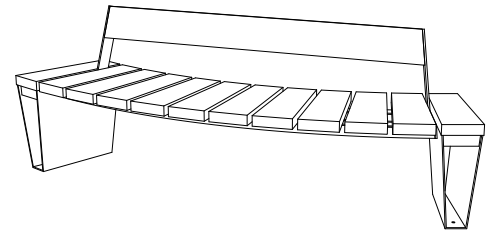

#### Seat - internal backrest

Most often used around features such as specimen trees, and ideal for outward-looking situations. The backrest provides a comfortable support for longer term seating.

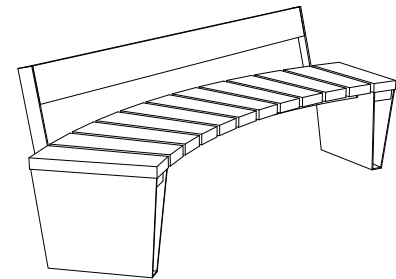

#### Seat - external backrest

These seats are often used to focus on a central feature in the landscape or to provide visually softer alternative to corner seating.



# VEEVA RANGE

## OPTIONS:

- Armrest(s) in standard positions to provide comfortable seating place widths
- Steelwork in polyester powder coated finish to any RAL colour reference, over plain or galvanised steel
- Timbers with UV protective finish

## Notes:

- 1890mm = arc length on c/l between centres of end slats. Overall c/l length of independent and start modules = 2035mm.
- Grey boxes indicate armrest positions
- Grey dashed lines indicate alignment of internal & external backrests

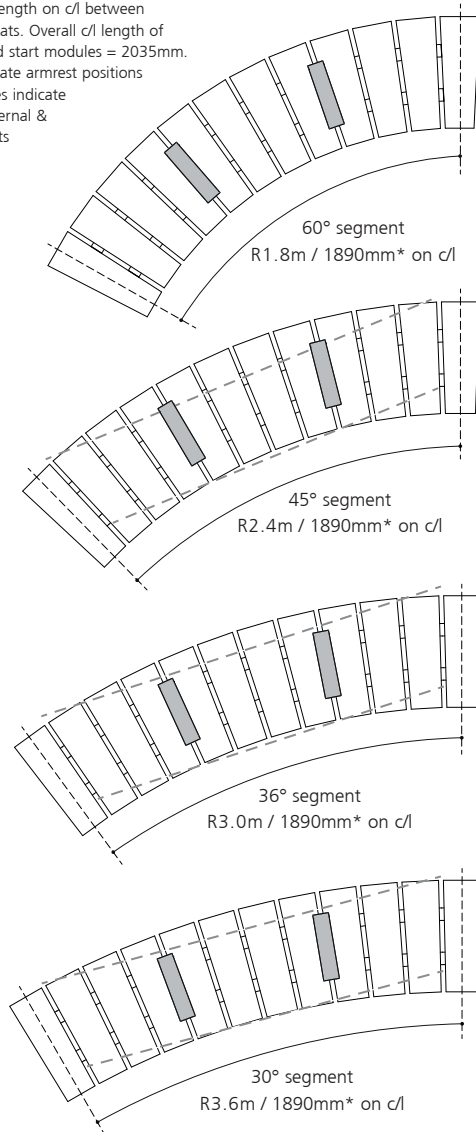

## VEEVA CURVED SEATS & BENCHES

Standard assembly: steel supports & frames for bolt-down fixing in hot dip galvanised finish, with iroko timber slats in smooth planed finish

BENCHES	SEATS WITH INTERNAL BACKREST	SEATS WITH EXTERNAL BACKREST
60° / 1.8m radius, 3 person seat & bench units		
<b>VEE RB 186</b> Independent, 2035mm	n/a	n/a
<b>VEE RB 18 S</b> Starter module, 2035mm	n/a	n/a
<b>VEE RB 18 M</b> Mid module, 1890mm	n/a	n/a
<b>VEE RB 18 E</b> End module, 1890mm	n/a	n/a
45° / 2.4m radius, 3 person seat & bench units		
<b>VEE RB 248</b> Independent, 2035mm	<b>VEE RSX 248</b> Independent, 2035mm	<b>VEE RSV 248</b> Independent, 2035mm
<b>VEE RB 24 S</b> Starter module, 2035mm	<b>VEE RSX 24 S</b> Starter module, 2035mm	<b>VEE RSV 24 S</b> Starter module, 2035mm
<b>VEE RB 24 M</b> Mid module, 1890mm	<b>VEE RSX 24 M</b> Mid module, 1890mm	<b>VEE RSV 24 M</b> Mid module, 1890mm
<b>VEE RB 24 E</b> End module, 1890mm	<b>VEE RSX 24 E</b> End module, 1890mm	<b>VEE RSV 24 E</b> End module, 1890mm
36° / 3.0m radius, 3 person seat & bench units		
<b>VEE RB 3010</b> Independent, 2035mm	<b>VEE RSX 3010</b> Independent, 2035mm	<b>VEE RSV 3010</b> Independent, 2035mm
<b>VEE RB 30 S</b> Starter module, 2035mm	<b>VEE RSX 30 S</b> Starter module, 2035mm	<b>VEE RSV 30 S</b> Starter module, 2035mm
<b>VEE RB 30 M</b> Mid module, 1890mm	<b>VEE RSX 30 M</b> Mid module, 1890mm	<b>VEE RSV 30 M</b> Mid module, 1890mm
<b>VEE RB 30 E</b> End module, 1890mm	<b>VEE RSX 30 E</b> End module, 1890mm	<b>VEE RSV 30 E</b> End module, 1890mm
30° / 3.6m radius, 3 person seat & bench units		
<b>VEE RB 3612</b> Independent, 2035mm	<b>VEE RSX 3612</b> Independent, 2035mm	<b>VEE RSV 3612</b> Independent, 2035mm
<b>VEE RB 36 S</b> Starter module, 2035mm	<b>VEE RSX 36 S</b> Starter module, 2035mm	<b>VEE RSV 36 S</b> Starter module, 2035mm
<b>VEE RB 36 M</b> Mid module, 1890mm	<b>VEE RSX 36 M</b> Mid module, 1890mm	<b>VEE RSV 36 M</b> Mid module, 1890mm
<b>VEE RB 36 E</b> End module, 1890mm	<b>VEE RSX 36 E</b> End module, 1890mm	<b>VEE RSV 36 E</b> End module, 1890mm



## VEEVA RANGE

### Ø3.6m CIRCLE C/L (RADIUS 1.8m)



6 x mid  
**Seats 18 people**



1 x starter  
3 x mid  
1 x end  
**Seats 15 people**  
Gap = 1550mm



2 x starter  
2 x end  
**Seats 12 people**  
Gaps = 1550mm



4 x independent  
**Seats 12 people**  
Gaps = 800mm



3 x independent  
**Seats 9 people**  
Gaps = 1550mm

### Ø4.8m CIRCLE C/L (RADIUS 2.4m)



8 x mid  
**Seats 24 people**



1 x starter  
5 x mid  
1 x end  
**Seats 21 people**  
Gap = 1650mm



2 x starter  
2 x mid  
2 x end  
**Seats 18 people**  
Gaps = 1650mm



3 x starter  
3 x end  
**Seats 18 people**  
Gaps = 1100mm



5 x independent  
**Seats 15 people**  
Gaps = 1000mm



4 x independent  
**Seats 12 people**  
Gaps = 1650mm

### Ø6.0m CIRCLE C/L (RADIUS 3.0m)



10 x mid  
**Seats 30 people**



1 x starter  
7 x mid  
1 x end  
**Seats 27 people**  
Gap = 1700mm



2 x starter  
4 x mid  
2 x end  
**Seats 24 people**  
Gaps = 1700mm



3 x starter  
3 x end  
**Seats 18 people**  
Gaps = 2400mm



6 x independent  
**Seats 18 people**  
Gaps = 1150mm



5 x independent  
**Seats 15 people**  
Gaps = 1700mm

### Ø7.2m CIRCLE C/L (RADIUS 3.6m)



12 x mid  
**Seats 36 people**



1 x starter  
9 x mid  
1 x end  
**Seats 33 people**  
Gap = 1750mm



2 x starter  
6 x mid  
2 x end  
**Seats 30 people**  
Gaps = 1750mm



3 x starter  
3 x mid  
3 x end  
**Seats 27 people**  
Gaps = 1750mm



4 x starter  
4 x end  
**Seats 24 people**  
Gaps = 1750mm



8 x independent  
**Seats 24 people**  
Gaps = 900mm



6 x independent  
**Seats 18 people**  
Gaps = 1750mm





# VEEVA RANGE

## C/L RADIUS 1.8m MODULES

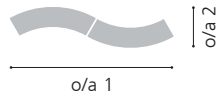

1 x starter  
1 x end  
**Seats 6 people**  
3850 x 980mm o/a



1 x starter  
2 x mid  
1 x end  
**Seats 12 people**  
6670 x 2300mm o/a

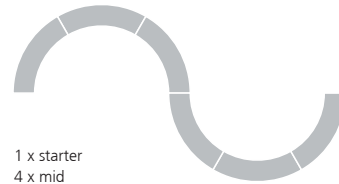

1 x starter  
4 x mid  
1 x end  
**Seats 18 people**  
7700 x 4100mm o/a

## C/L RADIUS 2.4m MODULES



1 x starter  
1 x end  
**Seats 6 people**  
3870 x 870mm o/a



1 x starter  
2 x mid  
1 x end  
**Seats 12 people**  
7140 x 1910mm o/a



1 x starter  
4 x mid  
1 x end  
**Seats 18 people**  
9330 x 3460mm o/a

## C/L RADIUS 3.0m MODULES



1 x starter  
1 x end  
**Seats 6 people**  
3860 x 790mm o/a



1 x starter  
2 x mid  
1 x end  
**Seats 12 people**  
7350 x 1650mm o/a



1 x starter  
4 x mid  
1 x end  
**Seats 18 people**  
10110 x 2970mm o/a

## C/L RADIUS 3.6m MODULES



1 x starter  
1 x end  
**Seats 6 people**  
3860 x 750mm o/a



1 x starter  
2 x mid  
1 x end  
**Seats 12 people**  
7450 x 1460mm o/a



1 x starter  
4 x mid  
1 x end  
**Seats 18 people**  
10540 x 2610mm o/a

## HOLLO RANGE



### Versatile seating / low table surfaces

Hollo is a stylish new addition to Furnitubes' contemporary product range, comprising timber-topped surfaces mounted on heavy duty plate steel supports, available as standard in 3 plan sizes and 3 height options. Hollo products can be equally employed as benches and tables, with the low level plinth on all units useful as a shelf. Hollo is an ideal choice where a range of seating configurations are required on a single scheme. The small cube unit is a single-seater, the long form accommodates 2 people and the large cube up to 4 sitters. When arranged in groups the units can also be used as low tables. At 450mm high, the mid-height option is suitable for most seating applications. The lower 350mm high unit is recommended for sites frequented mostly by children, and can also be used as a low coffee table. The 550mm high versions offer a slightly higher seating level which is preferred for elderly or less able-bodied people. Using different height options in the same scheme also creates more visual interest.

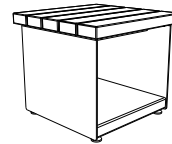

#### Standard sizes:

#### Plan dimensions:

- 500mm x 500mm
- 1000mm x 500mm
- 1000mm x 1000mm

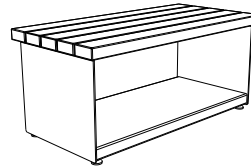

#### Heights:

- 450mm (standard)
- 350mm (low)
- 550mm (high)

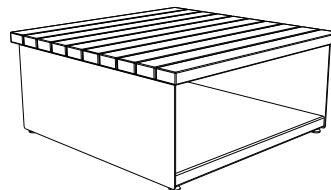

## HOLLO RANGE

### HOLLO BENCH / TABLE - SMALL CUBE FORM

Steelwork galvanised & polyester powder coated to any RAL colour reference, iroko timber slats in smooth planed finish

#### HLL 55/35

500mm wide x 500mm deep x 350mm high

#### HLL 55/45

500mm wide x 500mm deep x 450mm high

#### HLL 55/55

500mm wide x 500mm deep x 550mm high

#### OPTIONS:

- Steelwork in galvanised finish only
- Timbers with UV protective finish

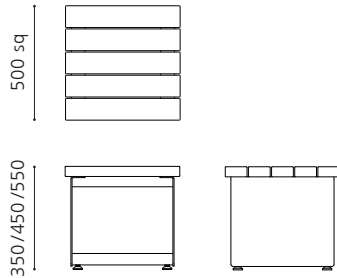

### HOLLO BENCH / TABLE - LONG FORM

Steelwork galvanised & polyester powder coated to any RAL colour reference, iroko timber slats in smooth planed finish

#### HLL 105/35

1000mm wide x 500mm deep x 350mm high

#### HLL 105/45

1000mm wide x 500mm deep x 450mm high

#### HLL 105/55

1000mm wide x 500mm deep x 550mm high

#### OPTIONS:

- Steelwork in galvanised finish only
- Timbers with UV protective finish

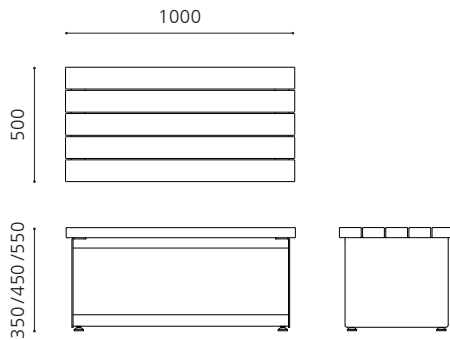

### HOLLO BENCH / TABLE - LARGE CUBE FORM

Steelwork galvanised & polyester powder coated to any RAL colour reference, iroko timber slats in smooth planed finish

#### HLL 1010/35

1000mm wide x 1000mm deep x 350mm high

#### HLL 1010/45

1000mm wide x 1000mm deep x 450mm high

#### HLL 1010/55

1000mm wide x 1000mm deep x 550mm high

#### OPTIONS:

- Steelwork in galvanised finish only
- Timbers with UV protective finish

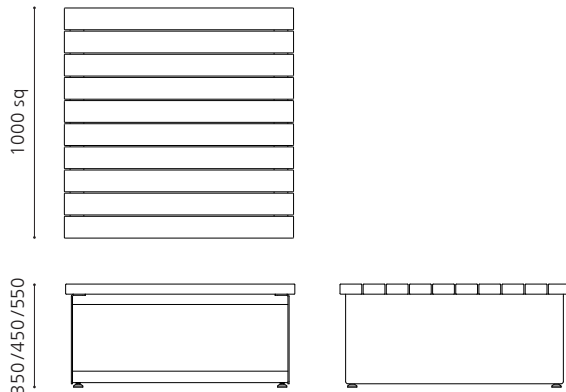

## HOLLO RANGE

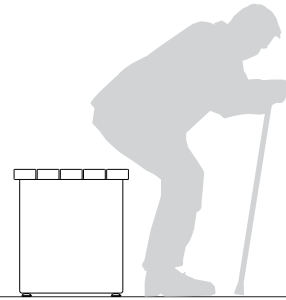
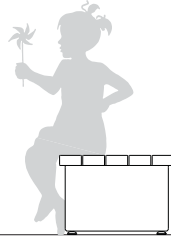
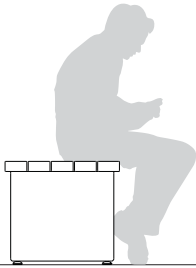

### 450mm high

450mm is the optimum seating height for most adults, but a little too high for children and slightly low for the less able-bodied and most elderly people.

### 350mm high

A 350mm high surface is more suited for children to sit on, though may still be too high for infants. The same height is also suitable for use as a low coffee table.

### 550mm high

Elderly and less able-bodied people can struggle to lower themselves onto and off standard 450mm high seats, whereas 550mm high is generally more manageable.

### Example layouts

With all standard units based on a 500 x 500mm grid, many different layout configurations are possible. Here, Hollo products are shown arranged in small clusters around a central unit which acts as a table.



5 x HLL 55/45 Hollo Small Cubes



1 x HLL 1010/45 Hollo Large Cube  
4 x HLL 105/45 Hollo Long Form

## HOLLO RANGE

### Freestanding / movable products:

All units are fitted with 4 screw-in adjustable feet as standard. 350mm and 450mm high products can be left freestanding, assuming the site is sufficiently secure for theft not to be an issue. For 550mm high products we recommend that they are fixed down as they are less stable and may tip due to their increased height.

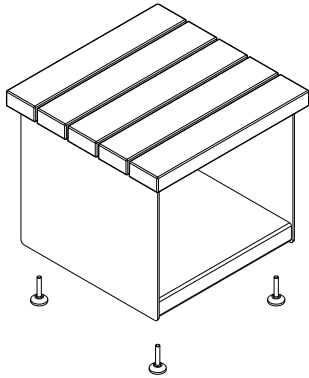

### Products weights:

Small cubes:

**HLL 55/35:** 28kg

**HLL 55/45:** 32kg

**HLL 55/55:** 35kg

Long Forms:

**HLL 105/35:** 43kg

**HLL 105/45:** 47kg

**HLL 105/55:** 50kg

Large cubes:

**HLL 1010/35:** 82kg

**HLL 1010/45:** 90kg

**HLL 1010/55:** 97kg

### Fixed products:

For fixing products to the ground remove the 4 pre-fitted feet by winding them out of their sockets and replace each with an M10 stud (recommended minimum 150mm long) to suit the planned foundation depth. By adding a nut to the stud beneath the underside of the product will allow height adjustment.

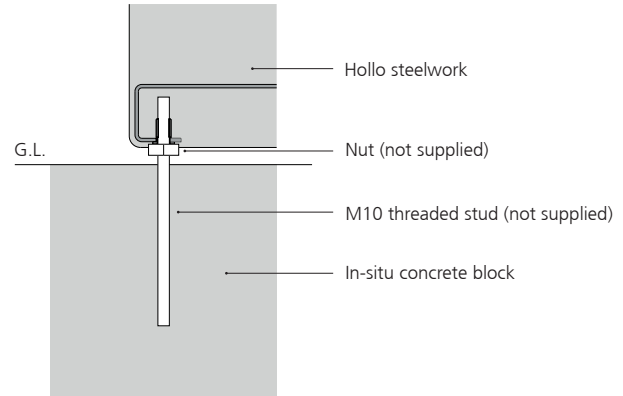

## PARALLEL RANGE



### Simple styling and robust construction

Parallel benches and tables are an ideal choice for outdoor dining areas that require a heavier duty and more contemporary-styled product than traditional timber picnic benches offer. The combination of a steel frame and closely-spaced slats make the benches and tables sufficiently heavy to be used as freestanding units on secure sites, but are also offered as bolt-down and in-ground options for more public areas. Bench and table-top slats are in iroko hardwood as standard, with selected models also available in wood plastic composite material. Two standard lengths are offered, to comfortably accommodate either 3 or 4 people per side.

#### Fixing options:



**1. Freestanding:**  
with levelling foot

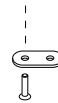

**2. Bolting down:**  
through base plate

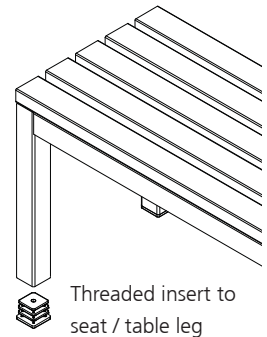

Threaded insert to  
seat / table leg



**3. In-ground fixing:**  
with threaded stud

## PARALLEL RANGE



### \* Notes re. heights:

The heights above ground level of bench & table modules vary slightly for different ground fixing options:

1. Freestanding: dimensions as specified
2. Bolting down: 10mm lower than specified
3. In-ground fixing: 15mm lower than specified

All fixing types use a bolt / stud that screws into the insert fitted into the leg, allowing height adjustment of up to 20mm. On sloping sites each leg can be adjusted independently so that top surfaces can be levelled.

### PARALLEL

Freestanding units, galvanised steel frame with iroko slats, smooth planed finish

#### BENCHES

##### PPB 6

3 person bench, 1800mm long

##### PPB 8

4 person bench, 2400mm long

#### TABLES

##### PPT 6

6 person table, 1800mm long

##### PPT 8

8 person table, 2400mm long

#### OPTIONS:

- Steelwork in powder coated finish, to any RAL colour reference
- Timbers with UV protective finish
- Wood plastic composite (WPC) slats (1800mm long versions only)
- Base-plated legs for bolt-down installation
- Threaded studs for for in-ground installation
- Umbrella hole (tables)

## PARALLEL RANGE

### Case study: Bow School, London

The Parallel range was originally designed for the Bow School development in London's East End. The tables and benches provide an extensive outdoor dining facility and were supplied as freestanding units to allow them to be readily moved around so that the space could be used for other purposes when required. The wood plastic composite (WPC) slat material was also used on long runs of purpose-made 'Contor' wall-top seating, including in a tiered amphitheatre arrangement, on Zenith seats and benches in the wider school envelope and for decking alongside a new pond. Fin cycle stands and Caledonian twin litter / recycling bins completed the suite of products supplied by Furnitubes to the impressive Bow School development.





## PARALLEL RANGE



## STIRLING BENCH RANGE

### Straight and curved benches for independent and continuous seating

The Stirling bench range comprises a modest number of straight and curved units that can be used independently or placed side-by-side to form longer seating runs. The bench width and length are compact compared with other seating ranges, but as the range does not include arms or backrests, they comfortably accommodate 3 people. The curved modules are designed around 3 standard radii - 1.0m, 1.5m and 2.0m - with a given number of common modules for each size combining to form full circles. Removing one or more benches from a full circle provides gaps between to access the central area. Waves can be achieved by changing the direction of common radius benches, while mixing different radii units and adding in straight benches allows any number of organic layouts. Curved benches can also be used to provide changes in direction to straight run seating, with series of angles from 45° up to 135° offered as standard.

#### Installation:

Each bench unit is supplied as a pre-assembled seat platform and 2 separate support posts for bolting together on site with supplied fixings. Each post should be set in a suitable concrete foundation. Adjacent units arranged for continuous lines of seating are installed independently.

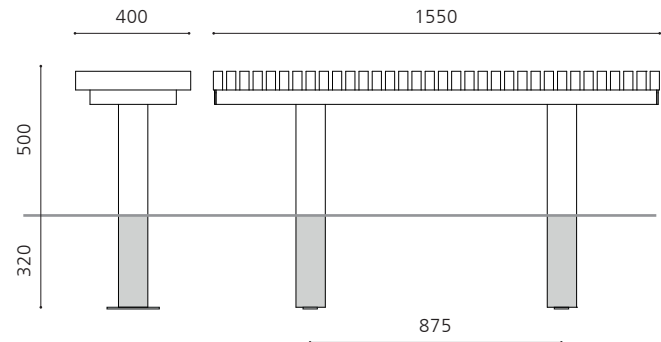

## STIRLING BENCH RANGE

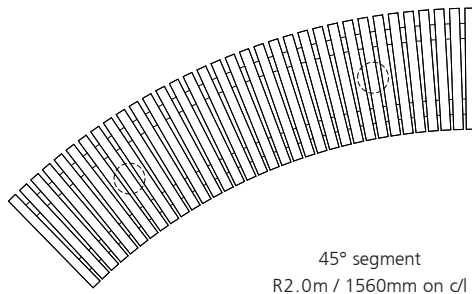
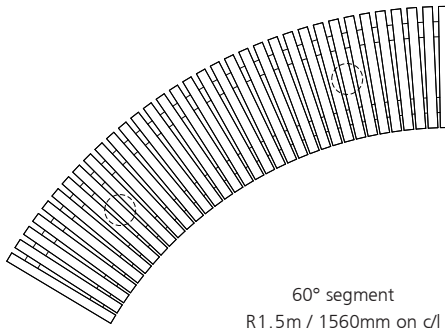
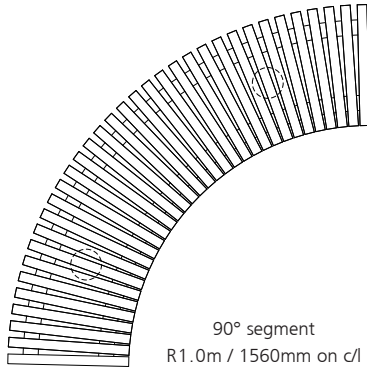
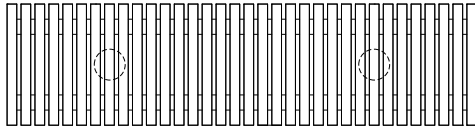

### STIRLING

Standard assembly: steel frame & posts for in-ground fixing in hot dip galvanised finish, with iroko timber slats in smooth planed finish

#### STL B5

3 person bench straight bench: 1550mm long

#### STL RB 104

3 person curved bench: 90° / 1.0m radius, 1560mm long centre line

#### STL RB 156

3 person curved bench: 60° / 1.5m radius, 1560mm long centre line

#### STL RB 208

3 person curved bench: 45° / 2.0m radius, 1560mm long centre line

#### OPTIONS:

- Base plated posts for bolt-down installation
- Framework & posts in polyester powder coated finish to any RAL colour reference
- Framework & posts in plastic coated finish, in selected colours
- Timbers with UV protective finish
- Other overall lengths, radii and segment angles / lengths







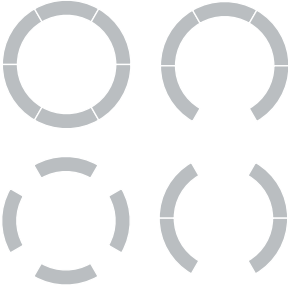
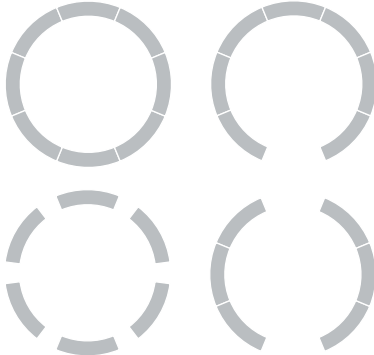

#### Plastic coating

A hardwearing plastic coated finish is available in the colours shown

■ RAL 9005 - Black	■ RAL 5015 - Blue	■ RAL 3020 - Red
■ RAL 7001 - Grey	■ RAL 6005 - Green	■ RAL 8017 - Brown
■ RAL 9016 - White	■ RAL 1021 - Yellow	

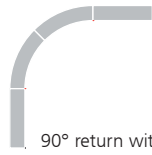

## STIRLING BENCH RANGE

BENCH SIZE >	90° / 1.0m radius (c/l)	60° / 1.5m radius (c/l)	45° / 2.0m radius (c/l)
<p><b>CIRCLES</b></p> <p>The angle and length of each standard curved bench is an equal division of 360°, allowing the following circular layouts:</p> <ul style="list-style-type: none"> <li>• Fully enclosed circles</li> <li>• Horsehoes</li> <li>• Open circles</li> </ul>	 <p>4 benches / Ø2.0m full circle (c/l)</p>	 <p>6 benches / Ø3.0m full circle (c/l)</p>	 <p>8 benches / Ø4.0m full circle (c/l)</p>
<p><b>WAVE FORMS</b></p> <p>Changing the direction of adjacent curved benches gives a low profile wave in plan. When arranged in twos or threes before a change in direction, the waves becomes more dynamic, especially on tighter radius benches.</p>			
<p><b>CORNERS / RETURNS</b></p> <p>As each curved bench has a different angle, a range of standard internal angles can be achieved from 45° up to 135°. Note that different angles have different radii depending on the curved bench sizes used.</p>	 <p>90° return with 1 x curved bench</p>	 <p>120° return with 1 x curved bench</p>  <p>60° return with 2 x curved benches</p>	 <p>135° return with 1 x curved bench</p>  <p>45° return with 3 x curved benches</p>  <p>90° return with 2 x curved benches</p>

## STIRLING BENCH RANGE



### Case study: George Green's School, London

A mature London Plane tree stands to both sides of the main entrance to George Green's School in London's Isle of Dogs. Over time, heavy footfall across the ground around the base of the trees had resulted in compaction of the soil, which posed a threat to the tree's long term health. The placement of benches around them is designed to deter pedestrians from walking close to the trees, thereby protecting the ground from further compaction. Using seats for this purpose (rather than fencing or posts) has provided useful seating for parents waiting to collect their children, and generally enhanced the entrance to the school. The Stirling range was chosen for this site as it provided all of the varying layout requirements from a single product range. Curved benches have been adjoined to form part-circles and straight benches have been linked to the circles, as well as being used as independent seats.

### For more options in a similar product style, consider the RailRoad range

If you are seeking additional features to your seating - such as armrests, backrests, different style supports, or even complementary tables - take a look at our RailRoad range. Using timbers on edge in the same style as Stirling products are designed, RailRoad has a similar aesthetic but offers many more options as standard, including a choice of seat support types, more and larger curves, and unique add-on features such as tablet surfaces.

To discover the full range of products in the RailRoad family, view or download RailRoad e-brochure at: <http://www.furnitubes.com/brochures>



## AXL BENCH & PLANTER RANGE

### Circular bench + optional integral planter

These unique circular benches were first developed by Furnitubes' in-house designers for the High Street improvement scheme in Lincoln city centre. The city council required seating with a significant visual presence to be used as part of traffic-calming measures as well as providing useful short term seating for shoppers. Manufactured in two sizes - to suit the available space and for visual variation - the steelwork was supplied in a hardwearing corten effect nylon coating, with the iroko hardwood slats in a finish coat to maintain good long term colouration. Following positive feedback received from the Lincoln installation, a complete new range - named Axl - has since been developed to offer seating in three different sizes, in four different forms (full, half and three quarter circles and a quadrant) and with the central pedestal available as a planter on larger full circle versions. Standard specification is a polyester powder coated finish over anti-corrosion zinc thermal sprayed steelwork and smooth planed iroko timber slats, though the unusual combination used at Lincoln and other scheme-specific finish requirements can be supplied on request.



## AXL BENCH & PLANTER RANGE

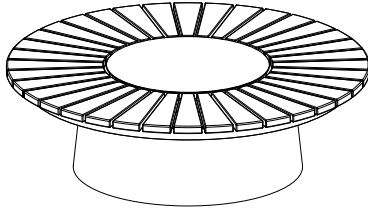

### Full circle bench

For open spaces where seating can be accessed from all sides

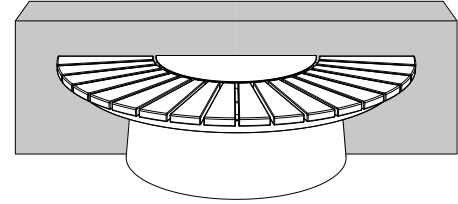

### 1/2 circle bench

For placement against straight walls

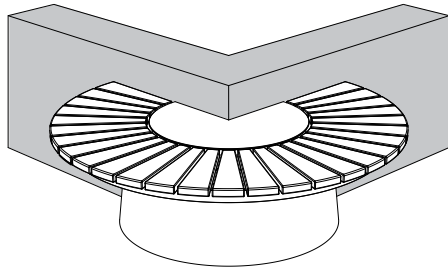

### 3/4 circle bench

Wraps around external 90° corner walls

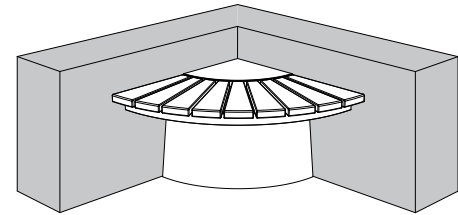

### 1/4 circle bench

Fits between internal 90° corner walls

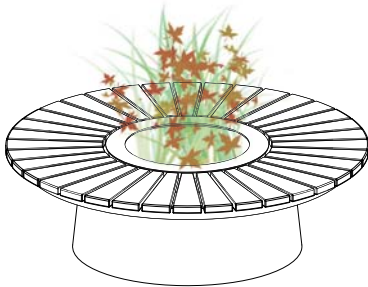

### Full circle planter bench

Open centre allows central pedestal to be used as a planter

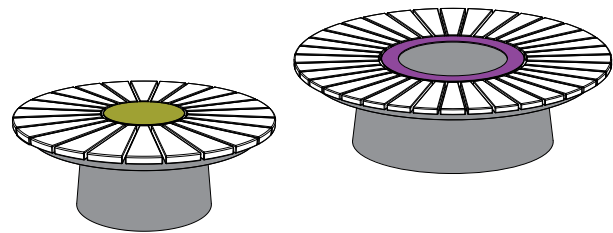

### Colourway options

Bolt-on top plate / ring allows contrasting colours to the pedestal

## AXL BENCH & PLANTER RANGE

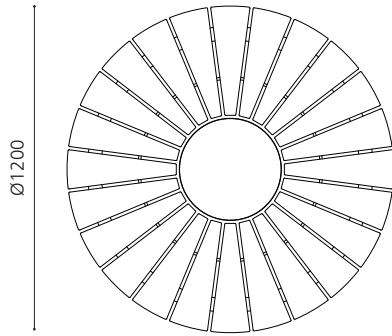

Ø1200

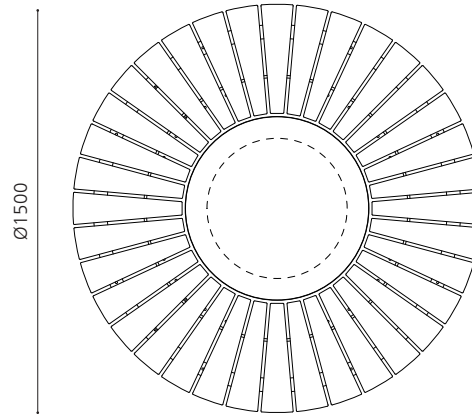

Ø1500

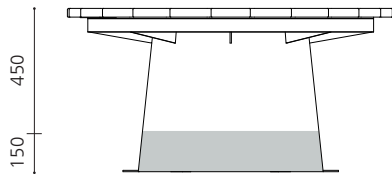

450

150

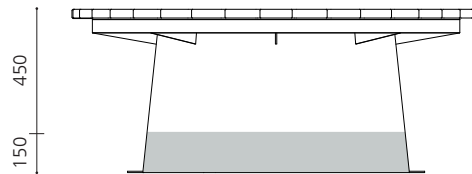

450

150

### AXL

Full / part circular benches with steel base, zinc thermal sprayed and polyester powder coated to any RAL colour ref, iroko timber slats in smooth planed finish

#### AXL 120

Full circle Ø1200mm (R600mm)

#### AXL 120 34

3/4 circle R600mm (Ø1200mm)

#### AXL 120 12

1/2 circle R600mm (1200 x 600mm)

#### AXL 120 14

1/4 circle R600mm (600 x 600mm)

#### AXL 150

Full circle Ø1500mm (R750mm)

#### AXL 150 PL

Full circle Ø1500mm (R750mm)  
with open top for internal planting

#### AXL 150 34

3/4 circle R750mm (Ø1500mm)

#### AXL 150 12

1/2 circle R750mm (1500 x 750mm)

#### AXL 150 14

1/4 circle R750mm (750 x 750mm)

#### OPTIONS:

- Armrests
- Steelwork in nylon coating
- Timbers with UV protective finish



## AXL BENCH & PLANTER RANGE

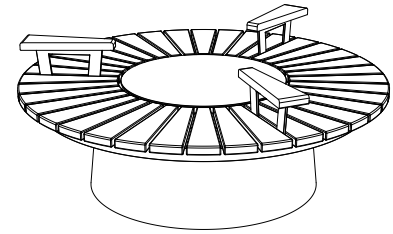
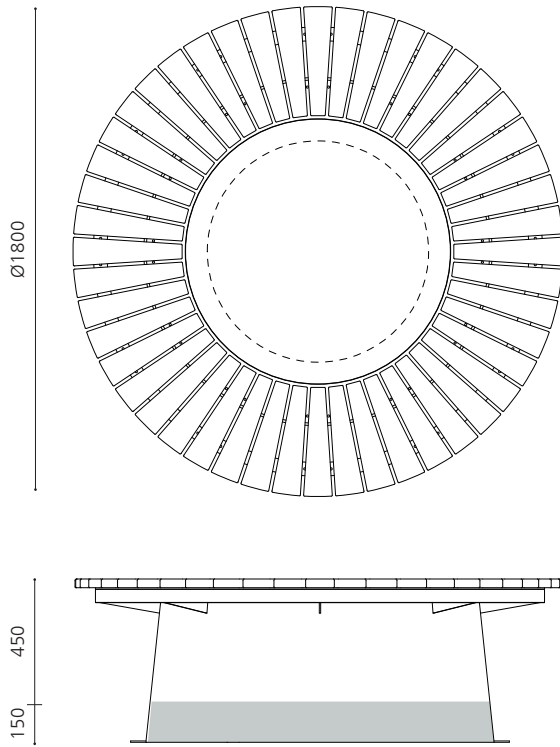

### Armrests

All benches are available with armrests which comprise a tapered timber pad discretely fixed to a supporting steel fabrication, which itself is welded to the bench sub-frame. Illustrated below are the positions that armrests can be placed to maintain appropriately-sized gaps between for an average sitter. It is not necessary to have all the armrests as shown, for example on the Ø1500mm bench 3 equally spaced armrests would give 3 seating segments, each accommodating 2 people.

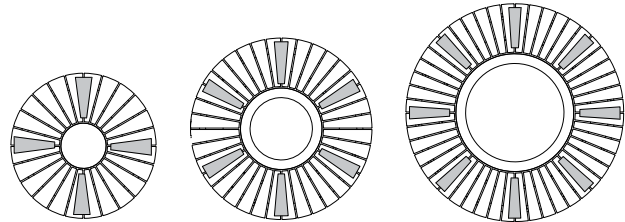

Ø1200mm  
4 arms maximum

Ø1500mm  
6 arms maximum

Ø1800mm  
8 arms maximum

### AXL

Full / part circular benches with steel base, zinc thermal sprayed and polyester powder coated to any RAL colour ref, iroko timber slats in smooth planed finish

#### AXL 180

Full circle Ø1800mm (R900mm)

#### AXL 180 PL

Full circle Ø1800mm (R900mm)  
with open top for internal planting

#### OPTIONS:

- Armrests
- Steelwork in nylon coating
- Timbers with UV protective finish

#### AXL 180 34

3/4 circle R900mm (Ø1800mm)

#### AXL 180 12

1/2 circle R900mm (1800 x 900mm)

#### AXL 180 14

1/4 circle R900mm (900 x 900mm)

### Installation

Given the width of the pedestal it is unlikely that paving will be sufficiently flat to allow for an above-ground bolt-down installation that achieves a level seating surface.

Benches are therefore designed to be bolted down to a below-ground foundation, via tabs welded to the pedestal, pre-drilled for M12 ground fixings (not supplied).

Note: planter pedestals are open-based as standard to allow through-drainage.

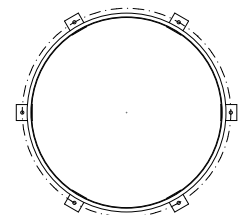

## BOSTON RANGE

### Popular coordinated seat and bench range

The Boston seating range was originally designed to utilise the seat and backrest framework from the original Zenith range, but end-mounted on seating standards rather than on post supports. The range has since been modified and expanded to include seats and benches both with and without arms to form a fully coordinated family. Circular rails to the front and back edges of the seating platform of all products, and to the top and bottom of the backrest for the seat version, add rigidity and strength to the products whilst also protecting the timber slats from accidental knocks and general wear and tear. The seat and benches are designed for 3 people as standard, although alternative sizes can be made to suit specific schemes. Steelwork is offered in a galvanised finish, but is also available in a supplementary polyester powder or plastic coated finish, and in various grades and finishes of stainless steel.

### Plastic coating

A hardwearing plastic coated finish is available in the colours shown

- |                    |                     |                    |
|--------------------|---------------------|--------------------|
| ■ RAL 9005 - Black | ■ RAL 5015 - Blue   | ■ RAL 3020 - Red   |
| ■ RAL 7001 - Grey  | ■ RAL 6005 - Green  | ■ RAL 8017 - Brown |
| ■ RAL 9016 - White | ■ RAL 1021 - Yellow |                    |



## BOSTON RANGE

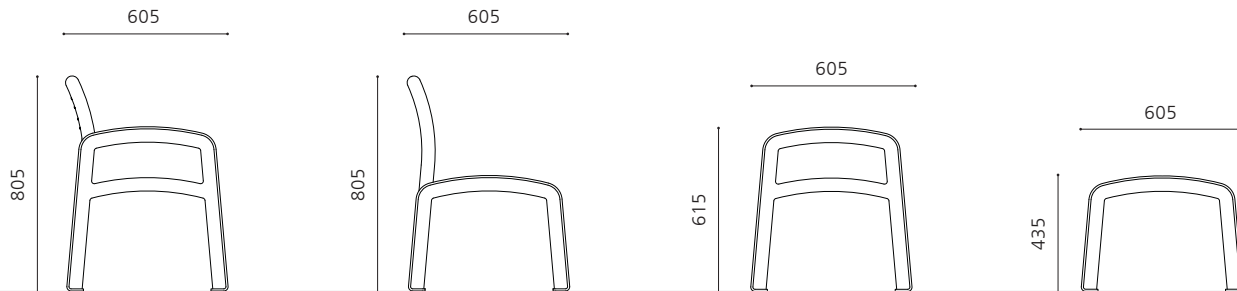

### Installation:

Each foot on the seat / bench standards is pre-drilled with for an M12 ground fixing (not supplied) for bolting the bench down to a suitable foundation block.

### BOSTON

Galvanised steel standards and framework with iroko timber slats in smooth planed finish

#### BOS 6A

Seat with integral end armrests  
1945 mm long

#### BOS 6

Seat (no armrests),  
1945 mm long

#### BOS B6A

Bench with integral end armrests,  
1945 mm long

#### BOS B6

Bench (no armrests),  
1945 mm long

### OPTIONS:

- Steelwork in polyester powder coated finish, to any RAL colour reference
- Steelwork in plastic coated finish, in selected colours
- Steelwork in stainless steel, various grades and finishes
- Timbers with UV protective finish
- Wood plastic composite (WPC) slats
- Anti-skate devices
- Alternative lengths

## ELTHAM, LIVERPOOL & OXFORD RANGES

### Contemporary styling at affordable prices

The Eltham, Liverpool and Oxford ranges of seats and benches combine a perforated plate seating platform mounted on contrasting decoratively-shaped polished stainless steel standards. Although specified and built for the exterior environment, the style of these ranges also make them a popular choice for interior locations, such as atriums and building entrance lobbies. Although each range is styled slightly differently and is available in different configurations - the Eltham is a seat only with an optional armrest, whereas the Liverpool and Oxford ranges are available as both seats and benches, all with integral armrests - there is sufficient similarity to the products to allow them to be used together on the same scheme. The single-piece pressed and perforated seat / backrest platform is manufactured from stainless steel but offered in a polyester powder coated finish to any given RAL colour reference. The same perforated detail is also used on other products from our range, such as the Liverpool litter bin, that enables a coordinated suite of products to be used. Given their high specification, the Eltham, Liverpool and Oxford ranges offer good value for money.



## ELTHAM, LIVERPOOL & OXFORD RANGES

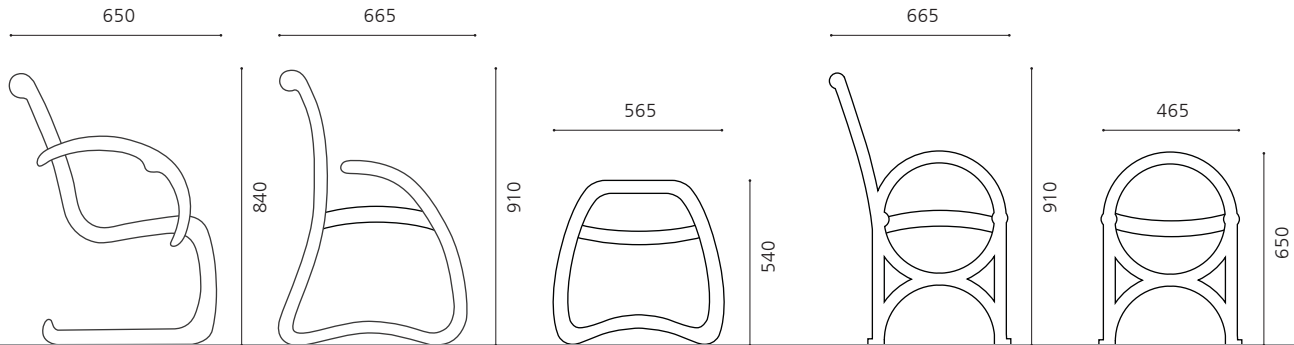

### Assembly and installation:

All seats are supplied flat-packed, complete with fixings, tools and instructions for self-assembly, which will require two people. Each end standard has 2 no. holes for M10 or M12 ground fixings (not supplied) for bolting down to a suitable foundation.

#### ELTHAM

All-stainless steel seat with bright polished finish standards and PPC platform

##### ELT 6

3 person seat without arms, 1850mm long

##### ELT 6 ARM

3 person seat with arms, 1850mm long

#### LIVERPOOL

All-stainless steel seat with bright polished finish standards and polyester powder coated (PPC) platform

##### LVR 6

3 person seat, 1850mm long

##### LVRB6

3 person bench, 1850mm long

#### OXFORD

All-stainless steel seat with bright polished finish standards and polyester powder coated (PPC) platform

##### OXF 6

3 person seat, 1850mm long

##### OXF B6

3 person bench, 1850mm long

### OPTION (ALL SEATS & BENCHES):

- Seat platform in polyester powder coated finish to any RAL colour reference

## WAVE® BENCH

### Contemporary Scandinavian design

The Wave bench - a Swedish design produced under exclusive license in the UK by Furnitubes - is a popular choice for contemporary landscape schemes. The wave profiles are formed by precision-pressed steel slats, contoured for comfortable seating, but not so for lying on. The bases of the slats are covered with a cast iron (or bronze if preferred) base, which conceals the ground fixings beneath. The standard specification for the Wave bench is a galvanised finish for long term corrosion resistance, with supplementary options of various colour coated finishes, and is also available in stainless steel. Complementary litter bins are available in two size options.

#### Plastic coating

A hardwearing plastic coated finish is available in the colours shown

■ RAL 9005 - Black	■ RAL 5015 - Blue	■ RAL 3020 - Red
■ RAL 7001 - Grey	■ RAL 6005 - Green	■ RAL 8017 - Brown
□ RAL 9016 - White	■ RAL 1021 - Yellow	

#### WAVE

Galvanised steel bench with cast iron base cover

#### WAG 2

2-person bench, 1410 mm long

#### OPTIONS:

- Painted or polyester powder coated finish to any RAL colour reference
- Plastic coated finish, in selected colours
- Stainless steel, various grades and finishes
- Cast bronze base cover, as-cast or polished finish
- Without base cover

#### Wave® Bench. All rights reserved.

The Wave bench is Copyright Protected & may not be reproduced without the prior permission of Furnitubes International Limited or the original Copyright holder. Copyright © 1996. Designed by Gunilla Hedlund for Nola.

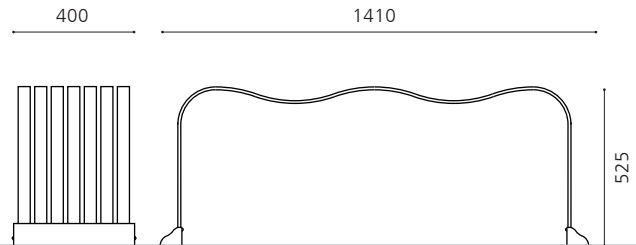

#### Installation:

The base plate at each end of the bench is pre-drilled with 2 no. holes for M10 or M12 ground fixings (not supplied) for fixing to a suitable foundation block. A cast iron base cover hides the ground fixings and is fitted to the steel bench.



## DELTA RANGE

### Soft-form design in multiple options

The Delta range of seats is characterised by its rounded organic-form cast iron seat standards. There are two designs in the range - one with armrests, which has a lighter weight seat standard, and the other without armrests but with wider / heavier castings. Informal arrangements of single seats in pocket parks are a particularly popular application for the Delta, as are the long benches used alongside pathways in parks. The range comprises 6 variations in total - accommodating 1, 3 or 6 people and all with or without armrests. Timber slats are pre-treated to maximise their resistance to weathering.

#### Installation:

The base of each foot is threaded to accept an M10 stud / fixing (not supplied) for anchoring into a ground foundation

#### DELTA

Cast ductile iron seat standards, painted grey with tropical hardwood slats with anti-fungidical, insecticide and water-proof treatments in natural colour

#### SEATS WITH ARMRESTS

##### DEL 2A

1 person chair  
650mm x 685mm x 835mm

##### DEL 6A

3 person seat  
1700mm x 685mm x 835mm

##### DEL 9A

6 person seat  
3000mm x 685mm x 835mm

#### SEATS WITHOUT ARMRESTS

##### DEL 2

3 person bench  
650mm x 685mm x 835mm

##### DEL 6

3 person high bench  
1700mm x 685mm x 835mm

##### DEL 9

6 person seat  
3000mm x 685mm x 835mm

Dimensions stated are length x width / depth x overall height



With  
armrests



Without  
armrests



## NEO RANGE

### Longstanding contemporary favourite

The Neo is a popular range of seats with multiple options and configurations, most often used in parks and open spaces. The style of the range uniquely suits the character of almost any scheme - from modern new developments to historic settings, and the economic design makes also it affordable for general amenity areas. The full range comprises a single person chair, 2 seat lengths, and standard benches, all featuring integral armrests. Seat and bench standards are manufactured in robust ductile cast iron and coated in a silver finish, and the seat platforms and backrests are in hardwood in a choice of 3 coloured finishes.

#### Installation:

The base of each foot is threaded to accept an M10 stud / fixing (not supplied) for anchoring into a ground foundation





### NEO

Cast ductile iron seat standards, coated silver with tropical hardwood slats with anti-fungidical, insecticide and water-proof treatments in natural colour

#### NEO 2A

1 person chair  
700mm x 710mm x 800mm

#### NEO 6A

3 person seat  
1800mm x 710mm x 800mm

#### NEO 12AC

6 person seat  
3000mm x 710mm x 800mm

#### NEOB6A

3 person bench  
1800mm x 630mm x 655mm

#### OPTIONS (ALL SEATS & BENCHES):

- Hardwood slats in blue or green coated finish

Dimensions stated are length x width / depth x overall height



## CONTEMPORARY SEATING

### Contemporary continental styling

In addition to our extensive choice of British seating designs, Furnitubes offers a range of contemporary European-styled street and park seating, characterised by striking designs and unusual combinations of materials and finishes. Lorca, Murcia and Menorca are modern designs based on the traditional combination of metal (corten steel, stainless steel and ductile cast iron respectively) seat supports with timber seating platforms. The Alicante introduces a steel backrest, whilst the Saville and Granada designs are all-steel constructions. All of the seats from this collection will make a significant statement in any contemporary-styled new development, and introduce a European design flair to your scheme.



## CONTEMPORARY SEATING



### ALICANTE

Steel standards - powder coated lightly textured finish in copper, blue or green colours  
Tropical hardwood slats, with anti-fungidical, insecticide and water-proof treatments

#### ALI 7

4 person seat, 2000mm x 650mm x 865mm



### LORCA

Cast ductile iron seat standards, painted grey  
Tropical hardwood slats, with anti-fungidical, insecticide and water-proof treatments

#### LOR 9

4 person seat, 2300mm x 600mm x 830mm

#### LOR B9

4 person bench, 2300mm x 600mm x 450mm



### MURCIA

Corten seat standards  
Tropical hardwood slats, with anti-fungidical, insecticide and water-proof treatments

#### MUR 2

1 person chair, 615mm x 635mm x 765mm

#### MUR 8

4 person seat, 2400mm x 635mm x 765mm

Dimensions stated are length x width / depth x overall height



### MENORCA

Stainless steel framework in polished finish;  
tropical hardwood slats with anti-fungidical, insecticide & water-proof treatments in black finish

**MEN 6** - 3 person seat, 1800mm x 730mm x 860mm

**MEN 7** - 4 person seat, 2000mm x 770mm x 845mm

**MEN 7AC AS** 4 person seat (with central arm),  
2000mm x 770mm x 845mm



### SEVILLE

All-steel construction throughout, powder coated finish; platform in RAL 9006 silver grey, end supports in black

#### SEVB7

4 person bench, 2000mm x 630mm x 510mm



### GRANADA

Steel, powder coated black

#### GRA5 A

3 person seat (with arms),  
1660mm (l) x 610mm (w) x 815mm (h)

#### GRA5

3 person seat (without arms),  
1660mm (l) x 610mm (w) x 815mm (h)

Dimensions stated are length x width / depth x overall height

## PRESIDENT RANGE

### Modular seating system

The President seating range is a modern, flexible seating solution suitable for both interior and exterior use, and is most commonly used in waiting areas to public building entrances / foyers and particularly at transportation hubs. Independent seating units are fixed to a continuous support beam, which allows for different colours to be used on these two components. Steelwork can be either plastic coated steel or polyester powder coated. Armrests are available as optional add-ons.

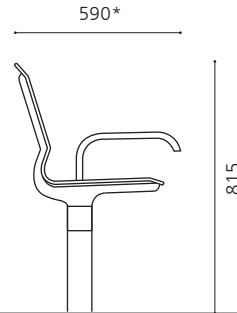

\* 515 without armrest



### PRESIDENT

All-steel construction polyester powder coated finish

#### PRS A3

3 module seat, 1505 mm long

#### PRS A4

4 module seat, 2055 mm long

#### PRS A5

5 module seat, 2605 mm long

#### OPTIONS:

- Base plated posts for bolt-down installation
- With armrests at preferred positions
- Polyester powder coated finish to any RAL colour reference
- Plastic coated finish, in selected colours
- Seat pans and framework in differing colours

#### Plastic coating

Steelwork is available in a hard-wearing plastic coated finish in the following choice of colours

- RAL 9005 - Black
- RAL 7037 - Grey
- RAL 6005 - Green

- RAL 5011 - Steel blue
- RAL 5021 - Water blue
- RAL 3020 - Red



# CONTEMPORARY SEATING

© Furnitubes Ref: S-298-03-17

[www.furnitubes.com](http://www.furnitubes.com)



tel: 020 8378 3200

## CONTEMPORARY SEATING & TABLES



View or download other product e-brochures at the following link:

[www.furnitubes.com/brochures](http://www.furnitubes.com/brochures)



© Furnitubes

 **Furnitubes**<sup>®</sup>

3rd Floor, Meridian House, Royal Hill, Greenwich

**LONDON SE10 8RD**

**T:** +44 (0)20 8378 3200

**F:** +44 (0)20 8378 3250

[sales@furnitubes.com](mailto:sales@furnitubes.com)

[www.furnitubes.com](http://www.furnitubes.com)