



## BESPOKE SEATING PROJECTS



Public realm furniture design  
& innovation from Furnitubes



## BESPOKE SEATING PROJECTS

©Furnitubes Ref: 5565-02-16

[www.furnitubes.com](http://www.furnitubes.com)



tel: 0208 378 3200

## INTRODUCTION

### Site-specific seating designs

Outdoor seating is a major component in most landscape schemes and makes a significant contribution to the overall character of any development. Even with our extensive range of standard products and flexible approach to adaptations, we recognise that there is often a requirement for site-specific bespoke seating. Our team of expert product designers is able to assist you in the process of designing new seating solutions, from concept through to detailed design and installation, offering technical and budgetary advice along the way. We work with the latest 3D modelling software which allows you to fully understand and contribute to the design during its development. Where there are budgetary constraints that don't allow truly original new designs to be developed for a site, we are able to offer variations to our standard designs - such as different lengths, back-to-back assemblies, additional armrests or incorporation of local themes - especially on seats constructed mainly in steel and timber. Please contact our Design department to discuss the feasibility and likely costs of developing new designs or adapting any of our standard products.

Here are just some of our exclusive standard seating ranges that have either a large number of configuration options, can be arranged in many different ways or can be readily adapted to create unique assemblies or layouts. Brochures can be downloaded at the following link:

<http://www.furnitubes.com/brochures/seating-e-brochures>



#### RailRoad Seating

Modular design ideal for long continuous seating runs, with straight and curved modules allowing for an almost endless number of layout options



#### Seven Seating

A range of five standard assemblies that can be used as independent units or used together in interesting assembly forms.



#### Elements Seating

Unique range of interchangeable components in a choice of conventional & unusual materials, all of which fix to a common chassis.

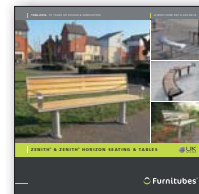

#### Zenith Seating

A longstanding popular range of steel & timber seats, benches & tables, including curved units, available in a large number of size options.



## OUR DESIGN CAPABILITY

### Take a seat.....

Whilst our designers have the knowledge and expertise to design across a broad range of products, seating presents the most challenges and opportunities for genuinely innovative new design and is an area in which we particularly enjoy working. Seating design is a major contributor to the character of any new scheme and presents the ultimate challenge of balancing form and function. We take pride in delivering unique and inspiring designs, whether client-led or our own creations.

### Philosophy

As designers and manufacturers, consideration of buildability is at the forefront of our minds with a new product. By establishing the important features of the design at the outset, these principles are upheld throughout product development. We also believe that attention to detail is critical, together with consideration of future maintenance and component replaceability in order to maximise product lifespan. We discuss cost estimates and programme at an early stage to ensure that it is realistic to deliver a new design on time and within budget.

### Capability & expertise

Furnitubes works in all major materials and manufacturing methods, including fabricated and cast metals, timber and concrete. All products are 3D modelled using Autodesk Inventor software, and we can create 3D pdfs to allow clients to view new designs in detail before commencement of manufacture. On completion of the design we can also generate ifc files for inclusion in BIM models.

### Service

With 4 full time qualified and dedicated designers we believe that we can offer an unparalleled and unique service in street furniture design. New product innovation is at the core of Furnitubes' philosophy and we welcome the opportunity from clients to demonstrate our design and manufacturing expertise.

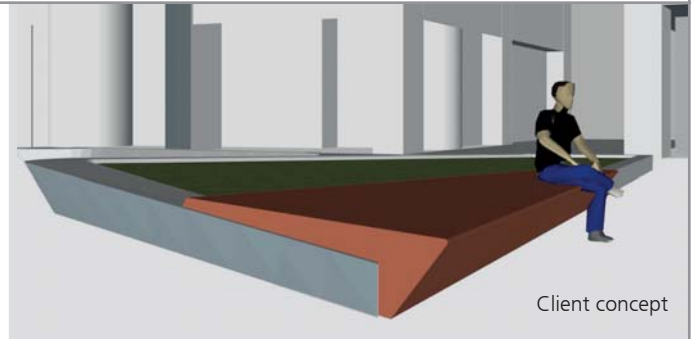

Client concept

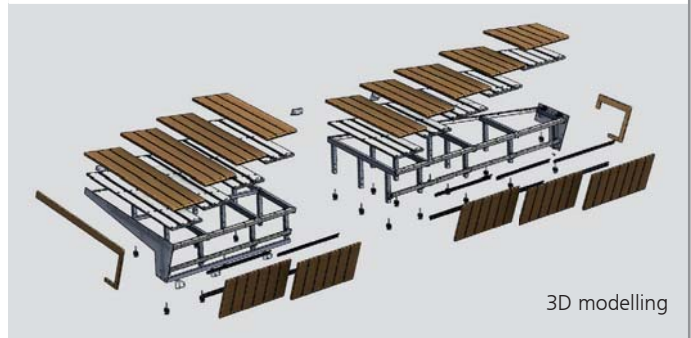

3D modelling



Visualisation

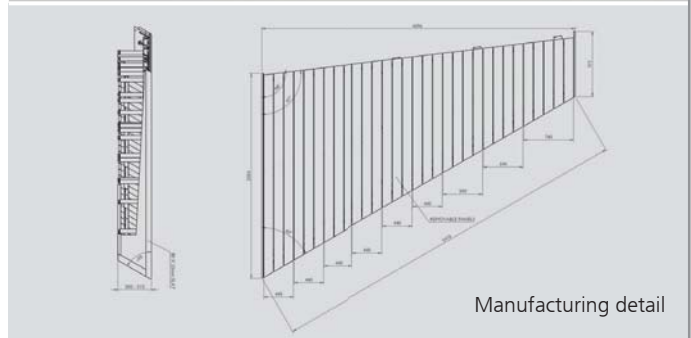

Manufacturing detail

## THE DESIGN TEAM



### **Nigel Abbott**

BA(Hons) MA CMLI

#### **Design Manager**

Nigel is in his second spell at the company, re-joining in 2012 after practicing as a chartered Landscape Architect for over 10 years, and now leads the Design Team at Furnitubes. Responsible for new in-house product development, Nigel is also uniquely positioned to offer practical and technical advice on product interface with wider hard landscape construction details.

#### **Contact Nigel**

[nigelabbott@furnitubes.com](mailto:nigelabbott@furnitubes.com)

Direct dial: 0208 378 3202

Mobile: 07823 331 469

### **David Gowing**

BEng(Hons) MA AMIMechE

#### **Design Office Manager**

David has worked at Furnitubes for over 20 years, joining from his early career in automotive engineering. David is the first port of call for technical advice or enquiries about bespoke products, and manages the daily departmental workload. Given his length of service, David has an unparalleled knowledge of the industry as a whole and of our own extensive product range.

#### **Contact David**

[davidgowing@furnitubes.com](mailto:davidgowing@furnitubes.com)

Direct dial: 0208 378 3222

### **Esteban Piñero**

BA BEng

#### **Lead Product Designer**

Esteban joined us in 2014 after 5 years in a similar role at a Spanish architectural metalwork company. Esteban is a creative designer with sound materials and manufacturing process knowledge, and is an expert in 3D modelling software. Fluent in Spanish and French, (as well as English and his native Basque) Esteban's language skills are often useful when dealing with overseas enquiries.

#### **Contact Esteban**

[estebanpinero@furnitubes.com](mailto:estebanpinero@furnitubes.com)

Direct dial: 0208 378 3231

### **Amran Ali**

BA(Hons)

#### **Product Designer**

Amran joined the team in 2014 following his first post-graduate job in interior furniture. Amran has successfully transferred his skills into the design of exterior products to become a valued member of the team. He is mostly office-based, supporting David in dealing with client enquiries, and is also a skilled 3D modeller who can work across many digital applications.

#### **Contact Amran**

[amranali@furnitubes.com](mailto:amranali@furnitubes.com)

Direct dial: 0208 378 3212

### **Andrew Elliott**

HND (3D Design)

#### **Product Designer**

Andrew is the newest member of the team, joining us in 2016 after completion of his recent studies. Prior to this Andrew's roles included product manufacture in sheet metal and landscape construction, both of which have relevance to his position as Product Designer at Furnitubes. Andrew is now our lead on all matters BIM and our most skilled operator in Revit software.

#### **Contact Andrew**

[andrewelliott@furnitubes.com](mailto:andrewelliott@furnitubes.com)

Direct dial: 0208 378 3205



## THOMAS MORE SQUARE LONDON

### Angular seating platforms tailor-made for raised planting beds

Thomas More Square is a 'business village' on the edge of the City of London, adjacent to St Katherine Docks and the Tower of London beyond. Works undertaken in 2015 were the first major redevelopment of the site since its construction in 1990. In addition to upgrades to the 6 major buildings, the public realm in between was also subject to re-design by landscape architects BDP. The previously uninspiring space of hardstanding, small grassed areas and isolated trees has been transformed into a high quality area with new paving, built-in planters and significant new seating provision to allow office workers and visitors to enjoy the outdoor environment. BDP approached Furnitubes with a concept seating design of intersecting angled planes to fit into dedicated alcoves set into raised planters. From this concept our designers developed the complex geometry by 3D modelling each of the 6 unique seating structures, and the complementary large scale wall-top platform. Seating was used in mirrored pairs either side of the main walkway and included flat benches, and seats with single plane and compound angle backrests, all custom-designed and made to fit the challenging levels of the site. The seating was designed on the principle of timber panels fitting over an internal steel frame, with hidden fixings used throughout. In the opinion of all parties involved in the project, the seating looks stunning and truly enhances the quality of the external spaces of Thomas More Square.



## THOMAS MORE SQUARE LONDON



## THOMAS MORE SQUARE LONDON

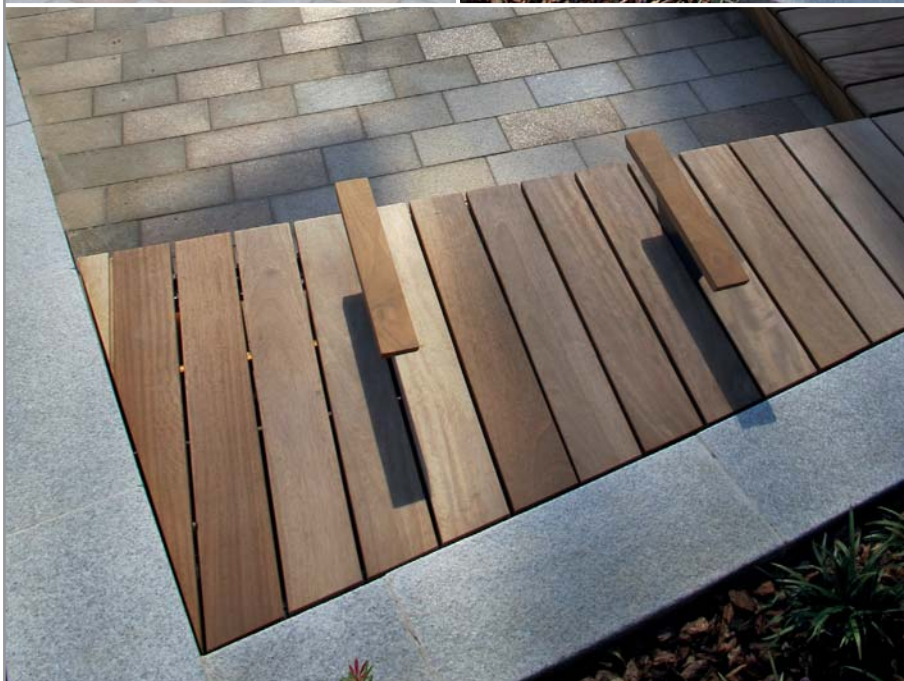

## THOMAS MORE SQUARE LONDON



## DOLLAR BAY LONDON

### Public realm and private garden seating

Dollar Bay is a residential development of 115 apartments and penthouses in Canary Wharf, London. Dollar Bay's prime location at the eastern end of the South Dock makes for spectacular views across the ever-changing Docklands' skyline. From the original client seating concept Furnitubes developed detailed designs for public realm quayside benches and a variety of seating solutions to the private garden, including bench seating around raised planters, linear seating beneath a pergola, bespoke recliners and picnic benches. Materials used include granite, flamed to match the paving and walling, and European oak in an oiled finish.

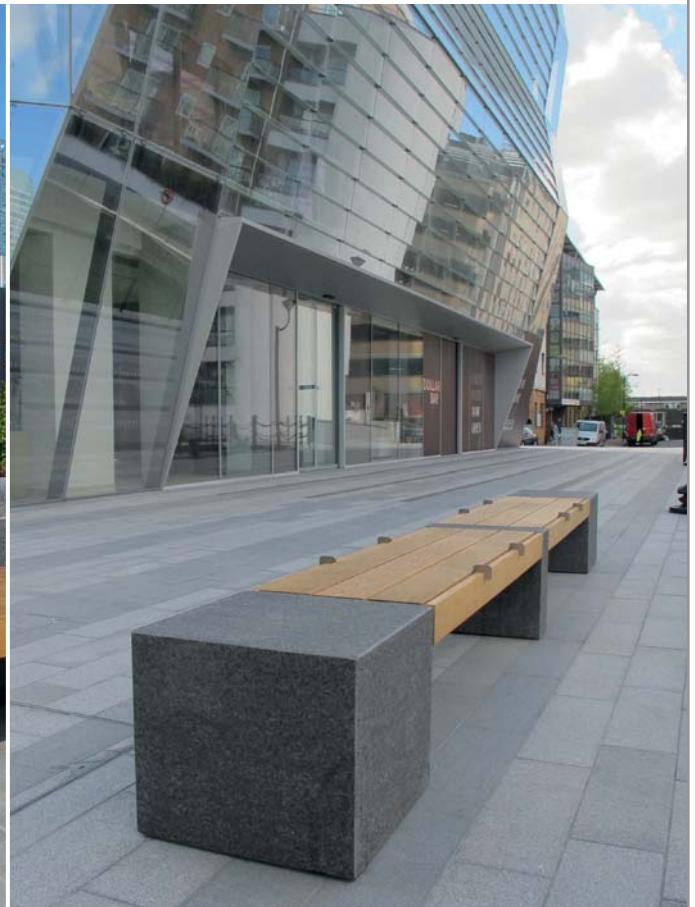
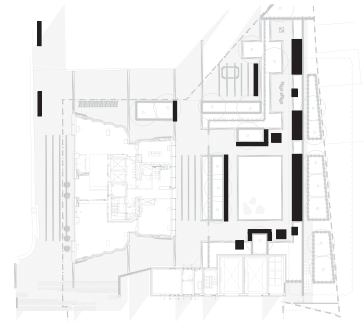

## DOLLAR BAY LONDON



## PETERBOROUGH LONG CAUSEWAY

### Feature seating for high street scheme

Peterborough City Council set Furnitubes the challenge of designing a series of benches that would become central features of the Long Causeway regeneration project. The brief was to design a large central circular seating arrangement that could incorporate poems written by local school children, with complementary smaller scale circular benches to either side. From outline concepts and discussion of material options, the designs were developed into multi-material forms that included polished granite support blocks, powder coated steel frames and oiled timber slats. In the central bench the poem lettering was engraved into bronze plates inset along the centre line of the seats and pre-treated to give a visually-rich weathered patina. Under-seat lighting was designed into the central benches to make them equally prominent features during the evening as they are during the day. Set within new paving custom-designed around the circular seating arrangement, the street scene of Long Causeway is much improved for shoppers, workers and visitors to the centre of Peterborough.



## PETERBOROUGH LONG CAUSEWAY



## BOND STREET MAYFAIR

### High class seating for London's West End

Bond Street (which actually comprises New Bond Street and Old Bond Street) is the only continuous thoroughfare between Oxford Street to the north and Piccadilly to the south, through London's Mayfair area. The street has long been synonymous with luxury goods, art and high fashion, and also has many other major attractions nearby, including the Royal Academy. Relatively narrow for the most part, the street was primarily designed to accommodate vehicles and was not particularly pedestrian-friendly. Publica, a London-based urban design and public realm practice, was commissioned to carry out a detailed audit of the current public realm conditions to inform a redesign of the street. A series of major improvements is now underway - including extensive highway realignment and resurfacing - which seek to rebuild the identity of Bond Street as a destination in its own right, rather than simply as a route or thoroughfare. More generous footway dimensions now gives the opportunity to include seating on Bond Street for the first time, offering shoppers, visitors, workers and passers-by somewhere to relax and enjoy the new surroundings. It was felt that the seating should be custom-designed and use high quality materials in keeping with the setting. The design of the cast bronze posts and armrests, with their polished edges and embossed hallmark details, are inspired by materials and details used in the jewellery trade, which Bond Street is well known for. Seating surfaces are in cumaru hardwood, treated with an ebony colour UV protective finish which perfectly complements the bronze. Two benches have been installed - one at 3m and the other at 3.6m long - as a pilot scheme, with further seating provision to follow if they are well received by local stakeholders and the public.



## BOND STREET MAYFAIR



## RUSKIN SQUARE CROYDON

### Multi-form seating and perimeter rails

Situated in the heart of Croydon, Ruskin Square is a 2 million sq ft development designed to create a high quality environment in which to work, relax and live, ultimately providing 625 new residential units. Eleven major new buildings are being constructed, interlinked with expansive new public realm provision, with the focal point being the creation of this exciting new space designed by **muf architecture / art**. Encircled by a ring of twelve specimen Pin Oak trees set in planting beds interspersed with sculptures, gateways and stepping stones lead to the central open space that is paved with recycled jarrah timber. Furnitubes' designers worked closely with **muf** architects in the development of a wide range of seating forms, providing three dimensional models and full scale prototypes for consideration en route to the final designs. Variations include plain seats and benches, reduced-scale seating for children, kissing seats and leaning platforms, many of which utilise the post and rails around the perimeter planting beds for the mounting of backrests, resulting in a very unique and site-specific design solution for the Ruskin Square scheme.

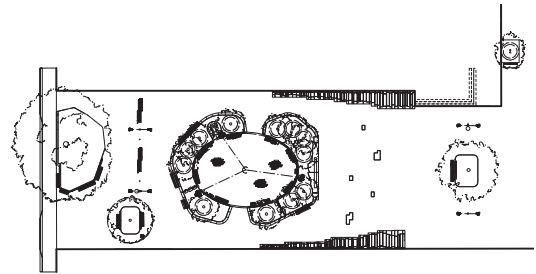

## RUSKIN SQUARE CROYDON



## BROWN HART GARDENS LONDON

### Seating and planters for unique London site

Brown Hart Gardens is a unique elevated city square set on top of a Grade II listed electricity substation in Mayfair, central London. Originally created to provide an ornamental garden for residents in the surrounding Peabody housing estate, the site was closed in the 1980s. Grosvenor Estate sought to renovate the 10,000 sq foot gardens with the addition of a new café building, complete re-surfacing and with extensive new seating provision and planting to be enjoyed by local residents, workers and visitors in the Oxford Street area. Furnitubes supplied over sixty bespoke seating and planter products to the Gardens. Concept designs for the products were originated by BDP landscape architects and carefully detailed by Furnitubes' designers in close consultation with the project team. Three basic design modules were supplied – heavy duty fixed seats for the perimeter of the site, and planters and benches for the central area which could be moved around to allow the space to be adapted for a variety of events. The site, which is now open to the public, provides a tranquil and intimate setting in the heart of London's busy West End. Brown Hart Gardens was awarded best new public space in the London Planning Awards 2014, with particular recognition for its ingenuity and historical sensitivity.



## BROWN HART GARDENS LONDON



## PORTSMOUTH HOT WALLS



### **Benches creating a wave**

The Hot Walls - part of Portsmouth's harbour fortifications dating back to the 15th Century - have stood as open empty structures for many years. The Hotwalls Studios scheme, paid for by a £1.75m grant from the government's coastal communities fund and local authority funding, has transformed the arches into 13 working studios for artists, designers and creative companies, as well as a new brasserie and cafe, all aimed to breathe new life into the arches in much the same way as has been achieved at Brighton seafront. The arches themselves have been fitted with new glass frontages and heated to provide comfortable new premises for local businesses. The open space to the front of the arches has been re-paved around existing sculptural art pieces, and 7 new 3.5m wave-form benches manufactured by Furnitubes have been installed around established trees alongside the Broad Street pavement. The benches - manufactured in grade 316 stainless steel appropriate for their coastal location, with curved-form timbers in iroko hardwood - provide the ideal opportunity for visitors to sit and enjoy this exciting redevelopment area in the heart of historic Old Portsmouth.

## PORTSMOUTH HOT WALLS



## DREAMLAND MARGATE

### Amphitheatre-style seating for historic amusement park

First opened as a pleasure gardens in the late 19th century, Dreamland is a historic amusement park in the seaside town of Margate, Kent. The park's Grade II\* listed near-100-year-old Scenic Railway wooden rollercoaster remains the centrepiece of the park today. Dreamland has long been an iconic attraction in the town - even featuring in the Only Fools and Horses "Jolly Boys' Outing" 1989 Christmas special - but had gradually fallen into decline over a number of years. Dreamland has undergone a major redevelopment in 2017 and re-opened on a free-to-enter / pay-per-ride basis to encourage higher visitor numbers. The attractions are vintage-themed, with rides including traditional fairground favourites such as a big wheel, waltzers and dodgems, all set within well-planted landscaped grounds. Key to the future success of the Dreamland is its programme of music at the new main stage, with a capacity of 15,000 for major events. To the front of the stage is a large 'civic plaza', beyond which is a grassed bank alongside the perimeter of the site that offers perfect views to the stage, with a backdrop of 3m high DREAMLAND letters. An informal arrangement of stone steps and seating has transformed the bank into an attractive amphitheatre-style setting. Furnitubes designed and supplied 250 linear metres of timber-topped seating platforms for fitment to various lengths of concrete blocks, all based around common module sizes and in straight segments at lengths that could be arranged radially to give the impression of curved seating, but without the expense of making individually dimensioned platforms for each seat. The seating platforms and accompanying front panels comprise iroko timber hardwood slats securely fastened to galvanised steel frames, themselves discretely fitted to the concrete blocks beneath. As well as offering provision for the main stage music events the amphitheatre seating is proving to be a popular meeting and resting point for day-to-day visitors to Dreamland.



## DREAMLAND MARGATE

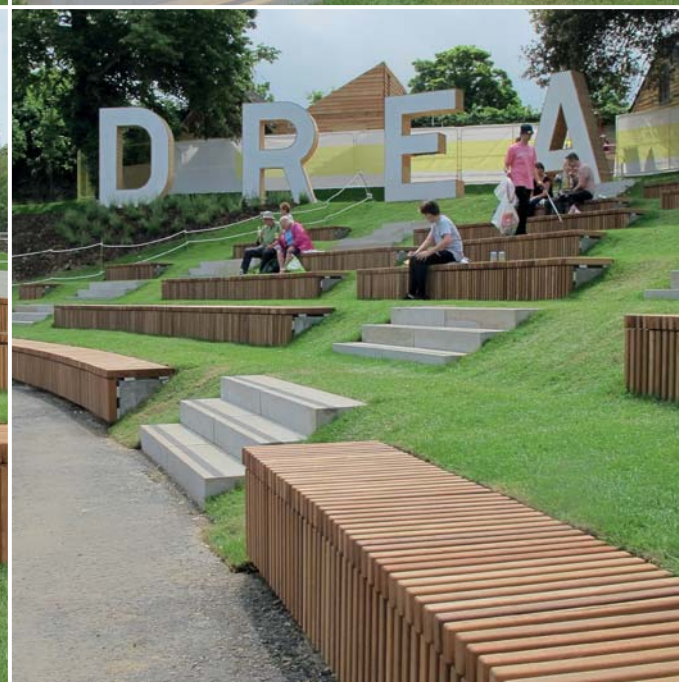
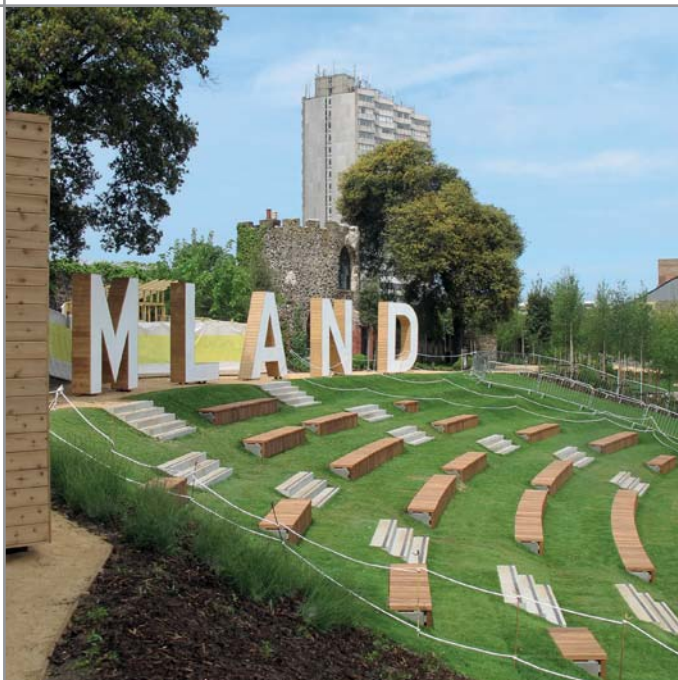

## LOCKLEAZE GAINSBOROUGH SQUARE BRISTOL

### Pavilion seating for local neighbourhood public open space

Gainsborough Square is a public open space in the Lockleaze neighbourhood, in the northern suburbs of Bristol. With no significant amenity facilities, the open space at the heart of the community was somewhat under-used and neglected. In a bid to rejuvenate the neighbourhood, Bristol City Council have invested £2.5 million into the regeneration of the square and its surroundings. As part of the development the City Council commissioned MUF Architecture to contribute to the vision of the overall public realm for the area. MUF's work included research amongst local people, setting up community projects including 'Our Dream Today, Your Dream Tomorrow' and running workshops. One outcome of the findings led to the proposal for a permanent pavilion structure in Gainsborough Square, as a central feature to be used as a meeting point for local people and as a focus for community events. MUF utilised Furnitubes' expertise in design and manufacture to develop a seating solution that integrated with and was fixed to the substructure of the pavilion. The products comprise a steel frame with recycled plastic boards for the seating surface, in 3 subtle colour shades as used for the pavilion deck and with outer ends of the seats sloping down to meet the pavilion deck. The new pavilion has proved to be a popular centrepiece at Gainsborough Square since its unveiling at a community event hosted by Bristol City Council.



## LOCKLEAZE GAINSBOROUGH SQUARE BRISTOL



Dream It, Build It, muf architecture/art, 2016. Photo © Max McClure, courtesy of the artist and Bristol City Council

## DUDLEY CORONATION GARDENS

### Seating in the round

Coronation Gardens - a picturesque green space in the centre of the Black Country town of Dudley - has undergone a major upgrade to enhance the town's historic quarter and to create a physical link between the town centre and Dudley College campus. Central to the scheme is an amphitheatre which is available to community groups and the college for open air productions. Constructed with a gabion wall to the rear, curved units were required to provide comfortable seating provision for approximately 50 people. Furnitubes developed and submitted a series of seating designs incorporating a combination of steel structures and timber-slatted seating surfaces, designed as common modular assemblies in order to be produced as economically as possible, but not to look too ordinary. The final designs were loosely based around our popular Elements seating range and included polished stainless steel fascia panels and support posts, with complementary armrests in selected positions. The 12 seating modules are arranged in a 3-6-3 sequence, with the gaps between allowing wheelchair users to be accommodated within the amphitheatre seating layout. Furnitubes also supplied independent seating to the scheme from our Zenith Horizon range, including benches, seats with backrests and picnic tables. We are proud to have been involved in the Coronation Gardens scheme and pleased that it has been well received and to see the site being well used since its re-opening.



## DUDLEY CORONATION GARDENS



## KINGS CRESCENT HACKNEY

### Quirky variations to Metropolitan seats

The Kings Crescent Estate in Stoke Newington, North London, has been transformed with a mix of 490 brand new homes, improvements to existing homes and new amenities designed to benefit both new and current residents. The project design team has been led by Karakusevic Carson Architects with MUF Architecture / Art responsible for the public realm. New streets within the development include an unusual collection of features - large boulders, bespoke play structures and natural interventions of stacked logs - all arranged in an informal manner that challenges street layout convention. A significant amount of seating is provided on the development and MUF Architecture / Art used Furnitubes' timber-slatted Metropolitan seat as the starting point for their bespoke seating concepts, which have delivered 7 new and unique seating solutions. Several seats offer child-friendly low level surfaces, which is something of a trademark with MUF's seating designs on this and other schemes on which we have previously collaborated. Another characteristically quirky feature is a seat constructed around a newly-planted tree, with a cut-out section allowing for the future growth of the tree. The steelwork seating frames are coated in black and ivory colours to complement the hues of other materials used on the development, combined with iroko hardwood slats in a natural planed and uncoated finish, which will fade to a silver-grey patina over time. These very unusual seating forms perfectly complement the eclectic mix of public realm features evident throughout the new Kings Crescent Estate.



## KINGS CRESCENT HACKNEY



## CHOBHAM MANOR STRATFORD

### Residential street and urban park seating

Chobham Manor is one of five new neighbourhoods being built at Queen Elizabeth Olympic Park in Stratford, east London. Sited close to Lea Valley Velopark - formerly known as the Olympic Velodrome, where Chris Hoy, Victoria Pendleton and many other Team GB cyclists triumphed at London 2012 - new streets have been named using cycling terminology, including Peloton Avenue and Keirin Road. Over the next 20 years nearly 7,000 new homes will be constructed in the area, together with nurseries, health centres and multi-purpose community spaces, alongside world-class sporting venues, all located within an attractive parkland setting. Chobham Manor Phase 1 contains 1500 square metres of publicly accessible open space, including a neighbourhood play area for young children. Bounded by a mixture of garden-style walling and low level steel railings, together with extensive new perimeter tree planting, the central space is surfaced with a synthetic turf to provide an all-year-round play facility. The chosen seating for the scheme was Furnitubes' municipal-styled Newstead range. Project architects MUF Architecture / Art did though put their own unique twist on the designs, including some exceptionally high backrests that straddle the boundary fence to provide low level child-friendly seating on the play area side. On the street, the seating is more conventional, generally arranged in linear groups to encourage social interaction and placed to take advantage of attractive vistas across the development.



## CHOBHAM MANOR STRATFORD

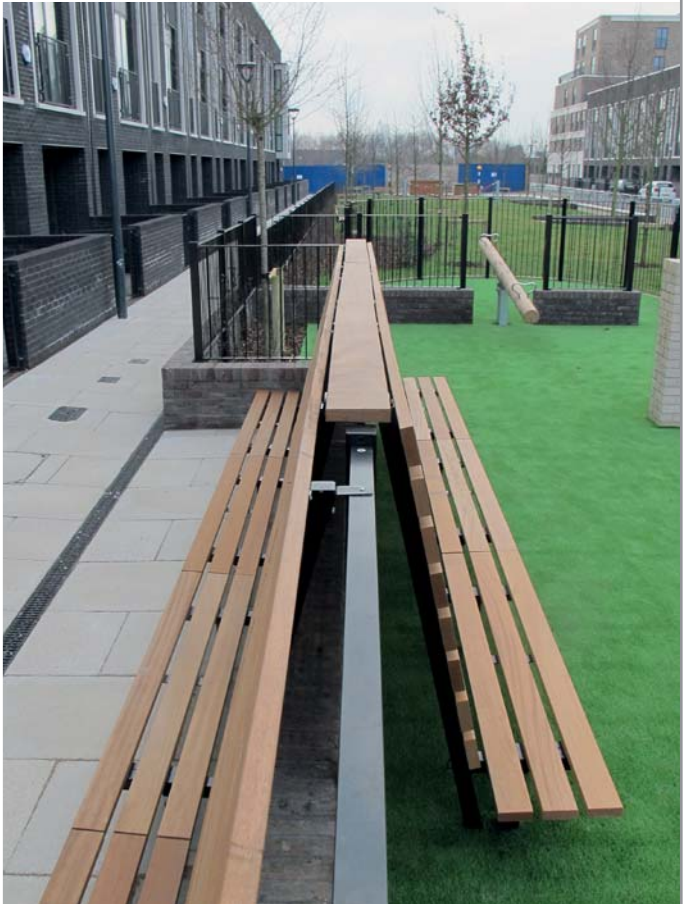

## SHOREDITCH MARK STREET GARDENS

### Seating circle for urban park

Mark Street Gardens is a small, tranquil green space close to the busy Great Eastern Street in London's popular Shoreditch area. Created as recently as the 1980s following clearance of the Langbourne Buildings, the gardens are one of Hackney's youngest parks, although it has a historic setting alongside the former St. Michael's Church. Recent improvement works coincide with the first Green Flag Award application for the gardens. A circular arrangement of new seating set around an existing memorial stone is a central feature to the new works. Furnitubes' designers were set the challenge of devising a 3-part seating arrangement that would fit between existing lines of granite setts and alongside retained planting. The geometrical outcome was two dual segment benches and a single 3-segment assembly, all based around a common module size. The benches combine galvanised steel plates ends and subframe, which sit well within this urban environment, and oiled iroko hardwood slats. Armrests have been carefully positioned to allow maximum usage of the seating area but also to deter rough sleeping, which has been an issue at the gardens in the past.



## SHOREDITCH MARK STREET GARDENS



## TOTTENHAM GREEN LONDON

### Purpose-designed concrete seating wall

Tottenham Green is surrounded by many local building landmarks but the green itself was previously an unwelcome and underused site. The scheme was designed to create a 'civic heart' for Tottenham by delivering new landscaping, lighting, an improved network of paths, and play spaces to become an area that supports and promotes performance, events, commerce and a café culture. The provision of new seating was a key component in delivering this goal and Furnitubes supplied two main types – integrated seats / low level concrete retaining walls and stand-alone Elements products. The former were custom-designed to suit the site, though they utilise the construction principles of our standard Fortis range of seats. The inset and therefore flush-fitting timber-slatted seat platforms and angled face to the concrete blocks are unique features to this product. The independent Elements seats were selected for their versatility of configuration, with many options and variations of back and armrests providing a wide variety of seating provision to suit different users. Other products supplied to the scheme included Boston litter bins and Lucky dog waste bins.



## TOTTENHAM GREEN LONDON



## ADAPTED STANDARD RANGE SEATS

### Custom-designed variations to standard products

With many of our seating product ranges, particularly those constructed mainly in steel and timber, we are able to offer variations to the standard designs, such as different dimensions, back-to-back assemblies, additional armrests etc. Please contact our Design department to discuss the feasibility and likely costs of adapting any of our standard products, either pre-production or by retro-fitting additional features. Shown on the following pages are some examples of standard seating products custom-made to meet site-specific requirements.

Below:

#### Elements Platform

Seating platform supplied to Cardiff & Vale College



## ADAPTED STANDARD RANGE SEATS

Right:

### **Core concrete block wall seat**

Bespoke angled corner to match paving line at a housing development in Cambridge

Below:

### **Newstead seat**

Cantilevered frame with additional front facia and rear slats, with all boards in wood plastic composite; Payers Park, Folkestone

Below right:

### **Metropolitan Steel & Timber Seat**

High-backed single-piece back-to-back assembly, with a scaled-down infants seat for a community garden in Hackney, London



## ADAPTED STANDARD RANGE SEATS

Photo: Ian Clipson (Eclipseonimages)



Photo: Jon Fixter

Photo: Shelagh Wright



Photo: Place Architecture

## ADAPTED STANDARD RANGE SEATS

Photo: Simon Khan

### **RailRoad Delta**

The International Bomber Command Centre near Lincoln has been created to provide a world-class facility to serve as a point for recognition, remembrance and reconciliation for Bomber Command. The centrepiece to the site is the Memorial Spire designed by Place Architecture, around which a series of walls record all of the Command servicemen who lost their lives during WWII. Between the walls are planters and back-to-back / curved-on-plan RailRoad seats with the seat slats set out radially from the centre of the spire. Manufactured with a combination of steel support framework in a powder coated grey finish and timber-slatted seats and backrests, these materials complement the corten steel and gravel landscape palette used on the site.

© Furnitubes Ref: S-584-02-16

[www.furnitubes.com](http://www.furnitubes.com)



tel: 0208 378 3200

## BESPOKE SEATING PROJECTS



View or download other product e-brochures at the following link:

**[www.furnitubes.com/brochures](http://www.furnitubes.com/brochures)**



© Furnitubes

 **Furnitubes®**

3rd Floor, Meridian House, Royal Hill, Greenwich

**LONDON SE10 8RD**

**T:** +44 (0)20 8378 3200

**F:** +44 (0)20 8378 3250

[sales@furnitubes.com](mailto:sales@furnitubes.com)

[www.furnitubes.com](http://www.furnitubes.com)