

CONTEMPORARY SEATING & TABLES



CONTEMPORARY SEATING

© Furnitubes Ref: S275-04-17

www.furnitubes.com



tel: 020 8378 3200

INTRODUCTION

Boldly-designed individual products and small ranges

Outdoor seating is a major component in most landscape schemes and makes a significant contribution to the overall character of any development. Our Contemporary Seating range is a collection of individual seating products and small ranges generally characterised by their straightforward aesthetic and often bold design, with particular attention to detail. Seats such as the Fan and Wave are even sculptural in their appearance, thereby making a strong visual statement that helps reinforce the visual identity of an area. The range includes a wide variety of styles and materials, including steel in galvanised or coated finishes, stainless steels in various finishes, and with the majority of products employing timber slats for a warm and comfortable seating platform. As with all products across all our ranges, these seats are built to last.



Whilst our Contemporary Seating brochure contains mainly individual products and those which are part of small ranges, other contemporary-styled products which are part of larger families can be found in their own brochures, and can be viewed and downloaded at the following link:

<http://www.furnitubes.com/brochures/seating-e-brochures>



RailRoad Seating

Straight and curved modules ideal for long continuous seating runs, in an endless number of layout options



Seven Seating

A range of five standard products that can be used independently or together in interesting assembly forms

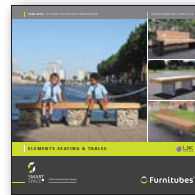

Elements Seating

A unique range of interchangeable components in a choice of conventional & unusual materials & finishes

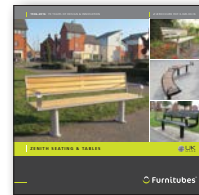

Zenith Seating

A longstanding popular range of steel & timber seats, benches & tables, including curved units

If you are unable to find a product to meet the exact requirements of your scheme, please call us to discuss the feasibility of adapting existing products or designing bespoke solutions, some examples of which are shown at the following link:

<http://www.furnitubes.com/street-furniture/seating-benches-special-commissions>



FORDHAM RANGE

Heavy duty seat, bench & table range

The Fordham steel and timber seating offers a bold appearance, heavy duty materials and a robust construction designed to offer the maximum resistance to vandalism required in tough urban environments. The bench is the basic form of the range, to which a backrest can be added to form a seat. Bench supports are fabricated I-beam profiles hot dipped galvanised as standard, on which are mounted iroko timbers (in the largest timber section profile across our entire seating range) with selected visible fixings, all combining to give a contemporary industrial aesthetic. Backrest slats are supported by a durable galvanised steel frame. Armrests in folded steel plate are available on all seats and benches, with standard fixing positions to maximise the useable seating space. Seats and benches are available in 6 standard lengths to comfortably accommodate up to 5 people, and the table is offered in 2 standard sizes, corresponding to 2 mid-size seating lengths.



FORDHAM RANGE

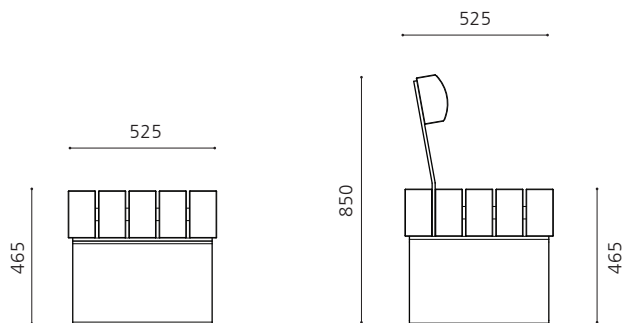

FORDHAM SEATING

Galvanised steel support frame with iroko timber slats, smooth planed finish

BENCHES

FOR B5

1500mm long

FOR B6

1800mm long

FOR B7

2100mm long

FOR B8

2350mm long

FOR B9

2685mm long

FOR B10

3000mm long

SEATS

FOR 5

1500mm long

FOR 6

1800mm long

FOR 7

2100mm long

FOR 8

2350mm long

FOR 9

2685mm long

FOR 10

3000mm long

OPTIONS:

- Polyester powder coated steelwork
- Armrests
- Timbers with UV protective finish

Installation:

Both seat / bench supports are pre-drilled with 4no. holes for M16 ground fixings (not supplied).

Seat backrests

Backrests, comprising a single timber supported on wide steel plates attached to the seat supports, are shorter than the seating platforms, as shown below.

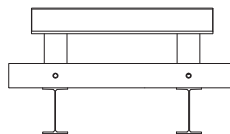

- **FOR 5** seat platform 1500mm long, backrest 1200mm long

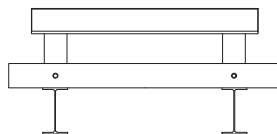

- **FOR 6** seat platform 1800mm long, backrest 1500mm long

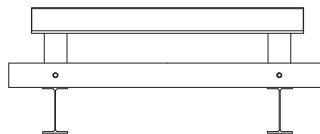

- **FOR 7** seat platform 2100mm long, backrest 1800mm long

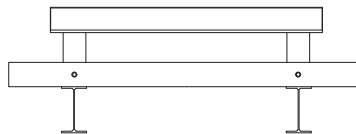

- **FOR 8** seat platform 2350mm long, backrest 1800mm long

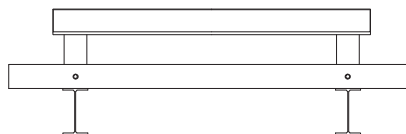

- **FOR 9** seat platform 2685mm long, backrest 2100mm long

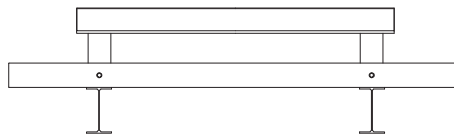

- **FOR 10** seat platform 3000mm long, backrest 2100mm long



FORDHAM RANGE



Armrests

Armrests are manufactured from heavy duty folded steel bars and can be pre-fitted to both benches and seats. Shown below are the maximum number of armrests for each seat / bench length that maintain suitable width seating spaces between.

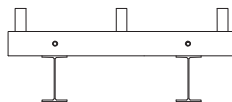

- **FOR B5 / FOR 5** 1500mm long, 3 arms max, 600mm spaces between

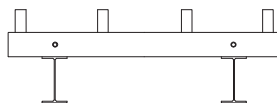

- **FOR B6 / FOR 6** 1800mm long, 4 arms max, 475mm spaces between

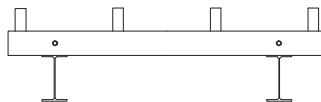

- **FOR B7 / FOR 7** 2100mm long, 4 arms max, 575mm spaces between

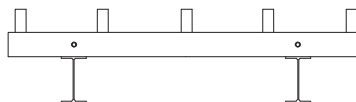

- **FOR B8 / FOR 8** 2350mm long, 5 arms max, 475mm spaces between

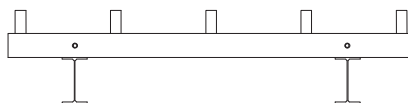

- **FOR B9 / FOR 9** 2685mm long, 5 arms max, 560mm spaces between

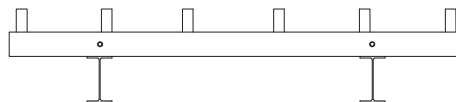

- **FOR B10 / FOR 10** 3000mm long, 6 arms max, 500mm spaces between



FORDHAM RANGE

Coordinated tables

The Fordham table is of a similar construction to the bench and seat from the same range, though the timber top slats are less deep, so more comfortable for the table user. Tables are available in 2 lengths, corresponding with 2 of the standard seating lengths. The option of a finish treatment to the table-top slats is advisable, as it provides not only UV protection that maintains the colour of the timber for longer, but also provides a degree of resistance to general grime and is easier to wipe clean.

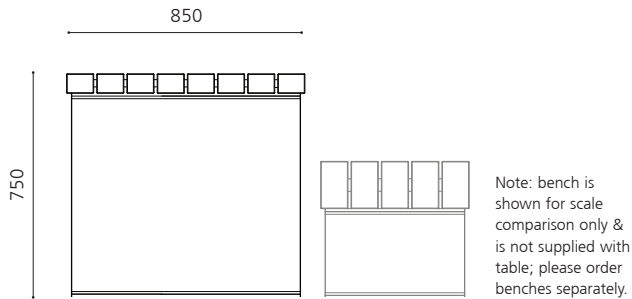

FORDHAM TABLES

Galvanised steel support frame with iroko timber slats, smooth planed finish

FOR T6

1800mm long

FOR T8

2350mm long

OPTIONS:

- Polyester powder coated steelwork
- Timbers with UV protective finish

Installation:

Both table supports are pre-drilled with 4no. holes for M16 ground fixings (not supplied).



VEEVA RANGE

Heavy duty straight & curved seating

The Veeva range is characterised by the wedge-shape seat supports, heavy duty timbers and its array of standard configuration options. Veeva offers independent units and modules that can be joined side-by-side to form longer seating runs, both in straight lines and four standard curved sizes. Curved modules can furthermore be arranged in full or broken circles and wave-forms. Backrests are straight, including those on curved seating, providing a cost-effective add-on feature that is available on all but the smallest radius version. Armrests are offered on all seating configurations. Iroko hardwood slats are arranged in a front-to-back orientation on straight and curved seating. On the straight versions only slats can also be used in a side-to-side arrangement, which changes the character of the seat and also reduces costs.



VEEVA RANGE



VEEVA RANGE

Independent benches and seats

A stand-alone independent unit is the traditional way of providing seating in many outdoor locations, allowing small groups of people to sit together. Standard length modules of straight and curved units in the Veeva range comfortably accommodate 3 people, and up to 4 at a tighter fit where armrests are not used.

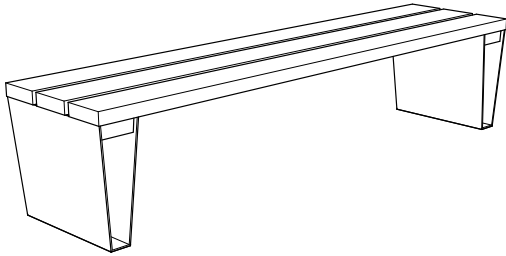

Independent Bench

Benches offer double aspect seating, which is useful where there are views or points of interest in both directions. Without a backrest, a bench is ideal as a short term rest point.

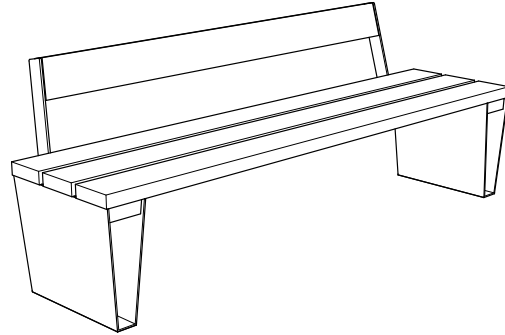

Independent Seat

The addition of a backrest improves the comfort of the seat for the user and encourages people to sit for longer.

Continuous run benches and seats

Longer runs of joined-up seating are a neat solution where high volume seating provision is required, taking up less space and also encouraging more social interaction compared with separated seats. Backrests can be used on all or just selected modules as required, as shown in this illustration.

Starter module (bench)

Seat platform + 2 supports

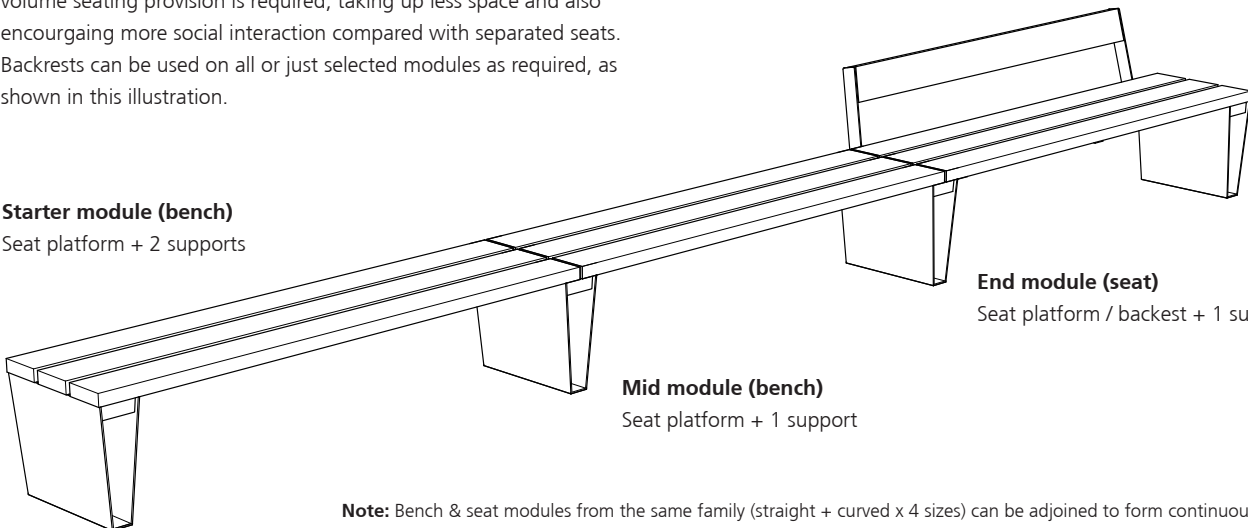

Mid module (bench)

Seat platform + 1 support

End module (seat)

Seat platform / backrest + 1 support

Note: Bench & seat modules from the same family (straight + curved x 4 sizes) can be adjoined to form continuous seating runs, but cannot be mixed across families, e.g. straight modules cannot be joined to curved modules.

VEEVA RANGE

Continuous run seating dimensions

The illustration below shows the points of measurement for starter, mid and end modules in a continuous straight seating run, and also the ground fixing points.

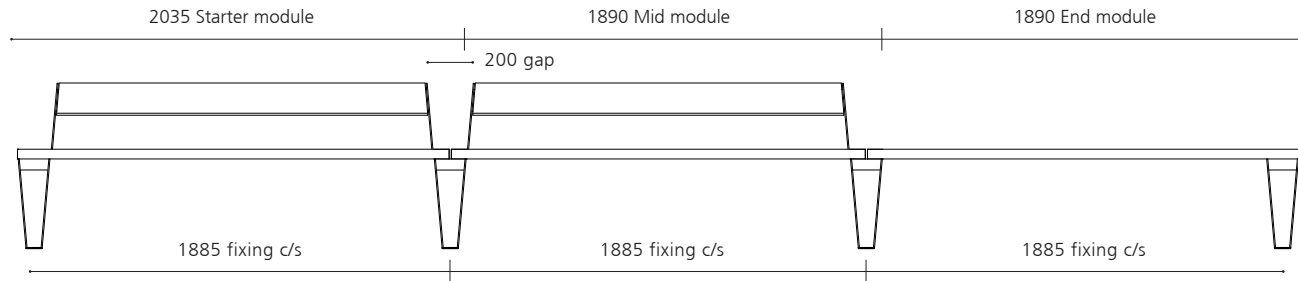

Armrests

Armrests define individual seating spaces and are particularly useful to less able-bodied people as an aid to lowering onto and alighting from a seat. Placement of armrests can also deter rough sleeping. The positions of armrests on all Veeva seating are pre-determined, set out as shown below, to provide a comfortable seating width and not to divide the seat into areas that result in unusable 'dead space'.

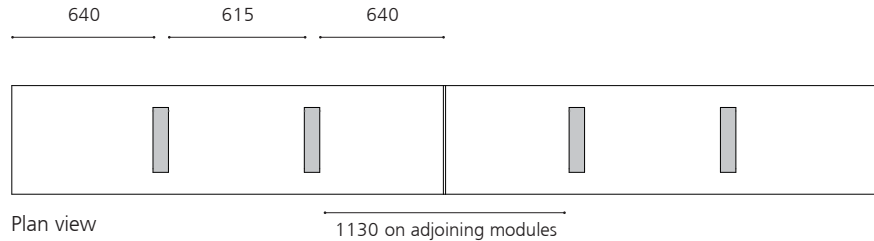
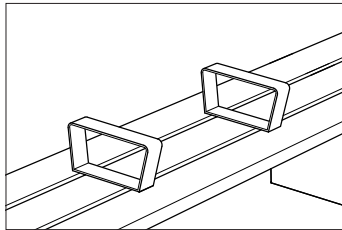

Installation

Each steel support on all Veeva seating units is pre-drilled with 2 no. holes for M10 ground fixings (not supplied). The internal spaces between the side plates of the supports are shown below. If there is insufficient space to use a spanner or socket to tighten a fixings, we suggest that a stud is pre-fixed to the underside of the support, which can then be set into a concrete foundation block or a cored hole in the paving.

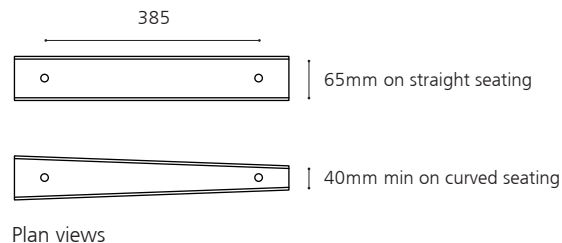

Pre-fixing a stud

Insert stud through support fixing hole and hand tighten the top nut.

Tighten locking nut onto stud on underside of support, holding top nut with a spanner to prevent rotation.

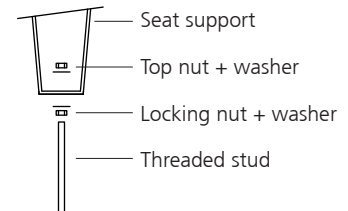

VEEVA RANGE

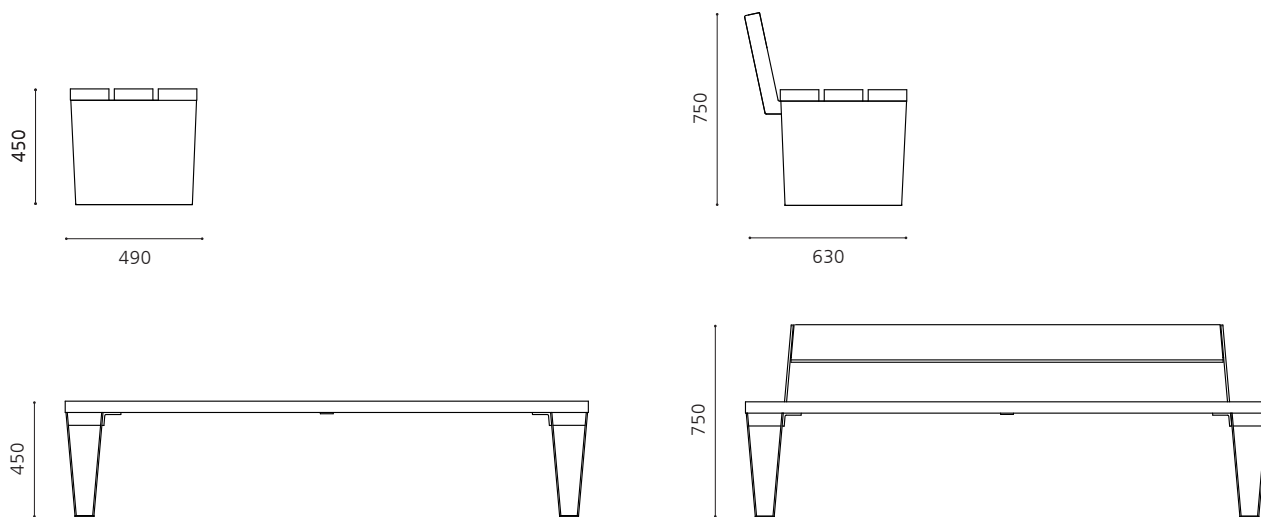

VEEVA STRAIGHT WITH SIDE-TO-SIDE PLATFORM SLATS

Standard assembly: steel supports & frames (where applicable) for bolt-down fixing in hot dip galvanised finish, with iroko timber slats in smooth planed finish

BENCHES

VEE B 2035

Independent, 2035mm long

VEE B 204 S

Starter module, 2035mm long

VEE B 189 M

Mid module, 1890mm long

VEE B 189 E

End module, 1890mm long

SEATS WITH BACKRESTS

VEE 2035

Independent, 2035mm long

VEE 204 S

Starter module, 2035mm long

VEE 189 M

Mid module, 1890mm long

VEE 189 E

End module, 1890mm long

OPTIONS:

- Armrest(s)
- Steelwork in polyester powder coated finish to any RAL colour reference, over plain steel or galvanising
- Timbers with UV protective finish

VEEVA RANGE

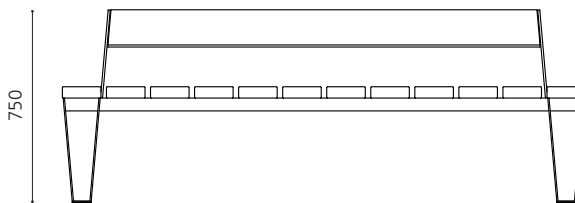
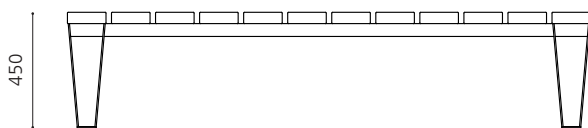
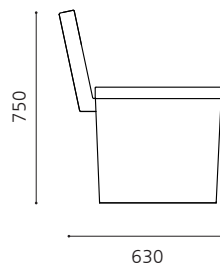
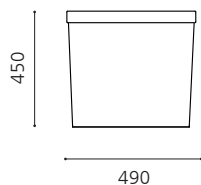

VEEVA STRAIGHT WITH FRONT-TO-BACK PLATFORM SLATS

Standard assembly: steel supports & frames (where applicable) for bolt-down fixing in hot dip galvanised finish, with iroko timber slats in smooth planed finish

BENCHES

VEE FB 2035

Independent, 2035mm long

VEE FB 204 S

Starter module, 2035mm long

VEE FB 189 M

Mid module, 1890mm long

VEE FB 189 E

End module, 1890mm long

SEATS WITH BACKRESTS

VEE F 2035

Independent, 2035mm long

VEE F 204 S

Starter module, 2035mm long

VEE F 189 M

Mid module, 1890mm long

VEE F 189 E

End module, 1890mm long

OPTIONS:

- Armrest(s)
- Steelwork in polyester powder coated finish to any RAL colour reference, over plain steel or galvanising
- Timbers with UV protective finish

VEEVA RANGE

Standard curved options to suit most sites

Curved seats and benches serve to visually break up orthogonal site layouts and emphasise features such as trees. They can be used independently, in pairs or multiples to create arcs and wave-forms, or linked to form complete circles. Four radii - from 1.8m up to to 3.6m - are offered as standard in the Veeva range, all configured around a given number of units to form a complete circle, with each segment designed to accommodate 3 people. Backrests are straight and are inset from the ends of the seating platforms, meaning the backrest is not continuous when curved modules are directly adjoined. Unlike most other seating in our range, the timber slats on curved Veeva seating are tapered in plan so that the gaps between slats are parallel.

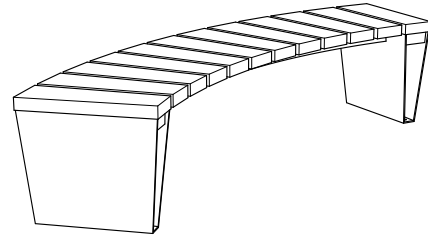

Bench

Benches are a popular choice where access can be gained from both sides, allowing people to sit facing opposite directions. Benches are most often used for 'short stay' seating locations.

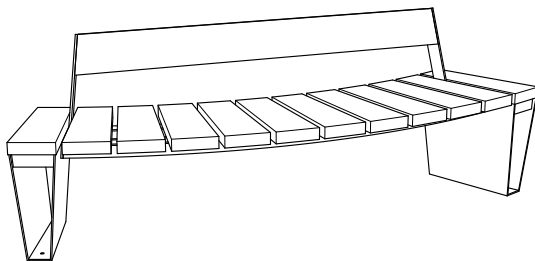

Seat - internal backrest

Most often used around features such as specimen trees, and ideal for outward-looking situations. The backrest provides a comfortable support for longer term seating.

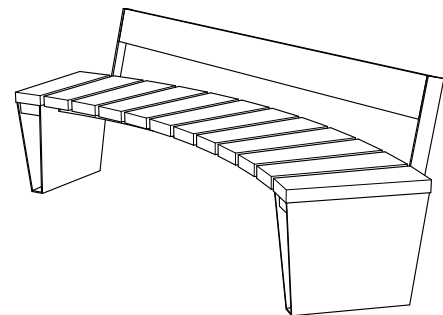

Seat - external backrest

These seats are often used to focus on a central feature in the landscape or to provide a visually softer alternative to angular corner seating.

VEEVA RANGE

OPTIONS:

- Armrest(s) in standard positions to provide comfortable seating place widths
- Steelwork in polyester powder coated finish to any RAL colour reference, over plain or galvanised steel
- Timbers with UV protective finish

Notes:

- 1890mm = arc length on c/l between centres of end slats. Overall c/l length of independent and start modules = 2035mm.
- Grey boxes indicate armrest positions
- Grey dashed lines indicate alignment of internal & external backrests

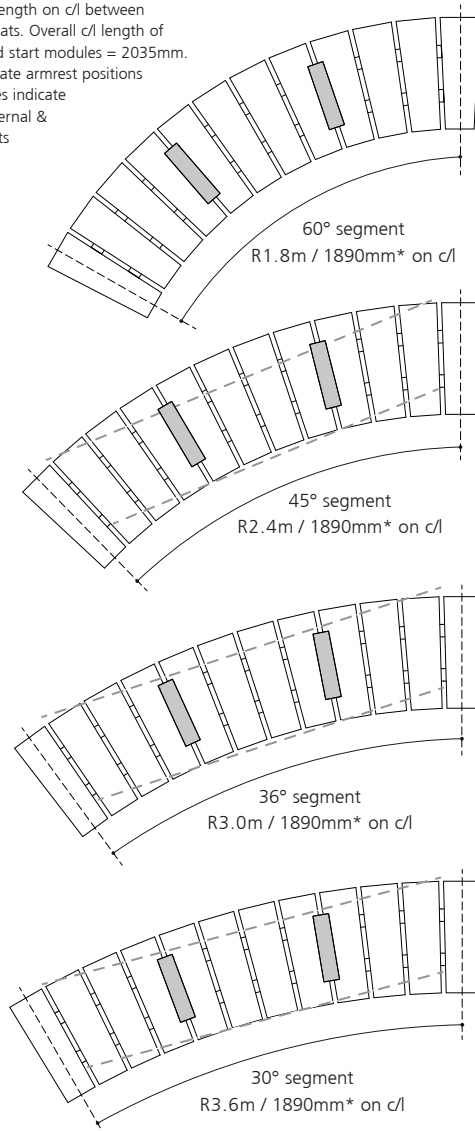

VEEVA CURVED SEATS & BENCHES

Standard assembly: steel supports & frames for bolt-down fixing in hot dip galvanised finish, with iroko timber slats in smooth planed finish

BENCHES	SEATS WITH INTERNAL BACKREST	SEATS WITH EXTERNAL BACKREST
60° / 1.8m radius, 3 person seat & bench units		
VEE RB 186 Independent, 2035mm	n/a	n/a
VEE RB 18 S Starter module, 2035mm	n/a	n/a
VEE RB 18 M Mid module, 1890mm	n/a	n/a
VEE RB 18 E End module, 1890mm	n/a	n/a
45° / 2.4m radius, 3 person seat & bench units		
VEE RB 248 Independent, 2035mm	VEE RSX 248 Independent, 2035mm	VEE RSV 248 Independent, 2035mm
VEE RB 24 S Starter module, 2035mm	VEE RSX 24 S Starter module, 2035mm	VEE RSV 24 S Starter module, 2035mm
VEE RB 24 M Mid module, 1890mm	VEE RSX 24 M Mid module, 1890mm	VEE RSV 24 M Mid module, 1890mm
VEE RB 24 E End module, 1890mm	VEE RSX 24 E End module, 1890mm	VEE RSV 24 E End module, 1890mm
36° / 3.0m radius, 3 person seat & bench units		
VEE RB 3010 Independent, 2035mm	VEE RSX 3010 Independent, 2035mm	VEE RSV 3010 Independent, 2035mm
VEE RB 30 S Starter module, 2035mm	VEE RSX 30 S Starter module, 2035mm	VEE RSV 30 S Starter module, 2035mm
VEE RB 30 M Mid module, 1890mm	VEE RSX 30 M Mid module, 1890mm	VEE RSV 30 M Mid module, 1890mm
VEE RB 30 E End module, 1890mm	VEE RSX 30 E End module, 1890mm	VEE RSV 30 E End module, 1890mm
30° / 3.6m radius, 3 person seat & bench units		
VEE RB 3612 Independent, 2035mm	VEE RSX 3612 Independent, 2035mm	VEE RSV 3612 Independent, 2035mm
VEE RB 36 S Starter module, 2035mm	VEE RSX 36 S Starter module, 2035mm	VEE RSV 36 S Starter module, 2035mm
VEE RB 36 M Mid module, 1890mm	VEE RSX 36 M Mid module, 1890mm	VEE RSV 36 M Mid module, 1890mm
VEE RB 36 E End module, 1890mm	VEE RSX 36 E End module, 1890mm	VEE RSV 36 E End module, 1890mm



VEEVA RANGE

Ø3.6m CIRCLE C/L (RADIUS 1.8m)



6 x mid
Seats 18 people



1 x starter
3 x mid
1 x end
Seats 15 people
Gap = 1550mm



2 x starter
2 x end
Seats 12 people
Gaps = 1550mm



4 x independent
Seats 12 people
Gaps = 800mm



3 x independent
Seats 9 people
Gaps = 1550mm

Ø4.8m CIRCLE C/L (RADIUS 2.4m)



8 x mid
Seats 24 people



1 x starter
5 x mid
1 x end
Seats 21 people
Gap = 1650mm



2 x starter
2 x mid
2 x end
Seats 18 people
Gaps = 1650mm



3 x starter
3 x end
Seats 18 people
Gaps = 1100mm



5 x independent
Seats 15 people
Gaps = 1000mm



4 x independent
Seats 12 people
Gaps = 1650mm

Ø6.0m CIRCLE C/L (RADIUS 3.0m)



10 x mid
Seats 30 people



1 x starter
7 x mid
1 x end
Seats 27 people
Gap = 1700mm



2 x starter
4 x mid
2 x end
Seats 24 people
Gaps = 1700mm



3 x starter
3 x mid
3 x end
Seats 18 people
Gaps = 2400mm



6 x independent
Seats 18 people
Gaps = 1150mm



5 x independent
Seats 15 people
Gaps = 1700mm

Ø7.2m CIRCLE C/L (RADIUS 3.6m)



12 x mid
Seats 36 people



1 x starter
9 x mid
1 x end
Seats 33 people
Gap = 1750mm



2 x starter
6 x mid
2 x end
Seats 30 people
Gaps = 1750mm



3 x starter
3 x mid
3 x end
Seats 27 people
Gaps = 1750mm



4 x starter
4 x mid
Seats 24 people
Gaps = 1750mm



8 x independent
Seats 24 people
Gaps = 900mm



6 x independent
Seats 18 people
Gaps = 1750mm



VEEVA RANGE

C/L RADIUS 1.8m MODULES

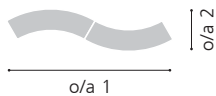

1 x starter
1 x end
Seats 6 people
3850 x 980mm o/a



1 x starter
2 x mid
1 x end
Seats 12 people
6670 x 2300mm o/a



1 x starter
4 x mid
1 x end
Seats 18 people
7700 x 4100mm o/a

C/L RADIUS 2.4m MODULES



1 x starter
1 x end
Seats 6 people
3870 x 870mm o/a



1 x starter
2 x mid
1 x end
Seats 12 people
7140 x 1910mm o/a



1 x starter
4 x mid
1 x end
Seats 18 people
9330 x 3460mm o/a

C/L RADIUS 3.0m MODULES



1 x starter
1 x end
Seats 6 people
3860 x 790mm o/a



1 x starter
2 x mid
1 x end
Seats 12 people
7350 x 1650mm o/a



1 x starter
4 x mid
1 x end
Seats 18 people
10110 x 2970mm o/a

C/L RADIUS 3.6m MODULES



1 x starter
1 x end
Seats 6 people
3860 x 750mm o/a



1 x starter
2 x mid
1 x end
Seats 12 people
7450 x 1460mm o/a



1 x starter
4 x mid
1 x end
Seats 18 people
10540 x 2610mm o/a



HOLLO RANGE

Versatile seating / low table surfaces

Hollo is a stylish new addition to Furnitubes' contemporary product range, comprising timber-topped surfaces mounted on heavy duty plate steel supports, available as standard in 3 plan sizes and 3 height options. Hollo products can be equally employed as benches and tables, with the low level plinth on all units useful as a shelf. Hollo is an ideal choice where a range of seating configurations are required on a single scheme. The small cube unit is a single-seater, the long form accommodates 2 people and the large cube up to 4 sitters. When arranged in groups the units can also be used as low tables. At 450mm high, the mid-height option is suitable for most seating applications. The lower 350mm high unit is recommended for sites frequented mostly by children, and can also be used as a low coffee table. The 550mm high versions offer a slightly higher seating level which is preferred for elderly or less able-bodied people. Using different height options in the same scheme also creates more visual interest.

Standard sizes:

Plan dimensions:

- 500mm x 500mm
- 1000mm x 500mm
- 1000mm x 1000mm

Heights:

- 450mm (standard)
- 350mm (low)
- 550mm (high)

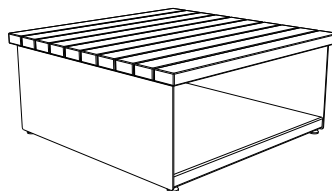
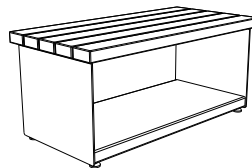
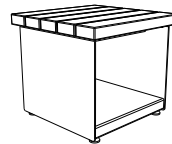

HOLLO RANGE

HOLLO BENCH / TABLE - SMALL CUBE FORM

Steelwork galvanised & polyester powder coated to any RAL colour reference, iroko timber slats in smooth planed finish

HLL 55/35

500mm wide x 500mm deep x 350mm high

HLL 55/45

500mm wide x 500mm deep x 450mm high

HLL 55/55

500mm wide x 500mm deep x 550mm high

OPTIONS:

- Steelwork in galvanised finish only
- Timbers with UV protective finish

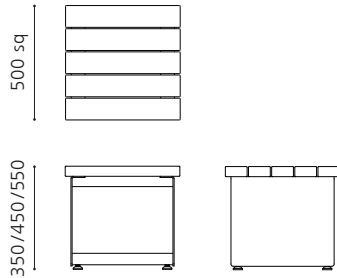

HOLLO BENCH / TABLE - LONG FORM

Steelwork galvanised & polyester powder coated to any RAL colour reference, iroko timber slats in smooth planed finish

HLL 105/35

1000mm wide x 500mm deep x 350mm high

HLL 105/45

1000mm wide x 500mm deep x 450mm high

HLL 105/55

1000mm wide x 500mm deep x 550mm high

OPTIONS:

- Steelwork in galvanised finish only
- Timbers with UV protective finish

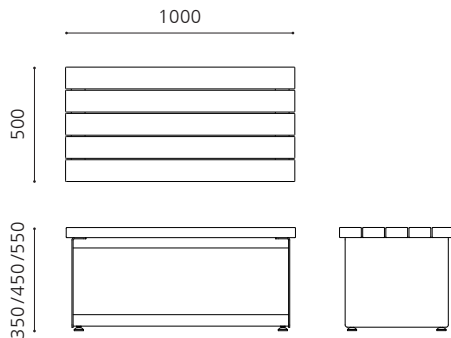

HOLLO BENCH / TABLE - LARGE CUBE FORM

Steelwork galvanised & polyester powder coated to any RAL colour reference, iroko timber slats in smooth planed finish

HLL 1010/35

1000mm wide x 1000mm deep x 350mm high

HLL 1010/45

1000mm wide x 1000mm deep x 450mm high

HLL 1010/55

1000mm wide x 1000mm deep x 550mm high

OPTIONS:

- Steelwork in galvanised finish only
- Timbers with UV protective finish

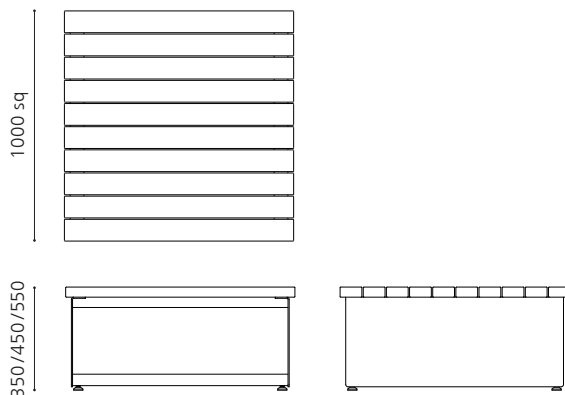

HOLLO RANGE

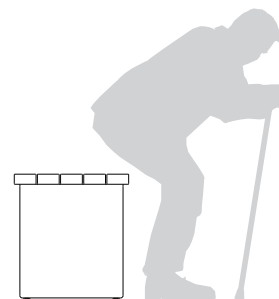
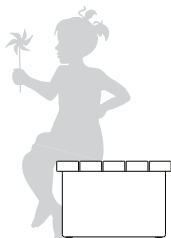
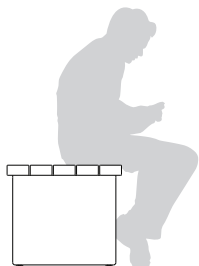

450mm high

450mm is the optimum seating height for most adults, but a little too high for children and slightly low for the less able-bodied and most elderly people.

350mm high

A 350mm high surface is more suited for children to sit on, though may still be too high for infants. The same height is also suitable for use as a low coffee table.

550mm high

Elderly and less able-bodied people can struggle to lower themselves onto and off standard 450mm high seats, whereas 550mm high is generally more manageable.

Example layouts

With all standard units based on a 500 x 500mm grid, many different layout configurations are possible. Here, Hollo products are shown arranged in small clusters around a central unit which acts as a table.



5 x HLL 55/45 Hollo Small Cubes



1 x HLL 1010/45 Hollo Large Cube
4 x HLL 105/45 Hollo Long Form

HOLLO RANGE

Freestanding / movable products:

All units are fitted with 4 screw-in adjustable feet as standard. 350mm and 450mm high products can be left freestanding, assuming the site is sufficiently secure for theft not to be an issue. For 550mm high products we recommend that they are fixed down as they are less stable and may tip due to their increased height.

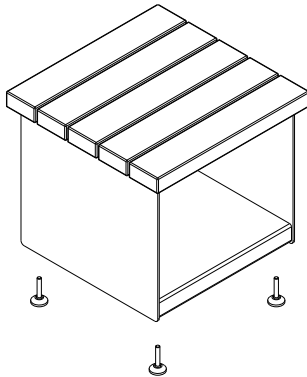

Products weights:

Small cubes:

HLL 55/35: 28kg

HLL 55/45: 32kg

HLL 55/55: 35kg

Long Forms:

HLL 105/35: 43kg

HLL 105/45: 47kg

HLL 105/55: 50kg

Large cubes:

HLL 1010/35: 82kg

HLL 1010/45: 90kg

HLL 1010/55: 97kg

Fixed products:

For fixing products to the ground remove the 4 pre-fitted feet by winding them out of their sockets and replace each with an M10 stud (recommended minimum 150mm long) to suit the planned foundation depth. By adding a nut to the stud beneath the underside of the product will allow height adjustment.

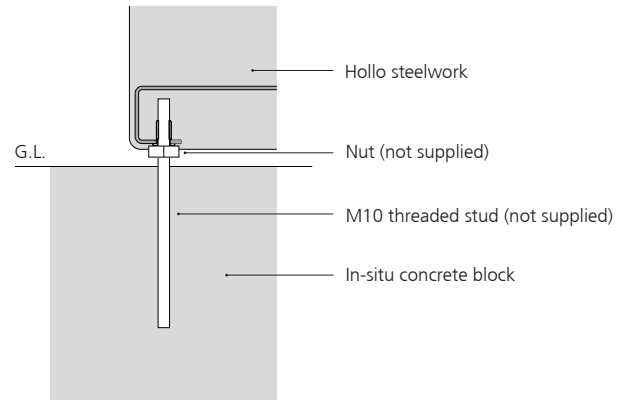

PARALLEL RANGE

Simple styling and robust construction

Parallel benches and tables are an ideal choice for outdoor dining areas that require a heavier duty and more contemporary-styled product than traditional timber picnic benches offer. The combination of a steel frame and closely-spaced slats make the benches and tables sufficiently heavy to be used as freestanding units on secure sites, but are also offered as bolt-down and in-ground options for more public areas. Bench and table-top slats are in iroko hardwood as standard, with selected models also available in wood plastic composite material. Two standard lengths are offered, to comfortably accommodate either 3 or 4 people per side.

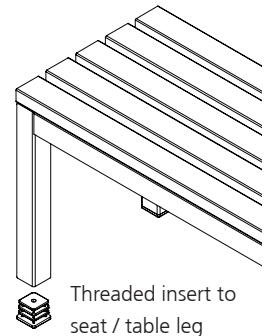

Fixing options:



1. Freestanding:
with levelling foot



2. Bolting down:
through base plate



3. In-ground fixing:
with threaded stud

PARALLEL RANGE

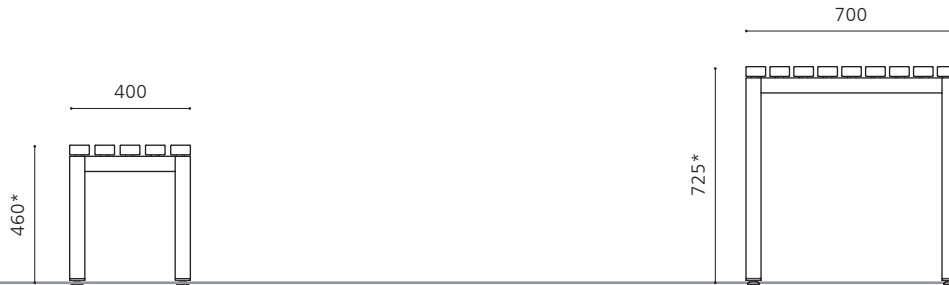

* Notes re. heights:

The heights above ground level of bench & table modules vary slightly for different ground fixing options:

1. Freestanding: dimensions as specified
2. Bolting down: 10mm lower than specified
3. In-ground fixing: 15mm lower than specified

All fixing types use a bolt / stud that screws into the insert fitted into the leg, allowing height adjustment of up to 20mm. On sloping sites each leg can be adjusted independently so that top surfaces can be levelled.

PARALLEL

Freestanding units, galvanised steel frame with iroko slats, smooth planed finish

BENCHES

PPB 6

3 person bench, 1800mm long

PPB 8

4 person bench, 2400mm long

TABLES

PPT 6

6 person table, 1800mm long

PPT 8

8 person table, 2400mm long

OPTIONS:

- Steelwork in powder coated finish, to any RAL colour reference
- Timbers with UV protective finish
- Wood plastic composite (WPC) slats (1800mm long versions only)
- Base-plated legs for bolt-down installation
- Threaded studs for in-ground installation
- Umbrella hole (tables)

PARALLEL RANGE

Case study: Bow School, London

The Parallel range was originally designed for the Bow School development in London's East End. The tables and benches provide an extensive outdoor dining facility and were supplied as freestanding units to allow them to be readily moved around so that the space could be used for other purposes when required. The wood plastic composite (WPC) slat material was also used on long runs of purpose-made 'Contor' wall-top seating, including in a tiered amphitheatre arrangement, on Zenith seats and benches in the wider school envelope and for decking alongside a new pond. Fin cycle stands and Caledonian twin litter / recycling bins completed the suite of products supplied by Furnitubes to the impressive Bow School development.



PARALLEL RANGE



AXL BENCH & PLANTER RANGE

Circular bench + optional integral planter

These unique circular benches were first developed by Furnitubes' in-house designers for the High Street improvement scheme in Lincoln city centre. The city council required seating with a significant visual presence to be used as part of traffic-calming measures as well as providing useful short term seating for shoppers. Manufactured in two sizes - to suit the available space and for visual variation - the steelwork was supplied in a hardwearing corten effect nylon coating, with the iroko hardwood slats in a finish coat to maintain good long term colouration. Following positive feedback received from the Lincoln installation, a complete new range - named Axl - has since been developed to offer seating in three different sizes, in four different forms (full, half and three quarter circles and a quadrant) and with the central pedestal available as a planter on larger full circle versions. Standard specification is a polyester powder coated finish over anti-corrosion zinc thermal sprayed steelwork and smooth planed iroko timber slats, though the unusual combination used at Lincoln and other scheme-specific finish requirements can be supplied on request.



AXL BENCH & PLANTER RANGE

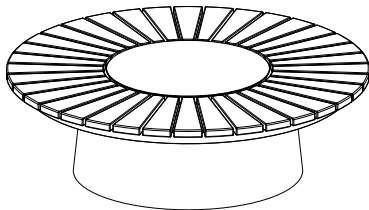

Full circle bench

For open spaces where seating can be accessed from all sides

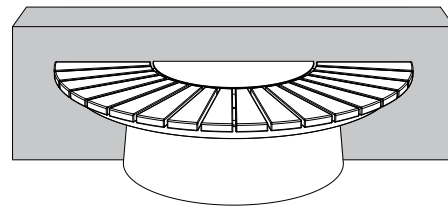

1/2 circle bench

For placement against straight walls

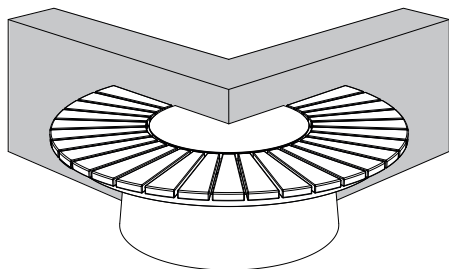

3/4 circle bench

Wraps around external 90° corner walls

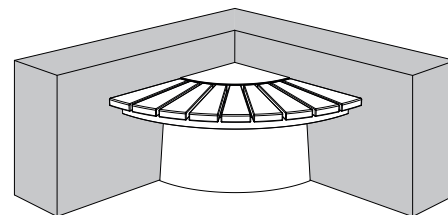

1/4 circle bench

Fits between internal 90° corner walls

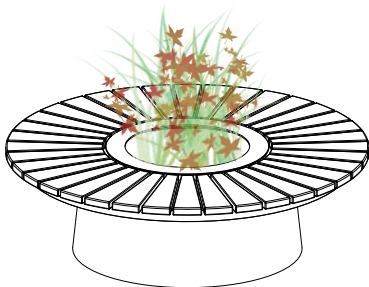

Full circle planter bench

Open centre allows central pedestal to be used as a planter

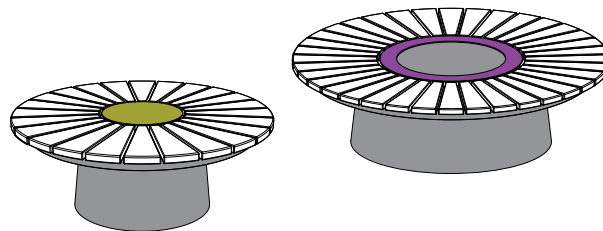

Colourway options

Bolt-on top plate / ring allows contrasting colours to the pedestal

AXL BENCH & PLANTER RANGE

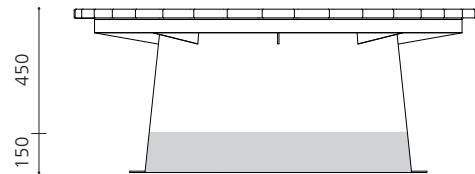
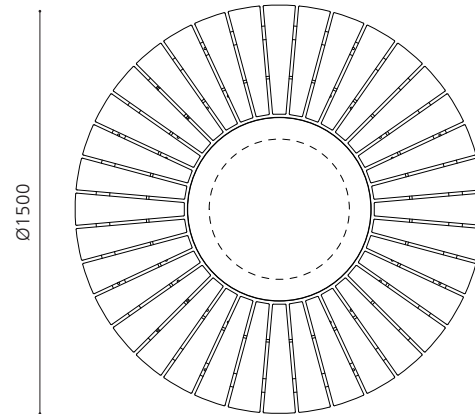
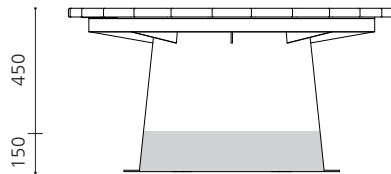
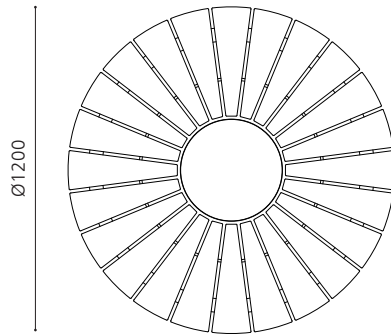

AXL

Full / part circular benches with steel base, zinc thermal sprayed and polyester powder coated to any RAL colour ref, iroko timber slats in smooth planed finish

AXL 120

Full circle Ø1200mm (R600mm)

AXL 120 34

3/4 circle R600mm (Ø1200mm)

AXL 120 12

1/2 circle R600mm (1200 x 600mm)

AXL 120 14

1/4 circle R600mm (600 x 600mm)

AXL 150

Full circle Ø1500mm (R750mm)

AXL 150 PL

Full circle Ø1500mm (R750mm)
with open top for internal planting

AXL 150 34

3/4 circle R750mm (Ø1500mm)

AXL 150 12

1/2 circle R750mm (1500 x 750mm)

AXL 150 14

1/4 circle R750mm (750 x 750mm)

OPTIONS:

- Armrests
- Steelwork in nylon coating
- Timbers with UV protective finish

AXL BENCH & PLANTER RANGE

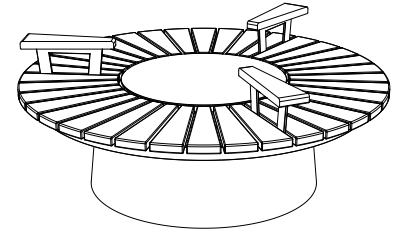
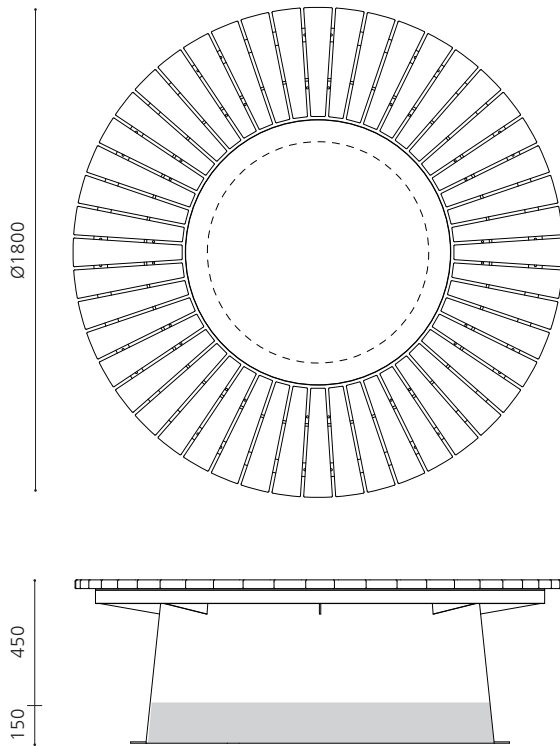

Armrests

All benches are available with armrests which comprise a tapered timber pad discretely fixed to a supporting steel fabrication, which itself is welded to the bench sub-frame. Illustrated below are the positions that armrests can be placed to maintain appropriate-sized gaps between for an average sitter. It is not necessary to have all the armrests as shown, for example on the Ø1500mm bench 3 equally spaced armrests would give 3 seating segments, each accommodating 2 people.

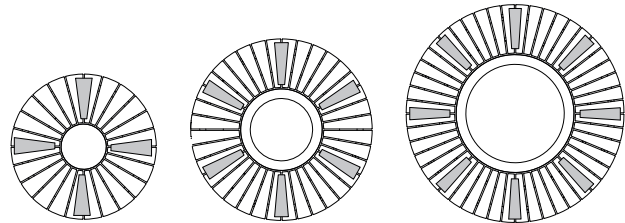

Ø1200mm

4 arms maximum

Ø1500mm

6 arms maximum

Ø1800mm

8 arms maximum

AXL

Full / part circular benches with steel base, zinc thermal sprayed and polyester powder coated to any RAL colour ref, iroko timber slats in smooth planed finish

AXL 180

Full circle Ø1800mm (R900mm)

AXL 180 PL

Full circle Ø1800mm (R900mm)
with open top for internal planting

OPTIONS:

- Armrests
- Steelwork in nylon coating
- Timbers with UV protective finish

AXL 180 34

3/4 circle R900mm (Ø1800mm)

AXL 180 12

1/2 circle R900mm (1800 x 900mm)

AXL 180 14

1/4 circle R900mm (900 x 900mm)

Installation

Given the width of the pedestal it is unlikely that paving will be sufficiently flat to allow for an above-ground bolt-down installation that achieves a level seating surface.

Benches are therefore designed to be bolted down to a below-ground foundation, via tabs welded to the pedestal, pre-drilled for M12 ground fixings (not supplied).

Note: planter pedestals are open-based as standard to allow through-drainage.

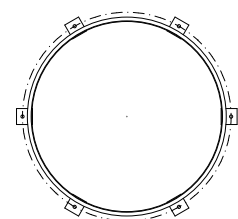

BOSTON RANGE

Popular coordinated seat and bench range

The Boston seating range was originally designed to utilise the seat and backrest framework from the original Zenith range, but end-mounted on seating standards rather than on post supports. The range has since been modified and expanded to include seats and benches both with and without arms to form a fully coordinated family. Circular rails to the front and back edges of the seating platform of all products, and to the top and bottom of the backrest for the seat version, add rigidity and strength to the products whilst also protecting the timber slats from accidental knocks and general wear and tear. The seat and benches are designed for 3 people as standard, although alternative sizes can be made to suit specific schemes. Steelwork is offered in a galvanised finish, but is also available in a supplementary polyester powder or plastic coated finish, and in various grades and finishes of stainless steel.

Plastic coating

A hardwearing plastic coated finish is available in the colours shown

- | | | |
|--------------------|---------------------|--------------------|
| ■ RAL 9005 - Black | ■ RAL 5015 - Blue | ■ RAL 3020 - Red |
| ■ RAL 7001 - Grey | ■ RAL 6005 - Green | ■ RAL 8017 - Brown |
| ■ RAL 9016 - White | ■ RAL 1021 - Yellow | |



BOSTON RANGE

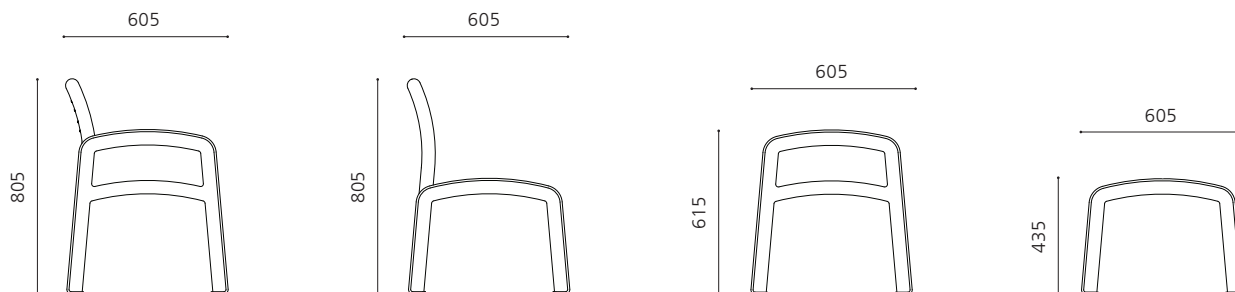

Installation:

Each foot on the seat / bench standards is pre-drilled with for an M12 ground fixing (not supplied) for bolting the bench down to a suitable foundation block.

BOSTON

Galvanised steel standards and framework with iroko timber slats in smooth planed finish

BOS 6A

Seat with integral end armrests
1945 mm long

BOS 6

Seat (no armrests),
1945 mm long

BOS B6A

Bench with integral end armrests,
1945 mm long

BOS B6

Bench (no armrests),
1945 mm long

OPTIONS:

- Steelwork in polyester powder coated finish, to any RAL colour reference
- Steelwork in plastic coated finish, in selected colours
- Steelwork in stainless steel, various grades and finishes
- Timbers with UV protective finish
- Wood plastic composite (WPC) slats
- Anti-skate devices
- Alternative lengths

LIVERPOOL & OXFORD RANGES

Contemporary styling at affordable prices

The Liverpool and Oxford ranges of seats and benches combine a perforated plate seating platform mounted on contrasting decoratively-shaped polished stainless steel standards. Although specified and built for the exterior environment, the style of these ranges also make them a popular choice for interior locations, such as atriums and building entrance lobbies. Each range is styled slightly differently but there is sufficient similarity to the products to allow them to be used together on the same scheme. The single-piece pressed and perforated seat / backrest platform is manufactured from stainless steel but offered in a polyester powder coated finish to any given RAL colour reference. The same perforated detail is also used on other products from our range, such as the Liverpool litter bin, that enables a coordinated suite of products to be used. Given their high specification, the Liverpool and Oxford ranges offer good value for money.



LIVERPOOL & OXFORD RANGES

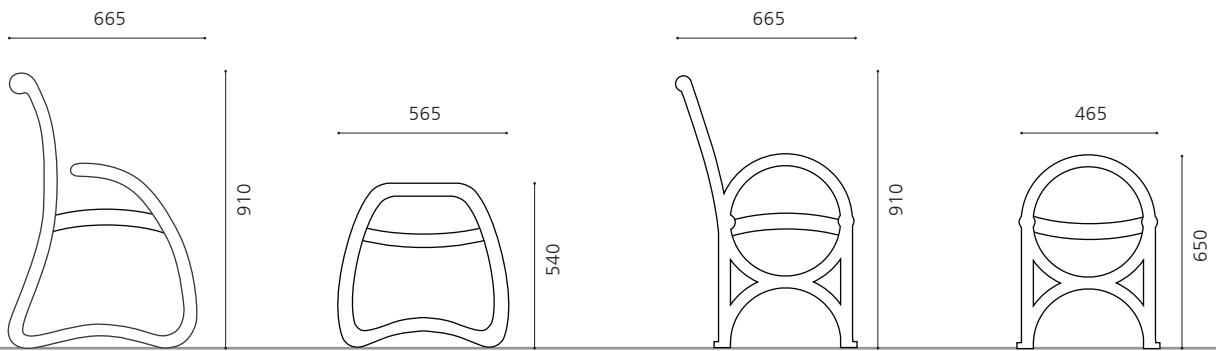

Assembly and installation:

All seats are supplied flat-packed, complete with fixings, tools and instructions for self-assembly, which will require two people. Each end standard has 2 no. holes for M10 or M12 ground fixings (not supplied) for bolting down to a suitable foundation.

LIVERPOOL

All-stainless steel seat with bright polished finish standards and polyester powder coated (PPC) platform

LVR 6

3 person seat,
1850mm long

LVRB6

3 person bench,
1850mm long

OXFORD

All-stainless steel seat with bright polished finish standards and polyester powder coated (PPC) platform

OXF 6

3 person seat,
1850mm long

OXF B6

3 person bench,
1850mm long

OPTION (ALL SEATS & BENCHES):

- Seat platform in polyester powder coated finish to any RAL colour reference



NEO RANGE

Longstanding contemporary favourite

The Neo is a popular range of seats with multiple options and configurations, most often used in parks and open spaces. The style of the range uniquely suits the character of almost any scheme - from modern new developments to historic settings, and the economic design makes also it affordable for general amenity areas. The full range comprises a single person chair, 2 seat lengths, and standard benches, all featuring integral armrests. Seat and bench standards are manufactured in robust ductile cast iron and coated in a silver finish, and the seat platforms and backrests are in hardwood in a choice of 3 coloured finishes.

Installation:

The base of each foot is threaded to accept an M10 stud / fixing (not supplied) for anchoring into a ground foundation



NEO

Cast ductile iron seat standards, coated silver with tropical hardwood slats with anti-fungidical, insecticide and water-proof treatments in natural colour

NEO 2A

1 person chair
700mm x 710mm x 800mm

NEO 6A

3 person seat
1800mm x 710mm x 800mm

NEO 12AC

6 person seat
3000mm x 710mm x 800mm

NEOB6A

3 person bench
1800mm x 630mm x 655mm

OPTIONS (ALL SEATS & BENCHES):

- Hardwood slats in blue or green coated finish

Dimensions stated are length x width / depth x overall height



CONTEMPORARY SEATING

Contemporary continental styling

In addition to our extensive choice of British seating designs, Furnitubes offers contemporary European-styled street and park seating, characterised by striking designs and unusual combinations of materials and finishes. Murcia is a modern designs using a combination of corten steel seat supports with timber seating slat whilst Seville is an all-steel construction. These seats will make a significant statement in any contemporary-styled new development, and introduce a touch of continental design flair to your scheme.



MURCIA

Corten seat standards

Tropical hardwood slats, with anti-fungidical, insecticide and water-proof treatments

MUR 2

1 person chair, 615mm long x 635mm deep x 765mm high

MUR 8

4 person seat, 2400mm long x 635mm deep x 765mm high



SEVILLE

All-steel construction throughout, powder coated finish; platform in RAL 9006 silver grey, end supports in black

SEVB7

4 person bench, 2000mm long x 630mm deep x 510mm high

CONTEMPORARY SEATING



CONTEMPORARY SEATING & TABLES



View or download other product e-brochures at the following link:

www.furnitubes.com/brochures



© Furnitubes

 **Furnitubes®**

3rd Floor, Meridian House, Royal Hill, Greenwich

LONDON SE10 8RD

T: +44 (0)20 8378 3200

F: +44 (0)20 8378 3250

sales@furnitubes.com

www.furnitubes.com