

## Butterfly Valve 565

# Beats metal in every round

Lightweight, highly reliable  
and cost-effective



# A robust lightweight

Plastic Butterfly Valves have already proven to outperform metal valves in almost every way, thanks to a higher resistance against corrosion and a lighter weight. Now, a new generation has arrived to beat metal in cost-effectiveness, too.

The new Butterfly Valve 565 is the best choice for optimizing piping systems built for water applications and a wide range of other applications. This new generation comes at a significantly lower initial cost, and will save even more thanks to its lower static weight, requiring less energy for both operation and transportation. Installing the Butterfly Valve 565 is quick and easy, but thanks to its extremely high durability, it will be almost maintenance-free during its long service life.

## + Direct Replacement

The Butterfly Valve 565 comes in the same installation length as metal solutions. The exchange does not require any additional work on the pipes or new designs. This reduces the effort of both planning and installation, also thanks to a lighter weight.

## + 60% lighter

Thanks to its low weight, a single person can lift and install the Butterfly Valve 565 in just a few minutes. This also facilitates planning, since the low weight significantly reduces the need for costly transportation and personnel.

## + Highly reliable

The Butterfly Valve 565 is built to last. High-performance thermoplastics protect it from abrasion and corrosion. This guarantees a longer system lifetime, even under harsh conditions such as water hammers. The results are a reduction of both maintenance costs and production stops.



## + Reduced costs

With the initial cost being comparable to metal solutions, the Butterfly Valve 565 outperforms its metal counterparts in the long run, reducing maintenance costs, thanks to its superior materials and design.

## + Ready for digitization

With its standard interface, the Butterfly Valve 565 can be upgraded with various modules, such as the smart actuator. This allows for automation and digitization of your systems, making them even more cost-effective and efficient.

## + Swiss quality

The Butterfly Valve 565 is produced by GF Piping Systems in Seewis (Grisons), Switzerland. High-quality valves have been produced here for over half a century. They combine technological innovation with the highest standards of material selection, manufacturing and quality testing for safety, durability and reliability.



To ensure the high quality standard, the butterfly valves are tested under the toughest conditions in a test stand.

# How plastic wins against corrosion and gravity

More than half a century ago, GF Piping Systems decided to switch from metal to plastic. This was both a revolutionary and a forward-looking step, as the disadvantages of metal have proven to be the advantages of plastic. The Butterfly Valve 565 is the newest product of this innovation process, outperforming its metal counterparts in every way.



✓	Short installation length	✓
✓	Light weight	✗
✓	Corrosion resistant	✗
✓	High p/T performance	✓

## Technical Data

<b>Dimension</b>	DN50-300, 2" - 12"
<b>Pressure rating</b>	DN50-150: PN16 / DN200-250: PN10 / DN300: PN6
<b>Materials</b>	Wafer: fibre reinforced polyamide (PA6-60) Disc: PVDF with fibre reinforced polyamide (PA6-60)
<b>Sealing material</b>	EPDM, FKM
<b>Shaft material</b>	Stainless steel, 1.4104 (430 F), Other shaft material on request
<b>Installation length</b>	EN558 row 20, ISO 5752 row 20, API 609 table 2
<b>Flange standards</b>	ISO 7005 PN10/16, EN 1092 PN10/16, DIN 2501 PN10/16, ANSI/ASME B 16.5 Class 150, BS 1560: 1989 Class 125/150; BS 4504 PN10/16, JIS B 2220 10K, JIS B 2239 10K
<b>Mounting flange</b>	EN ISO 5211
<b>Leak test</b>	ISO 9393-2, EN 12266 (leak rate A), ISO 5208 (Rate A)
<b>Approvals</b>	Multiple approvals available on request
<b>Actuation variants</b>	Manual: lockable hand lever or reduction gear with hand wheel Pneumatic: FC; FO; DA Electric: AC: 100, 230 V, AC/DC: 24 V, Smart Version

# Sustainably future-proof

GF Piping Systems is making flow sustainable: Environmental regulations, water scarcity and an increasing demand of consumers and society for greener and more sustainable solutions are an important set of trends shaping customer behavior. The Butterfly Valve 565 is another important milestone in building a more sustainable future.

## + Lower production footprint

The waste of energy and resources in industrial production is reduced further by the long service life, thanks to a higher resistance against corrosion.

## + Lower overall costs

The low weight of the plastic material reduces the energy and resources needed for transport and installation. After installation, the advantages of the reduced static weight can become even more significant.

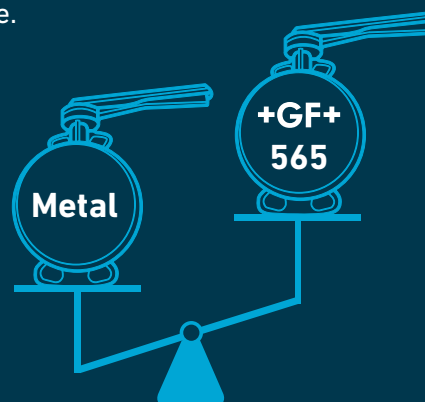

## + 10 tons weight saved

Replacing 600 metal butterfly valves with the new plastic Butterfly Valve 565 will save up to 10 tons in weight and reduce CO<sub>2</sub> emissions.

# Superior material meets modular design

When something is built to last, it is all the more important that it can be flexibly adapted to changing requirements. For high-quality plastic materials optimized for durability, modular design is the perfect match. The standard interface also ensures that the Butterfly Valve 565 stays upgradeable during its long lifespan, fit for the ever-evolving future.

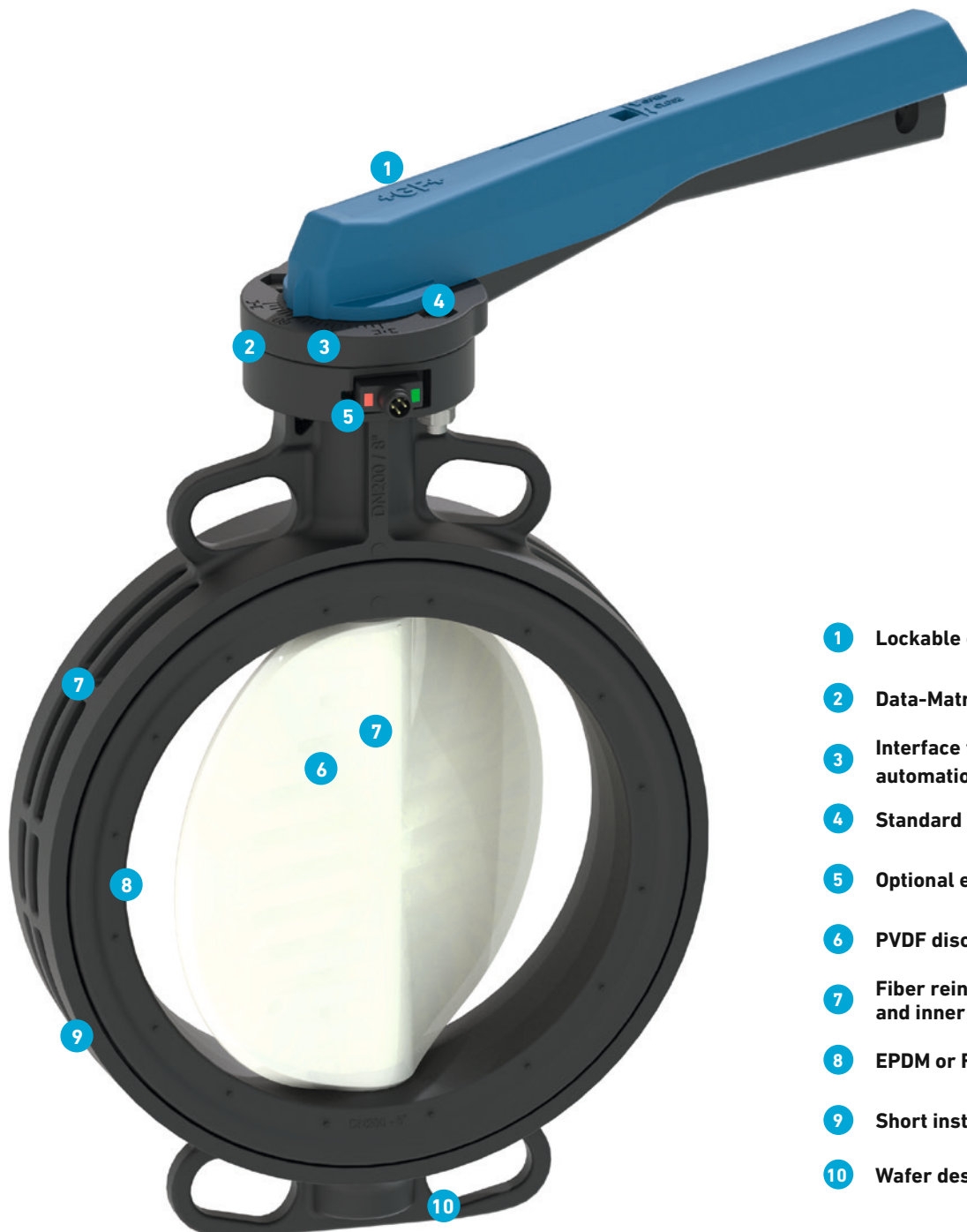

- 1 Lockable ergonomic lever
- 2 Data-Matrix-Code
- 3 Interface for flexible automation (ISO 5211)
- 4 Standard 5° ratchet setting
- 5 Optional electric position indicator
- 6 PVDF disc
- 7 Fiber reinforced housing and inner disc
- 8 EPDM or FKM sleeve
- 9 Short installation length
- 10 Wafer design

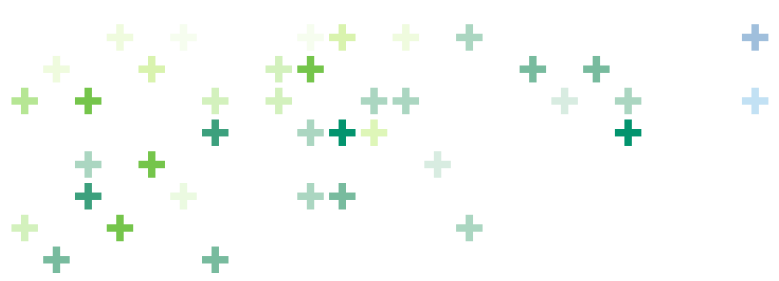

## Modular process automation

### Smart actuator for more efficiency in the work process

The smart actuator makes full use of the possibilities of digitization: Thanks to the app, you can access it at any time in order to read data or carry out settings, for example. This makes work easier and more efficient than ever before.

### Electric actuator for highest reliability and ease of use

Powered by an electric motor, electrical actuators are highly reliable and very easy to set up and operate. In addition, the latest generation of actuators offers many intelligent features. Modular accessories such as electric interfaces, integrated battery-powered fail-safe units and visual system feedback are also available.

### Pneumatic actuator for reliable operation

The pneumatic actuators are suitable for a wide range of environments and guarantee high levels of safety and reliability thanks to their fail-safe operation, robust design and high functionality, such as fast cycle times and adjustable travel. They are an economical, functional and reliable solution, especially for installations with a high number of actuated valves.

### Reduction gear with handwheel

The reduction gear with handwheel allows reliable, manual operation of the Butterfly Valve 565. Worm gears ensure that only minimal physical effort is required. They can fully open and close and are useful for high-stress situations.

### Monitoring by the double sensor

The optional LED position feedback allows the current position of the valve to be centrally recorded and checked at any time – for manually operated and automated valves. The compact dual sensor fits even in the most tight areas and is protected against ingress of water and dust.

### Information via Data-Matrix-Code

The Data-Matrix-Code simplifies the storage of all technical information for each individual valve and thus enables individual traceability. The faultless identification of each Butterfly Valve 565 facilitates easy installation, service and repair.

**Find out more**  
[www.gfps.com/565](http://www.gfps.com/565)

## Butterfly Valve 565

# Product range





# Butterfly Valve 565



## Butterfly valve type 565 manual PVDF/PA-GF

**Bare shaft**

**Wafer style metric/ANSI/BS/JIS**

**Suitable for ABS, PVC-U, PVC-C, ecoFIT and PROGEF Systems**

### Model:

- Installation length: EN558 row 20, ISO 5752 row 20, API 609 table 2
- Flange standards: ISO 7005 PN10/16, EN 1092 PN10/16, DIN 2501 PN10/16, ANSI/ASME B 16.5 Class 150, BS 1560: 1989 Class 125/150; BS 4504 PN10/16, JIS B 2220 10K, JIS B 2239 10K
- For easy installation and removal
- Suitable for water and uncritical media

### Option:

- Individual configuration of the valve possible
- Hand (lockable), pneumatic or electric actuators from GF
- Double sensor for electrical position feedback incl. LED feedback

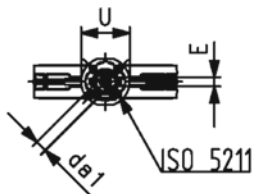
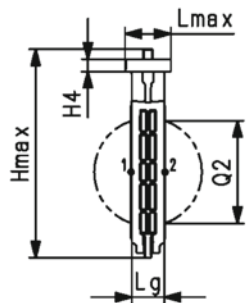
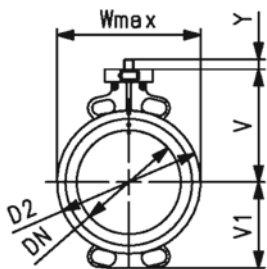

DN (mm)	PN (bar)	d (mm)	Size (inch)	kv-value ( $\Delta p=1$ bar) (L/min)	Do2 (mm)	Acc.to ISO 5211	EPDM Code	SP	Weight (kg)
50	16	63	2	1445	63	F07	<b>199 565 100</b>	1	0.9
65	16	75	2 ½	2530	75	F07	<b>199 565 101</b>	1	1.1
80	16	90	3	4020	90	F07	<b>199 565 102</b>	1	1.3
100	16	110	4	5850	110	F07	<b>199 565 103</b>	1	2.0
125	16	140	5	11900	140	F07	<b>199 565 104</b>	1	2.6
150	16	160	6	18050	160	F07	<b>199 565 105</b>	1	3.7
200	10	225	8		225	F07	<b>199 565 106</b>	1	4.7
250	10	280	10		280	F10	<b>199 565 107</b>	1	8.8
300	6	315	12		315	F10	<b>199 565 108</b>	1	12.6

DN (mm)	FKM Code	SP	Weight (kg)
50	<b>199 565 120</b>	1	1.0
65	<b>199 565 121</b>	1	1.2
80	<b>199 565 122</b>	1	1.4
100	<b>199 565 123</b>	1	2.2
125	<b>199 565 124</b>	1	2.9
150	<b>199 565 125</b>	1	3.8
200	<b>199 565 126</b>	1	5.2
250	<b>199 565 127</b>	1	9.5
300	<b>199 565 128</b>	1	13.7

DN (mm)	D2 (mm)	Wmax (mm)	Lmax (mm)	Hmax (mm)	H4 (mm)	V (mm)	V1 (mm)	Lg (mm)	da1 (mm)	E (mm)	U (mm)	Y (mm)	Q2 (mm)
50	100.0	118.5	85.5	222.5	23.0	133.5	63.0	43.0	14.1	11.0	90.0	27.0	28.5
65	121.0	132.5	85.5	248.5	23.0	140.0	82.0	46.0	14.1	11.0	90.0	27.0	44.0
80	138.0	138.0	85.5	261.0	23.0	146.0	89.0	46.0	14.1	11.0	90.0	27.0	63.5
100	158.5	158.5	85.5	286.0	23.0	166.5	104.0	52.0	18.1	14.0	90.0	16.0	84.0
125	187.0	187.0	85.5	313.5	23.0	180.0	118.0	56.0	18.1	14.0	90.0	16.0	110.5
150	213.0	213.0	85.5	337.5	23.0	189.0	130.5	56.0	22.2	17.0	90.0	19.0	137.5
200	267.0	267.0	85.5	387.0	23.0	209.5	195.0	60.0	22.2	17.0	90.0	19.0	191.5
250	325.5	325.5	125.5	499.0	23.0	262.5	195.5	68.0	28.2	22.0	125.0	41.0	239.0
300	380.0	380.0	125.5	555.0	23.0	284.5	230.5	78.0	28.2	22.0	125.0	41.0	285.5



**Butterfly valve type 565 manual PVDF/PA-GF**  
**Hand lever with ratchet settings**  
**Wafer style metric/ANSI/BS/JIS**  
**Suitable for ABS, PVC-U, PVC-C, ecoFIT and PROGEF Systems**

**Model:**

- Installation length: EN558 row 20, ISO 5752 row 20, API 609 table 2
- Flange standards: ISO 7005 PN10/16, EN 1092 PN10/16, DIN 2501 PN10/16, ANSI/ASME B 16.5 Class 150, BS 1560: 1989 Class 125/150; BS 4504 PN10/16, JIS B 2220 10K, JIS B 2239 10K
- For easy installation and removal
- Lockable ergonomic lever
- Suitable for water and uncritical media

**Option:**

- Individual configuration of the valve possible
- Pneumatic or electric actuators from GF
- Double sensor for electrical position feedback incl. LED feedback

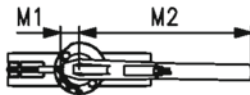
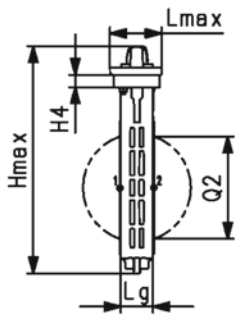
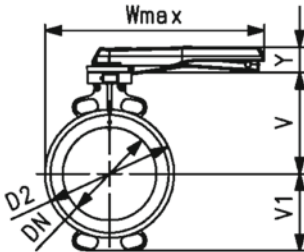

DN (mm)	PN (bar)	d (mm)	Size (inch)	kv-value ( $\Delta p=1$ bar) (L/min)	Do2 (mm)	EPDM Code	SP	Weight (kg)
50	16	63	2	1445	63	<b>199 565 000</b>	1	1.3
65	16	75	2 ½	2530	75	<b>199 565 001</b>	1	1.5
80	16	90	3	4020	90	<b>199 565 002</b>	1	1.7
100	16	110	4	5850	110	<b>199 565 003</b>	1	2.5
125	16	140	5	11900	140	<b>199 565 004</b>	1	3.1
150	16	160	6	18050	160	<b>199 565 005</b>	1	4.0
200	10	225	8		225	<b>199 565 006</b>	1	5.3

DN (mm)	FKM Code	SP	Weight (kg)
50	<b>199 565 020</b>	1	1.4
65	<b>199 565 021</b>	1	1.6
80	<b>199 565 022</b>	1	1.8
100	<b>199 565 023</b>	1	2.7
125	<b>199 565 024</b>	1	3.3
150	<b>199 565 025</b>	1	4.3
200	<b>199 565 026</b>	1	5.7

DN (mm)	D2 (mm)	Wmax (mm)	Hmax (mm)	Lmax (mm)	H4 (mm)	V (mm)	V1 (mm)	Lg (mm)	M1 (mm)	M2 (mm)	Y (mm)	Q2 (mm)
50	100.0	264.0	249.5	96.0	23.0	133.5	63.0	43.0	35.5	204.5	53.0	28.5
65	121.0	271.0	275.5	96.0	23.0	140.0	82.0	46.0	35.5	204.5	53.0	44.0
80	138.0	273.5	288.0	96.0	23.0	146.0	89.0	46.0	35.5	204.5	53.0	63.5
100	158.5	334.0	324.0	96.0	23.0	166.5	104.0	52.0	35.5	254.5	53.0	84.0
125	187.0	348.0	351.0	96.0	23.0	180.0	118.0	56.0	35.5	254.5	53.0	110.5
150	213.0	426.0	372.5	96.0	23.0	189.0	130.5	56.0	35.5	319.5	53.0	137.5
200	267.0	453.0	422.0	96.0	23.0	209.5	195.0	60.0	32.0	323.0	53.0	191.5



**Butterfly valve type 565 manual PVDF/PA-GF**  
**Reduction gear with handwheel**  
**Wafer style metric/ANSI/BS/JIS**  
**Suitable for ABS, PVC-U, PVC-C, ecoFIT and PROGEF Systems**

**Model:**

- Installation length: EN558 row 20, ISO 5752 row 20, API 609 table 2
- Flange standards: ISO 7005 PN10/16, EN 1092 PN10/16, DIN 2501 PN10/16, ANSI/ASME B 16.5 Class 150, BS 1560: 1989 Class 125/150; BS 4504 PN10/16, JIS B 2220 10K, JIS B 2239 10K
- For easy installation and removal
- Suitable for water and uncritical media

**Option:**

- Individual configuration of the valve possible
- Hand (lockable hand lever), pneumatic or electric actuators from GF
- Double sensor for electrical position feedback incl. LED feedback

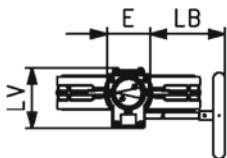
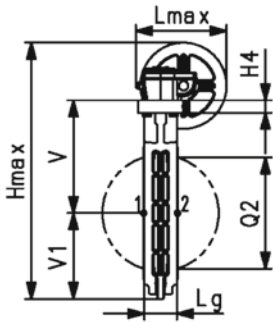
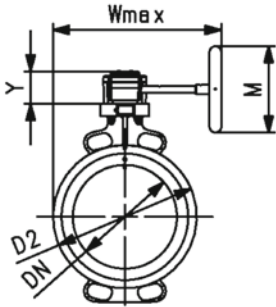

DN (mm)	PN (bar)	d (mm)	Size (inch)	kv-value ( $\Delta p=1$ bar) (L/min)	Do2 (mm)	EPDM Code	SP	Weight (kg)
50	16	63	2	1445	63	<b>199 565 200</b>	1	3.0
65	16	75	2 ½	2530	75	<b>199 565 201</b>	1	3.2
80	16	90	3	4020	90	<b>199 565 202</b>	1	3.4
100	16	110	4	5850	110	<b>199 565 203</b>	1	4.2
125	16	140	5	11900	140	<b>199 565 204</b>	1	4.7
150	16	160	6	18050	160	<b>199 565 205</b>	1	5.5
200	10	225	8		225	<b>199 565 206</b>	1	6.7
250	10	280	10		280	<b>199 565 207</b>	1	12.7
300	6	315	12		315	<b>199 565 208</b>	1	16.5

DN (mm)	FKM Code	SP	Weight (kg)
50	<b>199 565 220</b>	1	3.1
65	<b>199 565 221</b>	1	3.3
80	<b>199 565 222</b>	1	3.5
100	<b>199 565 223</b>	1	4.3
125	<b>199 565 224</b>	1	5.0
150	<b>199 565 225</b>	1	5.8
200	<b>199 565 226</b>	1	7.2
250	<b>199 565 227</b>	1	13.4
300	<b>199 565 228</b>	1	17.6

DN (mm)	D2 (mm)	Wmax (mm)	Hmax (mm)	Lmax (mm)	H4 (mm)	V (mm)	V1 (mm)	Lg (mm)	E (mm)	LB (mm)	LV (mm)	M (mm)	Y (mm)
50	100.0	238.5	303.0	169.0	23.0	133.5	63.0	43.0	80.0	128.0	112.5	160.0	61.5
65	121.0	246.0	329.0	169.0	23.0	140.0	82.0	46.0	80.0	128.0	112.5	160.0	61.5
80	138.0	248.5	341.5	169.0	23.0	146.0	89.0	46.0	80.0	128.0	112.5	160.0	61.5
100	158.5	258.5	377.5	169.0	23.0	166.5	104.0	52.0	80.0	128.0	112.5	160.0	61.5
125	187.0	272.0	405.0	169.0	23.0	180.0	118.0	56.0	80.0	128.0	112.5	160.0	61.5
150	213.0	285.5	426.5	169.0	23.0	189.0	130.5	56.0	80.0	128.0	112.5	160.0	61.5
200	267.0	312.5	475.5	169.0	23.0	209.5	195.0	60.0	80.0	128.0	112.5	160.0	61.5
250	325.5	360.5	603.0	212.5	23.0	262.5	195.5	68.0	100.0	135.5	130.0	200.0	68.5
300	380.0	387.5	659.5	212.5	23.0	284.5	230.5	78.0	100.0	135.5	130.0	200.0	68.5

DN (mm)	Q2 (mm)
50	28.5
65	44.0
80	63.5
100	84.0
125	110.5
150	137.5
200	191.5
250	239.0
300	285.5



**Butterfly valve type 565 electric PVDF/PA-GF**  
**Electric actuator 100-230V without manual override**  
**Wafer style metric/ANSI/BS/JIS**  
**Suitable for ABS, PVC-U, PVC-C, ecoFIT and PROGEF Systems**

**Model:**

- Installation length: EN558 row 20, ISO 5752 row 20, API 609 table 2
- Flange standards: ISO 7005 PN10/16, EN 1092 PN10/16, DIN 2501 PN10/16, ANSI/ASME B 16.5 Class 150, BS 1560: 1989 Class 125/150; BS 4504 PN10/16, JIS B 2220 10K, JIS B 2239 10K
- For easy installation and removal
- Voltage 100-230V, 50-60Hz
- Factory set control range 0-90°
- Heating element, position feedback (Open/Close/ Middle)
- Manual override integrated in electric actuator
- Suitable for water and uncritical media

**Option:**

- Individual configuration of the valve possible
- Hand or pneumatic actuators from GF
- Double sensor for electrical position feedback incl. LED feedback
- Optional accessories: Fail-safe return unit, Monitoring board, Position controller, Profibus DP board
- Additional manual override between valve and actuator

**Note:**

\*Preliminary data for DN100-300

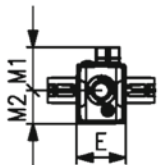
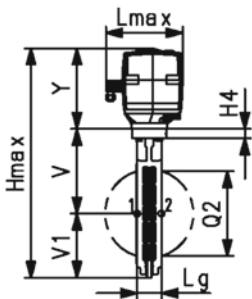

DN (mm)	PN (bar)	d (mm)	Size (inch)	kv-value ( $\Delta p=1$ bar) (L/min)	Do2 (mm)	Actuator	EPDM Code	SP	Weight (kg)
50	10	63	2	1445	63	EA45	<b>199 565 300</b>	1	3.3
65	10	75	2 ½	2530	75	EA120	<b>199 565 301</b>	1	4.6
80	10	90	3	4020	90	EA120	<b>199 565 302</b>	1	4.7
*	100	110	4	5850	110	EA120	<b>199 565 303</b>	1	5.6
*	125	140	5	11900	140	EA250	<b>199 565 304</b>	1	6.1
*	150	160	6	18050	160	EA250	<b>199 565 305</b>	1	8.7
*	200	225	8		225	EA250	<b>199 565 306</b>	1	10.0
*	250	280	10		280	EA250	<b>199 565 307</b>	1	14.5
*	300	315	12		315	EA250	<b>199 565 308</b>	1	18.2

DN (mm)	FKM Code	SP	Weight (kg)
50	<b>199 565 320</b>	1	3.4
65	<b>199 565 321</b>	1	4.7
80	<b>199 565 322</b>	1	4.8
*	<b>199 565 323</b>	1	5.8
*	<b>199 565 324</b>	1	6.4
*	<b>199 565 325</b>	1	9.0
*	<b>199 565 326</b>	1	10.5
*	<b>199 565 327</b>	1	15.2
*	<b>199 565 328</b>	1	19.4

DN (mm)	D2 (mm)	Wmax (mm)	Hmax (mm)	Lmax (mm)	H4 (mm)	V (mm)	V1 (mm)	Lg (mm)	E (mm)	M1 (mm)	M2 (mm)	Y (mm)
50	100.0	122.5	377.5	190.0	23.0	133.5	63.0	43.0	122.5	107.5	83.0	166.5
65	121.0	132.5	411.5	190.0	23.0	140.0	82.0	46.0	122.5	107.5	83.0	189.5
80	138.0	137.5	424.0	190.0	23.0	146.0	89.0	46.0	122.5	107.5	83.0	189.5
*	100	158.5	459.5	190.0	23.0	166.5	104.0	52.0	122.5	107.5	83.0	189.5
*	125	187.0	487.5	190.0	23.0	180.0	118.0	56.0	122.5	107.5	83.0	189.5
*	150	213.0	518.5	190.0	23.0	189.0	130.5	56.0	122.5	107.5	83.0	199.5
*	200	267.0	568.0	190.0	23.0	209.5	195.0	60.0	122.5	107.5	83.0	199.5
*	250	325.5	674.5	190.0	23.0	262.5	195.5	68.0	122.5	107.5	83.0	216.5
*	300	380.0	731.0	190.0	23.0	284.5	230.5	78.0	122.5	107.5	83.0	216.5

table continued on the next page

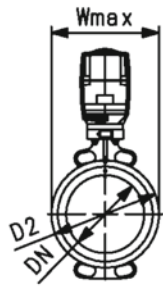

	<b>DN</b> (mm)	<b>Q2</b> (mm)
	50	28.5
	65	44.0
	80	63.5
	* 100	84.0
	* 125	110.5
	* 150	137.5
	* 200	191.5
	* 250	239.0
	* 300	285.5

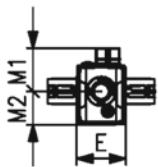
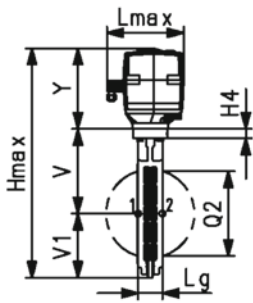



**Butterfly valve type 565 electric PVDF/PA-GF**  
**Electric actuator 24V without manual override**  
**Wafer style metric/ANSI/BS/JIS**  
**Suitable for ABS, PVC-U, PVC-C, ecoFIT and PROGEF Systems**

**Model:**

- Installation length: EN558 row 20, ISO 5752 row 20, API 609 table 2
- Flange standards: ISO 7005 PN10/16, EN 1092 PN10/16, DIN 2501 PN10/16, ANSI/ASME B 16.5 Class 150, BS 1560: 1989 Class 125/150; BS 4504 PN10/16, JIS B 2220 10K, JIS B 2239 10K
- For easy installation and removal
- Voltage 24V AC/DC
- Factory set control range 0-90°
- Heating element, position feedback (Open/Close/ Middle)
- Manual override integrated in electric actuator
- Suitable for water and uncritical media

**Option:**

- Individual configuration of the valve possible
- Hand or pneumatic actuators from GF
- Double sensor for electrical position feedback incl. LED feedback
- Optional accessories: Fail-safe return unit, Monitoring board, Position controller, Profibus DP board
- Additional manual override between valve and actuator

**Note:**

**\*Preliminary data for DN100-300**

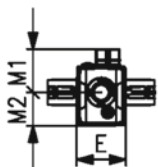
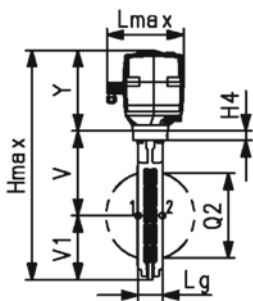
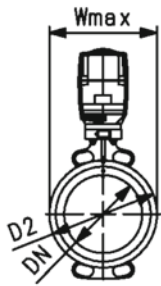

DN (mm)	PN (bar)	d (mm)	Size (inch)	kv-value ( $\Delta p=1$ bar) (L/min)	Do2 (mm)	Actuator	EPDM Code	SP	Weight (kg)
50	10	63	2	1445	63	EA45	<b>199 565 400</b>	1	3.3
65	10	75	2 ½	2530	75	EA120	<b>199 565 401</b>	1	4.6
80	10	90	3	4020	90	EA120	<b>199 565 402</b>	1	4.7
*	100	110	4	5850	110	EA120	<b>199 565 403</b>	1	5.6
*	125	140	5	11900	140	EA250	<b>199 565 404</b>	1	6.1
*	150	160	6	18050	160	EA250	<b>199 565 405</b>	1	8.7
*	200	225	8		225	EA250	<b>199 565 406</b>	1	10.0
*	250	280	10		280	EA250	<b>199 565 407</b>	1	14.5
*	300	315	12		315	EA250	<b>199 565 408</b>	1	18.2

DN (mm)	FKM Code	SP	Weight (kg)
50	<b>199 565 420</b>	1	3.4
65	<b>199 565 421</b>	1	4.7
80	<b>199 565 422</b>	1	4.8
*	<b>199 565 423</b>	1	5.8
*	<b>199 565 424</b>	1	6.4
*	<b>199 565 425</b>	1	9.0
*	<b>199 565 426</b>	1	10.5
*	<b>199 565 427</b>	1	15.2
*	<b>199 565 428</b>	1	19.4

DN (mm)	D2 (mm)	Wmax (mm)	Hmax (mm)	Lmax (mm)	H4 (mm)	V (mm)	V1 (mm)	Lg (mm)	E (mm)	M1 (mm)	M2 (mm)	Y (mm)
50	100.0	122.5	377.5	190.0	23.0	133.5	63.0	43.0	122.5	107.5	83.0	166.5
65	121.0	132.5	411.5	190.0	23.0	140.0	82.0	46.0	122.5	107.5	83.0	189.5
80	138.0	137.5	424.0	190.0	23.0	146.0	89.0	46.0	122.5	107.5	83.0	189.5
*	100	158.5	459.5	190.0	23.0	166.5	104.0	52.0	122.5	107.5	83.0	189.5
*	125	187.0	487.5	190.0	23.0	180.0	118.0	56.0	122.5	107.5	83.0	189.5
*	150	213.0	518.5	190.0	23.0	189.0	130.5	56.0	122.5	107.5	83.0	199.5
*	200	267.0	568.0	190.0	23.0	209.5	195.0	60.0	122.5	107.5	83.0	199.5
*	250	325.5	674.5	190.0	23.0	262.5	195.5	68.0	122.5	107.5	83.0	216.5
*	300	380.0	731.0	190.0	23.0	284.5	230.5	78.0	122.5	107.5	83.0	216.5

table continued on the next page

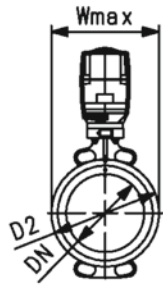

	<b>DN</b> (mm)	<b>Q2</b> (mm)
	50	28.5
	65	44.0
	80	63.5
*	100	84.0
*	125	110.5
*	150	137.5
*	200	191.5
*	250	239.0
*	300	285.5

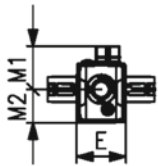
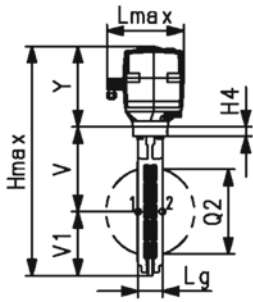



**Butterfly valve type 565 electric PVDF/PA-GF**  
**Smart electric actuator 100-230V without manual override**  
**Wafer style metric/ANSI/BS/JIS**  
**Suitable for ABS, PVC-U, PVC-C, ecoFIT and PROGEF Systems**

**Model:**

- Installation length: EN558 row 20, ISO 5752 row 20, API 609 table 2
- Flange standards: ISO 7005 PN10/16, EN 1092 PN10/16, DIN 2501 PN10/16, ANSI/ASME B 16.5 Class 150, BS 1560: 1989 Class 125/150; BS 4504 PN10/16, JIS B 2220 10K, JIS B 2239 10K
- For easy installation and removal
- Voltage 100-230V, 50-60Hz
- Factory set control range 0-90°
- Heating element, position feedback (Open/Close/ Middle)
- Connectivity via NFC and Wi-Fi Direct ensuring control, identification and visibility without opening the case
- Most relevant asset data visualized in the app
- Connection and control via app possible
- LED stripe for visual open/close 360° feedback
- Manual override integrated in electric actuator
- Suitable for water and uncritical media

**Option:**

- Individual configuration of the valve possible
- Hand or pneumatic actuators from GF
- Double sensor for electrical position feedback incl. LED feedback
- Optional accessories: Fail-safe return unit, Monitoring board, Position controller, Profibus DP board
- Additional manual override between valve and actuator

**Note:**

**\*Preliminary data for DN100-300**

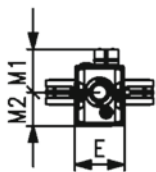
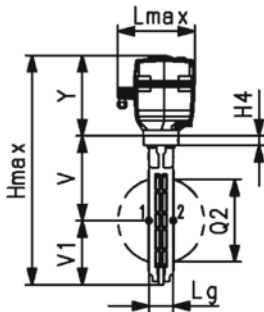
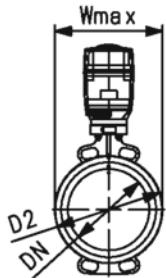

DN (mm)	PN (bar)	d (mm)	Size (inch)	kv-value (Δp=1 bar) (l/min)	Do2 (mm)	Actuator	EPDM Code	SP	Weight (kg)
50	10	63	2	1445	63	dEA45	<b>199 565 700</b>	1	3.3
65	10	75	2 ½	2530	75	dEA120	<b>199 565 701</b>	1	4.6
80	10	90	3	4020	90	dEA120	<b>199 565 702</b>	1	4.7
* 100	10	110	4	5850	110	dEA120	<b>199 565 703</b>	1	5.6
* 125	10	140	5	11900	140	dEA250	<b>199 565 704</b>	1	6.1
* 150	10	160	6	18050	160	dEA250	<b>199 565 705</b>	1	8.7
* 200	10	225	8		225	dEA250	<b>199 565 706</b>	1	10.0
* 250	6	280	10		280	dEA250	<b>199 565 707</b>	1	14.5
* 300	4	315	12		315	dEA250	<b>199 565 708</b>	1	18.2

DN (mm)	FKM Code	SP	Weight (kg)
50	<b>199 565 709</b>	1	3.4
65	<b>199 565 710</b>	1	4.7
80	<b>199 565 711</b>	1	4.8
* 100	<b>199 565 712</b>	1	5.8
* 125	<b>199 565 713</b>	1	6.4
* 150	<b>199 565 714</b>	1	9.0
* 200	<b>199 565 715</b>	1	10.5
* 250	<b>199 565 716</b>	1	15.2
* 300	<b>199 565 717</b>	1	19.4

DN (mm)	D2 (mm)	Wmax (mm)	Hmax (mm)	Lmax (mm)	H4 (mm)	V (mm)	V1 (mm)	Lg (mm)	E (mm)	M1 (mm)	M2 (mm)	Y (mm)
50	100.0	122.5	377.5	190.0	23.0	133.5	63.0	43.0	122.5	107.5	83.0	166.5
65	121.0	132.5	411.5	190.0	23.0	140.0	82.0	46.0	122.5	107.5	83.0	189.5
80	138.0	137.5	424.0	190.0	23.0	146.0	89.0	46.0	122.5	107.5	83.0	189.5
* 100	158.5	158.5	459.5	190.0	23.0	166.5	104.0	52.0	122.5	107.5	83.0	189.5
* 125	187.0	187.0	487.5	190.0	23.0	180.0	118.0	56.0	122.5	107.5	83.0	189.5
* 150	213.0	213.0	518.5	190.0	23.0	189.0	130.5	56.0	122.5	107.5	83.0	199.5
* 200	267.0	267.0	568.0	190.0	23.0	209.5	195.0	60.0	122.5	107.5	83.0	199.5
* 250	325.5	325.5	674.5	190.0	23.0	262.5	195.5	68.0	122.5	107.5	83.0	216.5
* 300	380.0	380.0	731.0	190.0	23.0	284.5	230.5	78.0	122.5	107.5	83.0	216.5

table continued on the next page



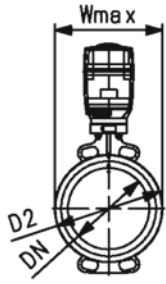

	DN (mm)	Q2 (mm)
	50	28.5
	65	44.0
	80	63.5
*	100	84.0
*	125	110.5
*	150	137.5
*	200	191.5
*	250	239.0
*	300	285.5

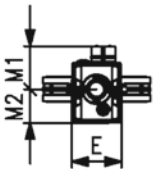
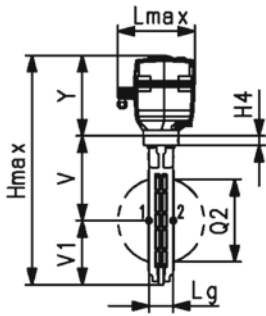



**Butterfly valve type 565 electric PVDF/PA-GF**  
**Smart electric actuator 24V without manual override**  
**Wafer style metric/ANSI/BS/JIS**  
**Suitable for ABS, PVC-U, PVC-C, ecoFIT and PROGEF Systems**

**Model:**

- Installation length: EN558 row 20, ISO 5752 row 20, API 609 table 2
- Flange standards: ISO 7005 PN10/16, EN 1092 PN10/16, DIN 2501 PN10/16, ANSI/ASME B 16.5 Class 150, BS 1560: 1989 Class 125/150; BS 4504 PN10/16, JIS B 2220 10K, JIS B 2239 10K
- For easy installation and removal
- Voltage 24V AC/DC
- Factory set control range 0-90°
- Heating element, position feedback (Open/Close/ Middle)
- Connectivity via NFC and Wi-Fi Direct ensuring control, identification and visibility without opening the case
- Most relevant asset data visualized in the app
- Connection and control via app possible
- LED stripe for visual open/close 360° feedback
- Manual override integrated in electric actuator
- Suitable for water and uncritical media

**Option:**

- Individual configuration of the valve possible
- Hand or pneumatic actuators from GF
- Double sensor for electrical position feedback incl. LED feedback
- Optional accessories: Fail-safe return unit, Monitoring board, Position controller, Profibus DP board
- Additional manual override between valve and actuator

**Note:**

**\*Preliminary data for DN100-300**

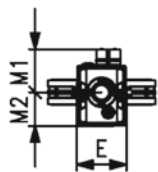
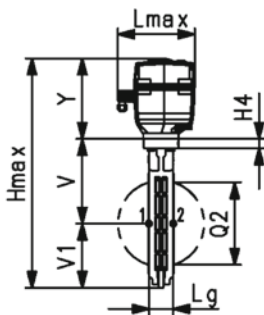
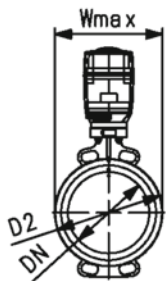

DN (mm)	PN (bar)	d (mm)	Size (inch)	kv-value (Δp=1 bar) (l/min)	Do2 (mm)	Actuator	EPDM Code	SP	Weight (kg)
50	10	63	2	1445	63	dEA45	<b>199 565 718</b>	1	3.3
65	10	75	2 ½	2530	75	dEA120	<b>199 565 719</b>	1	4.6
80	10	90	3	4020	90	dEA120	<b>199 565 720</b>	1	4.7
* 100	10	110	4	5850	110	dEA120	<b>199 565 721</b>	1	5.6
* 125	10	140	5	11900	140	dEA250	<b>199 565 722</b>	1	6.1
* 150	10	160	6	18050	160	dEA250	<b>199 565 723</b>	1	8.7
* 200	10	225	8		225	dEA250	<b>199 565 724</b>	1	10.0
* 250	6	280	10		280	dEA250	<b>199 565 725</b>	1	14.5
* 300	4	315	12		315	dEA250	<b>199 565 726</b>	1	18.2

DN (mm)	FKM Code	SP	Weight (kg)
50	<b>199 565 727</b>	1	3.4
65	<b>199 565 728</b>	1	4.7
80	<b>199 565 729</b>	1	4.8
* 100	<b>199 565 730</b>	1	5.8
* 125	<b>199 565 731</b>	1	6.4
* 150	<b>199 565 732</b>	1	9.0
* 200	<b>199 565 733</b>	1	10.5
* 250	<b>199 565 734</b>	1	15.2
* 300	<b>199 565 735</b>	1	19.4

DN (mm)	D2 (mm)	Wmax (mm)	Hmax (mm)	Lmax (mm)	H4 (mm)	V (mm)	V1 (mm)	Lg (mm)	E (mm)	M1 (mm)	M2 (mm)	Y (mm)
50	100.0	122.5	377.5	190.0	23.0	133.5	63.0	43.0	122.5	107.5	83.0	166.5
65	121.0	132.5	411.5	190.0	23.0	140.0	82.0	46.0	122.5	107.5	83.0	189.5
80	138.0	137.5	424.0	190.0	23.0	146.0	89.0	46.0	122.5	107.5	83.0	189.5
* 100	158.5	158.5	459.5	190.0	23.0	166.5	104.0	52.0	122.5	107.5	83.0	189.5
* 125	187.0	187.0	487.5	190.0	23.0	180.0	118.0	56.0	122.5	107.5	83.0	189.5
* 150	213.0	213.0	518.5	190.0	23.0	189.0	130.5	56.0	122.5	107.5	83.0	199.5
* 200	267.0	267.0	568.0	190.0	23.0	209.5	195.0	60.0	122.5	107.5	83.0	199.5
* 250	325.5	325.5	674.5	190.0	23.0	262.5	195.5	68.0	122.5	107.5	83.0	216.5
* 300	380.0	380.0	731.0	190.0	23.0	284.5	230.5	78.0	122.5	107.5	83.0	216.5

table continued on the next page

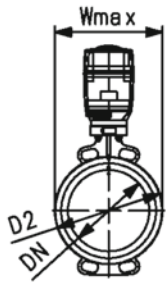

	DN (mm)	Q2 (mm)
	50	28.5
	65	44.0
	80	63.5
*	100	84.0
*	125	110.5
*	150	137.5
*	200	191.5
*	250	239.0
*	300	285.5

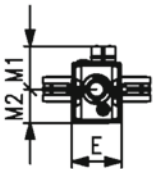
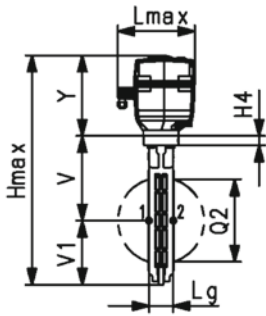



**Butterfly valve type 565 electric PVDF/PA-GF**  
**Electric actuator 100-230V with manual override**  
**Wafer style metric/ANSI/BS/JIS**  
**Suitable for ABS, PVC-U, PVC-C, ecoFIT and PROGEF Systems**

**Model:**

- Installation length: EN558 row 20, ISO 5752 row 20, API 609 table 2
- Flange standards: ISO 7005 PN10/16, EN 1092 PN10/16, DIN 2501 PN10/16, ANSI/ASME B 16.5 Class 150, BS 1560: 1989 Class 125/150; BS 4504 PN10/16, JIS B 2220 10K, JIS B 2239 10K
- For easy installation and removal
- Voltage 100-230V, 50-60Hz
- Factory set control range 0-90°
- Heating element, position feedback (Open/Close/ Middle)
- With additional manual override between valve and actuator
- Suitable for water and uncritical media

**Option:**

- Individual configuration of the valve possible
- Hand or pneumatic actuators from GF
- Double sensor for electrical position feedback incl. LED feedback
- Optional accessories: Fail-safe return unit, Monitoring board, Position controller, Profibus DP board

**Note:**

**\*Preliminary data for DN100-300**

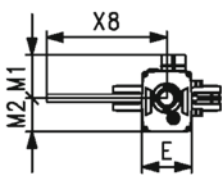
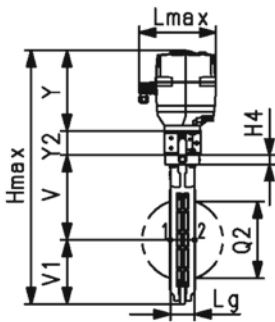
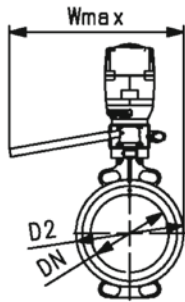

DN (mm)	PN (bar)	d (mm)	Size (inch)	kv-value ( $\Delta p=1$ bar) (l/min)	Do2 (mm)	Actuator	EPDM Code	SP	Weight (kg)
50	10	63	2	1445	63	dEA120	<b>199 565 340</b>	1	5.5
65	10	75	2 ½	2530	75	dEA120	<b>199 565 341</b>	1	5.8
80	10	90	3	4020	90	dEA120	<b>199 565 342</b>	1	5.9
*	100	110	4	5850	110	dEA120	<b>199 565 343</b>	1	6.6
*	125	140	5	11900	140	dEA250	<b>199 565 344</b>	1	7.1
*	150	160	6	18050	160	dEA250	<b>199 565 345</b>	1	9.7
*	200	225	8		225	dEA250	<b>199 565 346</b>	1	11.0

DN (mm)	FKM Code	SP	Weight (kg)
50	<b>199 565 360</b>	1	5.6
65	<b>199 565 361</b>	1	5.9
80	<b>199 565 362</b>	1	6.0
*	<b>199 565 363</b>	1	6.8
*	<b>199 565 364</b>	1	7.4
*	<b>199 565 365</b>	1	10.0
*	<b>199 565 366</b>	1	11.5

DN (mm)	D2 (mm)	Wmax (mm)	Hmax (mm)	Lmax (mm)	H4 (mm)	V (mm)	V1 (mm)	Lg (mm)	E (mm)	M1 (mm)	M2 (mm)	X8 (mm)
50	100.0	385.5	96.0	190.0	23.0	133.5	63.0	43.0	122.5	107.5	83.0	297.5
65	121.0	385.5	96.0	190.0	23.0	140.0	82.0	46.0	122.5	107.5	83.0	297.5
80	138.0	385.5	96.0	190.0	23.0	146.0	89.0	46.0	122.5	107.5	83.0	297.5
*	100	158.5	385.5	96.0	190.0	166.5	104.0	52.0	122.5	107.5	83.0	297.5
*	125	187.0	385.5	189.5	190.0	180.0	118.0	56.0	122.5	107.5	83.0	297.5
*	150	213.0	385.5	106.0	190.0	189.0	130.5	56.0	122.5	107.5	83.0	297.5
*	200	267.0	385.5	106.0	190.0	209.5	195.0	60.0	122.5	107.5	83.0	297.5

DN (mm)	Y (mm)	Y2 (mm)	Q2 (mm)	
50	189.5	60.0	28.5	
65	189.5	60.0	44.0	
80	189.5	60.0	63.5	
*	100	189.5	60.0	84.0
*	125	189.5	60.0	110.5
*	150	199.5	60.0	137.5
*	200	199.5	60.0	191.5



**Butterfly valve type 565 electric PVDF/PA-GF**  
**Electric actuator 24V with manual override**  
**Wafer style metric/ANSI/BS/JIS**  
**Suitable for ABS, PVC-U, PVC-C, ecoFIT and PROGEF Systems**

**Model:**

- Installation length: EN558 row 20, ISO 5752 row 20, API 609 table 2
- Flange standards: ISO 7005 PN10/16, EN 1092 PN10/16, DIN 2501 PN10/16, ANSI/ASME B 16.5 Class 150, BS 1560: 1989 Class 125/150; BS 4504 PN10/16, JIS B 2220 10K, JIS B 2239 10K
- For easy installation and removal
- Voltage 24V AC/DC
- Factory set control range 0-90°
- Heating element, position feedback (Open/Close/ Middle)
- Manual override integrated in electric actuator
- With additional manual override between valve and actuator
- Suitable for water and uncritical media

**Option:**

- Individual configuration of the valve possible
- Hand or pneumatic actuators from GF
- Double sensor for electrical position feedback incl. LED feedback
- Optional accessories: Fail-safe return unit, Monitoring board, Position controller, Profibus DP board

**Note:**

**\*Preliminary data for DN100-300**

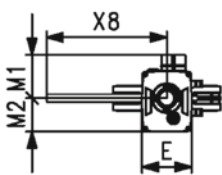
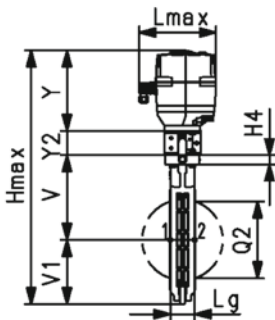
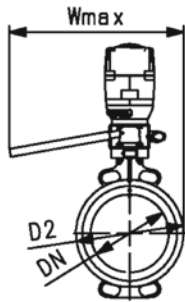

DN (mm)	PN (bar)	d (mm)	Size (inch)	kv-value ( $\Delta p=1$ bar) (L/min)	Do2 (mm)	Actuator	EPDM Code	SP	Weight (kg)
50	10	63	2	1445	63	dEA120	<b>199 565 440</b>	1	5.5
65	10	75	2 ½	2530	75	dEA120	<b>199 565 441</b>	1	5.8
80	10	90	3	4020	90	dEA120	<b>199 565 442</b>	1	5.9
* 100	10	110	4	5850	110	dEA120	<b>199 565 443</b>	1	6.6
* 125	10	140	5	11900	140	dEA250	<b>199 565 444</b>	1	7.1
* 150	10	160	6	18050	160	dEA250	<b>199 565 445</b>	1	9.7
* 200	10	225	8		225	dEA250	<b>199 565 446</b>	1	11.0

DN (mm)	FKM Code	SP	Weight (kg)
50	<b>199 565 460</b>	1	5.6
65	<b>199 565 461</b>	1	5.9
80	<b>199 565 462</b>	1	6.0
* 100	<b>199 565 463</b>	1	6.8
* 125	<b>199 565 464</b>	1	7.4
* 150	<b>199 565 465</b>	1	10.0
* 200	<b>199 565 466</b>	1	11.5

DN (mm)	D2 (mm)	Wmax (mm)	Hmax (mm)	Lmax (mm)	H4 (mm)	V (mm)	V1 (mm)	Lg (mm)	E (mm)	M1 (mm)	M2 (mm)	X8 (mm)
50	100.0	385.5	96.0	190.0	23.0	133.5	63.0	43.0	122.5	107.5	83.0	297.5
65	121.0	385.5	96.0	190.0	23.0	140.0	82.0	46.0	122.5	107.5	83.0	297.5
80	138.0	385.5	96.0	190.0	23.0	146.0	89.0	46.0	122.5	107.5	83.0	297.5
* 100	158.5	385.5	96.0	190.0	23.0	166.5	104.0	52.0	122.5	107.5	83.0	297.5
* 125	187.0	385.5	189.5	190.0	23.0	180.0	118.0	56.0	122.5	107.5	83.0	297.5
* 150	213.0	385.5	106.0	190.0	23.0	189.0	130.5	56.0	122.5	107.5	83.0	297.5
* 200	267.0	385.5	106.0	190.0	23.0	209.5	195.0	60.0	122.5	107.5	83.0	297.5

DN (mm)	Y (mm)	Y2 (mm)	Q2 (mm)
50	189.5	60.0	28.5
65	189.5	60.0	44.0
80	189.5	60.0	63.5
* 100	189.5	60.0	84.0
* 125	189.5	60.0	110.5
* 150	199.5	60.0	137.5
* 200	199.5	60.0	191.5



**Butterfly valve type 565 pneumatic PVDF/PA-GF  
FC (Fail safe to close)  
Wafer style metric/ANSI/BS/JIS  
Suitable for ABS, PVC-U, PVC-C, ecoFIT and PROGEF Systems**

**Model:**

- Installation length: EN558 row 20, ISO 5752 row 20, API 609 table 2
- Flange standards: ISO 7005 PN10/16, EN 1092 PN10/16, DIN 2501 PN10/16, ANSI/ASME B 16.5 Class 150, BS 1560: 1989 Class 125/150; BS 4504 PN10/16, JIS B 2220 10K, JIS B 2239 10K
- For easy installation and removal
- Control time 0-90° 1-2s
- Suitable for water and uncritical media

**Option:**

- Individual configuration of the valve possible
- Hand or electric actuators from GF
- Double sensor for electrical position feedback incl. LED feedback

**Note:**

**\*Preliminary data for DN100-300**

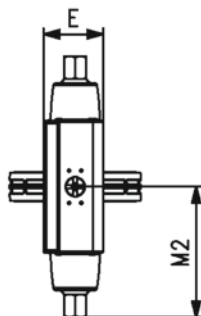
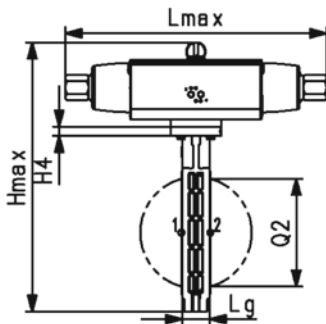
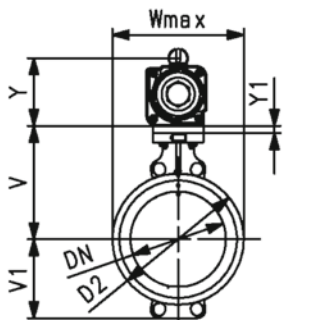

DN (mm)	PN (bar)	d (mm)	Size (inch)	kv-value ( $\Delta p=1$ bar) (L/min)	Do2 (mm)	Actuator	EPDM Code	SP	Weight (kg)
50	10	63	2	1445	63	PA30	<b>199 565 500</b>	1	3.2
65	10	75	2 ½	2530	75	PA30	<b>199 565 501</b>	1	3.5
80	10	90	3	4020	90	PA35	<b>199 565 502</b>	1	4.3
* 100	10	110	4	5850	110	PA40	<b>199 565 503</b>	1	5.9
* 125	10	140	5	11900	140	PA45	<b>199 565 504</b>	1	7.9
* 150	10	160	6	18050	160	PA50	<b>199 565 505</b>	1	10.7
* 200	10	225	8		225	PA60	<b>199 565 506</b>	1	16.4
* 250	10	280	10		280	PA65	<b>199 565 507</b>	1	25.5
* 300	6	315	12		315	PA70	<b>199 565 508</b>	1	32.1

DN (mm)	FKM Code	SP	Weight (kg)
50	<b>199 565 520</b>	1	3.3
65	<b>199 565 521</b>	1	3.6
80	<b>199 565 522</b>	1	4.4
* 100	<b>199 565 523</b>	1	6.1
* 125	<b>199 565 524</b>	1	8.2
* 150	<b>199 565 525</b>	1	11.0
* 200	<b>199 565 526</b>	1	16.9
* 250	<b>199 565 527</b>	1	26.2
* 300	<b>199 565 528</b>	1	33.3

DN (mm)	D2 (mm)	Wmax (mm)	Hmax (mm)	Lmax (mm)	H4 (mm)	V (mm)	V1 (mm)	Lg (mm)	E (mm)	M2 (mm)	Y (mm)	Y1 (mm)
50	100.0	118.5	309.5	274.5	23.0	133.5	63.0	43.0	70.5	137.2	98.5	15.0
65	121.0	132.5	335.5	275.5	23.0	140.0	82.0	46.0	70.5	137.2	98.5	15.0
80	138.0	138.0	361.0	325.5	23.0	146.0	89.0	46.0	83.5	162.6	111.5	15.0
* 100	158.5	158.5	385.5	359.5	23.0	166.5	104.0	52.0	87.0	179.8	115.0	0.0
* 125	187.0	187.0	447.5	418.0	23.0	180.0	118.0	56.0	107.5	209.0	149.5	0.0
* 150	213.0	213.0	472.5	434.0	23.0	189.0	130.5	56.0	111.5	217.0	153.5	0.0
* 200	267.0	267.0	545.5	547.5	23.0	209.5	195.0	60.0	135.0	273.6	177.0	0.0
* 250	325.5	325.5	666.0	681.0	23.0	262.5	195.5	68.0	148.0	323.0	190.0	18.0
* 300	380.0	380.0	742.5	681.0	23.0	284.5	230.5	78.0	168.0	340.5	210.5	18.0

DN (mm)	Q2 (mm)
50	28.5
65	44.0
80	63.5
* 100	84.0
* 125	110.5

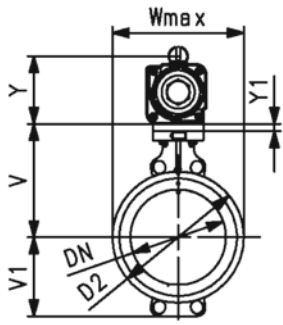

	<b>DN</b> (mm)	<b>Q2</b> (mm)
*	150	137.5
*	200	191.5
*	250	239.0
*	300	285.5

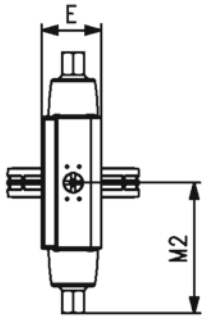
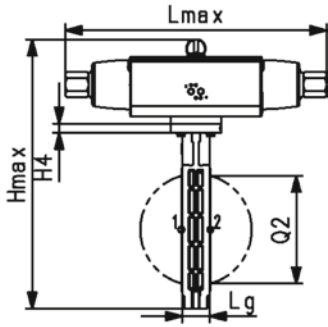



**Butterfly valve type 565 pneumatic PVDF/PA-GF**  
**FO (Fail safe to open)**  
**Wafer style metric/ANSI/BS/JIS**  
**Suitable for ABS, PVC-U, PVC-C, ecoFIT and PROGEF Systems**

**Model:**

- Installation length: EN558 row 20, ISO 5752 row 20, API 609 table 2
- Flange standards: ISO 7005 PN10/16, EN 1092 PN10/16, DIN 2501 PN10/16, ANSI/ASME B 16.5 Class 150, BS 1560: 1989 Class 125/150; BS 4504 PN10/16, JIS B 2220 10K, JIS B 2239 10K
- For easy installation and removal
- Control time 0-90° 1-2s
- Suitable for water and uncritical media

**Option:**

- Individual configuration of the valve possible
- Hand or electric actuators from GF
- Double sensor for electrical position feedback incl. LED feedback

**Note:**

\*Preliminary data for DN100-300

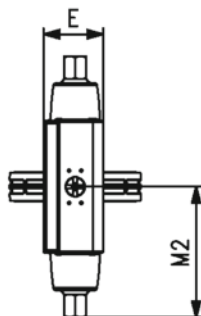
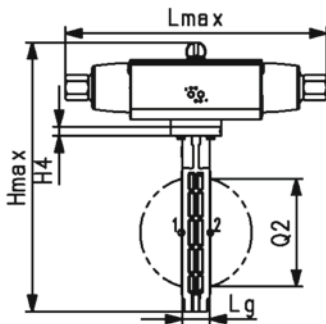
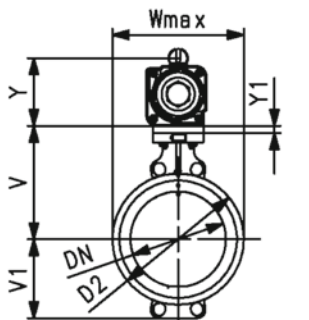

DN (mm)	PN (bar)	d (mm)	Size (inch)	kv-value ( $\Delta p=1$ bar) (L/min)	Do2 (mm)	Actuator	EPDM Code	SP	Weight (kg)
50	10	63	2	1445	63	PA30	<b>199 565 540</b>	1	3.2
65	10	75	2 ½	2530	75	PA30	<b>199 565 541</b>	1	3.5
80	10	90	3	4020	90	PA35	<b>199 565 542</b>	1	4.3
* 100	10	110	4	5850	110	PA40	<b>199 565 543</b>	1	5.9
* 125	10	140	5	11900	140	PA45	<b>199 565 544</b>	1	7.9
* 150	10	160	6	18050	160	PA50	<b>199 565 545</b>	1	10.7
* 200	10	225	8		225	PA60	<b>199 565 546</b>	1	16.4
* 250	10	280	10		280	PA65	<b>199 565 547</b>	1	25.5
* 300	6	315	12		315	PA70	<b>199 565 548</b>	1	32.1

DN (mm)	FKM Code	SP	Weight (kg)
50	<b>199 565 560</b>	1	3.3
65	<b>199 565 561</b>	1	3.6
80	<b>199 565 562</b>	1	4.4
* 100	<b>199 565 563</b>	1	6.1
* 125	<b>199 565 564</b>	1	8.2
* 150	<b>199 565 565</b>	1	11.0
* 200	<b>199 565 566</b>	1	16.9
* 250	<b>199 565 567</b>	1	26.2
* 300	<b>199 565 568</b>	1	33.3

DN (mm)	D2 (mm)	Wmax (mm)	Hmax (mm)	Lmax (mm)	H4 (mm)	V (mm)	V1 (mm)	Lg (mm)	E (mm)	M2 (mm)	Y (mm)	Y1 (mm)
50	100.0	118.5	309.5	274.5	23.0	133.5	63.0	43.0	70.5	137.5	98.5	15.0
65	121.0	132.5	335.5	275.5	23.0	140.0	82.0	46.0	70.5	137.5	98.5	15.0
80	138.0	138.0	361.0	325.5	23.0	146.0	89.0	46.0	83.5	163.0	111.5	15.0
* 100	158.5	158.5	385.5	359.5	23.0	166.5	104.0	52.0	87.0	180.0	115.0	0.0
* 125	187.0	187.0	447.5	418.0	23.0	180.0	118.0	56.0	107.5	209.0	149.5	0.0
* 150	213.0	213.0	472.5	434.0	23.0	189.0	130.5	56.0	111.5	217.0	153.5	0.0
* 200	267.0	267.0	545.5	547.5	23.0	209.5	195.0	60.0	135.0	274.0	177.0	0.0
* 250	325.5	325.5	666.0	681.0	23.0	262.5	195.5	68.0	148.0	323.0	190.0	18.0
* 300	380.0	380.0	742.5	681.0	23.0	284.5	230.5	78.0	168.0	340.5	210.5	18.0

DN (mm)	Q2 (mm)
50	28.5
65	44.0
80	63.5
* 100	84.0
* 125	110.5



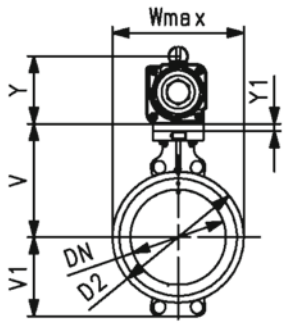

	<b>DN</b> (mm)	<b>Q2</b> (mm)
*	150	137.5
*	200	191.5
*	250	239.0
*	300	285.5

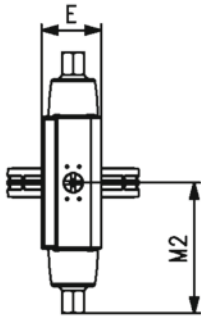
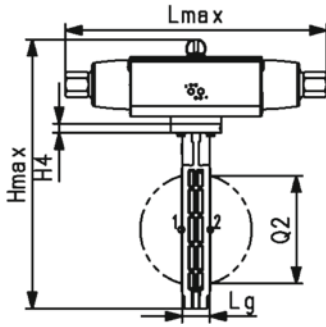



**Butterfly valve type 565 pneumatic PVDF/PA-GF**  
**DA (Double acting)**  
**Wafer style metric/ANSI/BS/JIS**  
**Suitable for ABS, PVC-U, PVC-C, ecoFIT and PROGEF Systems**

**Model:**

- Installation length: EN558 row 20, ISO 5752 row 20, API 609 table 2
- Flange standards: ISO 7005 PN10/16, EN 1092 PN10/16, DIN 2501 PN10/16, ANSI/ASME B 16.5 Class 150, BS 1560: 1989 Class 125/150; BS 4504 PN10/16, JIS B 2220 10K, JIS B 2239 10K
- For easy installation and removal
- Control time 0-90° 1-2s
- Suitable for water and uncritical media

**Option:**

- Individual configuration of the valve possible
- Hand or electric actuators from GF
- Double sensor for electrical position feedback incl. LED feedback

**Note:**

\*Preliminary data for DN100-300

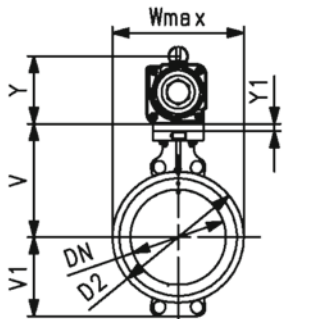

DN (mm)	PN (bar)	d (mm)	Size (inch)	kv-value ( $\Delta p=1$ bar) (L/min)	Do2 (mm)	Actuator	EPDM Code	SP	Weight (kg)
50	10	63	2	1445	63	PA35	<b>199 565 600</b>	1	2.6
65	10	75	2 ½	2530	75	PA35	<b>199 565 601</b>	1	2.9
80	10	90	3	4020	90	PA40	<b>199 565 602</b>	1	3.4
* 100	10	110	4	5850	110	PA45	<b>199 565 603</b>	1	4.5
* 125	10	140	5	11900	140	PA45	<b>199 565 604</b>	1	5.1
* 150	10	160	6	18050	160	PA55	<b>199 565 605</b>	1	7.7
* 200	10	225	8		225	PA60	<b>199 565 606</b>	1	10.7
* 250	10	280	10		280	PA65	<b>199 565 607</b>	1	16.9
* 300	6	315	12		315	PA70	<b>199 565 608</b>	1	22.4

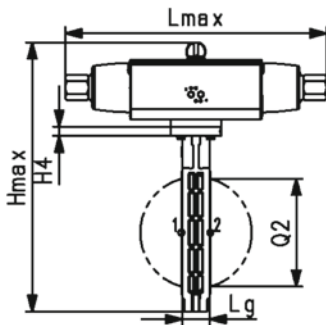

DN (mm)	FKM Code	SP	Weight (kg)
50	<b>199 565 620</b>	1	2.7
65	<b>199 565 621</b>	1	3.0
80	<b>199 565 622</b>	1	3.5
* 100	<b>199 565 623</b>	1	4.7
* 125	<b>199 565 624</b>	1	5.4
* 150	<b>199 565 625</b>	1	8.0
* 200	<b>199 565 626</b>	1	11.2
* 250	<b>199 565 627</b>	1	17.6
* 300	<b>199 565 628</b>	1	23.6

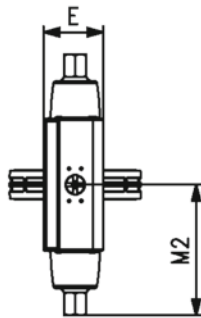

DN (mm)	D2 (mm)	Wmax (mm)	Hmax (mm)	Lmax (mm)	H4 (mm)	V (mm)	V1 (mm)	Lg (mm)	E (mm)	M2 (mm)	Y (mm)	Y1 (mm)
50	100.0	118.5	303.5	196.5	23.0	133.5	63.0	43.0	64.5	98.5	92.5	15.0
65	121.0	132.5	329.5	196.5	23.0	140.0	82.0	46.0	64.5	98.5	92.5	15.0
80	138.0	138.0	348.0	206.0	23.0	146.0	89.0	46.0	70.5	103.0	98.5	15.0
* 100	158.5	158.5	381.5	242.0	23.0	166.5	104.0	52.0	83.5	121.0	111.5	0.0
* 125	187.0	187.0	409.0	242.0	23.0	180.0	118.0	56.0	83.5	121.0	111.5	0.0
* 150	213.0	213.0	468.5	290.5	23.0	189.0	130.5	56.0	107.5	145.5	149.5	0.0
* 200	267.0	267.0	522.0	314.0	23.0	209.5	195.0	60.0	111.5	157.0	153.5	0.0
* 250	325.5	325.5	636.0	340.0	23.0	262.5	195.5	68.0	118.0	170.0	160.0	18.0
* 300	380.0	380.0	709.5	382.5	23.0	284.5	230.5	78.0	135.0	191.5	177.0	18.0

DN (mm)	Q2 (mm)
50	28.5
65	44.0
80	63.5
* 100	84.0
* 125	110.5

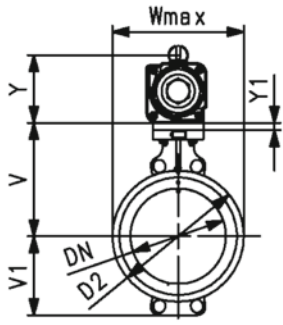

	DN (mm)	Q2 (mm)
*	150	137.5
*	200	191.5
*	250	239.0
*	300	285.5

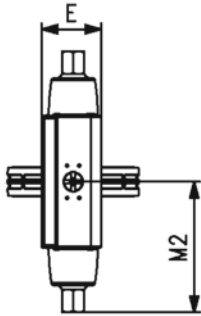
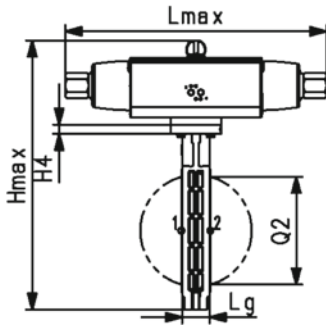

# Accessories

## Double Sensor for electrical position feedback

After being mounted in the valve or in the interface module, the double sensor is used to signal the CLOSED or OPEN position of the valve via an electric signal to a controller, supplied by the customer. The switching states are also output optically via two integrated LEDs.

Code	Open Signal color	Closed Signal color	Output circuit	Product picture
198546001	LED red	LED green	PNP	
198546002	LED green	LED red	PNP	

**i** Suitable connection cable code 198546150 available as an accessory.

## Switching ring for Double Sensor

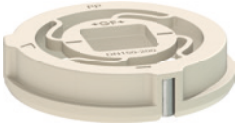
Code	DN	Product picture
199565900	50 - 80	
199565901	100 - 125	
199565902	150 - 200	
199565903	250 - 300	

**i** For manually operated valves an additional switching ring is required. For electrically or pneumatically operated valves, the switching ring is already pre-assembled.

## Hand lever

Hand lever incl. fastening screws.

Code	DN	Produktbild
199565906	50-80	
199565907	100-125	
199565908	150-200	

## Reduction gear

For valve operation via a manual gear with handwheel.

Code	DN	Product picture
161483471	50-200	
161483472	250-300	

## Electric Actuator EA25-250

The EA45/120/250 electric actuator is mounted on a valve (e.g. ball valve or butterfly valve) and connected to a control system provided by the customer. It actuates the valve with a rotary movement of up to 180°.

Code	DN	Type	Voltage	Torque max.	Interface	Product picture
198153184	50	EA45	AC 100-230V	45 Nm	F05* (WS 11/14)	
198153185	50	EA45	AC/DC 24V	45 Nm	F05* (WS 11/14)	
198153186	50 - 125	EA120	AC 100-230V	120 Nm	F07 (WS17)	
198153187	50 - 125	EA120	AC/DC 24V	120 Nm	F07 (WS17)	
198153188	150 - 300	EA250	AC 100-230V	250 Nm	F07 (WS17)	
198153189	150 - 300	EA250	AC/DC 24V	250 Nm	F07 (WS17)	

## Smart Actuator dEA45-250

The Smart Actuator dEA45/120/250 is mounted on a valve (e.g. ball valve or butterfly valve) and connected to a control system provided by the customer. It actuates the valve with a rotary movement up to 180°. The Smart Actuator offers wireless connectivity via NFC and Wi-Fi Direct, as well as control and reading of process data via downloadable App.

Code	DN	Type	Voltage	Torque max.	Interface	Product picture
198153194	50	dEA45	AC 100-230V	45 Nm	F05* (WS 11/14)	
198153195	50	dEA45	AC/DC 24V	45 Nm	F05* (WS 11/14)	
198153196	50 - 125	dEA120	AC 100-230V	120 Nm	F07 (WS17)	
198153197	50 - 125	dEA120	AC/DC 24V	120 Nm	F07 (WS17)	
198153198	150 - 300	dEA250	AC 100-230V	250 Nm	F07 (WS17)	
198153199	150 - 300	dEA250	AC/DC 24V	250 Nm	F07 (WS17)	

## Pneumatic Actuator PA30-70

The PA30 - PA90 pneumatic actuator can be mounted on any rotary valves with an interface according to ISO 5211.

### Single-acting FC

Code	DN	Type	Torque max.	Interface	Product picture
198811617	50 - 65	PA30	30 Nm	F05/07	
198811601	80	PA35	53 Nm	F05/07	
198811609	100	PA40	60 Nm	F05/07	
198811603	125	PA45	90 Nm	F07/10	
198811610	150	PA55	180 Nm	F07/10	
198811652	200	PA60	240Nm	F07/10/12	
198811607	250	PA65	360 Nm	F10/12	
198811612	300	PA70	480 Nm	F10/12	

### Single-acting FO

Code	DN	Type	Torque max.	Interface	Product picture
198811627	50 - 65	PA30	30 Nm	F05/07	
198811628	80	PA35	53 Nm	F05/07	
198811629	100	PA40	60 Nm	F05/07	
198811630	125	PA45	90 Nm	F07/10	
198811631	150	PA55	180 Nm	F07/10	
198811653	200	PA60	240Nm	F07/10/12	
198811633	250	PA65	360 Nm	F10/12	
198811634	300	PA70	480 Nm	F10/12	

### Double-acting DA

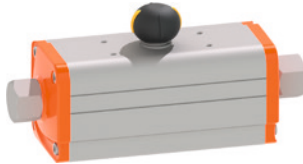
Code	DN	Type	Torque max.	Interface	Product picture
198811618	50 - 65	PA35	42 Nm	F03/05	
198811628	80	PA40	56 Nm	F05/07	
198811604	100 - 125	PA45	100 Nm	F05/07	
198811606	150	PA55	169 Nm	F07/10	
198811614	200	PA60	225 Nm	F07/10	
198811608	250	PA65	338 Nm	F07/10	
198811615	300	PA70	450 Nm	F10/12	

### Manual override

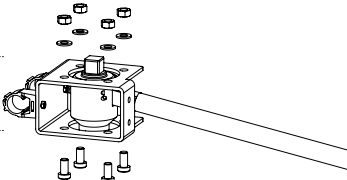
Code	DN	Product picture
199565914	50 - 80	
199565915	100 - 125	
199565916	150 - 200	

### Intermediate elements

Intermediate elements are required as a connection between valve and Actuator.

For Electric actuators EA45-250, dEA45-250

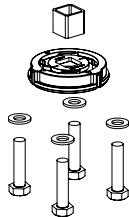
Code	DN	Type	Product picture
199565909	50	EA45	
199565910	50 - 80	EA120/dEA120	
199565911	100 - 125	EA120/dEA120	
199565912	150 - 200	EA250/dEA250	
199565913	250 - 300	EA250/dEA250	

For Pneumatic actuators, function FC/FO

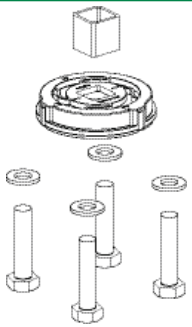
Code	DN	Type	Product picture
199565921	50	PA30	
199565921	65	PA30	
199565922	80	PA35	
199565923	100	PA40	
199565924	125	PA55	
199565925	150	PA50	
199565926	200	PA60	
199565927	250	PA65	
199565928	300	PA70	

For Pneumatic actuators, function DA

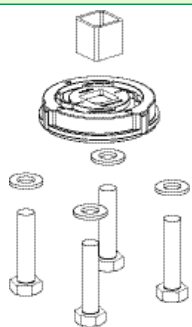
Code	DN	Type	Product picture
199565920	50	PA35	
199565920	65	PA35	
199565921	80	PA40	
199565923	100	PA45	
199565923	125	PA45	
199565925	150	PA55	
199565925	200	PA60	
199565926	250	PA65	
199565927	300	PA70	

For reduction gear

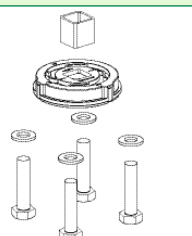
Code	DN	Product picture
199565917	50 - 80	
199565918	100 - 125	
199565919	150 - 200	
199565913	250 - 300	

Replacement seat liner

EPDM	FKM	DN	Product picture
199565930	199565940	50	
199565931	199565941	65	
199565932	199565942	80	
199565932	199565943	100	
199565934	199565944	125	
199565935	199565945	150	
199565936	199565946	200	
199565937	199565947	250	
199565938	199565948	300	

## Replacement o-ring

EPDM	FKM	DN	Product picture
199565951	199565961	50-80	
199565952	199565962	100-125	
199565953	199565963	150-200	
199565954	199565964	250-300	



For further information see [www.gfps.com/565](http://www.gfps.com/565)

■ Mobile apps and online tools to support configuration and calculation at [www.gfps.com/tools](http://www.gfps.com/tools)



The information and technical data (altogether "Data") herein are not binding, unless explicitly confirmed in writing. The Data neither constitutes any expressed, implied or warranted characteristics, nor guaranteed properties or a guaranteed durability. All Data is subject to modification. The General Terms and Conditions of Sale of Georg Fischer Piping Systems apply.

02/2021-A

© Georg Fischer Piping Systems Ltd, 8201 Schaffhausen/Switzerland  
Tel. +41 52 631 11 11 • [www.gfps.com](http://www.gfps.com) • E-Mail: [info.ps@georgfischer.com](mailto:info.ps@georgfischer.com)





**Notes**

---

---

---

---

---

---

---

---

---

---

---

---

---

---

---

---

---

---

---

---

---

---

---

---

---

---

---

---

## Notes

---

---

---

---

---

---

---

---

---

---

---

---

---

---

---

---

---

---

---

---

---

---

---

---

---

---

---

---

# Worldwide at home

Our sales companies and representatives ensure local customer support in more than 100 countries.

[www.gfps.com](http://www.gfps.com)

## Argentina / Southern South America

Georg Fischer Central Plastics Sudamérica S.R.L.  
Buenos Aires / Argentina  
Phone +54 11 4512 02 90  
gfcentral.ps.ar@georgfischer.com  
[www.gfps.com/ar](http://www.gfps.com/ar)

## Australia

Georg Fischer Pty Ltd  
Riverwood NSW 2210  
Phone +61 (0) 2 9502 8000  
australia.ps@georgfischer.com  
[www.gfps.com/au](http://www.gfps.com/au)

## Austria

Georg Fischer Rohrleitungssysteme GmbH  
3130 Herzogenburg  
Phone +43 (0) 2782 856 43-0  
austria.ps@georgfischer.com  
[www.gfps.com/at](http://www.gfps.com/at)

## Belgium / Luxembourg

Georg Fischer NV/SA  
1600 Sint-Pieters-Leeuw / Belgium  
Phone +32 (0) 2 556 40 20  
Fax +32 (0) 2 524 34 26  
be.ps@georgfischer.com  
[www.gfps.com/be](http://www.gfps.com/be)

## Brazil

Georg Fischer Sist. de Tub. Ltda.  
04571-020 São Paulo/SP  
Phone +55 (0) 11 5525 1311  
br.ps@georgfischer.com  
[www.gfps.com/br](http://www.gfps.com/br)

## Canada

Georg Fischer Piping Systems Ltd  
Mississauga, ON L5T 2B2  
Phone +1 (905) 670 8005  
Fax +1 (905) 670 8513  
ca.ps@georgfischer.com  
[www.gfps.com/ca](http://www.gfps.com/ca)

## China

Georg Fischer Piping Systems Ltd  
Shanghai 201319  
Phone +86 21 3899 3899  
china.ps@georgfischer.com  
[www.gfps.com/cn](http://www.gfps.com/cn)

## Denmark / Iceland

Georg Fischer A/S  
2630 Taastrup / Denmark  
Phone +45 (0) 70 22 19 75  
info.dk.ps@georgfischer.com  
[www.gfps.com/dk](http://www.gfps.com/dk)

## Finland

Georg Fischer AB  
01510 Vantaa  
Phone +358 (0) 9 586 58 25  
Fax +358 (0) 9 586 58 29  
info.fi.ps@georgfischer.com  
[www.gfps.com/fi](http://www.gfps.com/fi)

## France

Georg Fischer SAS  
95932 Roissy Charles de Gaulle Cedex  
Phone +33 (0) 1 41 84 68 84  
fr.ps@georgfischer.com  
[www.gfps.com/fr](http://www.gfps.com/fr)

## Germany

Georg Fischer GmbH  
73095 Albershausen  
Phone +49 (0) 7161 302 0  
info.de.ps@georgfischer.com  
[www.gfps.com/de](http://www.gfps.com/de)

## India

Georg Fischer Piping Systems Pvt. Ltd  
400 083 Mumbai  
Phone +91 22 4007 2000  
Fax +91 22 4007 2020  
branchoffice@georgfischer.com  
[www.gfps.com/in](http://www.gfps.com/in)

## Indonesia

PT Georg Fischer Indonesia  
Karawang 41371, Jawa Barat  
Phone +62 267 432 044  
Fax +62 267 431 857  
indonesia.ps@georgfischer.com  
[www.gfps.com/id](http://www.gfps.com/id)

## Italy

Georg Fischer S.p.A.  
20864 Agrate Brianza (MB)  
Phone +39 02 921 86 1  
Fax +39 02 921 86 24 7  
it.ps@georgfischer.com  
[www.gfps.com/it](http://www.gfps.com/it)

## Japan

Georg Fischer Ltd  
530-0003 Osaka  
Phone +81 (0) 6 6341 2451  
jp.ps@georgfischer.com  
[www.gfps.com/jp](http://www.gfps.com/jp)

## Korea

Georg Fischer Korea Co. Ltd  
Unit 2501, U-Tower  
120 Heungdeok Jungang-ro  
(Yeongdeok-dong)  
Giheung-gu, Yongin-si, Gyeonggi-do  
Phone +82 31 8017 1450  
Fax +82 31 217 1454  
kor.ps@georgfischer.com  
[www.gfps.com/kr](http://www.gfps.com/kr)

## Malaysia

Georg Fischer (M) Sdn. Bhd.  
41200 Klang, Selangor Darul Ehsan  
Phone +60 (0) 3 3122 5585  
Fax +60 (0) 3 3122 5575  
my.ps@georgfischer.com  
[www.gfps.com/my](http://www.gfps.com/my)

## Mexico / Northern Latin America

Georg Fischer S.A. de C.V.  
CP 66603 Apodaca, Nuevo León / Mexico  
Phone +52 (81) 1340 8586  
Fax +52 (81) 1522 8906  
mx.ps@georgfischer.com  
[www.gfps.com/mx](http://www.gfps.com/mx)

## Middle East

Georg Fischer Piping Systems (Switzerland) Ltd  
Dubai / United Arab Emirates  
Phone +971 4 289 49 60  
gcc.ps@georgfischer.com  
[www.gfps.com/int](http://www.gfps.com/int)

## Netherlands

Georg Fischer N.V.  
8161 PA Epe  
Phone +31 (0) 578 678 222  
nl.ps@georgfischer.com  
[www.gfps.com/nl](http://www.gfps.com/nl)

## New Zealand

Georg Fischer Ltd  
5018 Upper Hutt  
Phone +04 527 9813  
Fax +04 527 9834  
nz.ps@georgfischer.com  
[www.gfps.com/nz](http://www.gfps.com/nz)

## Norway

Georg Fischer AS  
1351 Rud  
Phone +47 67 18 29 00  
no.ps@georgfischer.com  
[www.gfps.com/no](http://www.gfps.com/no)

## Philippines

George Fischer Pte. Ltd.  
Philippines Representative Office  
1500 San Juan City  
Phone +632 571 2365  
Fax +632 571 2368  
sgp.ps@georgfischer.com  
[www.gfps.com/sg](http://www.gfps.com/sg)

## Poland

Georg Fischer Sp. z o.o.  
05-090 Sekocin Nowy  
Phone +48 (0) 22 31 31 0 50  
poland.ps@georgfischer.com  
[www.gfps.com/pl](http://www.gfps.com/pl)

## Romania

Georg Fischer Piping Systems (Switzerland) Ltd  
020257 Bucharest - Sector 2  
Phone +40 (0) 21 230 53 80  
ro.ps@georgfischer.com  
[www.gfps.com/int](http://www.gfps.com/int)

## Russia

Georg Fischer Piping Systems (Switzerland) Ltd  
Moscow 125040  
Phone +7 495 748 11 44  
ru.ps@georgfischer.com  
[www.gfps.com/ru](http://www.gfps.com/ru)

## Singapore

Georg Fischer Pte Ltd  
528 872 Singapore  
Phone +65 6747 0611  
Fax +65 6747 0577  
sgp.ps@georgfischer.com  
[www.gfps.com/sg](http://www.gfps.com/sg)

## Spain / Portugal

Georg Fischer S.A.  
28046 Madrid / Spain  
Phone +34 (0) 91 781 98 90  
es.ps@georgfischer.com  
[www.gfps.com/es](http://www.gfps.com/es)

## Sweden

Georg Fischer AB  
117 43 Stockholm  
Phone +46 (0) 8 506 775 00  
info.se.ps@georgfischer.com  
[www.gfps.com/se](http://www.gfps.com/se)

## Switzerland

Georg Fischer Rohrleitungssysteme (Schweiz) AG  
8201 Schaffhausen  
Phone +41 (0) 52 631 3026  
ch.ps@georgfischer.com  
[www.gfps.com/ch](http://www.gfps.com/ch)

## Taiwan

Georg Fischer Co. Ltd  
San Chung Dist., New Taipei City  
Phone +886 2 8512 2822  
Fax +886 2 8512 2823  
[www.gfps.com/tw](http://www.gfps.com/tw)

## United Kingdom / Ireland

George Fischer Sales Limited  
Coventry, CV2 2ST / United Kingdom  
Phone +44 (0) 2476 535 535  
uk.ps@georgfischer.com  
[www.gfps.com/uk](http://www.gfps.com/uk)

## USA / Caribbean

Georg Fischer LLC  
92618 Irvine, CA / USA  
Phone +1 714 731 8800  
Fax +1 714 731 6201  
us.ps@georgfischer.com  
[www.gfps.com/us](http://www.gfps.com/us)

## Vietnam

Georg Fischer Pte Ltd  
Representative Office  
Ho Chi Minh City  
Phone +84 28 3948 4000  
Fax +84 28 3948 4010  
sgp.ps@georgfischer.com  
[www.gfps.com/vn](http://www.gfps.com/vn)

## International

Georg Fischer Piping Systems (Switzerland) Ltd  
8201 Schaffhausen / Switzerland  
Phone +41 (0) 52 631 3003  
Fax +41 (0) 52 631 2893  
info.export@georgfischer.com  
[www.gfps.com/int](http://www.gfps.com/int)

The information and technical data (altogether "Data") herein are not binding, unless explicitly confirmed in writing. The Data neither constitutes any expressed, implied or warranted characteristics, nor guaranteed properties or a guaranteed durability. All Data is subject to modification. The General Terms and Conditions of Sale of Georg Fischer Piping Systems apply.

