

ALTHON GRC GP SMALL HEADWALL

Althon GRC GP Small Specification Information

A one piece glass reinforced headwall with an opening to suit 80mm diameter pipes and knockout webs to enlarge to 100mm and 150mm diameter pipes.

Althon GRC GP Small Headwall Installation

Dig out sufficiently to allow headwall flanges to finish flush with the batter. Take outfall pipe (minimum length 1.5m rigid impervious pipe) and slide it through headwall so it protrudes approximately 50mm. Make a good connection with the land drain and seal by returning approximately 150mm of soil into trench and consolidating. Unravel the string and draw the anchor back along the trench as the rest of the backfilling is completed.

Material: Glass Reinforced concrete

Weight approximately 11.5kg

All dimensions in mm

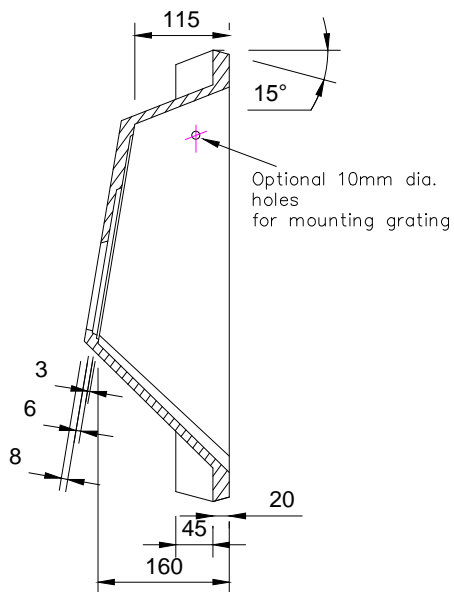
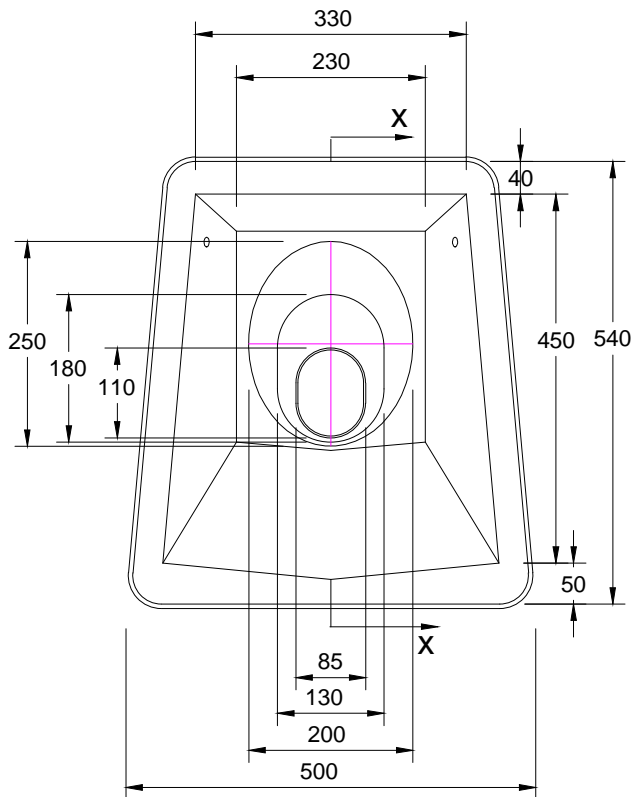

SECTION XX

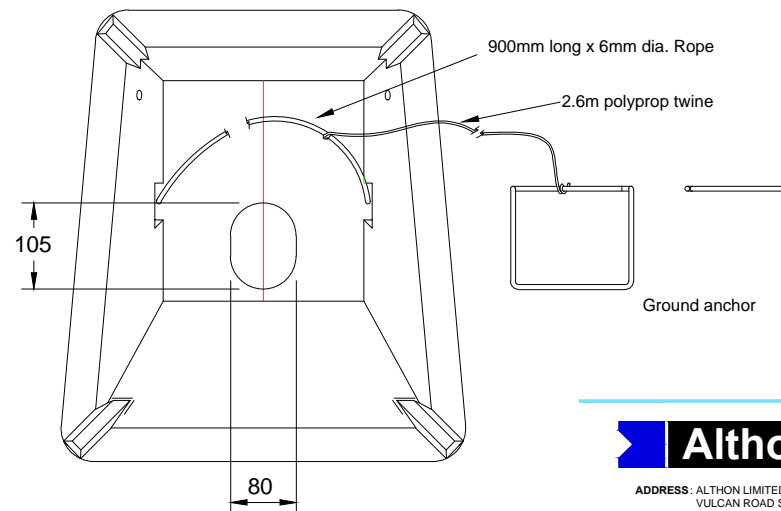

ADDRESS: ALTHON LIMITED
VULCAN ROAD SOUTH
NORWICH
NR6 6AF

TEL: 01603 488700
FAX: 01603 488598
EMAIL: sales@althon.co.uk
WEBSITE: www.althon.co.uk

DRAWING TITLE:

GRC GP SMALL HEADWALL

SCALE:	PAPER:	DATE:
NTS	A1	04 - 04 - 16

DRAWING No:

DRAWING FOR ILLUSTRATION PURPOSES ONLY