

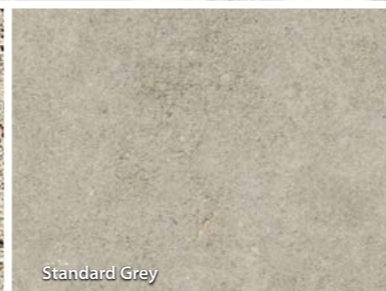

# Mini Beany<sup>®</sup>

Combined Kerb and Drainage System

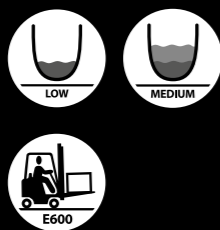

Mini Beany, Conservation, Bedford

Mini Beany is a low to medium capacity combined kerb and drainage system which evolved from the successful Beany range. The robust concrete construction makes this the ideal choice for areas of heavy or abnormally heavy wheel loads. Available in a choice of top finishes to complement a wide range of projects, from urban to rural.

See my related products...

Traffic Drain Water Management ..... pg 156

Top Blocks	Length (mm)	Width (mm)	Height (mm)	Unit Weight (kg)	Item Code
HB standard Grey	1000	250	240	95	<b>DR672010</b>
HB standard Grey	500	250	240	43	<b>DR672020</b>
45° SP Standard Grey	1000	250	240	98	<b>DR672040</b>
45° SP Standard Grey	500	250	240	43	DR672050
Bull Nose Conservation	1000	250	240	139	DR931210
Bull Nose Conservation	500	250	240	69.5	DR931211

Top Blocks	Length (mm)	Width (mm)	Height (mm)	Unit Weight (kg)	Item Code
Drop Kerb LH	1000	250	240/135	82	<b>DR689920</b>
Drop Kerb RH	1000	250	240/135	82	<b>DR689930</b>
Drop Kerb Centre Stone	1000	250	135	70	<b>DR689940</b>
Conservation Centre Stone	1000	250	135	70	DR931450

Base Channels	Length (mm)	Width (mm)	Invert Width (mm)	Depth (mm)	Invert Depth (mm)	Unit Weight (kg)	Item Code
210 Press Chan	1000	280	150	210	110	102	<b>DR696010</b>
260 Press Chan	1000	280	150	260	160	109	<b>DR697010</b>
310 Press Chan	1000	280	150	310	210	122	<b>DR698010</b>
360 Press Chan	1000	280	150	360	160	144	<b>DR699010</b>
210 Press Chan	500	280	150	210	110	51	<b>DR696020</b>
260 Press Chan	500	280	150	260	160	55	<b>DR697020</b>
310 Press Chan	500	280	150	310	210	61	DR698020
360 Press Chan	500	280	150	360	260	77	DR699020

Base Transitions	Length (mm)	Width (mm)	Invert Width (mm)	Depth (mm) Upstream/Downstream	Invert Depth (mm) Upstream/Downstream	Unit Weight (kg)	Item Code
210 - 260	1000	280	150	210/260	110/160	54	DR696330
260 - 310	1000	280	150	260/310	160/310	61	DR697330
310 - 360	1000	280	150	310/360	310/360	77	DR698330

Channel Accessories	Unit Weight (kg)	Item Code
210 End Cap	1	<b>DR696310</b>
260 End Cap	1	<b>DR697310</b>
310 End Cap	1	DR698310
360 End Cap	1	DR699310
210 Cap Outlet	2	DR696320
260 Cap Outlet	2	DR697320
310 Cap Outlet	2	DR698320
360 Cap Outlet	2	DR699320
Inline Side Outfall	150	<b>DR689000</b>
Inline End Outfall	142	DR689010
Slit Box	72	<b>DR689910</b>
Gully Outfall 150	277.25	<b>DR460401</b>
Gully Outfall 225	242.25	<b>DR460406</b>
Gully Outfall 150 Outlet	340.5	DR460400
Gully Outfall 225 Outlet	305.5	DR460405
HB Cable Duct Block	3	DR689900
45° SP Cable Duct Block	3	DR689905

Cover Plates	Unit Weight (kg)	Item Code
Cover Plate 500 mm	12	<b>DR691030</b>
Cover Plate 1000 mm	6	<b>DR691040</b>
Cover Plate 30/10	6	DR691050
Cover Plate 9/6	6	DR691060

Access Covers	Unit Weight (kg)	Item Code
HB Access Cover N/S	40	<b>DR691010</b>
45° SP Access Cover N/S	40	<b>DR691015</b>
HB Access Cover O/S	40	<b>DR691020</b>
45° SP Access Cover O/S	40	<b>DR691025</b>
Bull Nose Access Cover N/S	40	<b>DR691027</b>

Radial Tops	Unit Weight (kg)	Item Code
Mini Beany HB Cut 30/10 Ext Rad	44	<b>DR672310</b>
Mini Beany HB Cut 30/10 Int Rad	44	DR672311
Mini Beany HB Cut 9/6 Ext Rad	44	DR672320
Mini Beany HB Cut 9/6 Int Rad	44	DR672321
Mini Beany HB 9/6 Ext Cons Tex	35	DR931620
Mini Beany BN 9/6 Int Cons Tex	35	DR931230
Mini Beany BN 30/10 Ex Cons Tex	35	DR931215
Mini Beany BN 9/6 Ext Cons Tex	35	DR931225
Mini Beany 45deg Top 30/10 Ext	35	DR672110

Mini Beany with reference numbers indicated in **bold** black are available ex-stock. Mini Beany with reference numbers indicated in light are manufactured to order. Contact our sales office to discuss your requirements.

Radial Base Channels	Unit Weight (kg)	Item Code
210 Base 30/10	51	DR696110
210 Base 9/6	51	DR696120
260 Base 30/10	55	DR697110
260 Base 9/6	55	DR697120
310 Base 30/10	61	DR698110
310 Base 9/6	61	DR698120
360 Base 30/10	77	DR699110
360 Base 9/6	77	DR699120

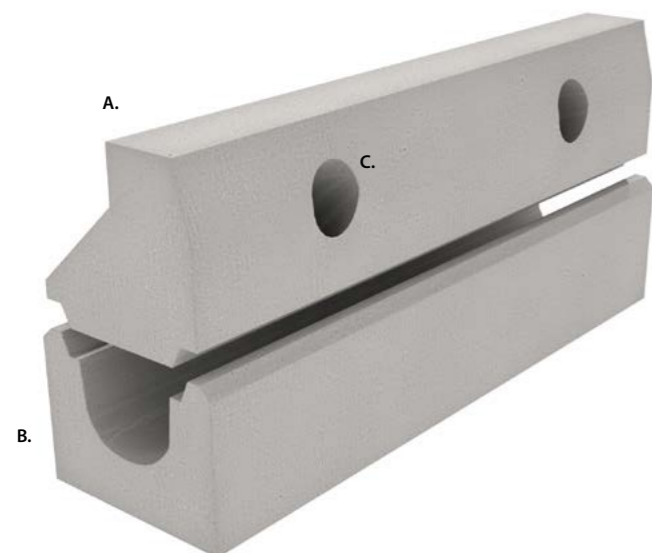

- A. Mini Beany Top Unit
- B. Base Channel
- C. Divergent Aperture



Mini Beany, Conservation, Bedford

# Mini Beany

## A Top Blocks

Top Blocks	Length (mm)	Width (mm)	Height (mm)	Unit Weight (kg)	Item Code
HB standard Grey	1000	250	240	95	<b>DR672010</b>
HB standard Grey	500	250	240	43	<b>DR672020</b>
45° SP Standard Grey	1000	250	240	98	<b>DR672040</b>
45° SP Standard Grey	500	250	240	43	DR672050
Bull Nose Conservation	1000	250	240	139	DR931210
Bull Nose Conservation	500	250	240	69.5	DR931211

## A1 Road Crossing Accessories

Road Crossing Accessories	Length (mm)	Width (mm)	Height (mm)	Unit Weight (kg)	Item Code
Drop Kerb LH	1000	250	240/135	82	<b>DR689920</b>
Drop Kerb RH	1000	250	240/135	82	<b>DR689930</b>
Drop Kerb Centre Stone	1000	250	135	70	<b>DR689940</b>
Conservation Centre Stone	1000	250	135	70	DR931450

## B Base Channels

Base Channels	Length (mm)	Width (mm)	Invert Width (mm)	Depth (mm)	Invert Depth (mm)	Unit Weight (kg)	Item Code
210 Press Chan	1000	280	150	210	110	102	<b>DR696010</b>
260 Press Chan	1000	280	150	260	160	109	<b>DR697010</b>
310 Press Chan	1000	280	150	310	210	122	<b>DR698010</b>
360 Press Chan	1000	280	150	360	160	144	<b>DR699010</b>
210 Press Chan	500	280	150	210	110	51	<b>DR696020</b>
260 Press Chan	500	280	150	260	160	55	<b>DR697020</b>
310 Press Chan	500	280	150	310	210	61	DR698020
360 Press Chan	500	280	150	360	260	77	DR699020

## C Transition Channels

Transition Channels	Length (mm)	Width (mm)	Invert Width (mm)	Depth (mm) Upstream/Downstream	Invert Depth (mm) Upstream/Downstream	Unit Weight (kg)	Item Code
210 - 260	500	280	150	210/260	110/160	54	DR696330
260 - 310	500	280	150	260/310	160/310	61	DR697330
310 - 360	500	280	150	310/360	310/360	77	DR698330

Mini Beany with reference numbers indicated in **bold** black are available ex-stock. Mini Beany with reference numbers indicated in light are manufactured to order. Contact our sales office to discuss your requirements.

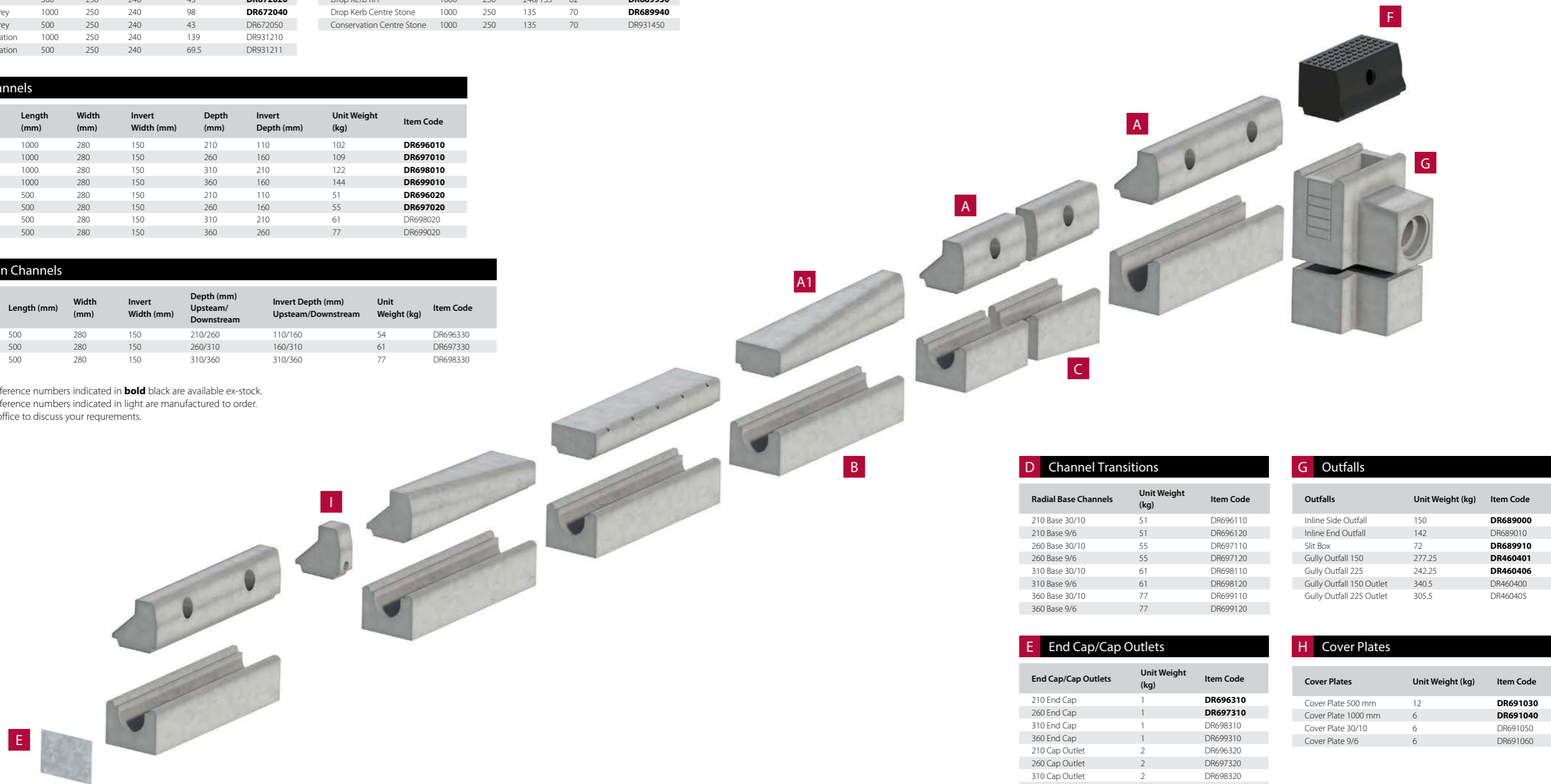

## D Channel Transitions

Radial Base Channels	Unit Weight (kg)	Item Code
210 Base 30/10	51	DR696110
210 Base 9/6	51	DR696120
260 Base 30/10	55	DR697110
260 Base 9/6	55	DR697120
310 Base 30/10	61	DR698110
310 Base 9/6	61	DR698120
360 Base 30/10	77	DR699110
360 Base 9/6	77	DR699120

## E End Cap/Cap Outlets

End Cap/Cap Outlets	Unit Weight (kg)	Item Code
210 End Cap	1	<b>DR696310</b>
260 End Cap	1	<b>DR697310</b>
310 End Cap	1	DR698310
360 End Cap	1	DR699310
210 Cap Outlet	2	DR696320
260 Cap Outlet	2	DR697320
310 Cap Outlet	2	DR698320
360 Cap Outlet	2	DR699320

## F Access Covers

Access Covers	Unit Weight (kg)	Item Code
HB Access Cover N/S	40	<b>DR691010</b>
45° SP Access Cover N/S	40	<b>DR691015</b>
HB Access Cover O/S	40	<b>DR691020</b>
45° SP Access Cover O/S	40	<b>DR691025</b>
Bull Nose Access Cover N/S	40	<b>DR691027</b>

## G Outfalls

Outfalls	Unit Weight (kg)	Item Code
Inline Side Outfall	150	<b>DR689000</b>
Inline End Outfall	142	DR689010
Slit Box	72	<b>DR689910</b>
Gully Outfall 150	277.25	<b>DR460401</b>
Gully Outfall 225	242.25	<b>DR460406</b>
Gully Outfall 150 Outlet	340.5	DR460400
Gully Outfall 225 Outlet	305.5	DR460405

## H Cover Plates

Cover Plates	Unit Weight (kg)	Item Code
Cover Plate 500 mm	12	<b>DR691030</b>
Cover Plate 1000 mm	6	<b>DR691040</b>
Cover Plate 30/10	6	DR691050
Cover Plate 9/6	6	DR691060

## I Cable Duct Blocks

Cable Duct Blocks	Unit Weight (kg)	Item Code
HB Cable Duct Block	3	DR689900
45° SP Cable Duct Block	3	DR689905