



Buckby Cycle Stand

Galvanised, Galvanised & Colour or Stainless



The VELOPA Buckby Cycle Stand is a shaped tubular cycle stand. The design allows the frame of the bicycle to be secured by the users own security lock. The Buckby Cycle Stand is suitable for securing two bicycles. The Buckby Cycle Stand is available in galvanised steel, Grade 304 and Grade 316 Stainless Steel, with ragged feet for casting into new concrete or flanged feet for bolting to an existing surface.

The practical and durable nature of the VELOPA Buckby Cycle Stand stand ensures that the stand will complement any environment and offers an aesthetically pleasing alternative to the Sheffield Cycle Stand.

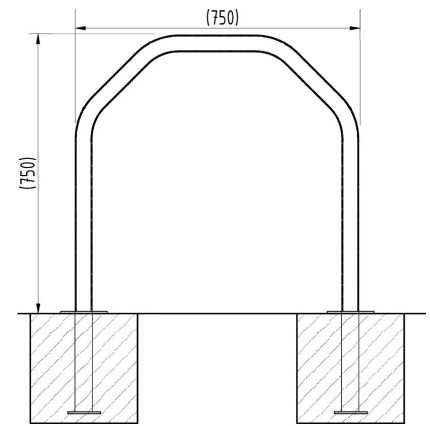

| Part Number | Description | Weight (kg) |
|-------------|-------------------------------------|-------------|
| 138 515 185 | Galvanised - Concrete In | 9kg |
| 138 515 180 | Galvanised - Bolt Down | 8kg |
| 138 515 186 | Galvanised & Black - Concrete In | 9kg |
| 138 515 181 | Galvanised & Black - Bolt Down | 8kg |
| 138 515 187 | Galvanised & Colour - Concrete In | 9kg |
| 138 515 182 | Galvanised & Colour - Bolt Down | 8kg |
| 138 515 184 | Stainless Steel - 304 - Concrete In | 9kg |
| 138 515 189 | Stainless Steel - 304 - Bolt down | 8kg |
| 138 515 188 | Stainless Steel - 316 - Concrete In | 9kg |
| 138 515 183 | Stainless Steel - 316 - Bolt Down | 8kg |

Product details

- 48mm diameter tube
- 750mm x 750mm (height x length)
- Concrete in 300mm (below ground)
- Round flange plate – 133mm x 5mm
- Each stand requires 6 bolts

Installation & use

Bolt down to a suitable concrete surface.
 Telescopic, removable and concrete in are supplied with welded fixing spikes to ensure firm ground anchorage into concrete.
 Telescopic, removable and concrete in require a suitable excavated hole for installing into concrete.
 Products are guaranteed for 12 months (if installed and used correctly).



www.autopa.co.uk
 +44 (0)1788 550556

AUTOPA Limited
 Cottage Leap, Rugby, Warwickshire CV21 3XP

