



# Kirby Cycle Stand

## Galvanised, Galvanised & Colour or Stainless



The tubular cycle stand, a familiar sight throughout the UK, allows the frame of the bicycle to be secured by the users own security lock. Suitable for securing two bicycles. The Kirby is a rolled variant of the ever popular Sheffield cycle stand.

The practical and durable nature of the VELOPA Kirby cycle stand ensures it has been consistently recommended by cycling groups since it's introduction in the 2000's. Shown is the galvanised flanged version of the Kirby Cycle Stand.

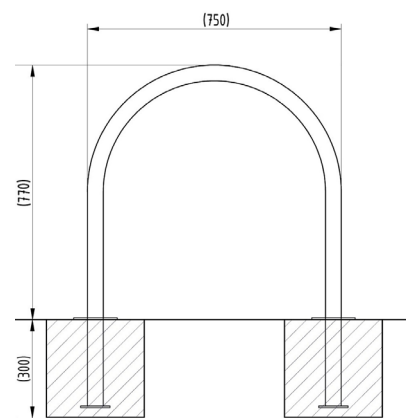

Part Number	Description	Weight (kg)
138 515 145	Galvanised - Concrete In	9kg
138 515 140	Galvanised - Bolt Down	8kg
138 515 147	Galvanised & Black - Concrete In	9kg
138 515 142	Galvanised & Black - Bolt Down	8kg
138 515 146	Galvanised & Colour - Concrete In	9kg
138 515 144	Galvanised & Colour - Bolt Down	8kg
138 515 155	Stainless Steel Grade 304 - Concrete In	9kg
138 515 150	Stainless Steel Grade 304 - Bolt Down	8kg

### Product details

- 48mm diameter tube
- 770mm x 750mm (height x length)
- Concrete in 300mm (below ground)
- Round flange plate – 133mm x 5mm
- Each stand requires 6 bolts (bolt down)

### Installation & use

Bolt down to a suitable concrete surface.  
 Telescopic, removable and concrete in are supplied with welded fixing spikes to ensure firm ground anchorage into concrete.  
 Telescopic, removable and concrete in require a suitable excavated hole for installing into concrete.  
 Products are guaranteed for 12 months (if installed and used correctly).



[www.autopa.co.uk](http://www.autopa.co.uk)  
 +44 (0)1788 550556

AUTOPA Limited  
 Cottage Leap, Rugby, Warwickshire CV21 3XP

