



Model R Cycle Holder Galvanised



The simplest cycle holder, a familiar sight throughout the UK, allows the tyre of the bicycle to be supported. The stand is fixed to a suitable wall and can be spaced at no less than 610mm between holders for cost effective cycle parking. The Model R is available in either 90° or 45° versions which allow for cycles to be parked either head-on or angled.

The practical and durable nature of the VELOPA Model R cycle holder ensures it has been consistently specified and used since it's introduction in the 1950's.

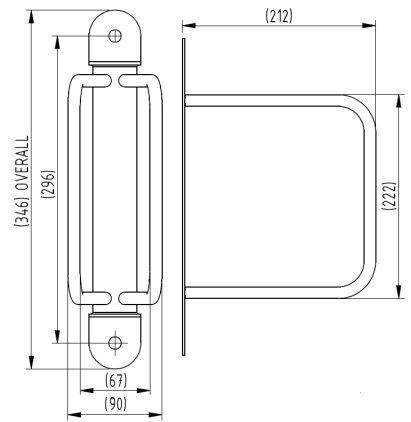

<u>Part Number</u>	<u>Description</u>	<u>Weight (kg)</u>
138 200 001	Model R90°	2kg
138 200 002	Model R45°	2kg

Product details

- 12mm diameter bar
- 346mm x 90mm x 212mm (height x width x depth)
- 41mm diameter mounting tube
- Each stand requires 2 bolts
- 45° and 90° angle to wall

Installation & use

Must be fixed to a suitable brick or concrete wall.
Centre of holders should be approximately 345mm (197mm to centre of lower fixing hole) above ground level.
This product is guaranteed for 12 months (if installed and used correctly).



www.autopa.co.uk
+44 (0)1788 550556

AUTOPA Limited
Cottage Leap, Rugby, Warwickshire CV21 3XP

