

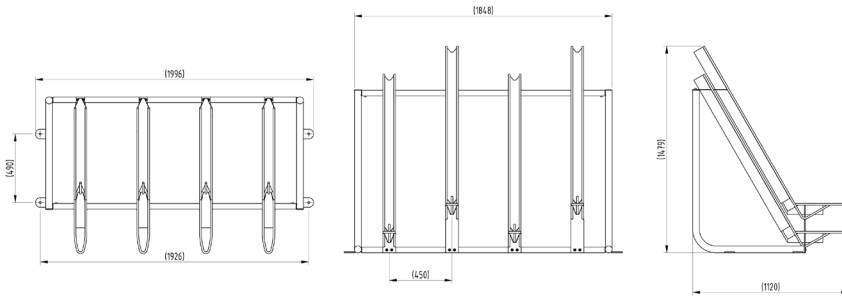

# Semi-Vertical Cycle Rack Galvanised



The VELOPA Semi-Vertical Cycle Rack is designed to offer a cycle parking solution suitable for where space is at a premium. The design allows the user to lock their bicycle through the stand to ensure security, the ramp allows easy placing of the bicycle into place and the hooped bar at the base ensures the bicycle is retained in position correctly. The Semi-Vertical Cycle Rack alternates high and low holders to allow for greater cycle parking density. Individual Holders are also available.

The practical and durable nature of the VELOPA Semi-Vertical Cycle Rack ensures that the rack is suitable for all environments where high density of cycle parking is required, especially those where space is at a premium.



<u>Part Number</u>	<u>Description</u>	<u>Weight (kg)</u>
138 200 282	Semi Vertical Cycle Holder with 2 Holders	33kg
138 200 283	Semi Vertical Cycle Holder with 3 Holders	41kg
138 200 280	Semi-Vertical Cycle Holder with 4 Holders	49kg
138 200 285	Semi-Vertical Cycle Holder with 5 Holders	57kg
138 200 286	Semi-Vertical Cycle Holder with 6 Holders	65kg
138 200 287	Semi-Vertical Cycle Holder with 7 Holders	73kg
138 200 288	Semi-Vertical cycle Holder with 8 Holders	81kg

## Product details

- 1460mm x 1100mm (height x width)
- 450mm distance between holders (centre to centre)
- Length varies per number of holders
- Price excludes fixing down bolts

## Installation & use

Fix using M12 bolts to a suitable concrete surface. First stand should be no closer than 400mm from nearest obstruction. This product is guaranteed for 12 months (if installed and used correctly).



[www.autopa.co.uk](http://www.autopa.co.uk)  
+44 (0)1788 550556

AUTOPA Limited  
Cottage Leap, Rugby, Warwickshire CV21 3XP

