

# Product Catalogue 2021

SignscapeandSignconex

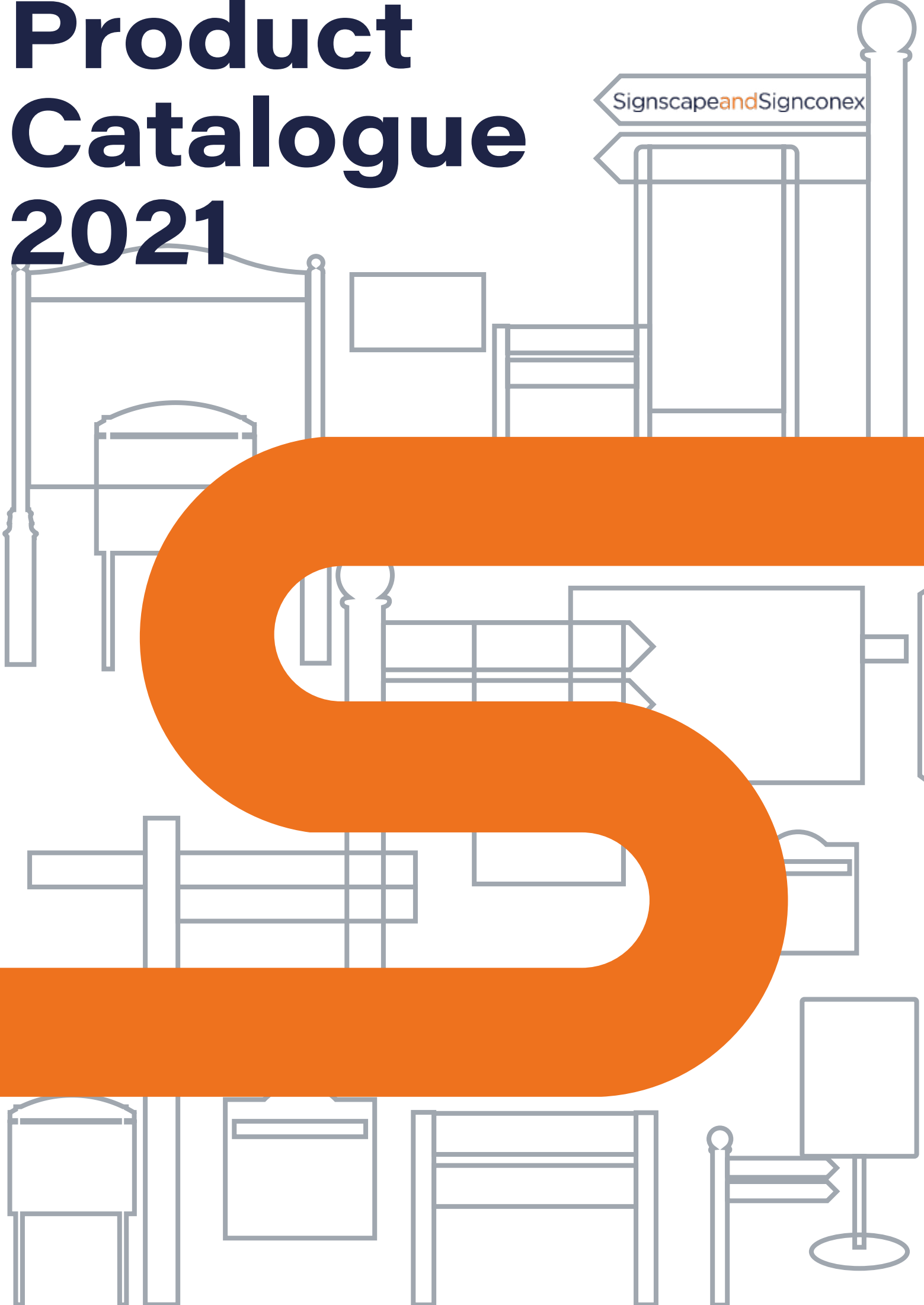
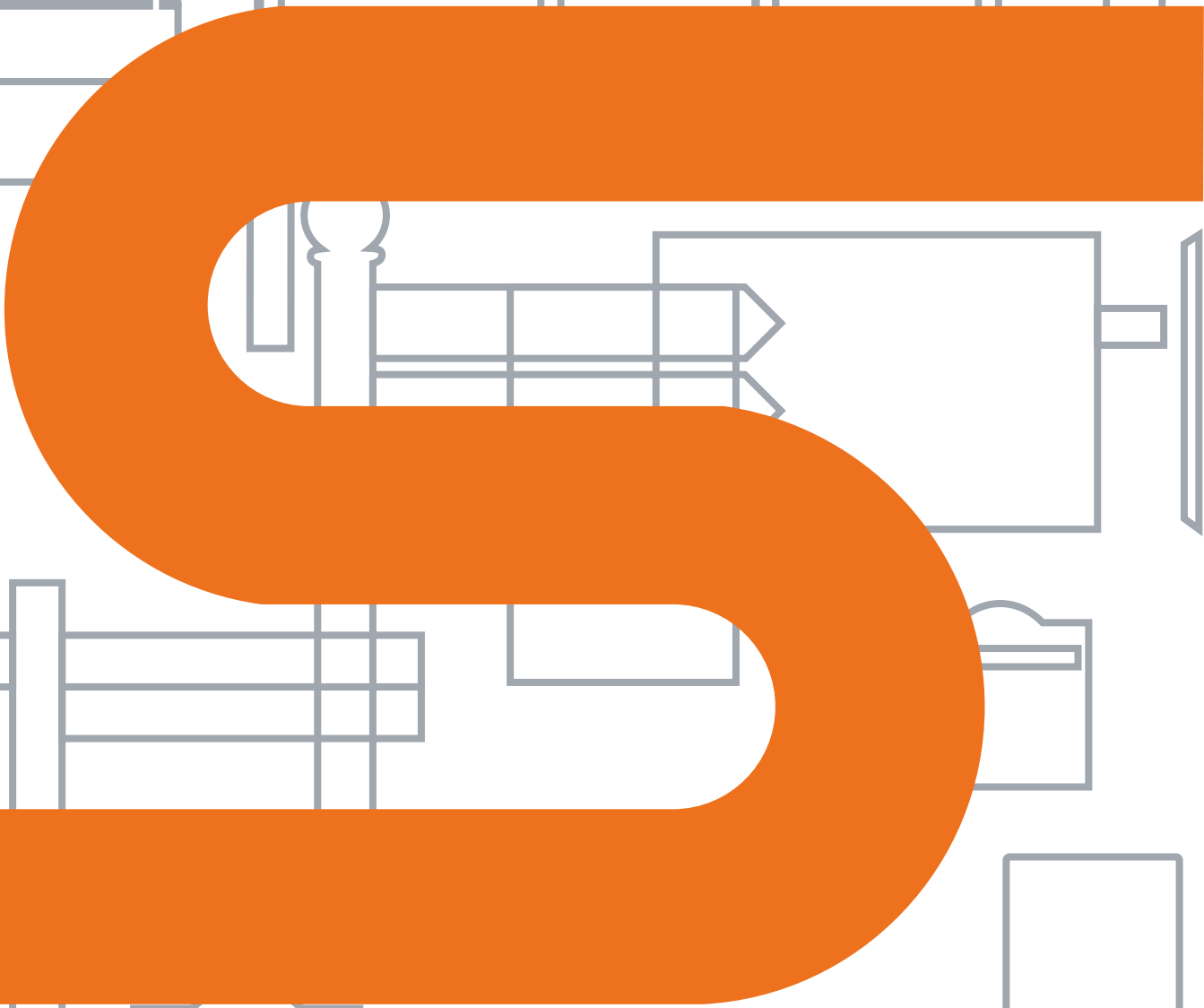

# CONTACT US

Pear Tree Industrial Estate  
Bath Road  
Upper Langford  
Bristol  
BS40 5DJ

Tel: 01934 852 888  
Visit: [www.sasl.co.uk](http://www.sasl.co.uk)

**Sales**  
01934 852 888  
[Sales@signscape.co.uk](mailto:Sales@signscape.co.uk)

**Accounts**  
01934 853 949  
[Accounts@signscape.co.uk](mailto:Accounts@signscape.co.uk)



©Signscape and Signconex Limited 2021. All rights reserved.

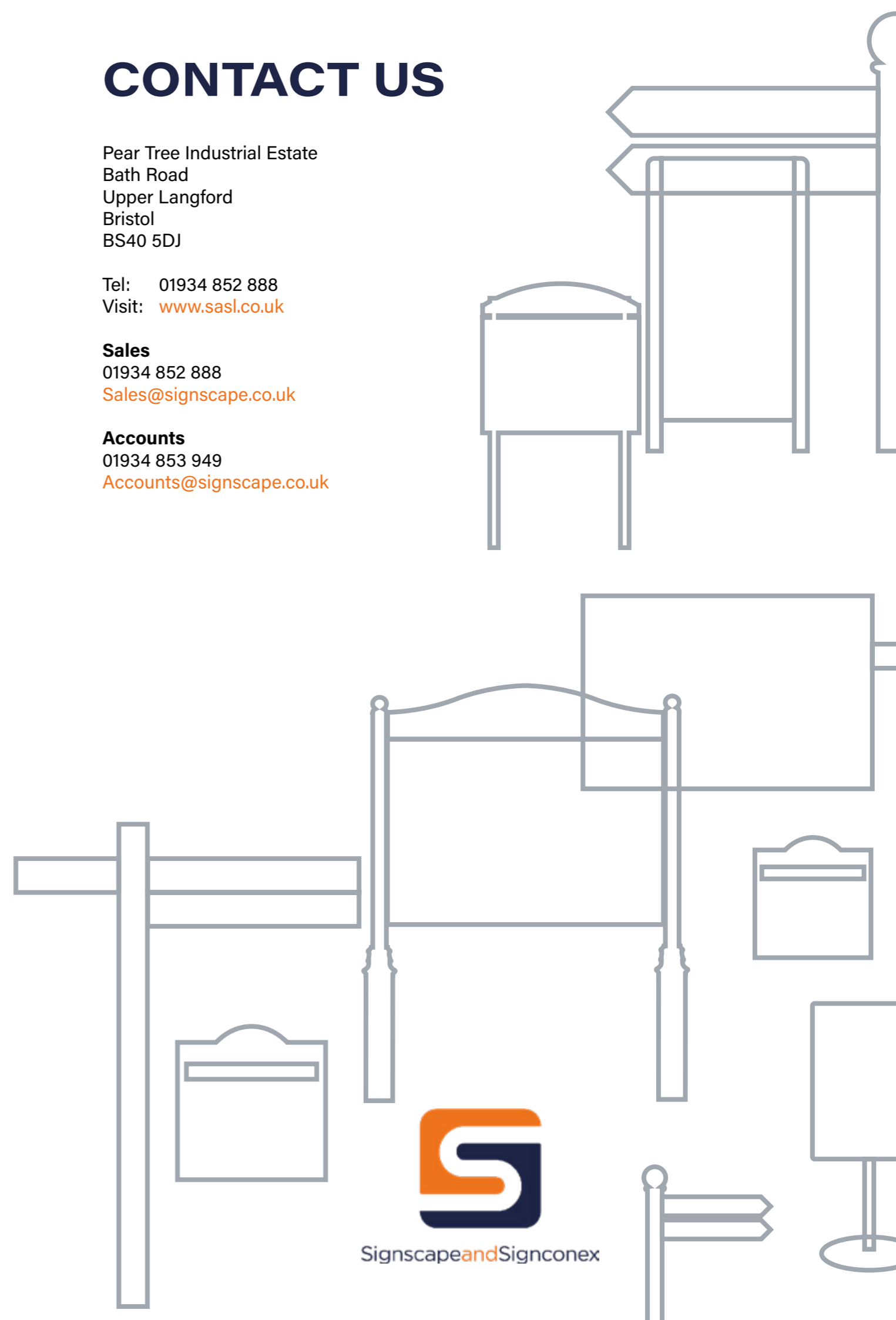

Signscape and Signconex

# ABOUT US

We are a leading trade manufacturer providing signage services in wayfinding sign systems, noticeboards, information display products and letterboards.

Based in Bristol, we have been serving happy customers all over the UK and internationally since 1973. We have the widest selection of products and specialise in tailoring bespoke signage to suit any location and project.

With over 45 years' in the industry, you can have confidence in our ability to design, manufacture and deliver your next project. We are passionate about helping customers find the best solution for their project and offer solutions appropriate for all applications. This catalogue represents all our product offerings for internal and external signage requirements.

Renowned for quality, style and durability, we specialise in tailoring our products to suit the image and requirements of wide variety of locations including:

- Education and Health Care Establishments
- Churches and Parish Councils
- Council and Local Authority Venues
- Offices and Corporate Environments
- Hospitality, Leisure and Retail Outlets
- Parks and Nature Reserves

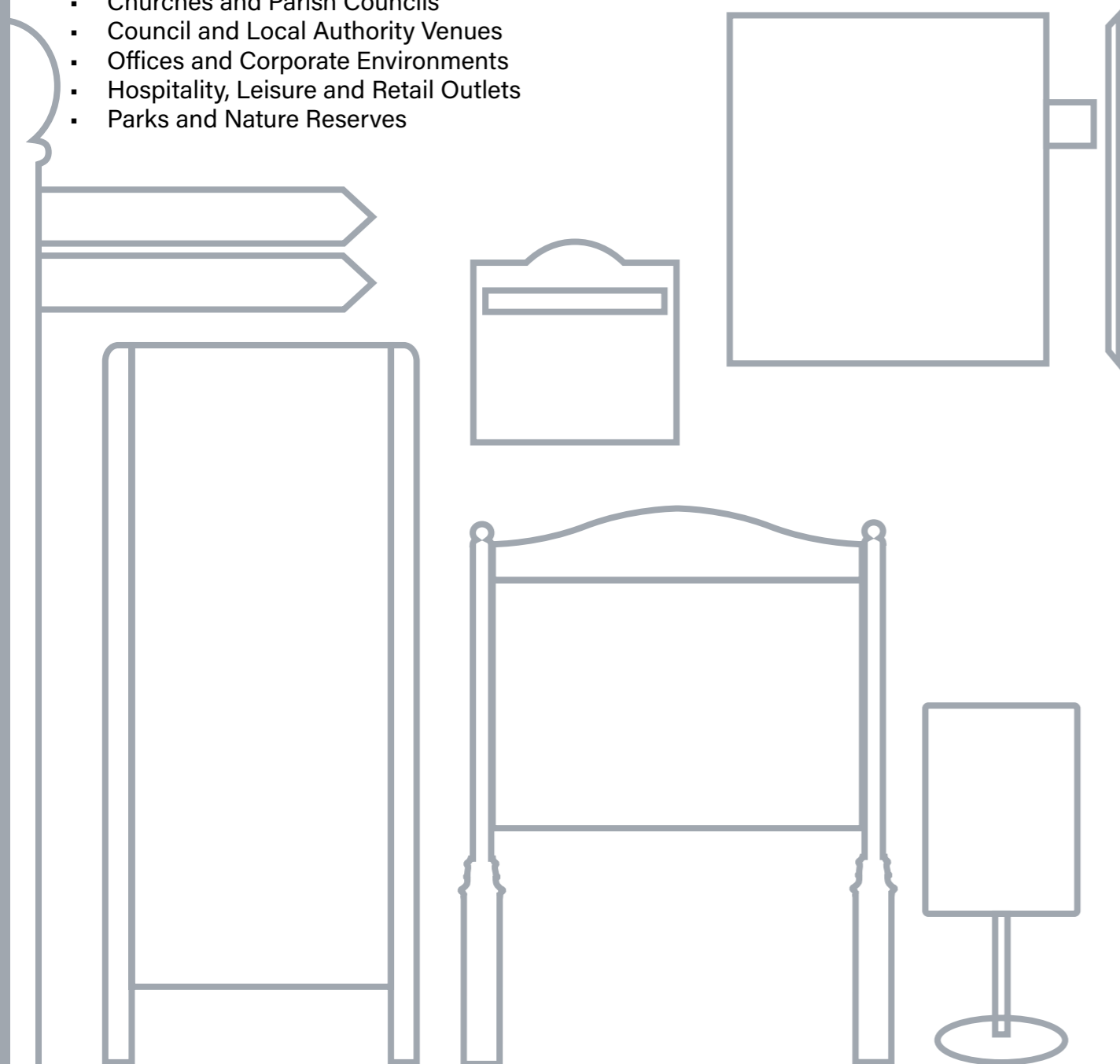

# CONTENTS

## WAYFINDING SIGN SYSTEMS 6-19

- INTERIOR - Changeable Directories: Signify and STAX-i  
- Paper Insert Signs: Papyrus
- EXTERIOR - Post and Panel: Modular and Custom  
- Totems: Infocurve and Infocurve-Mini  
- Directional Fingerposts: Waypoint and Heritage

## BESPOKE SIGNAGE 20-21

INTERIOR & EXTERIOR

## SOLAR DISPLAY SYSTEMS 22-23

EXTERIOR - Eco-Vision

## NOTICEBOARDS 24-33

- INTERIOR - Scroll Maitre'd Stand  
- Scroll Noticeboard
- EXTERIOR - Avenue: Poster Case, Sign Panel and Lectern  
- Lynester Noticeboard: Single and Double-Sided  
- Varicase Noticeboard

## OPENBOARDS 34-39

- INTERIOR - Pinboards  
- Whiteboards
- EXTERIOR - School Boards

## TECHNICAL GUIDE 40-45

- Master Swatch
- Accessories
- Guarantees
- Fire Ratings
- Whiteboard Cleaning Guide
- Delivery Options

# SIGNIFY

Signify is an ultra-slim, stylish and feature filled modular sign system. Specially designed for creating directional signs and wayfinding schemes in internal locations.

## KEY FEATURES:

- Modern and contemporary design
- Modular design
- Concealed locking mechanism
- Highly rigid construction
- Concealed fixings
- Easily add or subtract panels once installed
- Create a full internal wayfinding scheme
- 20-160mm panel heights
- Low profile 9mm depth
- Continuous aluminium end caps
- Panel and paper insert facility
- Braille and tactile compatible

## POPULAR USES:

- Meeting room directions
- Bathroom indicators
- Directories
- Internal wayfinding system

## IDEAL LOCATIONS:

- Hospitals
- Universities
- Corporate venues
- Hospitality venues

## Panel Sizes:

20, 40, 60, 80, 120 and 160mm height

\*Fabricated panels used for custom sizes

## Signify Formats:

- Wall mounted
- Projecting
- Suspended

## Locking Mechanism:

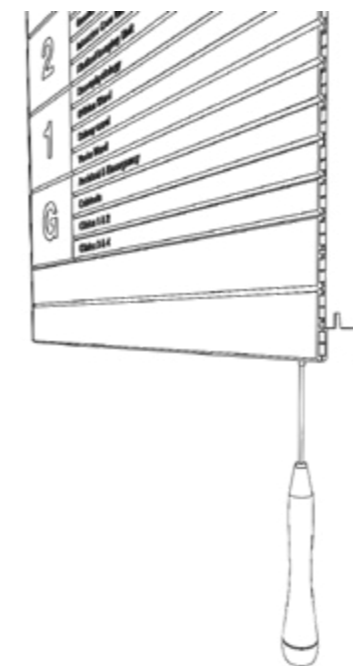

## Lock Features:

- Concealed locking fixing
- Tool supplied
- 4 no. Per assembly

## Popular Configurations:

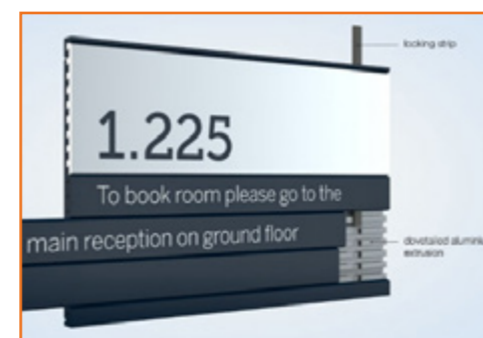
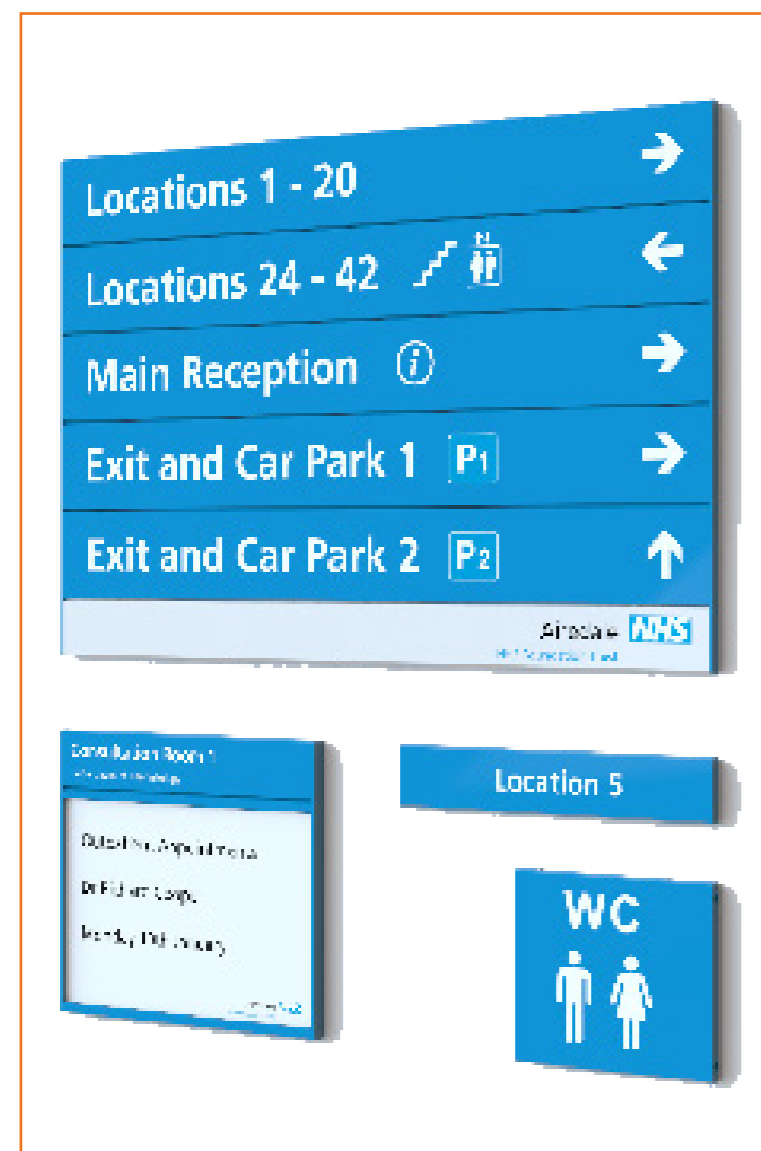

# STAX-i

STAX-i is an internal modular sign system packed with features and can produce a wide range of sign solutions.

**KEY FEATURES:**

- Panel locks with metal end caps
- Profile depth of 12mm
- Highly rigid construction
- Easily add or subtract panels once installed
- Create a full internal wayfinding scheme
- 25-150mm panel heights
- 12mm profile depth
- Plastic or continuous metal end cap options
- Panel and paper insert facility
- Braille and tactile compatible
- Pre-Drilled and Assembled with Fixings
- Vinyl Text Available

**POPULAR USES:**

- Desk, door and wall signs
- Slider style signs
- Combined face mode and slider sign
- Insert mode sign
- Face mode sign

**IDEAL LOCATIONS:**

- Local Authorities
- Public sector venues

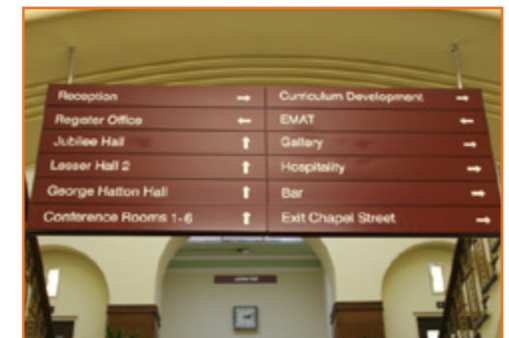
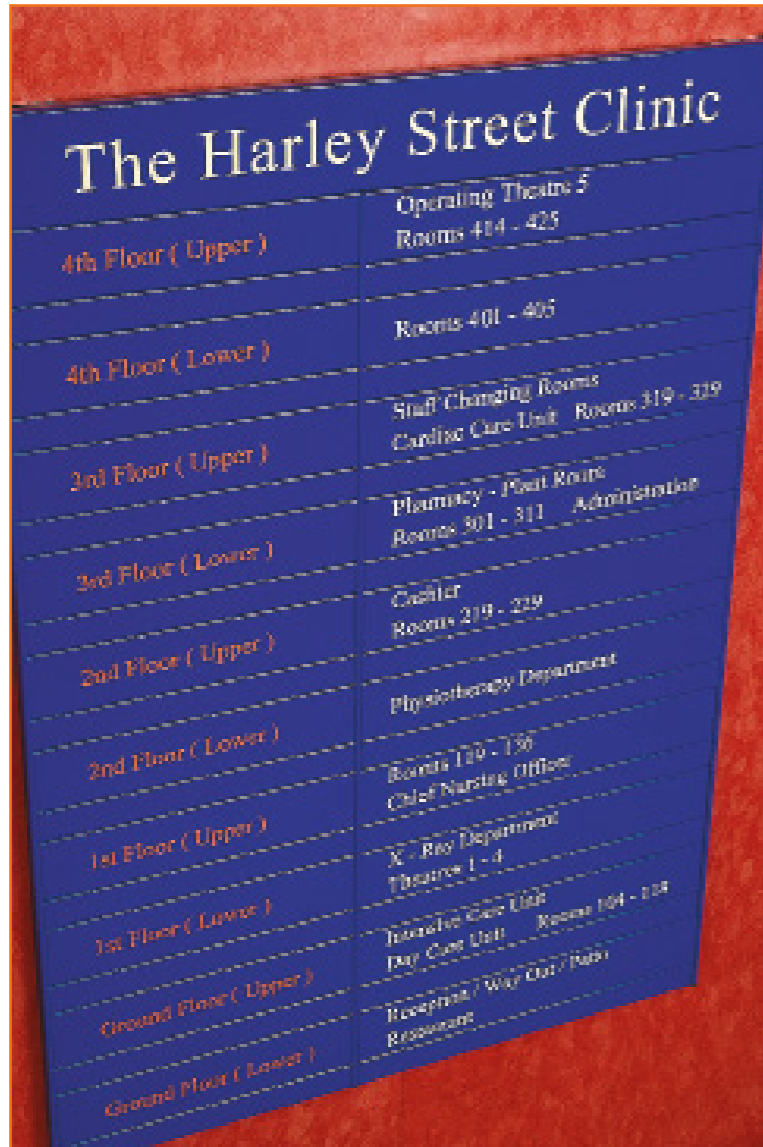

**Panel Sizes:**

25, 50, 75, 100 and 150mm height

\*Fabricated panels used for custom sizes

**STAX-i Formats:**

- Wall mounted
- Projecting
- Suspended

**Frame Finishes:**

- Satin silver
- Polished silver
- Polished gold
- Powder coated

We offer an in-house powder coating service that controls all quality. We use all paints that refer to either RAL or BS colour formats in conjunction with the manufacturers recommended pre-treatment procedures. The powder finishes vary from full gloss, satin and matt which are all suitable for exterior use.

**Overall Depth:**

12mm Single-Sided

**Inserts:**

Accepts up to 1.5mm thick

**Sign Assembly:**

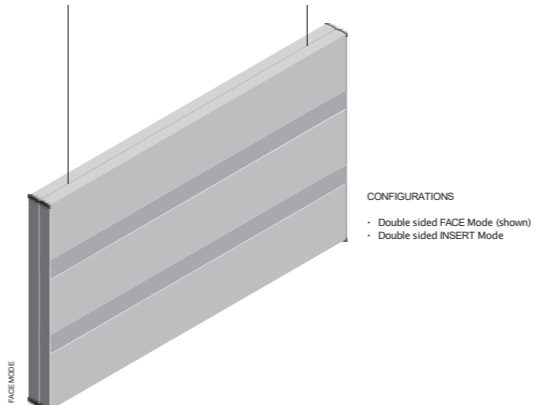

**Popular Configurations:**

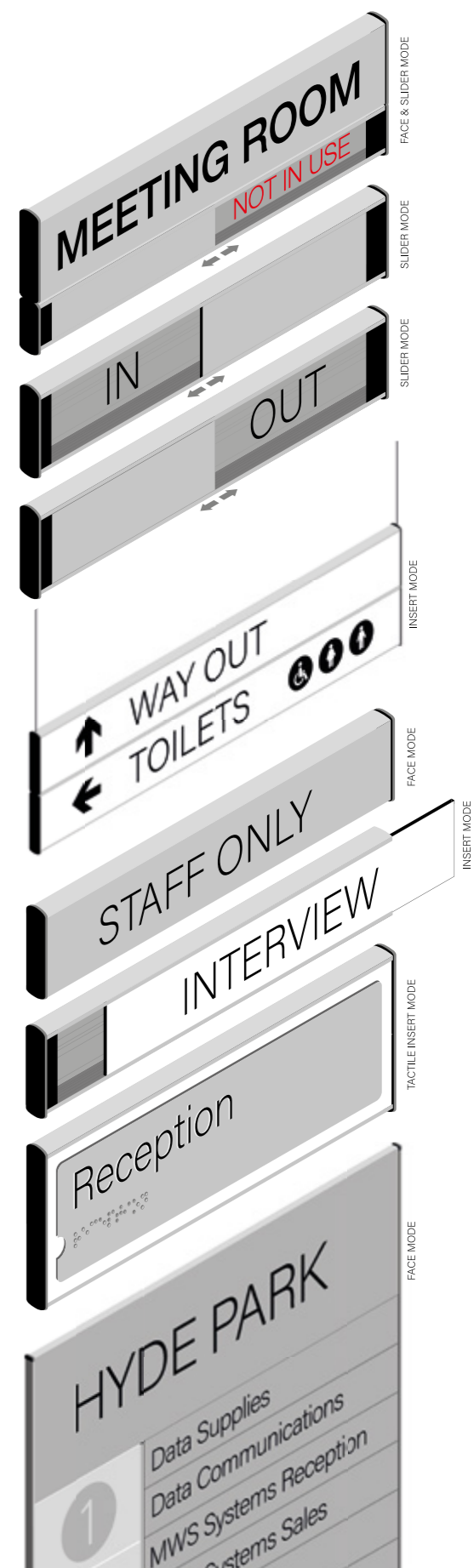



# POST AND PANEL

Our Post and Panel wayfinding system was one of the first in the UK. Our product remains the system of choice for many sign makers and wayfinding specialists.

## KEY FEATURES:

- Highly robust aluminium design
- Easy and quick to install
- Easily add or subtract panels once installed
- Double-sided as standard when post mounted
- Curved side tracks for wall mounted signs
- Create a full wayfinding scheme
- 100-300mm or custom panel heights
- 80mm D-shape, square or 90mm round posts
- Standard face mode or insert facility for graphics

## POPULAR USES:

- Entrance monoliths
- Directional signs
- Car park signs
- Projecting signs
- Suspended signs
- Lectern signs & Street nameplates
- Wall mounted directories

## IDEAL LOCATIONS:

- Outdoor wayfinding solution
- Hospitals
- Churches
- Local Authorities
- Schools

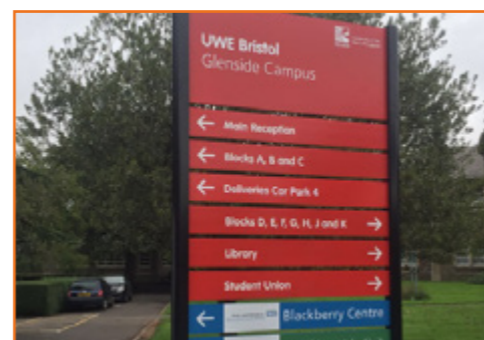

## Panel Sizes:

We can fabricate to any size, a variety of shaped top panels also available.

All panels are double sided, standard panel heights are 100, 150, 200, 250, and 300mm.

78mm thick flush panels available



## Specifications:

- Material: 6082T6 - 6063T6 Alloy
- Stock lengths: Up to 6000mm
- Stock Finish: Mill Finish
- Panel Thickness: 20mm

## Post Options:

D-shape Side Track (wall / rail mounting) 6 post types as shown below:

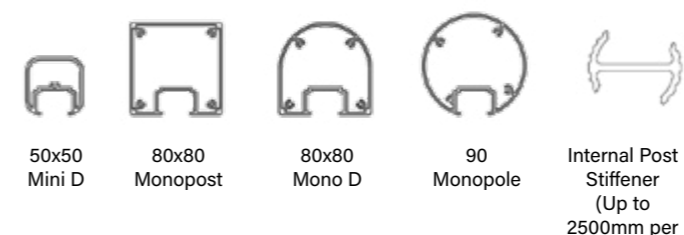

## Finial Options:

Cast aluminium, for 90 and 76mm Round Poles.

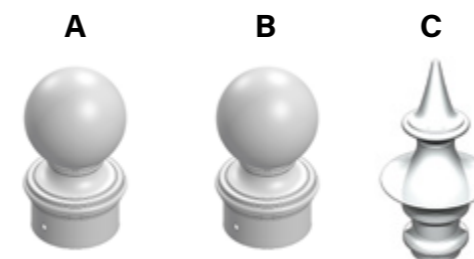

- A:** Ball Finial - Top Fixing (90mm Monopole only)
- B:** Ball Finial - External Fitting (76mm Poles only)
- C:** Pagoda Finial - External Fitting (76mm and 90mm poles)

## Popular Configurations:

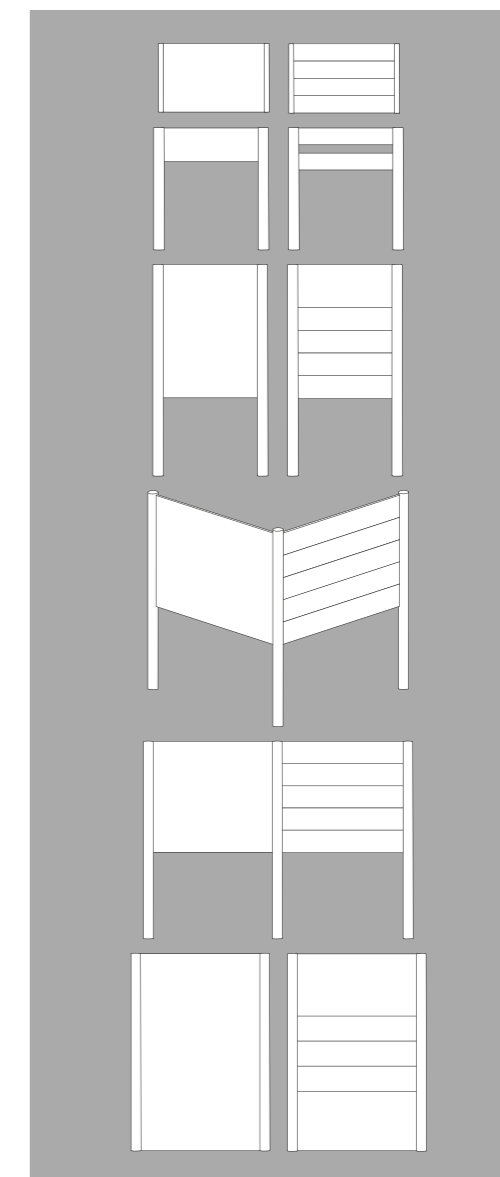

## Typical Post & Panel Sign Assembly:

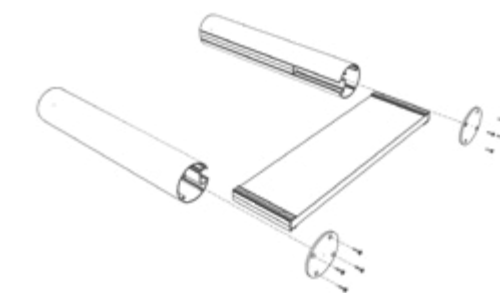

Most of the modular sign systems simply slide together prior to installation. The design of the sign systems allows for the ease of assembly with no additional specialist tool required.

Exposed mounting locations will require additional post strengthening which can be added to reinforce the sign assembly. These are also fitted within the internal cavity of the post design without the need for additional tools or modifications etc.

# INFOCURVE

Infocurve is an elegant, curved-faced, modular sign system that creates a broad range of sign solutions, for internal or external use.

## KEY FEATURES:

- A statement of excellence
- Easy install as no ground cage required
- User friendly interchangeable panels
- Double-sided is with post mounted
- Available in kit form or fully assembled
- Create a full wayfinding scheme
- Internal illumination available
- Seamless design
- Single or double-sided graphics

## POPULAR USES:

- Totem signs
- Wall mounted & free standing directories
- Projecting & suspended signs
- Post and Panel type signage.
- Entrance signs
- Valet signs

## IDEAL LOCATIONS:

- Hospitality venues
- Golf Estates
- Corporate venues
- Zoo's
- Theme parks



## Panel Sizes:

We can fabricate to any size, a variety of shaped top panels also available.

### Infocurve:

- 450mm-1500mm width
- Up to 5m above ground
- 20-160mm panels for creating curved directories

### Infocurve-mini:

- 100-400mm width
- Up to 6m above ground
- Several one-piece pre-cut metal panels create signs

78mm thick flush panels available Infocurve-

## Specifications:

- Material: 6082T6 - 6063T6 Alloy
- Stock lengths: Up to 6000mm
- Stock Finish: Mill Finish
- Panel Thickness: 20mm

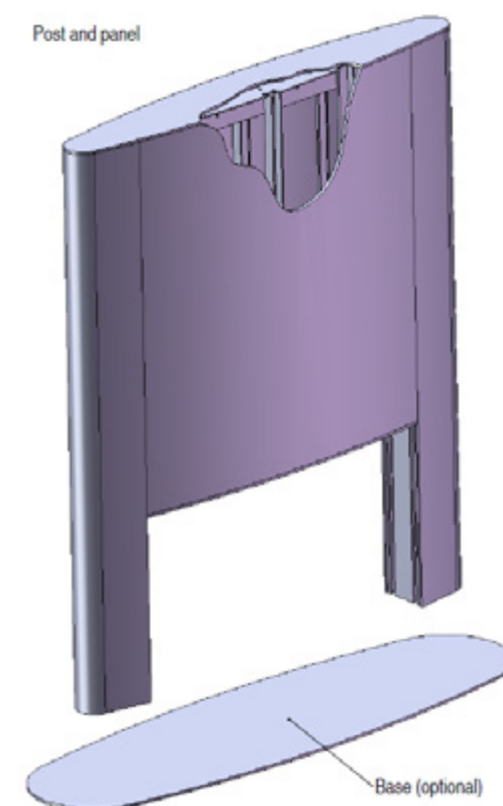

## Popular Configurations:





# WAYPOINT FINGERPOST

The modular Waypoint Fingerpost has a premium and contemporary style with a strong and highly robust design.

## KEY FEATURES:

- Modern and contemporary style
- Highly robust 20mm thick finger arms
- Rigid horizontal alignment of finger arms
- Seamless joints provide premium look
- Easily add or subtract arms once installed
- Modular aluminium design
- 8 mounting positions at every 45° per level
- Concealed locking mechanism
- 100mm round post
- Choice of finials available

## POPULAR USES:

- Directional sign
- Street sign

## IDEAL LOCATIONS:

- City centres
- Public venues



## Panel Sizes:

- 100mm x 20mm
- 150mm x 20mm
- 200mm x 20mm
- 250mm x 20mm
- 300mm x 20mm

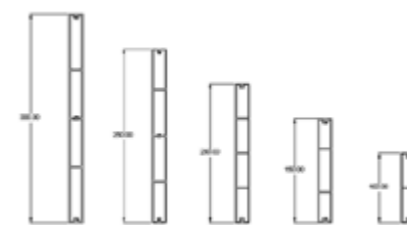

- Standard Length – 900mm x 20mm
- Standard End Style - Square Ended
- All panels are double sided
- Custom lengths and end styles available

## Finial Options:

- 50mm
- 100mm
- 150mm



## Mountings Positions:

- 8 mounting positions on one level
- 45 degree increments
- 2300mm surface level to underside of the lowest finger arm
- Extendible if required after installation
- Recommended Planting in ST.4 Concrete at 600mm minimum planting depth and with a standard base pin

## WayPoint Fingerpost Assembly:



## Popular Configurations:

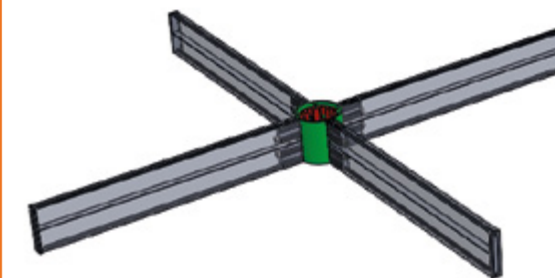

4 x Way Position Socket

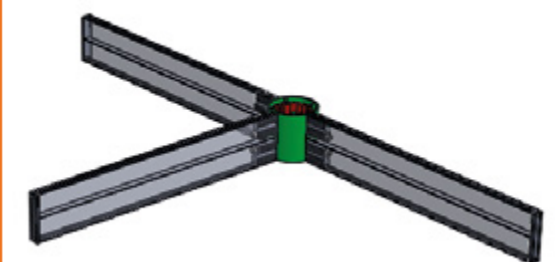

3 x Way Position Socket

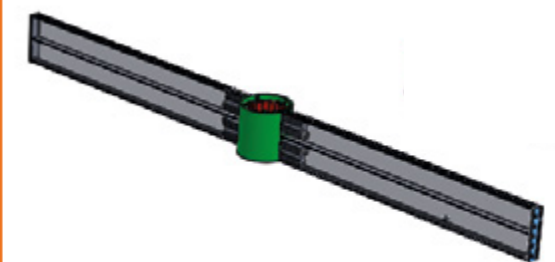

2 x Way Position Socket



1 x Way Position Socket

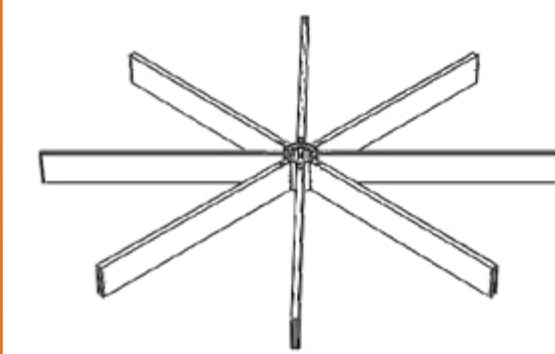

# HERITAGE FINGERPOST

Our Heritage Fingerpost system is more suited to outdoor and rural locations.

## KEY FEATURES:

- Premium traditional design
- Robust sockets and 16mm thick finger arms
- 1, 2 or 3-way sockets per level
- Rotate finger arms to any direction
- Easily add or subtract arms once installed
- Chevron, bull-nosed and square finger arms
- Modular aluminium design
- Round post or brackets for wall/square posts
- Wide range of finials and embellishments

## POPULAR USES:

- Directional sign
- Street sign

## IDEAL LOCATIONS:

- Outdoor and rural locations
- Churches
- Parks
- Historical venues



## Panel Options:

- All panels are double sided
- 120, 165, 200, 250 and 300mm panel heights
- 600-900 panel widths
- Fabricated panels are used for custom sizes

## Finger Arm Formats:

Choose from 3 finger arm styles  
Option of 1, 2 or 3 at any given height



## Specification:

- Single aluminium or steel mounting pole at 76mm
- Full aluminium system
- Three types of mounting swivel sockets
- 1, 2 or 3-way sockets per level
- Chevron, square and round end styles
- Adaptable if required after installation
- Decorative finials and post furniture
- Traditional ornate design

## Finials and Embellishments:

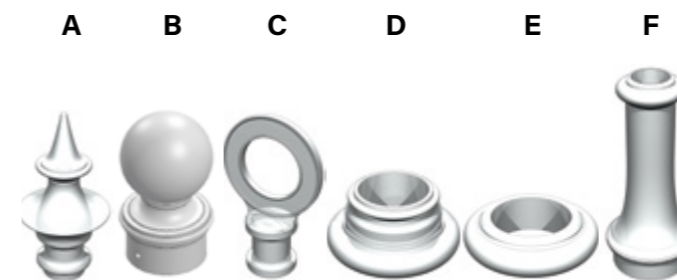

- A:** Pagoda Finial
  - B:** Ball Finial
  - C:** Hollow Ring Finial
  - D:** Flared Collar
  - E:** Plain Collar
  - F:** Base Embellishment
- (All suitable for the 76mm pole)

## Popular Styles:

### Chevron



### Bull Nosed



### Square

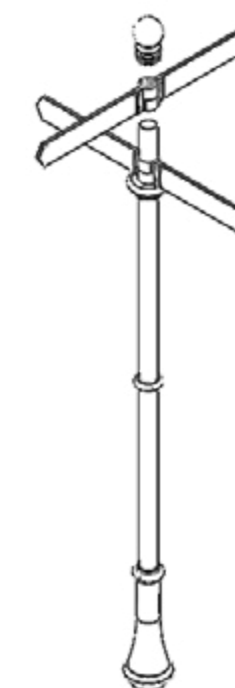

# BESPOKE SIGNAGE

With a vast range of sign systems created, we have a great deal of experience designing, producing, installing and maintaining all types of internal and external signs.

## KEY FEATURES:

- CAD design and render production
- Custom metal fabrication
- CNC routing
- Power coating and wet spray
- Vinyl
- UV flatbed and digital print
- Neon and LED lighting
- Perspex and acrylics

## POPULAR USES:

- Indoor signs
- Outdoor signs
- Custom designs
- Unique features
- Bespoke requests

## IDEAL LOCATIONS:

- Transport
- Retail
- Industrial & Commercial
- Leisure & Tourism
- Education & more



# SOLAR DISPLAY SYSTEMS

Eco-Vision products use the latest in solar cell technology to provide off-grid illumination within notice boards, poster cases, wayfinding displays and corporate signage.

## KEY FEATURES:

- 24hr visibility in any location
- Intelligent 'On-Demand' Lighting
- Top-lit or back-lit display area
- No need to route mains power
- Maintenance free illumination
- 50,000 hours use
- Environmentally friendly
- PV solar panels guaranteed for 25 years
- Key locks
- Integrated Audio Recordings
- Highly robust aluminium profiles
- Weather and vandal resistant
- Integrated weather shield
- Smooth continuous hinges

## POPULAR USES:

- Directional sign
- Information sign
- Map interpretation
- Dusk and evening lighting through solar

## IDEAL LOCATIONS:

- Town centres & Parks
- Cycle and coastal paths
- Golf and hotel driveways
- Remote car parks & Train station platforms
- Busy high streets & Pedestrianised areas

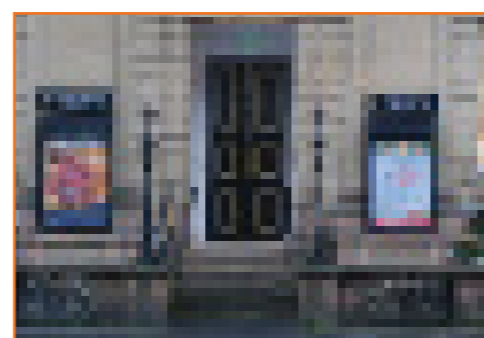
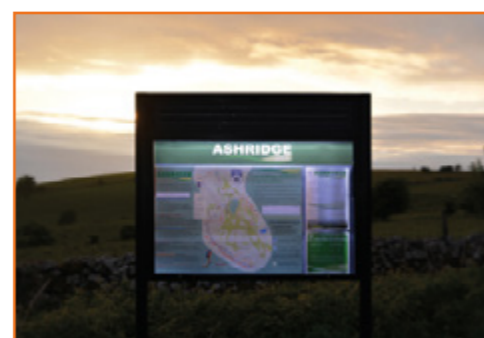

## Display Area:

624mm x 890mm	-A1P/A1L
890mm x 1238mm	-A0P/A0L
2 x 455mm x 624mm	-A2P x2
2 x 624mm x 890mm	-A1P x2
3 x 455mm x 624mm	-A2P x3

## Eco-Vision Formats:

- Single & Double Door Wall & Post
- Noticeboard
- Totem

## Optional Extras:

- Thumb locks
- Gas struts if top hinged door
- 90mm round or 80mm square posts
- Monopole "ball" post finials - for Round posts only
- Ornate posts includes ball finials & embellishments
- External ARC, ABL, CRD header panel
- Flat external header or footer panel
- Internal back-lit, printed header, 100mm high
- Internal back-lit, fret cut vinyl header, 100mm high
- Vinyl text on glazing or external header
- Printed logo or digital print on glazing or external header

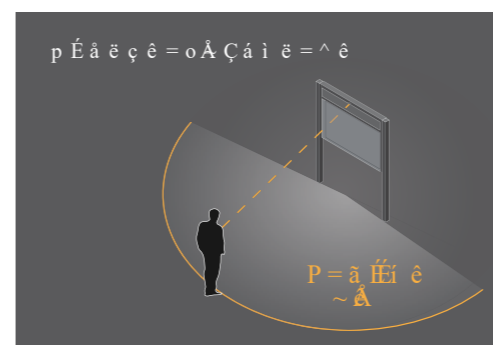

## Insert Options:

- Premium Felt
- Brushed loop nylon
- Tricord
- Coloured magnetic whiteboard

## Frame Finishes:

- Textured silver
- Antique bronze
- Antique pewter
- Standard powder coated colours

## Specification Detail:

Frame: 6063T6 & 6082T6 grade aluminium  
 Glazing: 4mm hi-impact acrylic  
 Gas struts: included on A0L  
 Core: magnetic panel or 8mm pinboard  
 Guarantee: solar cells have 25 year life  
 Insert to Glazing: s/sided 95mm boards, d/sided & monolith style 150mm boards  
 Fire Rating: Exterior surfaces to BS-476 Class 1  
 Locks: Integrated proprietary locks with 2 keys  
 Illumination: LED top illumination as standard, edge-lit LED illumination (back-lit effect) on request  
 Posts, Finials & Headers: 80 x 80 x 3000mm D-shape posts match the frame finish as standard. 90mm round, 80mm square or 90mm ornate post option.  
 Back Panel: magnetic panels have powder coated zintec, other inserts have powder coated aluminium back, wall mounted has mill finish aluminium

# SCROLL MAITRE'D STAND

The Scroll Maitre'd Stand is an elegant and professional free standing display solution.

## KEY FEATURES:

- Stylish curved frame and pole design
- Soft felt covered top surface
- Includes 75mm high message plate
- Prestigious polished frame finishes
- Mains powered LED illumination option
- Lightweight yet sturdy 1.1m stand
- Optional lockable, glazed cover

## POPULAR USES:

- Menu stand
- Table reservation book stand
- Visitor comments book stand

## IDEAL LOCATIONS:

- Compliments hospitality venues
- Cafés
- Bars
- Restaurants
- Conference centres



## Stand Size:

- Display area: A3L
- Overall size: 496(w) x 390(h)mm
- Top area: 496(w) x 390(h)mm
- Height from floor: 1155(h)mm

## Frame Finishes:

- Polished gold
- Polished silver
- Antique bronze
- Antique pewter
- Textured silver
- Satin silver
- Standard powder coated colours

## Message Plate:

- 75mm message plate
- Text of your choice
- 100-150mm high versions available
- Additional pre-lettered inserts available

## General Information:

For technical specifications please see the below pages.

- |                   |                         |                         |                         |
|-------------------|-------------------------|-------------------------|-------------------------|
| ▪ Master Swatches | - <a href="#">pg 40</a> | ▪ Fire Ratings          | - <a href="#">pg 41</a> |
| ▪ Accessories     | - <a href="#">pg 42</a> | ▪ Whiteboard Care Guide | - <a href="#">pg 43</a> |
| ▪ Guarantees      | - <a href="#">pg 44</a> | ▪ Delivery Options      | - <a href="#">pg 45</a> |

## Stand Formats:

- Single door stand

## Insert Options:

- Premium felt
- Red
- Green
- Burgundy
- Black
- Silver Grey
- Blue
- Beige

## Optional Extras:

- Mains powered LED illumination
- Window Hanging Kit
- Internal Header with Vinyl Text
- Internal Header with Printed Logo
- Extra 75mm Height for Header area
- Lockable, glazed cover

# SCROLL NOTICEBOARD

The Scrolls' unique curved top and bottom frame provides an elegance not found in other noticeboards and has a wide range of tailoring options.

## KEY FEATURES:

- Stylish curved frame
- Superior weather and vandal resistance
- Variety of panel inserts
- Optional LED illumination
- Robust 80mm deep frame
- Unbreakable 4mm glazing
- Retracting, concealed key locks
- Top hinged door
- Header options with graphics
- 1.1m and 1.8m stand optional

## POPULAR USES:

- Noticeboards
- Map interpretation
- Timetables
- Event posters
- Community notices

## IDEAL LOCATIONS:

- Indoor application
- Education venues
- Hospitality
- Conference venues
- Corporates

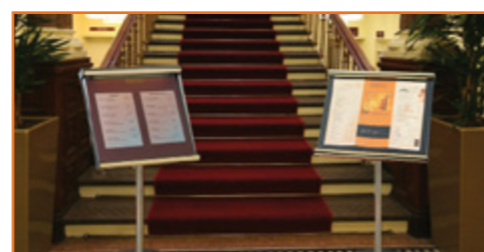
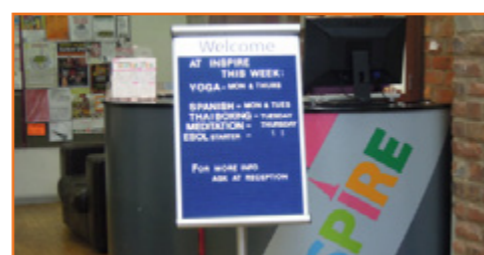
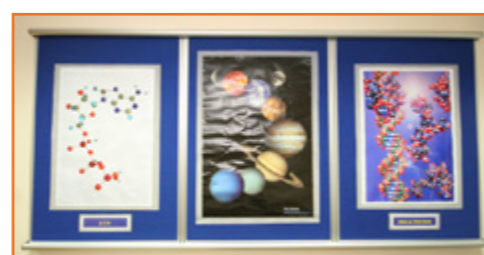

Display Area:		670mm x 624mm	-6xA4P
		624mm x 890mm	-A1P
230mm x 317mm	-A4P	890mm x 624mm	-A1L
317mm x 230mm	-A4L	670mm x 931mm	-9xA4P
252mm x 624mm	-2x A4P	890mm x 931mm	-12xA4P
317mm x 450mm	-A3P	890mm x 1238mm	-A0P
450mm x 317mm	-A3L	1238mm x 890mm	-A0L
670mm x 317mm	-3x A4P	1110mm x 931mm	-15xA4P
800mm x 317mm	-4x A4P	1330mm x 931mm	-18xA4P
450mm x 624mm	-A2P	1465mm x 1165mm	-1512
624mm x 450mm	-A2L	1765mm x 1165mm	-1812

## Frame Finishes:

- Polished gold
- Polished silver
- Antique bronze
- Antique pewter
- Textured silver
- Satin silver
- Standard powder coated colours

## Optional Extras:

- Internal header with graphics or branding
- LED illumination (Mains)
- 100% groove letterboard insert
- 50% pinboard and 50% groove letterboard insert
- Galvanised steel back panel
- Coloured zintec back & sub-frame
- Internal header plate - 75mm - 150mm height or extra 75mm on top of this
- Vinyl text on glazing or header
- Printed logo or digital print on glazing or header

## Specification Detail:

- Frame: 6063T6 grade aluminium
- Glazing: 4mm polycarbonate glazing
- Core: 12mm premium pinboard
- Locks: Integrated lock with 2 keys
- Depth: 80mm overall, 30mm insert to glazing
- Fire Rating: Exterior surfaces to BS-476 Class 1
- Clearance: 70mm above
- Wall Mounted Back Panel: Black fluted PP as standard, galvanised steel is optional
- Illumination: Low voltage LED

illumination wired for UK mains, 3m cable supplied as standard

- Wall Mounted: Case is pre-drilled, ready to install as standard
- Stand Mounted Core: 6mm pinboard
- Stand Mounted: Either 1.1m to centre at 15° or 1.8m to top at 90°, pole is coloured to match frame finish as standard
- Stand Mounted: Base is scratch resistant antique pewter as standard, except for polished gold which has antique bronze - 495mm - 650mm diameter
- Stand Mounted Back Panel: Dark brown stained wood as standard

## General Information:

For technical specifications please see the below pages.

- Master Swatches - [pg 40](#)
- Accessories - [pg 42](#)
- Guarantees - [pg 44](#)
- Fire Ratings - [pg 41](#)
- Whiteboard Care Guide - [pg 43](#)
- Delivery Options - [pg 45](#)

## Scroll Formats:

- Single door wall
- Multi-bank wall
- Single door stand

\*Stand has limited size and layout options

## Insert Options:

- Premium felt pinboard
- Brushed loop nylon pinboard
- Tricord pinboard
- Cork pinboard
- Dry-wipe whiteboard
- Coloured magnetic whiteboard
- Felt groove letterboard

# AVENUE RANGE

The Avenue range offers a robust yet highly affordable method of poster display.

## KEY FEATURES:

- Slender 40mm deep profile
- Lightweight and easy to install
- Mitred corner design
- Security Allen key locks
- Left, right or top concealed hinges
- 2mm hi-impact acrylic glazing
- Pre-drilled holes on wall mounted
- Superior weather resistance
- Single or multiple poster display formats
- Shaped header and sign panel options
- Magnetic panel insert or honeycombed corrugated plastic insert option

## POPULAR USES:

- Noticeboards
- Map interpretation
- Timetables
- Event posters
- Community notices

## IDEAL LOCATIONS:

- Outdoor applications
- Churches
- Schools
- Councils
- Public sector buildings

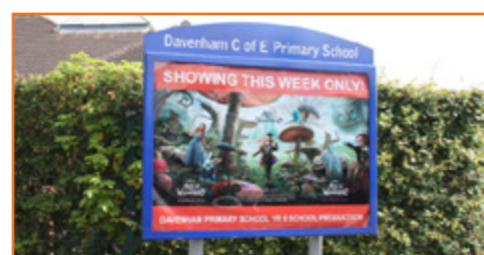

## Display Area:

210mm x 297mm	-A4P/A4L
297mm x 420mm	-A3P/A3L
420mm x 594mm	-A2P/A2L
508mm x 762mm	-2030P/2030L
594mm x 841mm	-A1P/A1L
762mm x 1016mm	-3040P/3040L
635mm x 1016mm	-DRP/DRL
841mm x 1189mm	-A0P/A0L
1016mm x 1524mm	-4060P/4060L
1200mm x 1800mm	-6-SheetP/6-SheetL

## Sign Panel:

The Avenue Sign Panel combines our external poster case with a powder coated aluminium backing panel.

## Lectern:

- Sizes: A2L, A1L and A0L
- Steel Posts: 80mm square
- Comes with self-supporting door stays

## Specification Detail:

- Frame: 6063T6 grade aluminium
- Glazing: 2mm hi-impact acrylic
- Locks: Security Allen key
- Back Panel: Powder coated zintec
- Fire Rating: BS-476 Class 1
- Insert: Magnetic, pinboard or fluted PP
- Poster Clips: Included with fluted PP
- Posts Spec: 76-89mm aluminium pole pair. All poles supplied at 3000mm and match frame finish as standard. Poles are rear mounted via channel and clips.

## General Information:

For technical specifications please see the below pages.

- |                   |                         |                         |                         |
|-------------------|-------------------------|-------------------------|-------------------------|
| • Master Swatches | - <a href="#">pg 40</a> | • Fire Ratings          | - <a href="#">pg 41</a> |
| • Accessories     | - <a href="#">pg 42</a> | • Whiteboard Care Guide | - <a href="#">pg 43</a> |
| • Guarantees      | - <a href="#">pg 44</a> | • Delivery Options      | - <a href="#">pg 45</a> |

## Avenue Formats:

- Poster Case: single door wall, post & rail mounted
- Sign Panel: single door wall, post & rail mounted
- Lectern: post mounted

## Frame Finishes:

- Textured silver
- Antique bronze
- Antique pewter
- Standard powder coated colours

## Insert Options:

- Magnetic panel
- Pinboard
- Fluted PP (corrugated plastic)

\*Inserts come in same colour as standard

## Optional Extras:

- Ball finials
- Front facing locks
- Insert face different colour to frame
- Anti-graffiti film
- Flat or arc header panel (post/rail only)
- Anti-rotational clips
- Self supporting door stays
- Front facing instead of side facing locks
- Posts different colour to frame
- Steel surface mounting base plate
- Vinyl text, printed logo or digital print

# LYNESTER NOTICEBOARD

Our most prestigious noticeboard, the Lynester, has radius profile edges for a modern look and comes with many extra benefits.

## KEY FEATURES:

- Prestigious curved edge profile
- Smooth continuous hinges
- Eco-Vision Solar powered version
- Ornate posts include finial and embellishments for classic look
- Choice of 50mm or 95mm deep
- Double-sided 150mm depth
- Double-sided display in a single unit
- Superior weather resistance
- Robust key locking doors
- Air ducts to minimise condensation
- Coloured aluminium posts as standard
- Back-lit or shaped header panels
- Standard and custom sizes available

## POPULAR USES:

- Noticeboards
- Map interpretation
- Timetables
- Event posters
- Community notices

## IDEAL LOCATIONS:

- Outdoor applications
- Churches
- Schools
- Councils
- Public sector buildings



## Display Area:

450mm x 624mm	-A2P	1395mm x 1089mm	-1512L
624mm x 450mm	-A2L	1089mm x 1695mm	-1218P
670mm x 624mm	-6x A4P	1695mm x 1089mm	-1812L
624mm x 890mm	-A1P	2 x 317mm x 450mm	-A3Px2
890mm x 624mm	-A1L	2 x 450mm x 624mm	-A2Px2
670mm x 931mm	-9x A4P	2 x 670mm x 624mm	-6xA4Px2
890mm x 931mm	-12x A4P	2 x 624mm x 890mm	-A1Px2
890mm x 1238mm	-A0P	2 x 670mm x 931mm	-9xA4Px2
1238mm x 890mm	-A0L	2 x 890mm x 931mm	-12xA4Px2
1110mm x 931mm	-15x A4P	2 x 890mm x 1238mm	-A0Px2
1330mm x 931mm	-18x A4P		
1089mm x 1395mm	-1215P	3 x 569mm x 895mm	-2010

## Lynester Formats:

- Single, Double, Triple or Double-Sided door
- Wall, post or rail mounted

## Frame Finishes:

- Textured silver
- Antique bronze
- Antique pewter
- Standard powder coated colours

## Specification Detail:

- Frame: 6063T6 & 6082T6 grade aluminium
- Glazing: 4mm hi-impact acrylic
- Core: 10mm magnetic panel or 8-12mm Pinboard
- Depths: 25mm insert to glazing on 50mm version and 54mm on 95mm version, 71(w) mm and 65(h)mm extra pinboard display behind doors
- Fire Rating: Exterior surfaces to BS-476 Class 1
- Locks: Integrated proprietary locks with 2 keys
- Posts Supplied: 80 x 80 x 3000mm D-shape posts match the frame finish as standard, 80mm square, 90mm round or 90mm ornate options, post embellishment is 550mm high
- Back Panels: Coloured magnetic panels have powder coated zintec, all other inserts have powder coated aluminium except wall mounted - mill finish
- Illumination: Mains powered LED top illumination of the pinboard or LED back illuminated box header, 3m cable supplied as standard

## Insert Options:

- Premium Felt
- Brushed loop nylon
- Tricord
- Cork
- Magnetic whiteboard
- Dry-wipe whiteboard
- Coloured magnetic whiteboard

## Optional Extras:

- 90mm round or 80mm square posts
- Thumb locks instead of key locks
- Gas struts (top hinged door)
- Monopole "ball" post finials - Round posts only
- Ornate posts include ball finials & embellishments
- Optional mains LED illumination
- Integrated box header
- ARC, ABL, CRD external header panel
- Flat external header or footer panel
- Vinyl text on glazing or header
- Printed logo or digital print on glazing or header

## General Information:

For technical specifications please see the below pages.

- |                   |                         |                         |                         |
|-------------------|-------------------------|-------------------------|-------------------------|
| • Master Swatches | - <a href="#">pg 40</a> | • Fire Ratings          | - <a href="#">pg 41</a> |
| • Accessories     | - <a href="#">pg 42</a> | • Whiteboard Care Guide | - <a href="#">pg 43</a> |
| • Guarantees      | - <a href="#">pg 44</a> | • Delivery Options      | - <a href="#">pg 45</a> |



# VARICASE NOTICEBOARD

Varicase is a premium noticeboard with square edged profiles offering a clean, traditional look.

## KEY FEATURES:

- Traditional square edged design
- Impact resistant 4mm glazing
- Superior weather and vandal resistance
- Robust key locking door
- Smooth continuous hinge
- Air ducts to minimise condensation
- External and internal header options
- Standard and custom sizes available
- Aluminium black posts as standard
- 50mm frame depth
- Side or top hinged doors and mitred corners

## POPULAR USES:

- Noticeboards
- Map interpretation
- Timetables
- Event posters
- Community notices

## IDEAL LOCATIONS:

- Outdoor applications
- Churches
- Schools
- Councils
- Public sector buildings



## Display Area:

450mm x 624mm	-A2P	2 x 317mm x 450mm -A3Px2
624mm x 450mm	-A2L	2 x 450mm x 624mm-A2Px2
670mm x 624mm	-6x A4P	2 x 670mm x 624mm-6xA4Px2
624mm x 890mm	-A1P	2 x 624mm x 890mm-A1Px2
890mm x 624mm	-A1L	2 x 670mm x 931mm -9xA4Px2
670mm x 931mm	-9x A4P	2 x 890mm x 931mm-12xA4Px2
890mm x 931mm	-12x A4P	2 x 890mm x 1238mm-A0Px2
890mm x 1238mm	-A0P	
1238mm x 890mm	-A0L	3 x 569mm x 895mm-2010

## Varicase Formats:

- Single, Double, Triple or Double-Sided door
- Wall, post or rail mounted

## Frame Finishes:

- Satin Silver
- Textured silver
- Antique bronze
- Antique pewter
- Standard powder coated colours

## Insert Options:

- Premium Felt
- Brushed loop nylon
- Tricord
- Cork
- Magnetic whiteboard
- Dry-wipe whiteboard
- Coloured magnetic whiteboard
- Felt groove letterboard

## Specification Detail:

- Frame: 6060T6 grade aluminium
- Glazing: 4mm hi-impact acrylic
- Core: Magnetic panel or 8mm pinboard
- Depth: 50mm overall
- Internal Depth: 25mm pinboard insert to glazing
- Fire Rating: Exterior surfaces to BS-476 Class 1
- Locks: Integrated proprietary locks with 2 keys
- Wall Mounted: Case not pre-drilled as standard, 40mm extra Pinboard display behind door
- Illumination: Not available
- Back Panel: Coloured magnetic panels have powder coated zintec, all other inserts have mill finish(wall) and PC finish (post) aluminium
- Posts Supplied: 80mm square, 3000mm aluminium posts, powder coated black as standard, alternative colours available, posts are side mounted as standard, 3500mm optional

## Optional Extras:

- Groove letterboard
- Thumb locks instead of key locks
- Steel self-supporting stays - if you specify a top hinged door
- Different colour posts
- Steel surface mounting base plates
- Coloured aluminium back panel
- ARC, ABL, CRD external header panel
- Flat external header and/or footer panel
- Internal header plate - 75(h)mm - 150(h)mm, add extra 75(h)mm
- Vinyl text on glazing or header
- Printed logo or digital print on glazing or header

## General Information:

For technical specifications please see the below pages.

- |                   |                         |                         |                         |
|-------------------|-------------------------|-------------------------|-------------------------|
| • Master Swatches | - <a href="#">pg 40</a> | • Fire Ratings          | - <a href="#">pg 41</a> |
| • Accessories     | - <a href="#">pg 42</a> | • Whiteboard Care Guide | - <a href="#">pg 43</a> |
| • Guarantees      | - <a href="#">pg 44</a> | • Delivery Options      | - <a href="#">pg 45</a> |

# PINBOARDS

We offer a range of pinboards to suit internal locations for a host of applications.

## PINBOARD OPTIONS:

- Flat Frame Pinboard with top and side header plates and custom printed graphics.
- Unframed Pinboards are sleek and stylish pinboards, perfect for use in a variety of settings, from office, to education and hospitality.
- Our Hidden Frame Pinboard offers an ultra modern, sleek look to suit any venue.
- Solid Oak Framed Pinboards offer a more traditional style, complimenting prestigious locations.

## POPULAR USES:

- Notices
- Timetables
- Event posters
- Project tracking
- Bulletins
- Photo gallery
- Letterboards

## IDEAL LOCATIONS:

- Churches
- Schools
- Councils
- Retail spaces

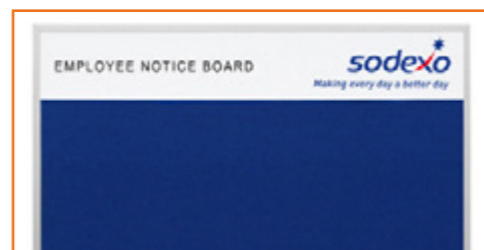
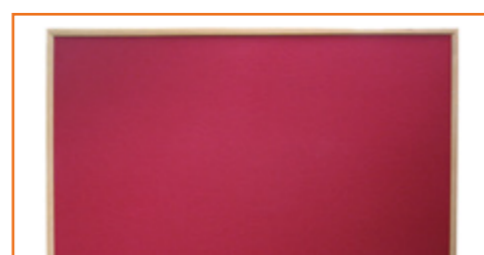
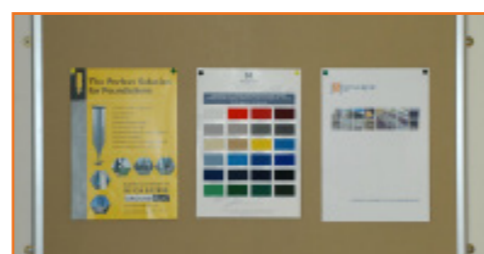

## Display Area:

- 600mm x 450mm
- 900mm x 600mm
- 1200mm x 900mm
- 1200mm x 1200mm
- 1500mm x 1200mm
- 1800mm x 1200mm
- 2400mm x 1200mm

## Key Features:

- Flat Frame:
- Square frame profile with 20mm face and 16mm depth
  - Premium 10-12mm core
  - Corner cap free design
  - Choice of header plates and graphics
  - Come complete with wall fixings
  - Over 100 frame and colour combinations
  - Unframed pinboard has felt wrapped around all edges, 50 options to choose

## Frame Finishes:

- Premium varnished Solid Oak frame
- Antique bronze
- Antique pewter
- Textured silver
- Satin silver
- Standard powder coated colours

## General Information:

For technical specifications please see the below pages.

- |                   |                         |                         |                         |
|-------------------|-------------------------|-------------------------|-------------------------|
| • Master Swatches | - <a href="#">pg 40</a> | • Fire Ratings          | - <a href="#">pg 41</a> |
| • Accessories     | - <a href="#">pg 42</a> | • Whiteboard Care Guide | - <a href="#">pg 43</a> |
| • Guarantees      | - <a href="#">pg 44</a> | • Delivery Options      | - <a href="#">pg 45</a> |

## Pinboard Formats:

- Flat Framed
- Unframed
- Hidden Framed
- Solid Oak Framed

## Insert Options:

- Standard felt
- Premium felt
- Brushed loop nylon
- Tricord
- Cork

## Optional Extras:

- Acrylic business card holders
- Perspex document pockets for storage
- 50% pinboard 50% whiteboard
- Non-magnetic dry-wipe whiteboard with semi-matt finish
- Magnetic dry-wipe whiteboard with high gloss finish
- Hidden rear 'keyhole' fixings available
- Standard or custom sizes available
- Unframed boards are fixed through face as standard (not supplied pre-drilled)
- Header plates and graphics available
- White PVC header plate
- Silver, gold or powder coated header plate
- Vinyl text on header plate
- Printed logo on header plate

# WHITEBOARDS

We offer a range of whiteboards to suit internal locations for a host of applications.

## WHITEBOARD OPTIONS:

- Flat Frame Whiteboard with top and side header plates and custom printed graphics.
- Custom Whiteboards are perfect for use in a variety of settings where permanent information or branding is required.
- Our Hidden Frame Whiteboard offers an ultra modern, sleek look to suit any venue.
- Solid Oak Framed Whiteboards offer a more traditional style, complimenting prestigious locations.

## POPULAR USES:

- Sales targets
- Health and safety
- Medical boards
- Classroom boards
- Planning boards
- Status boards
- Playtime boards

## IDEAL LOCATIONS:

- Churches
- Schools
- Councils
- Retail spaces

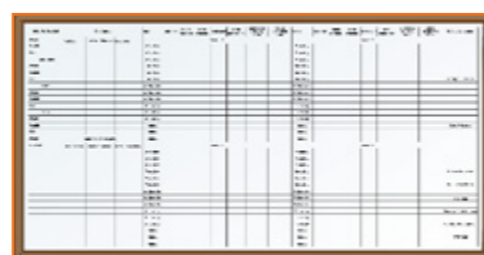
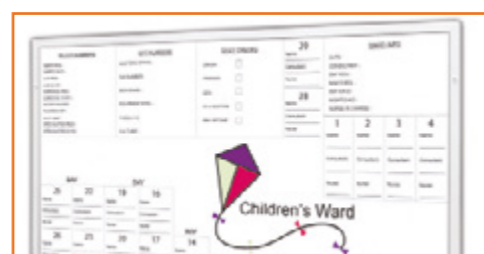
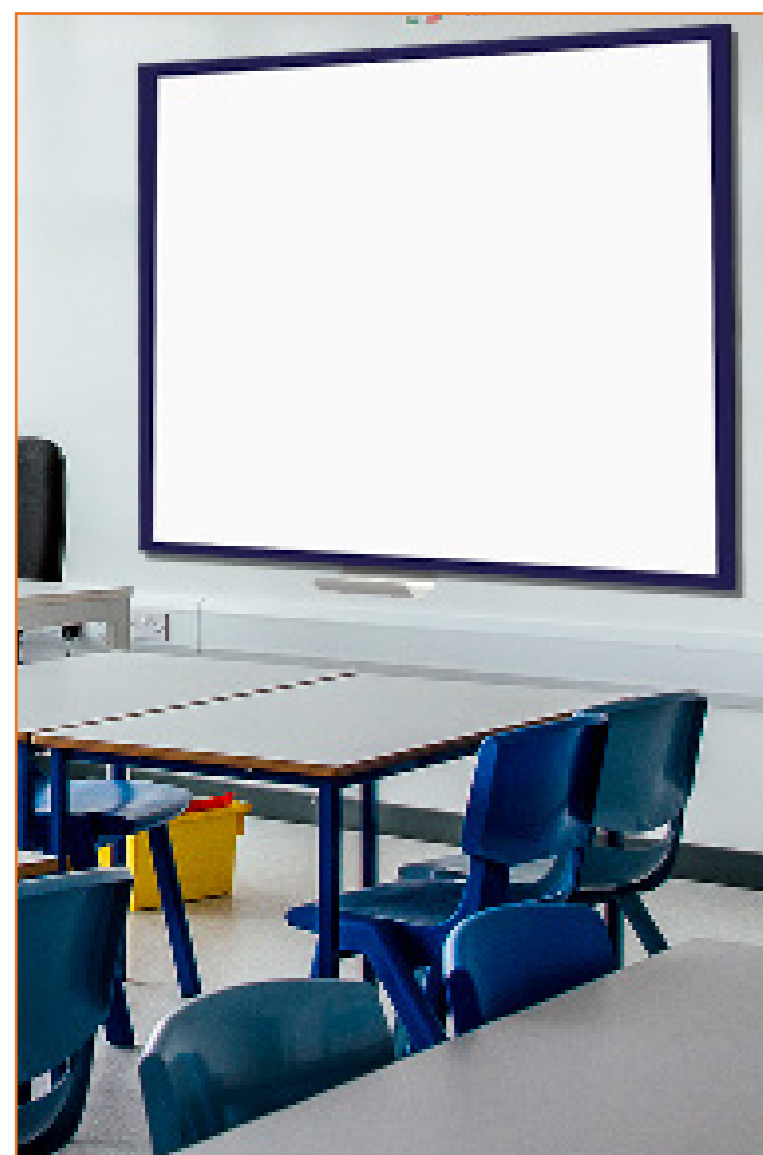

## Display Area:

- 600mm x 450mm
- 900mm x 600mm
- 1200mm x 900mm
- 1200mm x 1200mm
- 1500mm x 1200mm
- 1800mm x 1200mm
- 2400mm x 1200mm

## Key Features:

- Premium long-lasting 10-12mm core
- Corner cap free design
- Pen tray and wall fixings included
- Suitable for use with most projectors
- Full colour print and dry-wipe lamination
- Print fitted under the frame for a seamless finish
- We recommend Pentel Maxiflo or Whitebox dry-wipe markers

## Frame Finishes:

- Premium varnished Solid Oak frame
- Antique bronze
- Antique pewter
- Textured silver
- Satin silver
- Standard powder coated colours

## General Information:

For technical specifications please see the below pages.

- |                   |                         |                         |                         |
|-------------------|-------------------------|-------------------------|-------------------------|
| • Master Swatches | - <a href="#">pg 40</a> | • Fire Ratings          | - <a href="#">pg 41</a> |
| • Accessories     | - <a href="#">pg 42</a> | • Whiteboard Care Guide | - <a href="#">pg 43</a> |
| • Guarantees      | - <a href="#">pg 44</a> | • Delivery Options      | - <a href="#">pg 45</a> |

## Whiteboard Formats:

- Flat Framed
- Custom Printed Framed
- Hidden Framed
- Solid Oak Framed

## Insert Options:

- Non-magnetic dry-wipe whiteboard with semi-matt or gloss finish
- Magnetic dry-wipe whiteboard with high gloss finish

## Optional Extras:

- Acrylic business card holders
- Perspex document pockets for storage
- 50% pinboard 50% whiteboard
- Hidden rear 'keyhole' fixings available
- Standard or custom sizes available
- Header plates and graphics available
- White PVC header plate
- Silver, gold or powder coated header plate
- Vinyl text on header plate
- Printed logo on header plate
- Free artwork for musical staves, 50, 75 or 100mm squares or writing lines

# SCHOOL BOARDS

These Premium aluminium framed openboards are perfect for use in any outdoor settings, schools and nurseries.

## SCHOOL BOARD OPTIONS:

- Our chalkboards are made from a high pressure laminate which is far superior to painted wood (from which many chalkboards are made). Unlike painted boards, our boards won't chip or degrade and won't require annual repainting.
- Our premium whiteboards are virtually unbreakable, with long-lasting quality.

## POPULAR USES:

- Health and safety
- Classroom boards
- Status boards
- Playtime boards

## IDEAL LOCATIONS:

- Outdoor settings
- Nurseries
- Schools

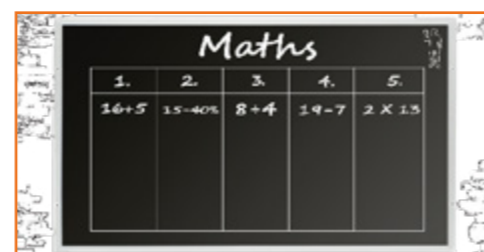
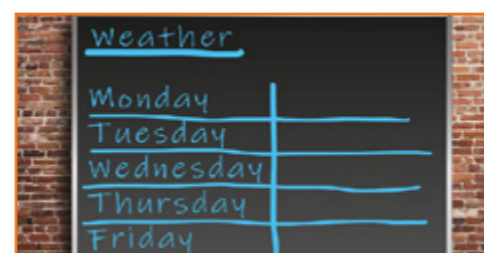
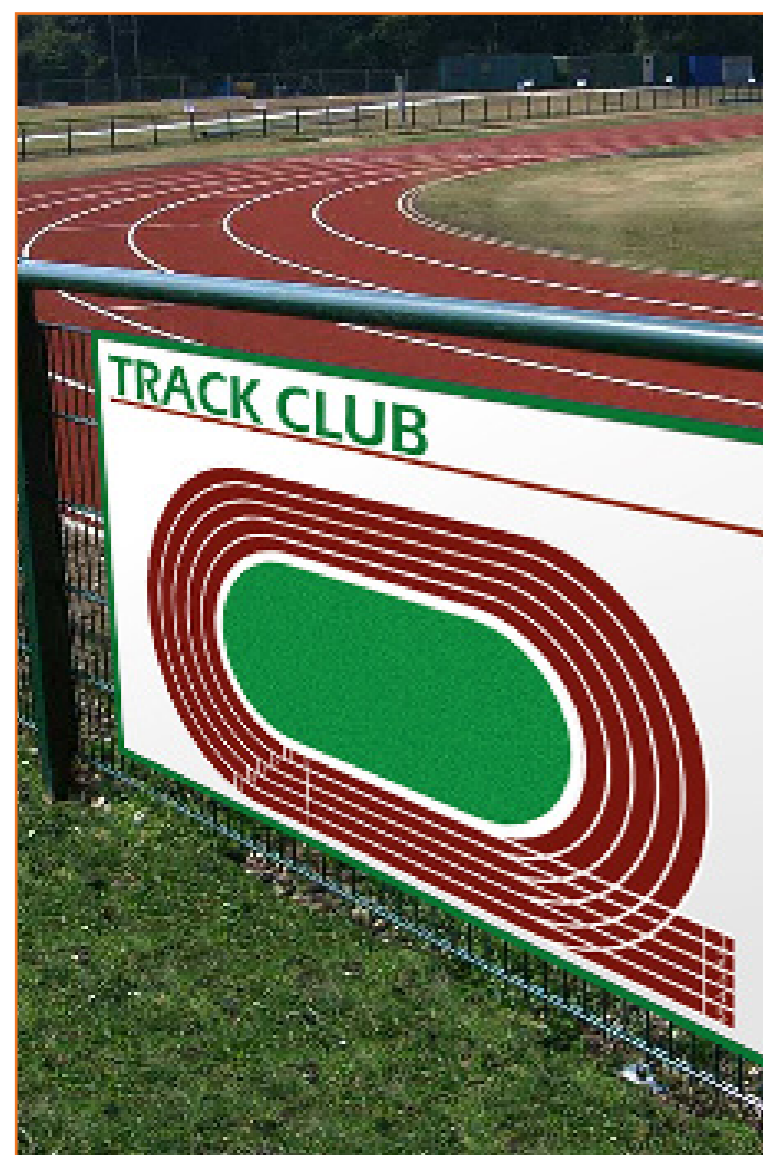

## Display Area:

300mm x 210mm (A4)  
420mm x 300mm (A3)  
600mm x 450mm  
900mm x 600mm  
1200mm x 900mm  
1200mm x 1200mm  
1500mm x 1200mm  
1800mm x 1200mm  
2400mm x 1200mm

## Key Features:

- Easy to install
- Come complete with wall fixings
- Premium quality with 16mm depth
- Virtually unbreakable magnetic surface
- All components 100% weatherproof
- Corner cap free design
- Designed for magnets and Dry-wipe pens
- Suitable for chalk and chalk pens (non-permanent)
- Includes pen tray

## Frame Finishes:

- Textured silver
- Satin silver
- Standard powder coated colours

## General Information:

For technical specifications please see the below pages.

- Master Swatches - [pg 40](#)
- Accessories - [pg 42](#)
- Guarantees - [pg 44](#)
- Fire Ratings - [pg 41](#)
- Whiteboard Care Guide - [pg 43](#)
- Delivery Options - [pg 45](#)

## Whiteboard Formats:

- Flat Framed
- Custom Printed Framed
- Hidden Framed
- Solid Oak Framed

## Insert Options:

- Magnetic dry-wipe whiteboard with high gloss finish
- Chalkboard laminate

## Optional Extras:

- Full surface print to your custom design
- Standard sizes and custom sizes available
- Extra for a Powder Coated frame
- Any writing or cleaning substances or materials other than those recommended may invalidate the 5 year surface guarantee. Surface guarantee does not cover any damage or scratching of the board surface caused by misuse or vandalism.
- Vinyl text on whiteboard surface
- Printed logo or digital print
- Printed vinyl graphic

# MASTER SWATCH

Below are the standard frame and insert options available. If any non-standard colour specifications are required, we can supply these.

STANDARD RANGE OF FRAME FINISHES											
<b>ALUMINIUM FINISHES</b>	<b>SS</b>	<b>TS</b>	<b>PG</b>	<b>PS</b>	<b>AP</b>	<b>AB</b>					
Description:	Satin Silver	Textured Silver (RAL 9006) (Powder Coated - similar to SS)	Polished Gold	Polished Silver	Antique Pewter (Powder Coated)	Antique Bronze (Powder Coated)					
<b>POWDER COATED COLOURS</b>	<b>CR</b>	<b>CG</b>	<b>CD</b>	<b>CB</b>	<b>CZ</b>	<b>CM</b>	<b>CY</b>	<b>CN</b>	<b>CK</b>	<b>CW</b>	<b>CS</b>
Description:	Red	Green	Dark Green	Blue	Royal Blue	Maroon	Yellow	Brown	Black	White	Silver Grey
RAL Reference:	3020	6029	6005	5010	5002	3004	1023	8017	9005	9003	9006
Finish:	Gloss	Gloss	Gloss	Gloss	Gloss	Gloss	Gloss	Gloss	Satin	Gloss	Gloss

*OTHER POWDER COATED COLOURS ARE AVAILABLE ON REQUEST, AN ADDITIONAL CHARGE MAY BE REQUIRED*

STANDARD RANGE OF INSERT OPTIONS												
<b>Standard Felt</b>				<b>Brushed Loop Nylon</b>				<b>Tricord</b>				
Industry standard felt that is pin friendly & accepts Velcro in moderate use. Fire resistant to BS 5867				A very smooth fabric specifically designed for use with Velcro. Also accepts pins in moderate use. Fire resistant to BS 5867				A cross-stitch fabric with a smart uniform pattern that is pin friendly and offers the best durability of all fabrics. Fire resistant to BS 5867 & 476-1				
<b>OB</b>	<b>DG</b>	<b>CH</b>	<b>GY</b>	<b>XB</b>	<b>EG</b>	<b>HY</b>	<b>LG</b>	<b>BL</b>	<b>OX</b>	<b>RE</b>	<b>BN</b>	<b>SR</b>
Oxford Blue	Dock Green	Cherry	Grey	Oxford Blue	Emerald Green	Cherry Red	Light Grey	Black	Oxford Blue	Red	Bottle Green	Grey
<b>Premium Natural Felt</b>						<b>Felt Groove Board</b>						
Finest quality natural wool felt in 250g/m <sup>2</sup> . Pin friendly and accepts Velcro in moderate use. Fire resistant to BS 5867 & BS 476-1.						MDF covered with high quality premium natural felt. Designed for Variatex changeable characters. Suitable for light Velcro use, but not pins.						
<b>RD</b>	<b>GN</b>	<b>BE</b>	<b>BK</b>	<b>BG</b>	<b>SG</b>	<b>BI</b>	<b>GE</b>	<b>GG</b>	<b>GU</b>	<b>GK</b>	<b>GD</b>	
Red (EX65)	Green (EX31)	Blue (EX154)	Black (EX08)	Burgundy (EX35)	Silver Grey (EX52)	Beige (EX134)	Red (EX65)	Green (EX31)	Blue (EX154)	Black (EX08)	Burgundy (EX35)	
<b>Other Inserts</b>				<b>COLOURED MAGNETIC PANELS</b>								
<b>MG</b>	Magnetic Drywipe surface is painted steel with a high gloss finish, excellent durability and fire rated to BS476-1			<b>CO</b>	3mm thick industry standard cork is suitable for pins in high usage. Not suitable for Velcro.			<b>CL</b>	High pressure chalk laminate is virtually unbreakable and is suitable for chalk pens and traditional chalk.			
<b>NM</b>	Non-Magnetic Drywipe surface is a smooth coated hardboard with a semi-matt finish and good durability.			<b>GR</b>	5mm black rubber with grooves that match the felt Grooveboard and Variatex groove characters.			<b>COLOURED MAGNETIC PANELS</b> Zintec panel in powder coated colour or finish, to match or contrast the frame finish of your product.				

EXTENDED RANGE OF FABRICS	
We have a special extended range of fabrics to match unique requirements, please contact us for more details.	

WOOD EFFECT FINISHES				
<b>WOOD EFFECT POWDER COATING</b>				
Description:	WoodEffect 1 -	WoodEffect 2 -	WoodEffect 3 -	WoodEffect 4 -

*OTHER WOOD EFFECT FINISHES ARE AVAILABLE ON REQUEST, ALL PRICED ON APPLICATION*

# FIRE RATINGS

The exterior surface of most premium range products are fire resistant to the highest British Standard available - BS-476 Class 1 Part 7 - Surface Spread of Flame. See below for the fire rating for each product's components and note any exceptions.

As an optional extra products can be made manufactured so that all components are fully fire rated to BS-476 Class 1 as above. Please contact us for more information on fire resistance or ratings.

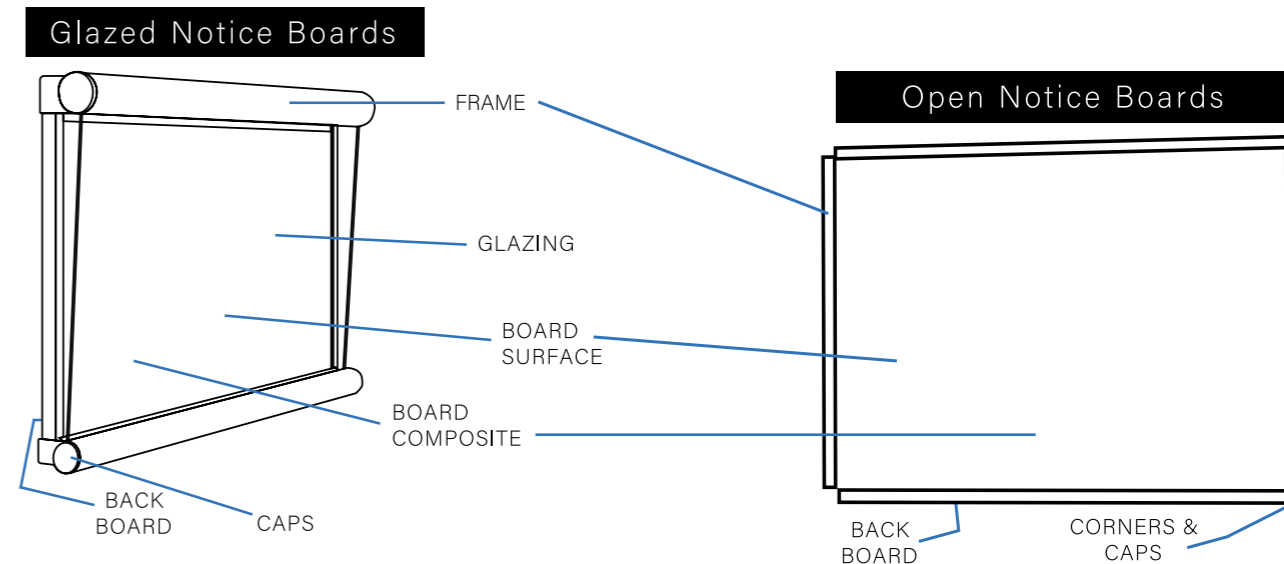

## Fire Ratings of Component Materials:

Noticeboards	Avenue	Scroll	Lynester/ Eco-Vision	Varicase
Frame - satin silver & polished colours	N/A	BS-476-1	N/A	BS-476-1
Frame - powder coated finishes	BS-476-1	BS-476-1	BS-476-1	BS-476-1
Caps	N/A	BS-476-1	N/A	N/A
Glazing	BS-476-1	BS-476-1	BS-476-1	BS-476-1
All exterior surfaces BS-476 Class 1 SSF	Yes	Yes	Yes	Yes
Fully fire rated including the board core	N/A	Optional Extra	Optional Extra	Optional Extra

Open Boards	Flat Frame	Solid Oak
Frame - satin silver & polished colours	BS-476-1	No
Frame - powder coated finishes	Optional Extra	No
Caps	N/A	N/A
Fire rated, components and backboard	Optional Extra	Optional Extra

Board Surface	Standard Felt	Brushed Loop Nylon	Tricord	Premium Felt	Felt Groove Letterboard	Non-Magnetic Dry-wipe Whiteboard	Magnetic Dry-wipe Whiteboard
Fire rating	BS-5867	BS-5867 & BS-5438	BS-5867	BS-5867 & BS-476-1	BS-476-1	Not Rated	BS-476-1

## Full Classifications:

- BS-476-1 = Part 7, Class 1 for surface spread of flame (maximum).
- BS-5867 = Type B, Part 2 for curtain & drape flammability.
- BS-5438 = Flammability of textile fabrics when subjected to a small igniting flame applied to the face or bottom edge of vertically oriented specimens.

# ACCESSORIES

## Protective Extras:

- Additional clear powder coating, for silver satin, polished silver & gold finishes, required for highly exposed locations and those within 1 mile of coastlines.
- Additional intermediate primer for powder coated finishes, required for highly exposed locations and those within 1 mile of coastlines.
- Channel (fitted to case), railing clips & fixings available.

## Replacement or Individual Parts:

### Posts (Pair):

- 80mm square modular posts, powder coated black, 3000mm long
- 80mm square, 80 D-shape or 90mm round modular posts, powder coated any finish, 3000mm long
- 80mm square, 80 D-shape or 90mm round modular posts, powder coated any finish, 3500mm long
- 76mm round, powder coated any finish avenue posts, 3000mm long
- 89mm round, powder coated any finish avenue posts, 3000mm long
- Internal post stiffeners for modular posts, 2500mm long

### Stands:

- Scroll 1.1m
- Scroll 1.8m
- Scroll 1.1m double stand
- Stand bracket only

### Lamps & Ballasts:

- T2 ultra-bright lamp or ballast (while stocks last)

### Keys & Locks:

- 2 X keys for Scroll, Varicase, Lynester and Avenue
- 2 X locks and 2 x keys for Scroll, Varicase, Lynester and Avenue

### Other:

- Anodising erasers for removing scuff marks on satin silver finishes

## Approved Accessories & Cleaning Solutions:

# BOARD CLEANING GUIDE

Our dry-wipe whiteboards perform to a very high standard, provided they are maintained correctly and used in conjunction with the correct pens.

To assist you in getting the best from your dry-wipe whiteboard and to ensure you maintain your 1 year product guarantee, please follow these guidelines:

## Whiteboard Pens:

We put 12 leading dry-wipe whiteboard pen suppliers through extensive testing to check our surfaces perform to the highest standard. All pens tested met our minimum standard, for dry-wiping and cleaning off with a slightly damp cloth.

For best performance we recommend Pentel Maxiflo markers and Whitebox WBSL pens. These pens are available to purchase from us and are available through most stationery suppliers.

We ask that you use one of the following pens, in order to maintain your product guarantee.

- Pentel Maxiflo Premium Dry-wipe Markers
- Whitebox Economy WBSL Dry-wipe Markers
- Uni Inkview Whiteboard Markers
- Sharpie Low Odour Whiteboard Markers
- Artline 525tt Whiteboard Markers
- Acco Nobo Glide Dry-wipe Erase Markers
- Staedtler Lumocolor Whiteboard Markers
- Expo Dry Erase Markers
- Berol By Papermate Dry-wipe Markers
- Show-Me Teacher Whiteboard Markers
- 5 Star Dry-wipe Marker
- Edding 361 Board Marker

## Cleaning Tips:

We recommend that any ink is cleaned with a soft cloth (e.g. yellow duster - included with each whiteboard we supply) and not a board eraser. Board erasers often hold the ink on the surface of the eraser which causes smudging. Smudged ink can then be significantly harder to remove. Please do not use any abrasive material to clean your board. Even something as innocent as a paper towel can damage the dry-wipe surface, causing it to become difficult to clean.

If ink does not dry-wipe with a soft cloth, we recommend making your cloth slightly damp. This should be sufficient to remove ink that is even several weeks old. If you prefer to have a cleaning spray near your board for convenience you can purchase an approved cleaning spray. 5-Star Whiteboard Cleaner- 250ml pump spray bottle is recommended.

# GUARANTEES

## 5 Year Guarantee Terms & Conditions

All our exterior glazed products are covered by a 5 year guarantee as standard. This covers defective parts and/or labour, with the exception of the pinboard core and fabric coverings\*, and is based on normal operating conditions within the UK and Republic of Ireland.

Powder coated finishes are applied to the standards of the powder coating suppliers. Colour fastness and corrosion resistance is dependent on the location and atmospheric conditions. Therefore our guarantee is limited to corrosion resistance only in line with our powder coating suppliers specifications, with the following provisions:

- Products with powder coated finishes, that are installed within 1 mile of a coastal location\*\*, must also have the extra coastal intermediate primer protection applied to the external finish.
- Products with satin silver, polished gold or polished silver finishes, that are installed within 1 mile of the coast, must also have the additional clear powder coating applied to the external finish.

The guarantee is offered on the basis that, any faulty product is returned to the factory to assess and/or remedy, with prior written agreement of the manufacturer. Photographic evidence may be required before the product is returned. The 5 year guarantee does not cover consequential losses or expenses. If the product has been modified or tampered with other than as expressed in the instructions, or notified and agreed by the manufacturer, the manufacturer reserves the right to void the guarantee.

In order to uphold your guarantee, please ensure the products are:

- Installed, as directed in the instructions we provide.
- Well maintained, using guidance information stated on the instructions.
- Cleaned regularly, using guidance information stated on the instructions.

Frequency of cleaning will depend on local conditions, but the minimum recommendation is twice a year. In most cases regular cleaning will also help your product last beyond the 5 year guarantee.

\* Please note that coloured magnetic inserts offer much greater durability than fabric coloured pinboards, especially in their colour fastness.

\*\* As well as highly industrial locations or any other locations with high levels of sulphur dioxide in the atmosphere.



# DELIVERY OPTIONS

## General Delivery Terms:

1. Standard UK Mainland delivery.
2. DataPack Signed Next Day delivery for small replacement parts, lamps & ballasts, accessories and letterboard characters (max 10 sets) - £9 net.
3. Courier Next Day delivery for all products except those which are post mounted - £18 net.
4. Courier Next Day delivery for post mounted products - £29 net.
5. All delivery prices above are limited to UK Mainland.
6. Prices exclude all Isles and AB, DD, IV, KY, KW, PA, PH postcodes.
7. All other UK regions and international delivery is based on weight and destination.

## Product Specific Delivery Terms:

- **Wayfinding Sign Systems:** All items delivered based on weight and destination. Despatched in 15-20 working days.
- **Eco-Vision:** Free UK Mainland. Excludes Isles & AB, DD, IV, KY, KW, PA, PH postcodes, includes palletised delivery. Despatched in 15-20 working days.
- **Scroll:** UK Mainland - £18, £29 with posts. Excludes Isles & AB, DD, IV, KY, KW, PA, PH postcodes. Despatched in 7-15 working days.
- **Avenue:** UK Mainland - £18, £29 with posts. Excludes Isles & AB, DD, IV, KY, KW, PA, PH postcodes. Sign Panels: £50 net. Despatched in 10-15 working days.
- **Lynester & Varicase:** UK Mainland - £18, £29 with posts. Excludes Isles & AB, DD, IV, KY, KW, PA, PH postcodes, includes palletised delivery. Despatched in 10-15 working days.
- **Econ Letterboards:** UK Mainland - £18. Excludes Isles & AB, DD, IV, KY, KW, PA, PH postcodes. Non-stock - 10 working days. Stock items - next day despatch.
- **Variatex Letterboards:** UK Mainland - £18. Excludes Isles & AB, DD, IV, KY, KW, PA, PH postcodes. Despatched in 10-15 working days.
- **Econ & Variatex Characters:** 1-10 sets to UK Mainland - £9. Excludes Isles & AB, DD, IV, KY, KW, PA, PH postcodes. Despatched next working day.
- **Pinboards, Whiteboards & School Boards:** UK Mainland - £18. Excludes Isles & AB, DD, IV, KY, KW, PA, PH postcodes. Despatched in 10-15 working days. Delivery of pens, pins, magnets and/or cleaner is £9 for UK Mainland if purchased on their own, without a board product.



SignscapeandSignconex



Pear Tree Industrial Estate  
Bath Road  
Upper Langford  
Bristol  
BS40 5DJ

01934 852 888  
sales@signscape.co.uk



[www.sasl.co.uk](http://www.sasl.co.uk)

