

Avon SG1500CR Sliding Gate



Avon SG1500CR High Impact Sliding Armoured Vehicle Gates provide a high level of security against unauthorised vehicle access.

The SG1500CR gate was first independently physically tested by the Transport Research Laboratory (TRL) using an N3 european truck in accordance with the PAS 68 specification (7,500kg weighted vehicle travelling at 80kph) and post-test achieved zero penetration. The same gate was then crash tested with a 4x4 pick-up truck travelling at 80 kph and zero penetration was achieved.

The gate design was then aesthetically enhanced by removing the front two support legs and independently tested by the Transport Research Laboratory (TRL) with a US truck (15,000lb truck at travelling at 50 mph) in accordance with the US Standard ASTM F 2656-07 (supersedes DoS SD-STD-02.01) again the gate stopped the vehicle and zero penetration was achieved.

The gate comes with a hold to run control as standard. However it can be customised to interface with a wide range of access control equipment to suit specific customer requirements.

Please note this is a specialist high security product and is designed for use with vehicles only.

SG1500CR Sliding Gate

SPECIFICATION

Physical Dimensions:	The tested model has a clear width opening of 4m, please contact our sales department for alternative dimensions
Basic Power Requirements:	Subject to gate size and construction
ASTM F2656-07 Classification:	M50 P1
Full PAS68 Classification:	V/7500(N3)/80/90:0/0 V/2500(N1G)/80/90:0/0 (4x4 pickup truck)
Tested Model:	Sliding gate Overall width 6.2m 2.2m high - clear width opening of 4m
Speed of operation:	6 to 8 seconds per metre
Operating temperature range available:	-25°C - +70°C (option)
Construction:	The framework is constructed from fully welded, heavy gauge, steel structures and hi-tensile structural steel. Both versions of the sliding gates foundation depths are from under 500mm subject to gate design and incorporate a full impact resistant system which enables a wide range of gate heights, clear widths and infill to be provided.

Features

- Physically impact tested to PAS 68 criteria and ASTM F 2656-07 criteria
- Manufactured from heavy gauge materials
- Variable height & clear widths
- Manual operating override facility
- High quality coating system (minimum galvanised)
- Shallow mounting less than 500mm overall depth
- Hold to run operation

Benefits

- Confidence in proven performance
- Flexibility to suit site requirements
- Strength and durability
- Operational under power failure conditions
- Overcomes site depth restrictions
- Reliable & dependable
- Safe operation



OPTIONS

Where the high security gates control point is remote from the installation, we strongly recommend the fitting of a recordable CCTV system, traffic lights and inductive loop systems.

Please note this is a specialist high security product and is designed for use with vehicles only and a full site risk assessment must be carried out at design stage to ensure all relevant safety systems are included.

- Matching infill panels
- Emergency buttons with lock down
- Inductive loop detectors
- Access and intercom systems
- UPS backup for the electrical system
- Traffic lights and back-indications systems
- Serrated / barbed wire toppings
- Laser Scanners
- Safety edges, Safety beams

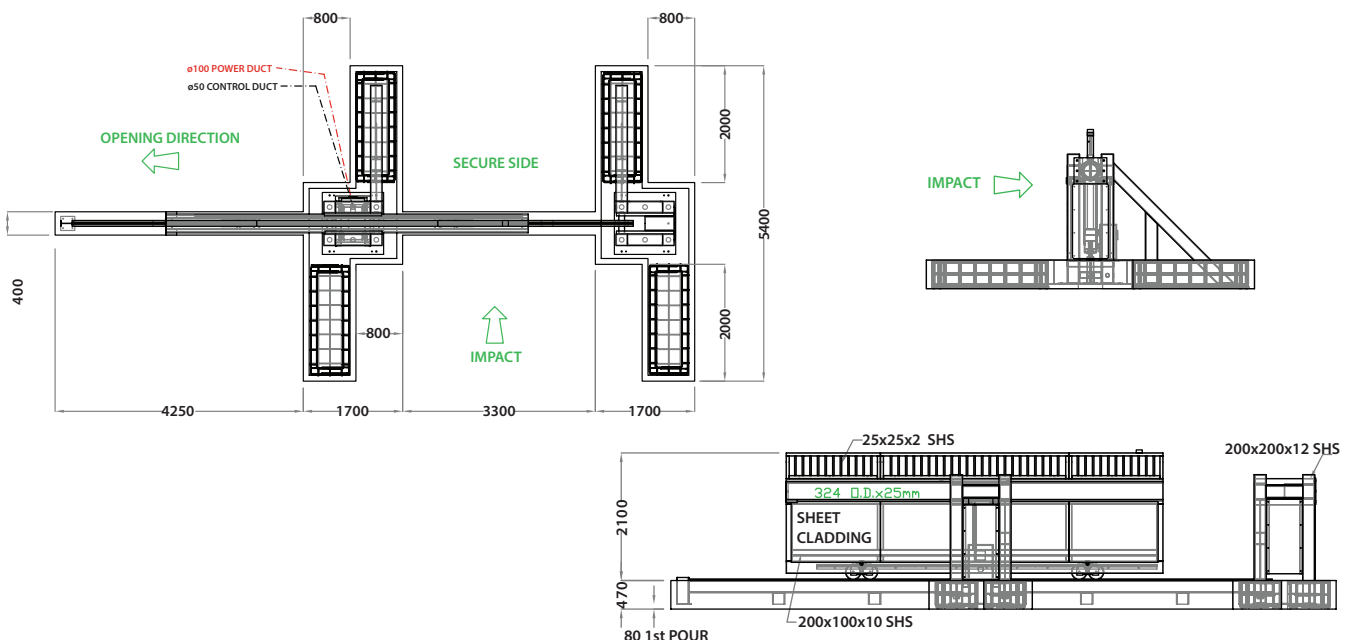

Avon Barrier Corporation Ltd
149 South Liberty Lane
Bristol BS3 2TL
United Kingdom

t: +44 (0) 117 953 5252
e: sales@avon-barrier.com
w: www.avon-barrier.com

Avon Barrier reserve the right to change or amend the specification of its products from time to time in furtherance of its policy of continued improvements.

Ref Avon SG1500CR Sliding Gate version 4 11_18

