

5 55 334 5

eibe ibondo Swing Snake







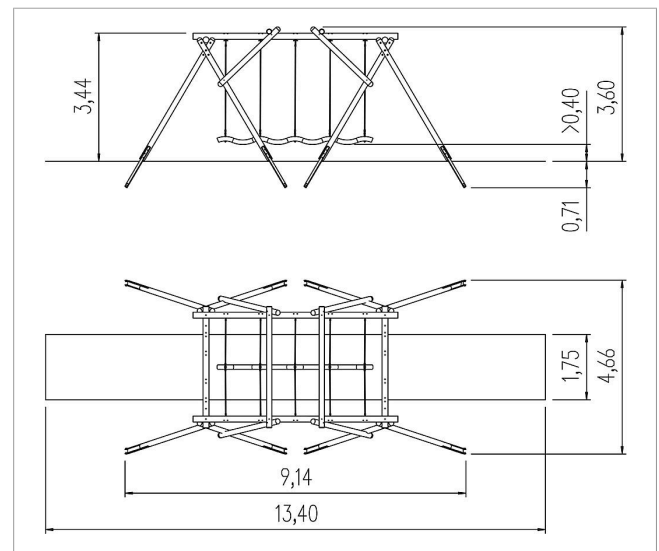

made in germany

3+

Scope of delivery

- 1 swing frame: SW
- 1 swing snake: polyester-coated steel cable
- Post shoes: hot-dip galvanised steel



	Material	SW pi
	Foundation level	FL 3
	Minimum space	1340x466x360 cm
	Free falling height	205 cm
	Impact protection net	23 m ²
	Foundations	6x CF
	Assembly	2 people/8 h
	Largest section	550xØ 16 cm
	Heaviest section	50 kg