

5 35 002 1432 5

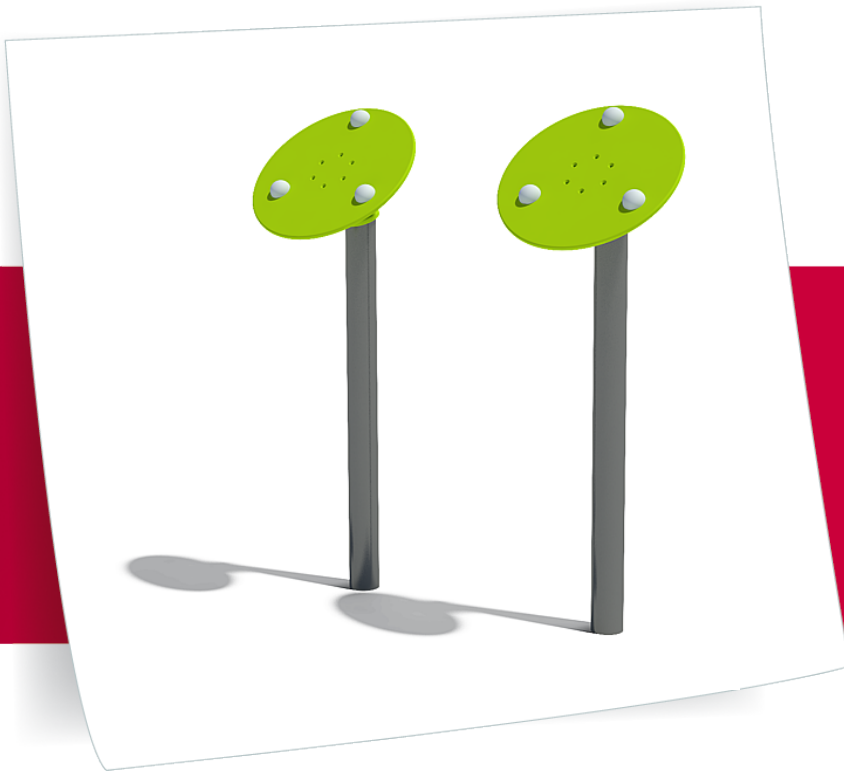





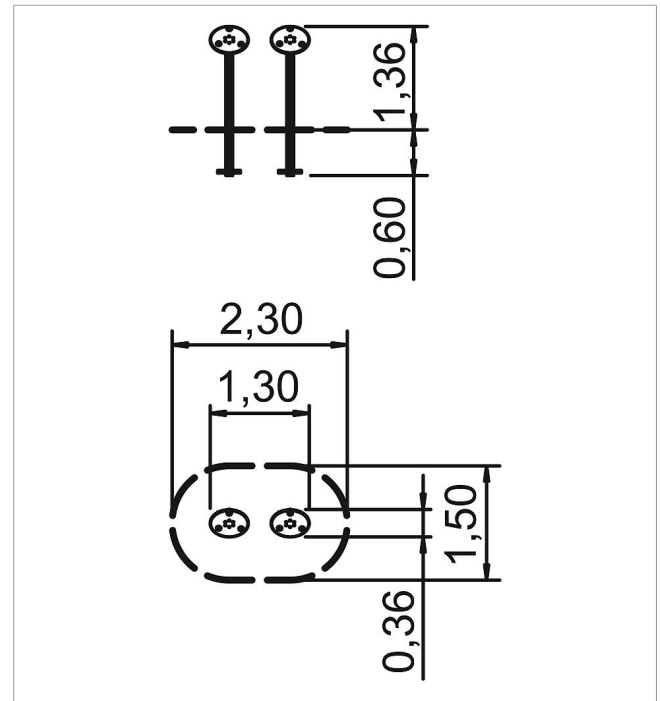

**eibe fantallica active-
station 'Spinning disc',
single**
made in germany



Scope of delivery

2 posts: hot-dip galvanised and powdered steel
2 palms: HPL



	Material	Steel
	Foundation level	FL 3
	Minimum space	230x150x180 cm
	Free falling height	-
	Impact protection net	-
	Foundations	2x CF
	Assembly	1 person/3 h
	Largest section	1960x360x360 cm
	Heaviest section	24 kg