

# SOUNDSORBA®

ACOUSTIC PRODUCTS

## LINERSORBA®

LINERSORBA® is a highly cost effective system to absorb noise in building spaces. It is very flexible and easy to install as it snap fits onto wall surfaces using proprietary U channels and T sections. The acoustic panels have an off-white speckled face, giving a rugged mottled visual appearance whilst still offering a valued added finish. Ideal for areas that are not exposed to possible damage.



# LINERSORBA® Acoustic Panel Systems

## APPLICATION

LINERSORBA® acoustic panels are a cost effective solution to absorbing noise in buildings where there is no possibility of damage to the panels. They are generally used out of touching distance on walls of offices, community halls, schools and universities, laboratories, workshops, etc.

## COMPOSITION

Manufactured from specially tooled high density acoustic Glasswool boards faced on one side with off white colour speckled non-woven acoustic facing giving a mottled industrial surface finish.

## CUTTING

Panels can be cut with a long bladed Stanley knife or kitchen knife. The fixing sections can be cut with a fine tooth fret saw.

## THERMAL INSULATION

Thermal conductivity:  $K = 0.037 \text{ w/m}^2\text{k}$ .

## NOMINAL SIZES

Panel size: 2700mm x 1200mm, 2400mm x 1200mm, 1200mm x 1200mm, 1200mm x 600mm.

Panel thickness: 25mm and 40mm.

UPVC fixing trims: 2700mm lengths.

PU trims are perimeter U channels.

PT trims are T-joint sections.



## FIRE RESISTANCE

Class 0 to BS476 Part 6



## CLEANING

Panels can be vacuum cleaned periodically



## WEIGHT

Panels are lightweight.  
25mm thickness -  $2.5 \text{ kg/m}^2$   
40mm thickness -  $4 \text{ kg/m}^2$



## COLOUR

Off white

## ACOUSTIC PERFORMANCE )))

### ACOUSTIC PERFORMANCE BS EN ISO 354:2003

Noise Reduction Coefficient 0.90 (i.e. 90%)

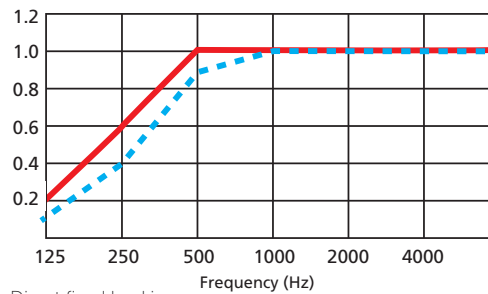

**KEY:**  
Class A - 40mm thick panels  
Class C - 25mm thick panels

Direct fixed backing

Even higher absorption can be achieved when installed with an air gap

## INSTALLATION

The panels have cut edges on all four sides but can be cut on site using a Stanley knife or similar. Clean white cotton gloves should be worn when handling the panels to avoid any possibility of marking the face of the panels.

The UPVC sections serve two functions. One is to decoratively mask the edges and the other is as structural fixing sections. This system is the most flexible as panels can be cut on site to suit wall dimensions.

Use spirit level to align all horizontal and vertical surfaces. Drill oversized holes in UPVC female trims larger than screw shank, but smaller than screwhead. Use V line as guide.

Screw fix at maximum of 400mm centres. The backing wall, to which the LINERSORBA® acoustic panels are to be fixed, must have a continuous solid backing wall surface which must be flat and level.

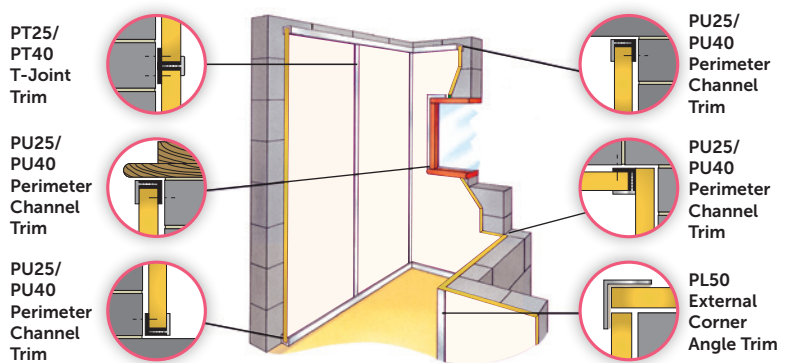

## EASY FIX INSTALLATION - by using UPVC clip-in trims

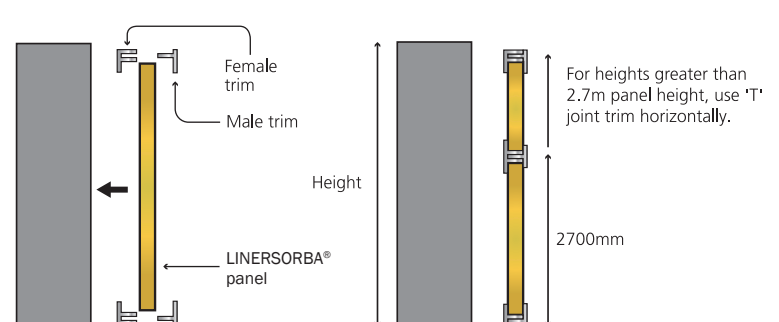

## FIXING GUIDE

- A** Screw fix UPVC female perimeter trim to top, bottom and end of walls.
- B** Screw fix UPVC female 'T' joint. Trim vertically between top and bottom UPVC female perimeter trims, allowing for LINERSORBA® panel width and height.
- C** Cut and insert individual LINERSORBA® panels to fit between female perimeter and female 'T' joint trims. Push fit top and bottom male perimeter trims into female trims. Then neatly cut vertical male perimeter and vertical male 'T' joint trims to fit between the top and bottom perimeter trims and push fit together. Ensure that all trims are fully pushed in and located. On external corners, glue the PL50 angle trim as illustrated above.