

MultipliCITY Seat

MultipliCITY is an international collection of outdoor public furniture elements that gives new meaning to the term global design. Created and developed in partnership with celebrated design innovators Yves Behar and fuseproject, MultipliCITY is an expressive, dynamic and flexible system that combines the efficiency of mass production, the use of custom materials and configurations to express cultural preferences. The MultipliCITY Seat shares the same form language as the bench and like it is solid and grounded, interactive and user-focused. The cast aluminium seat with timber slats is offered in straight and mitered versions that enable virtually limitless configurations.

Specification

Materials

Frame - cast aluminium

Seat - timber

Dimensions

H: 834mm
W: 2400mm
D: 582mm

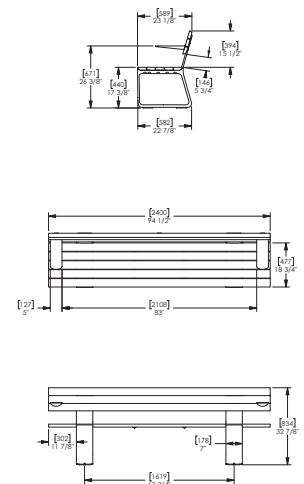

(Technical Drawings for variants available on request)

artform
urban furniture