

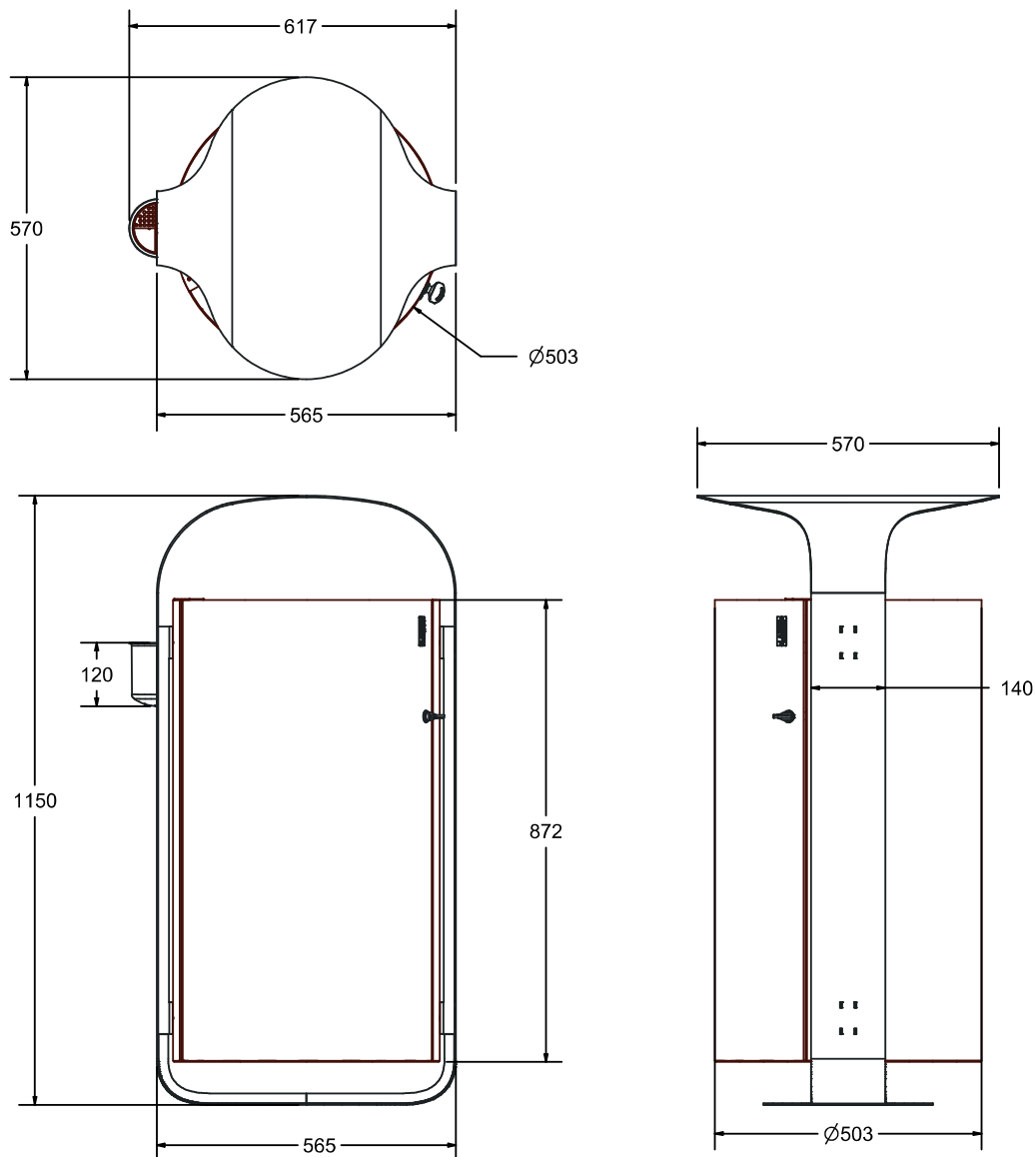

Max dimensions:

Height: 1150 mm | Width: 570 mm | Length: 617 mm | Capacity: 90 lt

Ashtray Capacity: 0,25 Lt | Weight: 52 Kg

**DESCRIPTION**

The load-bearing structure of the bin is made in steel sheet of 30/10 thickness. Inside the bin, a strong support of 30/10 thickness, on which there are 4 threaded inserts M8 for the fixing of the structure of the bin, is welded. The bin has a front part, which can be opened, and a back that can't. Both parts are made in steel sheet of 15/10 thickness, supported by profiles of 30/10 thickness. On the door there is a triangular key lock. On the base of the bin, there are 4 holes of 11 mm diam. for the fixing to the ground through specific bolts (not provided). Inside the bin there is a container in galvanized steel sheet of 10/10 thickness, which is also polyester-powder coated. On the upper part there are 2 oval holes serving as handles and two holes of 10 mm diam. for the insertion of the elastic band. On the side of the load-bearing structure there is an ashtray, and on demand another can be added to the other side.

For the realization of this product, Steel EN10111DD11 is used and later treated with a cycle of sandblasting, cataphoresis and powder coating. Such cycle is meant to guarantee the protection of the painted products, in an environment of C4 corrosion class, as requested by the UNI regulations EN ISO 12944-2. The products are eventually polyester-powder coated with RAL colours at choice.

As an alternative to steel EN10111DD11, the production in corten is also available, on demand. In this case the material is treated with a specific oxidation process.

The galvanized steel used is steel EN10346DX51D+Z and, unless otherwise stated, is not painted.

LAB23

FLUXUS

Litter Bin



Designer: Arch. Roberto Semprini