

MULTIPANEL[®]

FLOORS

WETFLOR[®]

Recommended Tools

- A sharp knife (A hooked blade is recommended)
- F84 Two Part Reactive Flooring Adhesive
- 68kg Articulated floor roller
- Notched adhesive trowel
- Flat nosed flexible knife
- 45 Degree square
- A tape measure
- Straight edge
- Grooving tool
- A soft brush
- Hand roller
- Spirit level
- Felt Paper
- Heat gun
- Dividers
- Scribe

INSTALLATION GUIDE

Pre-installation

Prior to installation, Multipanel recommend that you visit our **video** section on www.multipanel.co.uk, where you will find a complete WetFlor animation.

Pre-installation check-list

Checked?

Inspect flooring for any flaws, defects or damage	Y / N
Check colour and pattern concentration consistency between all sheets.	Y / N
If flooring is being fitted by a tradesman, colours should be approved by end user.	Y / N
Condition flooring at room temperature for 48 hours.	Y / N

PREPARATION OF SUB-FLOOR

Any imperfections in the subfloor will affect the final appearance and performance of Multipanel WetFlor.

Basic requirements:

- **For ALL floors**

Subfloors must be uniformly levelled, clean and free from grit, dust, grease, oil, polish, old adhesive and paint. It is essential that the subfloor is dry.

- **For concrete floors**

Use a leveling compound if the surface is uneven, rough or cracked. It is usual to apply 3-6mm of leveling compound to produce the desired level finish.

- **For Wooden floors**

Cover the entire floor outside the fall formed area with 6mm Marine Plywood sheets to ensure any gaps between floorboards are concealed.

- **Quarry or Ceramic tiles**

Follow the basic requirements above for concrete floors. Any loose or broken tiles should be removed and the floor patched with a suitable concrete patch before using a latex leveling compound to fill the joints between the tiles to create a smooth, even surface.

- **Existing smooth flooring**

Remove all existing vinyl, linoleum, cork flooring and residual adhesive if any. The floor must be properly cleaned of dirt and grit and should be dry.

Remove any skirting boards which remain in the room and fill any blemishes in door architrave.

RECOMMENDED ADHESIVE

Mixing and Application

Multipanel recommends the use of F84 Two Part Reactive Flooring Adhesive from F. Ball for fixing WetFlor[®] to the substrate.

MIXING

- ✔ Stir the contents of the resin container then empty all the contents of the hardener container into it.
- ✔ Using a power whisk fitted to a slow speed drill, or alternatively a stick for hand-mixing, mix the two components together for approximately 2 minutes, scraping the sides of the container, until a uniform mix is obtained.

ADHESIVE APPLICATION

- ✔ WetFlor[®] must be allowed to flatten, then cut to fit before mixing the adhesive.
- ✔ Holding the trowel at an angle of 60°, spread the adhesive evenly to an area that can be covered within the working time of the adhesive - approximately 1 hour at 20°C.
- ✔ Immediately lay the WetFlor[®] into the wet adhesive, pressing from the centre outwards to exclude air. Roll to ensure overall contact with the adhesive.
- ✔ Under certain circumstances, you may need to apply weights to some floorcoverings to maintain contact until the adhesive has set - about 12 hours.
- ✔ Do not weld WetFlor[®] until the adhesive has had sufficient time to develop a good bond.

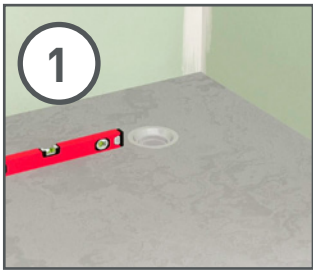

1
Check Fall to Gully is even and sufficient to allow drainage. The surrounding floor should be checked for suitability, and that it is flat and level.

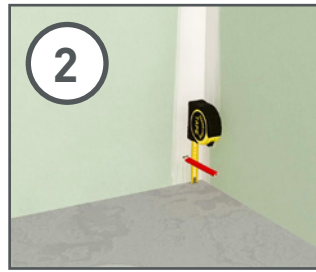

2
Measure the desired height of the upcovered flooring around the walls.

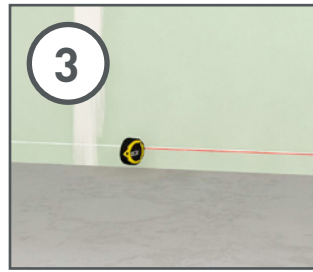

3
Strike a chalk line around the walls.

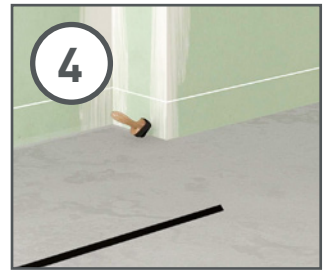

4
Cut coving strips to length. Coat the strips and walls where the coving strips will sit with pre-mixed adhesive (see recommended adhesive section)



5
When both adhesive parts are dry, fit the coving in place and mitre to fit around corners. Sand down mitred joints to ensure a smooth finish.

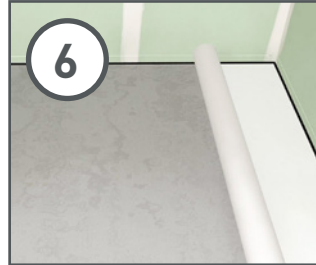

6
Dry fit the area with felt paper, leaving a gap of 15mm to 20mm around obstructions and walls.

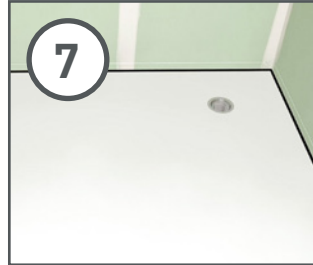

7
Cut neatly around the drain.

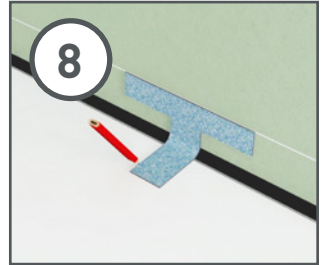

8
Cut a surplus piece of flooring into a T shape, mark one side so that it is always used the same way up.

Place the top of the T against the chalk line and press the bottom part tightly into the coving and mark the position.

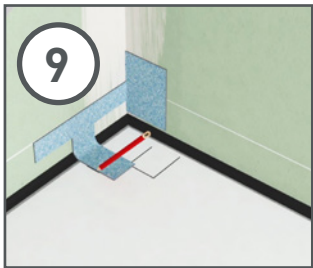

9
After marking one side of a corner you can use a scrap piece of vinyl as a spacer, this makes it easier to place the second mark.

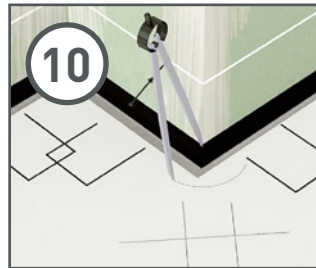

10
Check the compass setting at the scribe marks and place two intersecting arcs to establish the end point for external corner.

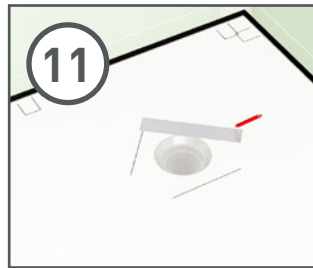

11
After marking out the walls, use three lines to mark out the drain allowing plenty of overlap, for correct fitting of WetFlor® inside the Gully Collar. A Circular Gully must always be used with WetFlor®

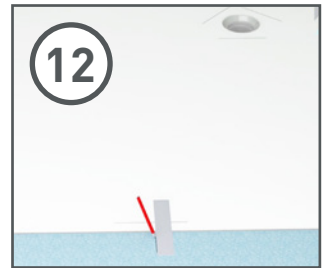

12
Create a check mark across the adjoining edges of two sheets of flooring, this will make alignment easier later on.

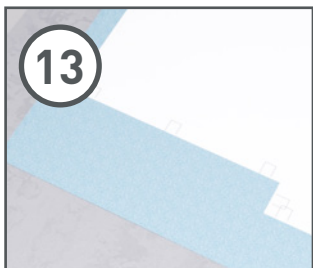

13
Lay the paper on top of the flooring and transfer the marks by setting the T shape to the marks on the paper.

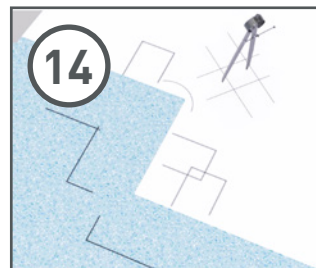

14
Mark down the sides of the T piece for internal corners.

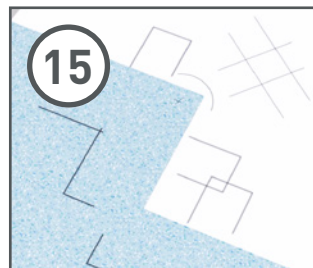

15
Use the dividers to find the bottom point of an external corner. Set the spacing to the check mark made earlier and scribe intersecting arcs to make a cross.

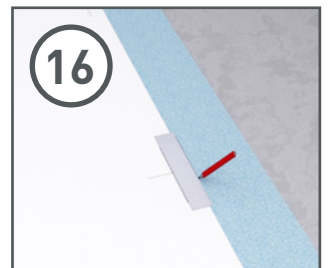

16
Mark across the sheet and include the check mark.

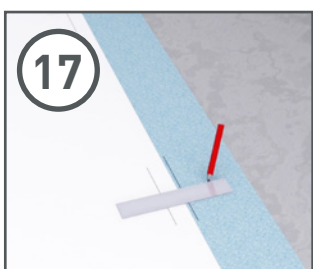

17
Make sure that all marks are transferred to the flooring.



18
Transfer the marks for the drain.

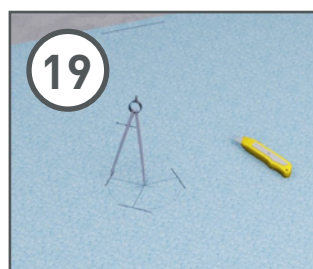

19
Using dividers mark the shape of the drain using the marks made earlier.

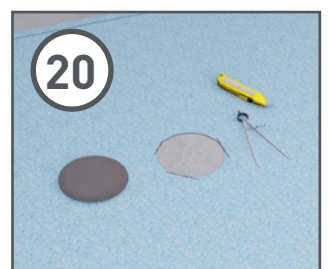

20
Cut out the drain hole.

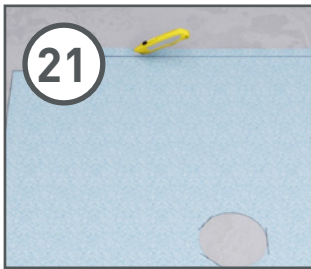

21 Using a straight edge and a knife join all the marks together neatly and trim the flooring.

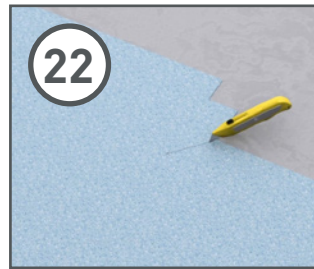

22 Use the crossed over arc marks to set the external corner.

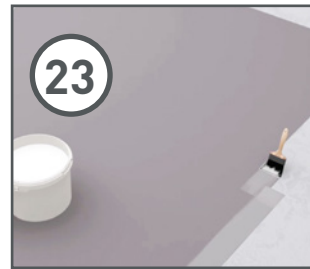

23 Lay the sheet face down and coat the edges that will sit on the coving with pre-mixed reactive adhesive.



24 Brush pre-mixed reactive adhesive on to the walls.



25 With a metal trowel, spread the adhesive onto the floor and coving, use a smaller spatula to apply adhesive round the drain hole.

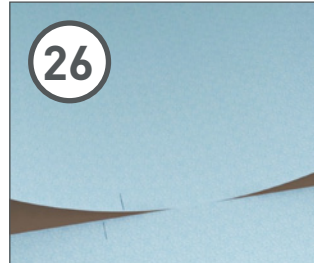

26 Ensure any dust or foreign particles are removed from the underside of the WetFlor® prior to bonding. Carefully place the sheet in position, lining it up using the check marks.

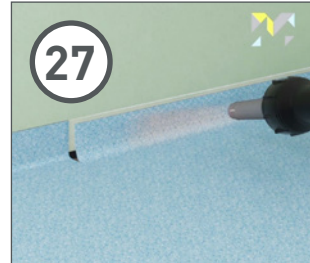

27 A heat gun can be used to warm and soften the vinyl.



28 Use a hand roller along the wall to firmly press the vinyl into the adhesive and create a strong bond.

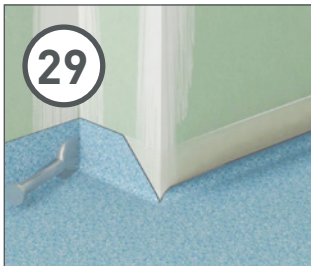

29 Push the flooring edges firmly into the corners.

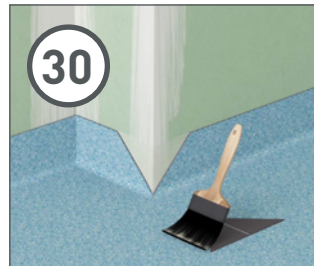

30 Use offcuts to fill in external corners, use heat to soften the vinyl so that it is easy to form tightly around the corner.

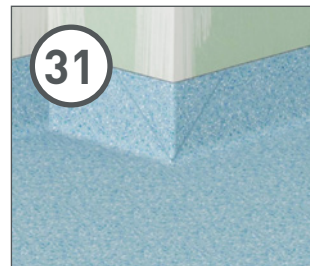

31 External corners should then be welded to ensure the integrity of the flooring.

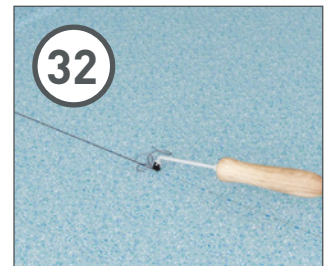

32 Use a grooving tool to groove all joints in the flooring before welding.

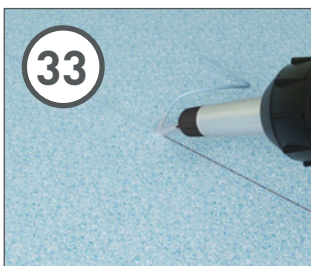

33 Weld the flooring joints using a colour matched welding rod.

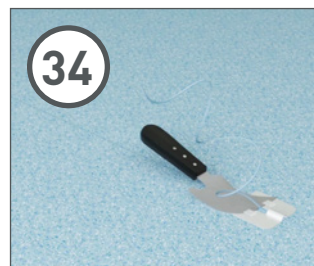

34 Trim the welded joints in two passes using a trim plate or sharp knife.



35 Roll with a 68kg articulated floor roller, firstly in the short direction, then in the long. In corners and other awkward areas, use a hand roller. Ensure that all the sheets are adhered.



→ Roll the whole area thoroughly again, between one and four hours later.

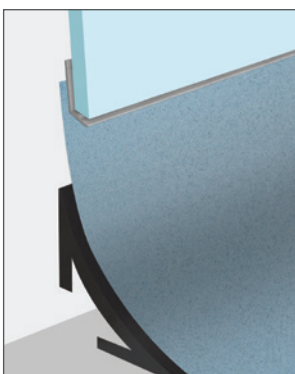

Type X profile used between floor and wall junction, See Multipanel Classic fitting instructions.

Instructions are included with our wall panels or you can download from www.multipanel.co.uk.



Special Circumstances

HIGH TRAFFIC AREAS FITTING WETFLOR® (PRESSURE-SENSITIVE ADHESIVES)

These adhesives are designed to go completely dry prior to laying into and are particularly well suited to dense subfloors where there is difficulty with moisture uptake. They have the advantage of very long open times but, because they are laid into dry, have the disadvantage that the adhesive ridges are not flattened when the vinyl is rolled. To eliminate this disadvantage, we recommend an alternative method of application:

- A. Fold back all the sheets to just over half their length.
 - B. Spread the adhesive with the correct notch trowel. Maintain the correct size of notch at all times. Then roll out the adhesive ridges with a long handled, short pile adhesive roller.
- Note: To maintain the correct spread rate, the adhesive roller should be pre-wetted with adhesive. This will prevent it taking adhesive from the floor.**
- C. Wrap the roller in a polyethylene bag and hang up when not in use. This will prevent it from drying out. It also prevents flats being formed and avoids regular washing out and pre-wetting.
 - D. When the adhesive is completely dry and ready to lay into, it will change from opaque to clear or translucent. The adhesive will be tacky to the touch. It is worth remembering that air flow is the most critical factor in the drying time and not temperature. Electric fans can be used to accelerate the drying time.
 - E. Place a length of 100mm wide polyethylene strip onto the edge of the adhesive adjacent to the fold in the vinyl sheet. This will prevent the sheet sticking to the last 100mm of adhesive.
 - F. Roll the central sheet back into place along the longitudinal line, taking care not to twist the roll or trap air bubbles.

TRAFFICKING OF NEWLY LAID FLOORS

After the vinyl sheet has been installed, only light foot traffic should be allowed for at least 24 hours. Early trafficking may disturb the adhesive bond and weaken it, resulting in the associated problems of tracking, indentation, de-bonding etc. The furniture and bathroom products should only be returned after this time. Where liable to be subject to heavy trafficking, the vinyl should be protected with hardboard or plywood for at least 48 hours.

HOW TO MAINTAIN MULTIPANEL WETFLOR®

- Protect your vinyl floor by covering the legs of furniture with felt protectors. Otherwise, damaging dents that cannot be repaired will scar your floor.
- Remove dust, sand and grit particles. Do this frequently by sweeping or vacuuming your vinyl floor.
- Do not use a vacuum with a beater bar. It may scratch your floor. The attachments that come with your vacuum are useful to clean the edges or to get to hard to reach areas. When sweeping or vacuuming does not remove the dirt, mop the floor with clean warm water.
- Mop the floor thoroughly with fresh water after cleaning. If water alone does not clean the surface, use cleaning products recommended. We recommend mopping with soft soap solution added to water.
- Place non-staining, walk-off mats or rugs at every outside entry to your room. **Think prevention.** This will help keep sand and grit from being tracked on to your floor.
- Be sure to avoid using rubber-backed mats or rugs. They can damage and potentially discolor your floor over a period of time.
- For spots or spills, wipe them up immediately. Also, use a clean cloth to wipe the cleaner onto the floor. Rinse the spot or spill area thoroughly and wipe dry with a clean cloth.
- Avoid using abrasive scrubbing tools. They will leave scratches.

UNDERFLOOR HEATING

WetFlor® can be installed over underfloor heating systems, however it is important to switch off 48 hours prior to floor installation commencing and remains off at least 48 hours after the install is complete. It can then be gradually increased by a few degrees per day to a maximum of 27°C. Whilst the underfloor heating system is off, an alternative heat source should be provided, if required, to ensure the area of install is kept at a constant temperature between 18°C and 27°C.

Warranty

Grant Westfield Ltd offers a reducing 10 year wear warranty that Multipanel® WetFlor® will not wear-out under normal foot traffic. Wear out means the removal of pattern and colours from the floor. In the event of a successful claim under your Multipanel® WetFlor® guarantee we will replace the necessary amount of flooring, but will only cover any claims for consequential costs under exceptional circumstances where a defective roll prohibits ordinary use of the surrounding area, e.g. unable to take a shower.

This guarantee does not cover failure of the product due to:

- Faulty installation
- Incorrect maintenance
- Damage or misuse
- Damage from underfloor heating > 27°C
- Exposure to direct sunlight > 110°f/43°C
- Use of non-recommended adhesive

Prior to installation the following checks should be carried out and any queries reported, as claims of this nature will not be covered:

- If flooring is to be fitted by a tradesman, colours should be approved by the customer
- If flooring has been stored in cold conditions, it must be left to condition at room temperature for 48 hours prior to installation.
- All products have arrived in good condition
- Flaws and defects in vinyl - although unlikely

This guarantee does not confer any rights other than those set out above and claims for consequential loss or damage are excluded.

Grant Westfield Ltd reserve the right to change Multipanel® WetFlor® decor and sizes.

We hope that you are fully satisfied with the Multipanel® product you have purchased and that you will return to Multipanel® for all your wall/floor/ceiling lining requirements.