

# Recycling Bins



# CONTENTS

Nexus® 100 Recycling Bin .....	4-7
Nexus® 100 Cup Bank .....	8-9
Nexus® 100 Duo Recycling Bin .....	9
Nexus® 50 Recycling Bin .....	10-11
Nexus® 30 Recycling Bin .....	12-13
Nexus® 140 Recycling Bin .....	14-15
Eco Nexus® Recycling Bins .....	16-17
Eco Nexus® Cup Bank.....	17
Eco Nexus® Duo Recycling Bins.....	18
Glasdon Recycling Stand .....	18
Mirage™ Recycling Bins .....	19
Vista™ Recycling Bins .....	19
Nexus® Shuttle Food Waste Recycling Bin.....	20-21
Combo™ Catering Waste Bins .....	21
Envoy™ Recycling Bin.....	22-23
Envoy™ Cup Bank.....	24
Nexus® 2.5 Desktop Recycling Bin .....	24
Nexus® 130 Recycling Bin .....	25
Nexus® 130 Trio Recycling Bins .....	25
<b>NEW</b> C-Thru™ Recycling Bin Range.....	26-27
C-Thru™ Trio Recycling Bins .....	27
Orbis™ Recycling Sack Holder .....	28
Glasdon Jubilee™ Outdoor Recycling Bin .....	29
Streamline Jubilee™ Outdoor Recycling Bin .....	29
Nexus® City 240 Food Waste Recycling Bin .....	30-31
Nexus® City 140 Food Waste Recycling Bin .....	30-31
<b>NEW</b> Nexus® City 240 Outdoor Recycling Bin .....	32
<b>NEW</b> Nexus® City 140 Outdoor Recycling Bin .....	32
Gemini™ Outdoor Recycling Bin.....	33
Grampian™ Outdoor Recycling Bin Housing.....	33
Nexus® 200 Outdoor Recycling Bin .....	34-35
Nexus® 360 Outdoor Recycling Bin .....	36-37
Modus™ Housing .....	38
Visage™ Screen System.....	39



## NO OBLIGATION SITE SURVEY

A specially trained Glasdon representative is available on request to provide product demonstrations and carry out a site survey with you, on your premises. They will discuss your particular requirements and recommend the best product solutions from our range. For a no obligation site survey, please telephone our Sales Office on 01253 600410 or e-mail: [sales@glasdon-uk.co.uk](mailto:sales@glasdon-uk.co.uk)



# The sky's the limit for Recycling at Zodiac Aerospace

Zodiac Aerospace is a world leader in aerospace equipment and systems for commercial, regional and business aircraft, as well as helicopters and space applications. Altogether, the Zodiac Aerospace businesses employ 30,000 people worldwide and work with clients throughout the world, offering a comprehensive range of products and services to respond to new challenges in aerospace.



Zodiac Aero Evacuation Systems, subsidiary of Zodiac Aerospace, is a world leader for civil aviation evacuation slides, slides/rafts, life rafts, life vests and helicopter emergency flotation equipment. Zodiac Aero Evacuation Systems take a global approach to sustainable development throughout the facilities, which includes a commitment to reducing waste production and recycling a minimum of 80% within their sites as per corporate goal.

With this commitment to waste reduction and recycling in mind, Zodiac Aero Evacuation Systems contacted Glasdon about Recycling Bins. Nexus® 140 and Nexus 100 Recycling Bins were ordered for the collection of general waste, mixed recyclables and compost for the cafeteria.

These products have made a positive impact on the recycling at Zodiac Aero Evacuation Systems and a further order has been placed.

It's great to see Zodiac Aero Evacuation Systems striving to reduce their environmental impact, not just within the organisation but for air transport as a whole. By encouraging recycling across their sites, this simple act, if committed to by everyone, could make a massive difference to our world's resources.



# Putting Recycling into Practice at Honda



Honda Motor Co Ltd is a Japanese public multinational corporation primarily known as a manufacturer of automobiles, motorcycles and power equipment. Honda focus on developing low emission vehicles to sustain their environmentally-friendly targets within the business. Protecting the environment is considered in all activities from analysing engines to general office activities.

Glasdon supplied a series of Nexus® 50 Recycling Bins to Honda's head office in Slough, forming a small recycling area within their office to separate waste – the aim being to reduce the amount of waste being taken to landfill to zero!

Glasdon recycling bins can be personalised with your company name and/or logo. Illustrations are provided to any customer to see how their product will look before purchasing – completely free of charge!



# Nexus® 100 Recycling Bin

The exciting Nexus 100 is a stylish and modern recycling unit designed to co-ordinate with the Nexus range and enhance office environments. The unit offers excellent flexibility to match diverse recycling requirements, and can be sited side-by-side or back-to-back to create a recycling centre.



## Specifications

### Design Features

- Sack Retention System.
- Pivoting Lid and Lid Stay.
- Key-lock (Confidential Paper Unit Only).
- Heavy Duty Wheels on Door.
- Drip Tray.
- Non Marking Durapol®\* material Feet.
- Standard or Recycle Now Graphic Options.

### Optional Extras

- Key-lock (for Paper, Bottles, Cans and Non Recyclables Units) (Locks can be retro-fitted).
- Metal Liner.
- Sign Kit.
- Rear Wheels (x 2).
- Combined Folding Sign and Wheel Kit.
- Reservoir Side Pod or Waste Bin Side Pod.
- Nexus Cup Bank (see page 8).
- Nexus Duo split waste stream for cans and bottles (see page 9).
- General Waste Flap Kit.
- Multi Bin Connector Kit.
- Oxo-Degradable Sacks.
- Woven Polypropylene Sack.
- Glasdon Recycling Stand (see page 18).

### Dimensions

Width: 544mm  
 (width c/w one side pod: 677mm, width c/w two side pods: 810mm)  
 Depth: 397mm  
 Height: 1007mm  
 Capacity: 100 litres  
 Amount of A4 Paper: 30kg  
 Amount of 330ml Cans: 130  
 Amount of 500ml Plastic Bottles: 95  
 Weight: 12kg

### Materials

Bin Body, Door, Lid and Apertures: Duratec™\*\*\* material  
 Sack Retention System: Durapol

## Sack Retention System

The sack retention band can be lifted up to allow light waste such as cans or plastic bottles to be removed without removing the door.



## Secure Key-Lock for Confidential Paper Unit

A keyed push lock is situated at the front of the unit for ease of access. The plunger locates into the oval hole in the door to secure the unit (can be provided as an optional extra on paper, can, bottle and non-recyclable waste units).



BS 8470:2006  
 Support your waste management contractor's compliance with BS 8470:2006  
 - Code of Practice for the Secure Destruction of Confidential Material.  
 "Confidential material to be collected should remain protected from unauthorised access from the point of collection to complete destruction."

\*Durapol® material is a polymer formulated to withstand extremes of temperature and is impact-tested in our Quality Assurance Laboratory as part of our BS EN ISO 9001:2008 test procedure.  
 Durapol® material will not chip or rust, is easy to clean and never needs painting.

\*\*Duratec™ material has been specially created for use in internal environments. In addition to its attractive appearance it offers a blend of toughness, rigidity and dimensional stability.



### Paper Bin

The large 100 litre capacity can hold up to 30kg of waste paper. (Frequent emptying is recommended to avoid accumulation of excessive weight.)



### Drip Tray

Positioned in the base of the door, the drip tray will collect any waste liquid, which is deposited in the unit, preventing it from spilling out on to the floor. The drip tray can be easily removed for emptying and cleaning.

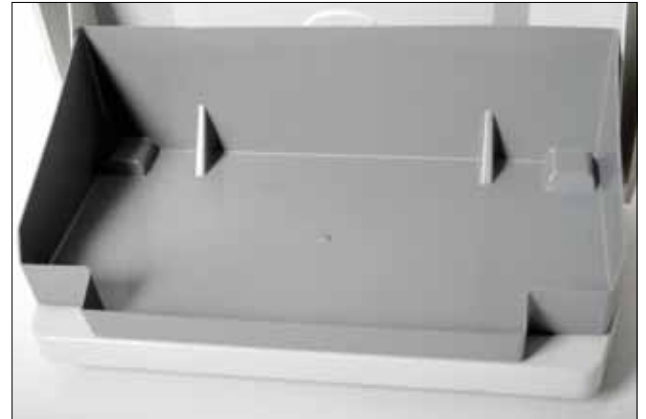

### Rear Wheels

Nexus 100 can be supplied with two rear wheels, making the whole unit easy to manoeuvre.

### Easy and Safe to Empty

Lift the lid to its open position, then pivot open the door. For lighter loads such as cans and plastic bottles simply lift the sack retention band up and remove the sack (as shown opposite). For heavier waste such as paper, the door can be removed from the unit and tilted onto the wheels attached to the base, ready for transporting the heavy waste a short distance to a collection area. With the door away from the unit, the sack can then be removed with minimal lifting.



Wheels are attached to the base of the door to aid easy emptying.



# Nexus<sup>®</sup> 100 Recycling Bin Colour, Aperture & Graphic Options

Colour-coded apertures and clear graphics make Nexus 100 easily identifiable for effective use. If you require other colour/aperture combinations than those illustrated below, please contact our sales office on: 01253 600410.

## Select your choice of colour and aperture

### Paper Apertures



Pastel Green  
Pastel Blue

### Cans & Bottles Apertures



Red  
Orange  
Yellow  
Mid Grey  
Lime Green

### Duo



Pastel Grey  
Grey/Red  
Lime Green/Black

### Open Top



Pastel Green  
Pastel Blue  
Red  
Orange  
Yellow  
Black  
Mid Grey  
Lime Green

### Flip Lid



Pastel Green  
Pastel Blue  
Red  
Orange  
Yellow  
Black  
Mid Grey  
Lime Green

## Select from Standard Graphic Options with or without text

### Standard Graphic Options



### Standard Graphic Options and Text



## Recycle Now Graphic Options are also available in these colours

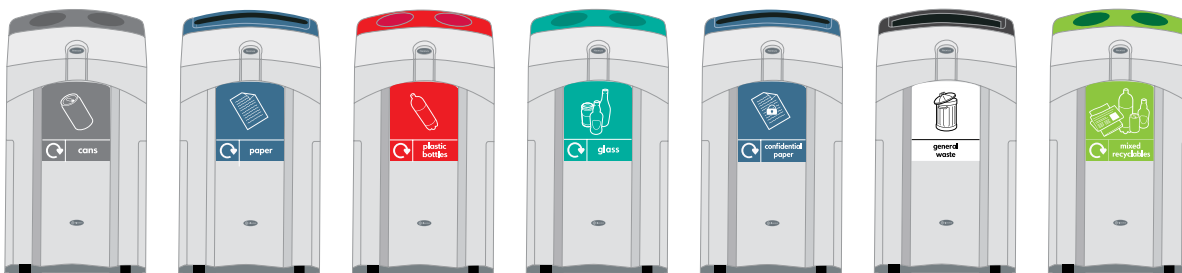

Grey  
Blue  
Red  
Pastel Green  
Blue  
Black  
Lime Green



## Optional Extras

### Sign Kit

A sign kit is available, which is fitted to the rear of the unit to provide additional signage at eye level and will help promote the recycling message. The clear sign front pivots to allow either a standard Glasdon sign or your own A4 sign to be inserted and replaced when required.

A combined folding sign and wheel kit is available to allow Nexus 100 to be easily moved.

#### Standard Graphic Options for Sign Kits



#### Recycle Now Graphics Options for Sign Kits



As well as the standard recycling logo options shown, we are also able to offer a wider range of Recycle Now Graphics, to show your company's commitment to helping Britain become a recycling nation.



### General Waste Flap

A General Waste Flap is available as an optional extra, to hide any unsightly waste and help contain any odours from within the bin. Simply lift the flap using the moulded-in finger grip. Available in Black and Mid Grey.



### Side Pods

An additional 8ltr side pod is available on one or both sides of the Nexus 100 unit. This can be either an 8ltr reservoir for the collection of waste liquids from cans or bottles before depositing in the unit, an 8ltr waste pod for the collection of small non-recyclable items, or an additional recycling bin for items such as CDs and DVDs, mobile phones or bottle tops. A standard range of graphics are available and the trim moulding on the pod is available in Red, Orange, Yellow, Coffee and Mid Grey.

#### Reservoir Funnel & Trim Colours



#### Standard Side Pod Graphic Options

Examples only - any logo and trim colour options can be attached to all Nexus 100 models.

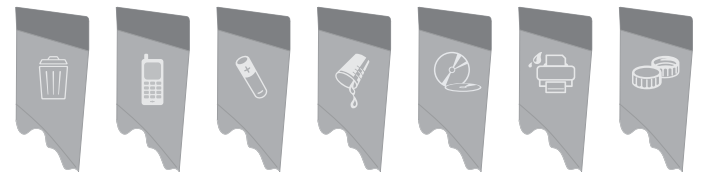

#### Recycle Now Colour Options for Side Pod

It is recommended that grey side pod trims are used when Recycle Now coloured side pod logos are required.



# Nexus® 100 Cup Bank

The Nexus 100 Cup Bank is a stylishly designed unit to collect used drinks cups for recycling and store waste liquid separately. The Nexus 100 Cup Bank co-ordinates with the Nexus 100 units to create a complete range of recycling bins for any environment.

The four cup apertures on top of the unit accept cups up to 98mm diameter, therefore allowing the collection of the majority of sizes of disposable cups. The unique stacker moulding on the inside of the door and body will collect the cups neatly and compactly within a clear plastic sack. Nexus 100 Cup Bank is supplied with an 8ltr reservoir side pod as standard, to collect waste liquid prior to cup disposal.

## Standard Graphic Option



## Recycle Now Graphic Option



(Additional side pod available as optional extra)



## Specifications

### Design Features

- 4 x 98mm Cup Apertures.
- 8ltr Side Pod Reservoir.
- Removable Reservoir Funnel Moulding.
- Split Stacking Tubes.
- Sack Retention System.
- Pivoting Lid and Lid Stay.
- Removable Door.
- Heavy Duty Wheels on Door.
- Drip Tray.
- Non Marking Durapol®\*\* material Feet.
- Standard Recycling Logo or Recycle Now Graphic (to co-ordinate with other Recycle Now bins).

### Optional Extras

- Sign Kit.
- Extra Reservoir Side Pod or Waste Bin Side Pod.
- 76mm diameter Cup Tubes – helps prevent cross contamination of vending cups for recycling.
- Multi Bin Connector Kit.

### Dimensions

Width: 677mm (width c/w two side pods: 810mm)  
Depth: 397mm  
Height: 1007mm  
Capacity: 100 litres  
Amount of cups:  
Ø 70 x 90mm plastic cups: 152 per tube = 608 total  
Ø 88 x 110mm wax paper cups: 80 per tube = 320 total  
Weight: 17.5kg

### Materials

Bin Body, Door, Lid and Apertures: Duratec™\*\*\* material  
Sack Retention System and Stacking Tubes: Durapol

### Colours

Bin Door & Lid: Pastel Grey.  
Bin Body & Side Pod: Mid Grey.  
Aperture and Side Pod Trim: Coffee.

## 8ltr Reservoir and Funnel Moulding

The 8ltr reservoir pod is attached to the right hand side of the unit as standard. The reservoir funnel moulding is specially designed to prevent splash back and is removable to allow access to the reservoir. A max level indicator shows when the reservoir requires emptying.

A spout on the reservoir allows the contents to be poured out simply and with a large opening the reservoir can be easily cleaned.



## Sack Retention System

Internally the stacking tubes are split, with one half attached to the door and the other half attached to the unit body, to allow a sack to be inserted simply. The door then pivots back to clamp the sack within the stacker tubes and is held in place with the sack retention lugs.



## Drip Tray

Positioned in the base of the door, the drip tray will collect any waste liquid which is deposited in the unit, preventing it from spilling out on to the floor. The drip tray can be removed for emptying and cleaning.



\*Durapol® material is a polymer formulated to withstand extremes of temperature and is impact-tested in our Quality Assurance Laboratory as part of our BS EN ISO 9001:2008 test procedure.  
Durapol® material will not chip or rust, is easy to clean and never needs painting.

\*\*Duratec™ material has been specially created for use in internal environments. In addition to its attractive appearance it offers a blend of toughness, rigidity and dimensional stability.



### Easy to Empty

Lift the lid to its open position, and then pivot open the door. Remove the sack and its contents of neatly stacked cups for disposal. The door can also be completely removed from the unit for cleaning or the removal and cleaning of the drip tray. The Reservoir Side Pod Lid moulding is removed by lifting at the finger grip, the reservoir can then be lifted out using the handle and easily carried to pour away its contents.



### Optional Extras

#### Additional Side Pods

An additional 8ltr side pod is available on the left side of the Nexus 100 Cup Bank. This can be an extra 8ltr reservoir for the collection of waste liquids or an 8ltr waste pod. A standard range of graphics are available and the trim moulding on the pod is available in Coffee. The additional reservoir provides a 16ltr capacity for high volume areas. The 8ltr waste pod is ideal for the collection of teabags or stirrers etc.



#### Graphic Options for Sign Kit

With Standard Recycling Logo



Plastic Cups Only

With Recycle Now Graphic



## Nexus<sup>®</sup> 100 Duo Recycling Bin

Ideal where more than one stream is required and space is limited.



Cans/Plastic Bottles or Mixed Recyclables/General Waste are available with a split coloured aperture.



All other options are available with a pastel grey aperture and split colour lid sticker.



Other split coloured apertures can be supplied, subject to a minimum order quantity. Please contact our sales office for details.



# Nexus<sup>®</sup> 50 Recycling Bin

The sleek, contemporary design of the Nexus 50 units will complement any environment, helping to encourage the efficient collection and segregation of recyclable waste.



The units provide a variety of siting options, including siting back-to-back, in a row or as a bank of four.

## Specifications

### Design Features

- Sack Retention System.
- Removable Door.
- Key-lock (Confidential Paper Unit Only).
- Non marking Durapol<sup>®</sup>\*\* feet.
- Standard or Recycle Now Graphic Options.

### Optional Extras

- Key-lock (for Paper, Bottle, Can and Non Recyclables Units) (Locks can be retro-fitted).
- Post Mounted Sign Kit.
- Wall Mounting Sign Kit.
- A4 Moulded Portrait Sign Kit.
- Rear Pod.
- General Waste Flap.
- Connector Kit.
- Castors.
- Clear plastic sacks, size: 406mm (16") diameter x 990mm.
- Nexus 50 Cup Bank model available.
- Glasdon Recycling Stand (see page 18).

### Dimensions

Width:	295mm	Capacity:	50 litres
Depth:	510mm	Weight:	4.2kg
Height:	680mm		

### Materials

Bin Body and Door: Duratec<sup>™</sup>\*\* material  
Sack Retention System: Durapol

BS 8470:2006  
Support your waste management contractor's compliance with BS 8470:2006 - Code of Practice for the Secure Destruction of Confidential Material. "Confidential material to be collected should remain protected from unauthorised access from the point of collection to complete destruction."

## Holds 18kg of Waste Paper

The compact units have a deceptively large 50 litre capacity. The confidential and paper units have an aperture which conceals the contents and allows paper to be stacked as it is placed in the bin. This enables the bin to hold up to 18kg of waste paper!

The rectangular shape of the bin and sloped aperture allows over 3000 sheets of paper to fit neatly into Nexus 50.



NOT Like This



Neatly Like This

## Easy to Empty, Easy to Clean

Nexus 50 has a front-opening, removable door. This allows easy access to the contents and reduces manual handling problems during emptying as minimal lifting is required. The unit is fitted with a neat sack retention system, which accepts various sizes of sack from 14" to 18" diameter (356mm to 458mm diameter), to cater for different requirements.

Manufactured from self-coloured Duratec material. The smooth interior and exterior contours allow easy cleaning and add to the attractive, modern appearance of Nexus 50.



<sup>\*</sup>Durapol<sup>®</sup> material is a polymer formulated to withstand extremes of temperature and is impact-tested in our Quality Assurance Laboratory as part of our BS EN ISO 9001:2008 test procedure. Durapol<sup>®</sup> material will not chip or rust, is easy to clean and never needs painting.

<sup>\*\*</sup>Duratec<sup>™</sup> material has been specially created for use in internal environments. In addition to its attractive appearance it offers a blend of toughness, rigidity and dimensional stability.



# Nexus<sup>®</sup> 50 Recycling Bin Colour, Aperture & Graphic Options

Colour-coded apertures and clear graphics make the units easily identifiable and easy to use. If you require other colour/aperture combinations than those illustrated below, please contact our sales office on: 01253 600410.

## Select your choice of colour and aperture

### Paper Apertures

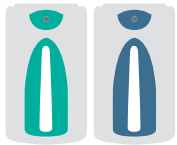

Pastel Green  
Pastel Blue

### Cans & Bottles Apertures

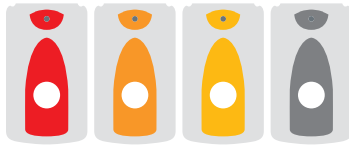

Red  
Orange  
Yellow  
Mid Grey

### Open Top

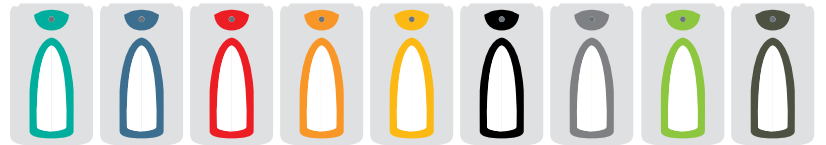

Pastel Green  
Pastel Blue  
Red  
Orange  
Yellow  
Black  
Mid Grey  
Lime Green  
Brown (Cup Bank Only)

## Select from Standard Graphic Options

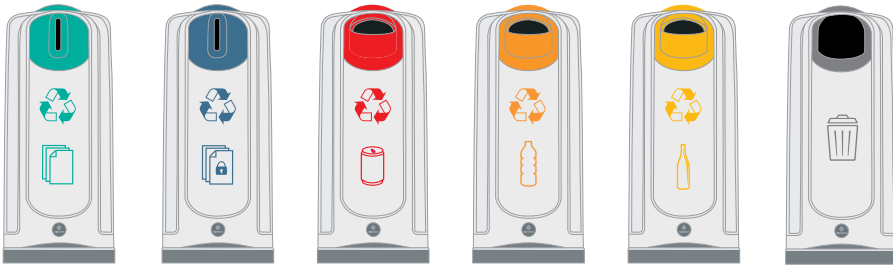

## Recycle Now Graphic Options are also available in these colours



Grey  
Blue  
Red  
Blue  
Black  
Lime Green†



## General Waste Flap

A General Waste Flap is available as an optional extra, to hide any unsightly waste and help contain any odours from within the bin. (Only available in Mid Grey)

## Optional Extras

### Rear Pods and Cup Bank

Rear Pods and Cup Bank are available for the Nexus 50. This can be either an 8ltr reservoir for the collection of waste liquids from cans or bottles before depositing in the unit, or an additional 8ltr recycling bin for items such as bottle tops or any other small items.

For Rear Pod graphics and colour options please see Nexus 100 side pod information on page 7.



### Sign Kits

Three sign kit options are available for the Nexus 50 – a post mounted sign, a new A4 moulded portrait sign, which both attach to Nexus 50 and a wall mounting sign. The sign kits help create a clearly identifiable recycling point in any location, as well as providing an easy and effective way of personalising the product. Sign designs can be specified at point of order.

### Standard Graphic Options for Sign Kits



### Recycle Now Graphic Options for Sign Kits



†Mixed Recyclables (Lime Green or Orange).



# Nexus® 30 Recycling Bin

The compact design of the Nexus 30 recycling bins make them ideal for locations where space is limited, as they can be used for collecting smaller waste streams such as office food waste and batteries.



## Nexus® 30 Deluxe Recycling Bin

The stylish Nexus 30 Deluxe model has a metallic silver finish, which will enhance prestigious office environments, meeting rooms and reception areas.



## Specifications

### Design Features

- Moulded-in Sack Retention System.
- Key-lock (Confidential Paper Unit Only).
- Standard or Recycle Now Graphic Options.
- C-Thru Nexus® 30 model available.
- C-Thru Nexus® 30 Battery Bin model available.
- Nexus® 30 Deluxe model available.

### Optional Extras

- Key-lock (for Paper, Bottle, Can and Non Recyclables Units).
- Food/General Waste Flip Lid.
- Pivoting Lid.
- A4 Sign Kit.
- Handle.
- Wall Mounting Kit.

### Dimensions

Width: 335mm Depth: 308mm Height: 626mm

Capacity: 30 litres

Amount of A4 Paper: 6kg Amount of 330ml Cans: 35

Amount of 500ml Plastic Bottles: 25 Weight: 2.8kg

### Material

Bin Body and Lid: Duratec™\*\* material

### Colours

#### Nexus 30:

Bin Body: Pastel Grey. Lid: Mid Grey.

#### C-Thru Nexus 30:

Bin Body: Clear. Lid: Mid Grey.

#### Nexus 30 Deluxe:

Bin Body and Lid: Metallic Silver.

### Apertures:

Confidential Paper Unit/Paper Unit: Pastel Blue, Pastel Green, Yellow.

Cans/Bottles Unit: Red, Orange, Yellow, Mid Grey, Magenta, Pastel Green.

General Waste Unit: Pastel Blue, Pastel Green, Red, Orange, Yellow, Black, Mid Grey, Lime Green, Magenta, Green.

Mixed Recyclables Unit: Lime Green, Orange.

Flip Lid: Pastel Blue, Pastel Green, Red, Orange, Yellow, Black, Mid Grey, Lime Green, Magenta, Green.

Battery Unit: Magenta.

Pivoting Lid: Mid Grey.

## Moulded-in Sack Retention System



Ensures the sack remains secure and neat within the bin body.



## C-Thru Nexus® 30 Battery Bin

C-Thru Nexus 30 Battery Bin is a small capacity unit with a clear body, which makes it ideal for collecting batteries. The unit is supplied with a Battery Weight Warning Graphic adhered to both sides of the bin body to indicate when the bin weighs approximately 25kg, so the operator can empty the unit safely. A handle is also supplied to the back of the bin to help decant the batteries when the bin needs emptying.



\*\*Duratec™ material has been specially created for use in internal environments. In addition to its attractive appearance it offers a blend of toughness, rigidity and dimensional stability.

# Nexus<sup>®</sup> 30 Recycling Bin Colour, Aperture & Graphic Options

Colour-coded apertures and clear graphics make the units easily identifiable and easy to use. If you require other colour/aperture combinations than those illustrated below, please contact our sales office on: 01253 600410.

## Select your choice of colour and aperture

### Paper Apertures

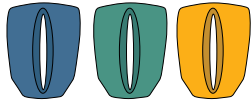

Pastel Blue Pastel Green Yellow

### Pivoting Lid



Mid Grey

### Open Top



Pastel Blue Pastel Green Red Orange Yellow Black Mid Grey Lime Green Magenta Green

### Cans & Bottles Apertures

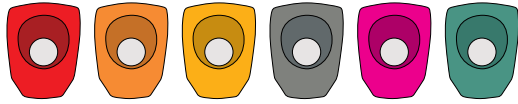

Red Orange Yellow Mid Grey Magenta Pastel Green

### Flip Lid

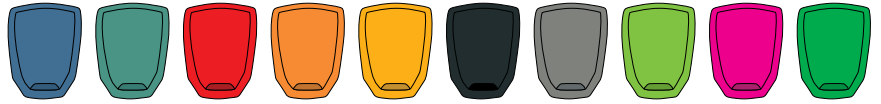

Pastel Blue Pastel Green Red Orange Yellow Black Mid Grey Lime Green Magenta Green

## Select from Standard Graphic Options



## Recycle Now Graphic Options are also available in these colours



## Optional Extras

### Flip Lid

The flip lid hides any unsightly waste and helps to contain any odours from within the bin. The lid is quick, easy and hygienic to use.



### Handle

Enables the operator to lift the entire bin and decant waste for ease of use and speed of emptying.



### Pivoting Lid and Lid Stay

The entire lid can be opened to enable quick and easy access to the sack for emptying and replacing sack. The lid hides any unsightly waste and helps contain any odours from within the bin.



### A4 Sign Kit

Increases visibility and awareness of recycling collection. Sign designs can be specified at point of order.

#### Standard Graphic Options for Sign Kits



### Wall Mounting Kit

Permanent and lift-off wall mounting kits are available.



#### Recycle Now Graphic Options for Sign Kits





# Nexus<sup>®</sup> 140 Recycling Bin

The Nexus 140 range of internal recycling bins has been designed for areas where a large capacity container is required for collecting recyclable waste, yet a modern, stylish appearance is also desired. Nexus 140 models are available, with clear, easily-identifiable graphics and colour-coded apertures and provide a variety of siting options.



## Confidential Paper Bin

Nexus 140 Confidential Paper Bin is supplied with a key-lock as standard (a lock is available with other units as an optional extra). When no lock is fitted, concealed latches maintain an element of security, without the need for a key.



BS 8470:2006  
Support your waste management contractor's compliance with BS 8470:2006 - Code of Practice for the Secure Destruction of Confidential Material. "Confidential material to be collected should remain protected from unauthorised access from the point of collection to complete destruction."

## Specifications

### Design Features

- Sack Retention System.
- Removable Door.
- Key-Lock (Confidential Paper Unit Only).
- Moulded Skirting Board Recess.
- Standard Graphic Options.

### Optional Extras

- Rear Wheels and Handle.
- Key-lock (for Paper, Bottle, Can and Non Recyclables Units).
- Recycle Now Graphic Options.
- Post Mounted Sign Kit.
- Wall Mounting Sign Kit.
- Clear Plastic Sacks, size: 508mm (20") diameter x 1143mm.
- Woven Polypropylene Liner c/w velcro strap.
- Glasdon Recycling Stand (see page 18).

### Dimensions

Width: 595mm  
Depth: 606mm  
Height: 1195mm  
Capacity: 140 litres  
Weight: 22kg

### Materials

Bin Body and Door: Durapol<sup>®</sup>\* material  
Sack Retention System: Stainless Steel

### Body/Door Colours

Nexus 140 is supplied as standard in Cool Light Grey, other colour combinations are available on request.



## Paper Bin

The large 140 litre capacity can hold up to 50kg of waste paper. (Frequent emptying is recommended to avoid accumulation of excessive weight.)



## Can and Bottle Bin

Nexus 140 Recycling Bin takes 500ml bottles as standard. Larger aperture sizes can be ordered, please telephone 01253 600410 for more information. Each bin can hold up to 100 x 500ml bottles or 180 x 330ml cans.



## Combo Delta<sup>™</sup> Bin

Combo Delta bin has a large funnel aperture and can be used for the collection of recyclable waste.

Please telephone our Sales Office for more information.



\*Durapol<sup>®</sup> material is a polymer formulated to withstand extremes of temperature and is impact-tested in our Quality Assurance Laboratory as part of our BS EN ISO 9001:2008 test procedure. Durapol<sup>®</sup> material will not chip or rust, is easy to clean and never needs painting.

# Nexus<sup>®</sup> 140 Recycling Bin Colour, Aperture & Graphic Options

If you require other colour/aperture combinations than those illustrated below, please contact our sales office on: 01253 600410.

## Select your choice of colour and aperture

### Paper Apertures

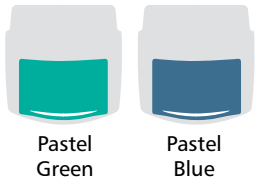

### Cans & Bottles Apertures



### Open Top



## Plain Swing Top - ideal for use when recycling larger items

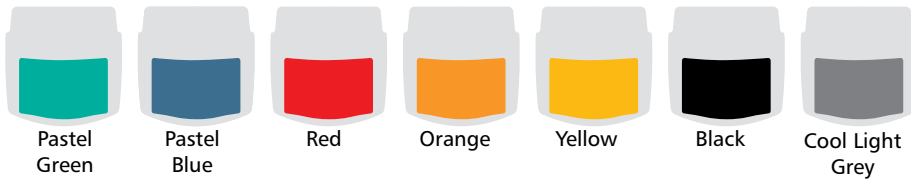

## Select from Standard Graphic Options

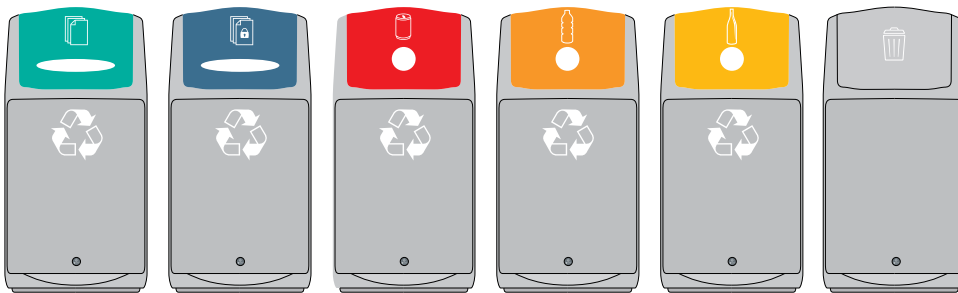

## Recycle Now Graphic Options are also available in these colours

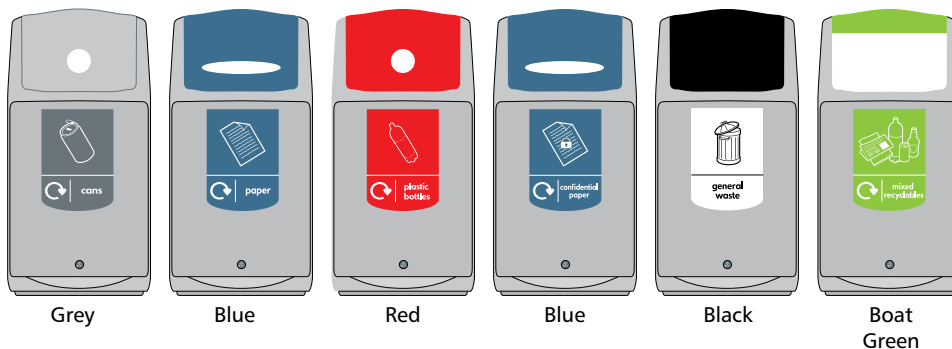

## Optional Extras

### Post-Mounted or Wall-Mounting Signs

Post-mounted signs which attach to Nexus 140 or wall mounting signs are available to help promote the recycling message. The sign kits help create a clearly identifiable recycling point in any location as well as providing an easy and effective way of personalising the product. Sign designs can be specified at point of order.

### Standard Graphic Options for Sign Kits



### Recycle Now Graphics Options for Sign Kits



## Easy to Empty, Easy to Clean

The large, front-opening, removable door allows thorough cleaning and minimises the need to lift sacks during emptying, helping to reduce manual handling concerns. A neat sack retention system keeps the sack in place within the bin during use. A new, reusable woven polypropylene liner is now available which is ideal for collecting heavy waste including glass and paper.

The units are available with optional rear wheels and a handle to allow easy movement of the bin when full.



# Eco Nexus® Recycling Bins

The economical Eco Nexus recycling bins are available as a 60 litre or 85 litre capacity unit. The units take up minimal space, which allows flexibility of siting (as shown in the photographs). Vibrant coloured lids with a choice of aperture options are available to encourage correct recycling usage.



85 Litre Model



60 Litre Model

## Specifications

### Design Features

- Available as a 60 litre or 85 litre capacity unit.
- Range of Recycling Lids available with a choice of colour/aperture options.
- Handles on the lid and bin body to enable easy removal of the lid for emptying the bin.
- Integral Sack Retention System secures the sack in position neatly within the bin. The lid clamps the sack in position and hides the sack, creating a tidy finish.
- Key-Lock (Confidential Paper Unit Only).
- Standard or Recycle Now Graphic Options available for the front or the side of the bin.
- Eco Nexus® Cup Bank model available.

### Optional Extras

- A4 Sign Kit.
- Key-Lock (for Paper, Bottle, Can and Non Recyclables Units).
- Food/General Waste Flip Lid.
- Wheel Kit.
- Glasdon Recycling Stand (see page 18).

### Dimensions

	60 Litre Model	85 Litre Model
Width (with lid):	527mm	527mm
Depth:	343mm	343mm
Height:	677mm	886mm
Capacity:	60 litres	85 litres

### Material

Eco Nexus 60 Bin Body: Durapol®\* material

Eco Nexus 85 Bin Body: Durapol

### Colours

**Bin Body:** Mid Grey.

**Lids:** Confidential Paper Unit/Paper Unit: Pastel Blue, Pastel Green.

Cans/Bottles Unit: Red, Orange, Yellow, Mid Grey, Pastel Green.

General Waste Unit: Pastel Blue, Pastel Green, Red, Orange, Yellow, Black, Mid Grey, Lime Green, Magenta, Green.

Mixed Recyclables Unit: Lime Green, Orange.

Flip Lid: Pastel Blue, Pastel Green, Red, Orange, Yellow, Black, Mid Grey, Lime Green, Magenta, Green.

Eco Nexus Cup Bank: Brown.

## Optional Extras

### Flip Lid

The flip lid hides any unsightly waste and helps to contain any odours from within the bin. The lid is quick, easy and hygienic to use.



### Wheel Kit

The snap-fit wheel kit is quick and easy for the user to assemble, making the bin easy to manoeuvre even when full.



\*Durapol® material is a polymer formulated to withstand extremes of temperature and is impact-tested in our Quality Assurance Laboratory as part of our BS EN ISO 9001:2008 test procedure. Durapol® material will not chip or rust, is easy to clean and never needs painting.



# Eco Nexus® Recycling Colour, Aperture & Graphic Options

Colour-coded apertures and clear graphics make the units easily identifiable and easy to use. If you require other colour/aperture combinations than those illustrated below, please contact our sales office on: 01253 600410.

## Select your choice of colour and aperture

### Paper Apertures



Pastel Blue Pastel Green

### Mixed Recyclables

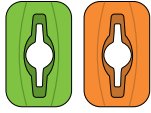

Lime Green Orange

### Cans & Bottles Apertures

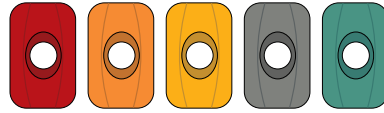

Red Orange Yellow Mid Grey Pastel Green

### Open Top



Pastel Blue Pastel Green Red Orange Yellow Black Mid Grey Lime Green Magenta Green

### Flip Lid

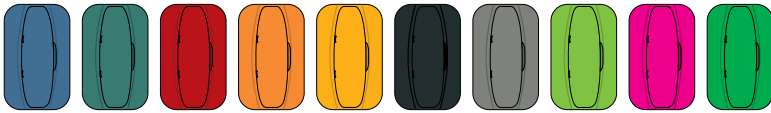

Pastel Blue Pastel Green Red Orange Yellow Black Mid Grey Lime Green Magenta Green

## Optional Extras

### A4 Sign Kit

Versatile A4 Sign Kit can be positioned on the back or the side of the bin, depending on the positioning of the bin. The Sign Kit helps to create a clearly identifiable recycling point in any location, as well as providing an easy and effective way of personalising the products. Sign designs can be specified at point of order.

### Standard Graphic Options for Sign Kits



### Recycle Now Graphic Options for Sign Kits



## Select from Standard Graphic Options



## Recycle Now Graphic Options are also available in these colours



# Eco Nexus® Cup Bank



The Eco Nexus Cup Bank collects used cups for recycling and stores waste liquid separately. The Eco Nexus Cup Bank co-ordinates with the Eco Nexus units to create a complete recycling bin range.



### Standard Lid

The Eco Nexus Cup Bank lid incorporates a reservoir to collect waste liquid prior to cup disposal, and an aperture to deposit disposable cups.

### Reservoir Location Points

Quick and easy to empty/replace reservoir.



## Recycling Graphics and A4 Signs

### Recycle Now Graphic Options



### Standard Graphic Options



# Eco Nexus® Duo Recycling Bins

Eco Nexus Duo is available as a 70/30% or 50/50% split mixed recyclables and general waste bin. Available as either a 60 litre or 85 litre capacity unit.



Eco Nexus Duo 60 litre with a 70/30 split lid



Eco Nexus Duo 85 litre with a 70/30 split lid

## Select your choice of aperture



50/50 split lid.

70/30 split lid.

Eco Nexus Duo can be supplied with graphics for any recycling stream combination.

## Specifications

### Design Features

- Available as a 60 litre or 85 litre capacity unit.
- Available with a 70/30 split lid or 50/50 split lid for mixed recyclables and general waste.
- Integrated Sack Retention System secures both sacks within bin.
- Hinged lid ensures correct aperture orientation, and simplifies emptying procedure.

### Optional Extras

- A4 Sign Kit.
- Wheel Kit.
- Glasdon Recycling Stand (see below).

### Dimensions

	60 Litre Model	85 Litre Model
Width:	527mm	527mm
Depth:	343mm	343mm
Height:	677mm	886mm
Capacity:	60 litres	85 litres

### Materials

Bin Body: Durapol®\* material (contains recycled material)  
Bin Lid: 100% recycled Duratec™\*\* Material

### Colours

Bin Body: Mid Grey.  
Bin Lid: Black.

# Glasdon Recycling Stand

Glasdon Recycling Stand is a robust and durable stand complete with clearly identifiable signage to help create a multiple stream recycling point.

## Specifications

### Design Features

- Sites two to three indoor recycling bins.
- Steel frame with Armortec®# coating.
- Lightweight and easy to manoeuvre.
- Simple and quick assembly.
- Large sign face helps create clearly identifiable graphics.
- Extremely robust Ecoboard™### material base allows for permanent fixing of recycling bins.
- Rubber feet raise the Recycling Stand off the ground to protect the framework and flooring.
- Any Standard Graphic or Recycle Now Graphic Options are available.

### Optional Extras

- Frame Extension Inserts – to make the station suitable for taller bins.
- Magnetic signage - to allow for flexible sign options.

### Dimensions

Base Width:	1280mm
Base Depth:	780mm
Height to bottom of sign:	1090mm
Overall Height:	1530mm
Overall Height (with extension inserts):	1680mm

### Materials

Frame: Steel with Armortec coating  
Signage area: Steel with Armortec coating  
Base: Ecoboard

### Colours

Frame: Anthracite Grey  
Ecoboard base: Dark Grey



Glasdon Recycling Stand with two C-Thru™ Recycling Bins

## Recycling Stand Examples

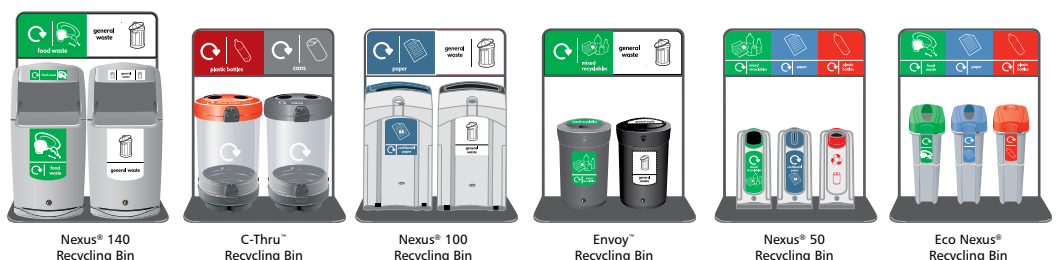

\*Durapol® material is a polymer formulated to withstand extremes of temperature and is impact-tested in our Quality Assurance Laboratory as part of our BS EN ISO 9001:2008 test procedure. Durapol® material will not chip or rust, is easy to clean and never needs painting.

\*\*Duratec™ material has been specially created for use in internal environments. In addition to its attractive appearance it offers a blend of toughness, rigidity and dimensional stability.

###Armortec® corrosion resistant coating is specially formulated to extend the life of Glasdon metal products and components used externally.

####Ecoboard™ material is manufactured using a combination of virgin polymer and post consumer plastic waste to create a very robust and strong panel. Ecoboard will not chip or rust, is easy to clean and never needs painting.

# Mirage™ Recycling Bins

Mirage recycling bins have a modern, metallic silver finish and sleek, space-saving design. Mirage is available as a 60 litre or 80 litre capacity unit, with a choice of aperture options for the collection of paper or a general waste handle.

## Specifications

### Design Features

- Choice of aperture options:-
  - Paper Aperture.
  - General Waste Handle.
- Sack Retaining Feature.
- Metallic Silver Finish will not dent or rust.
- Unit Connector Kit.

### Optional Extras

- Personalisation.
- Plastic sacks for use with sack retaining feature.

### Dimensions

	60 Litre Model	80 Litre Model
Width:	290mm	290mm
Depth:	490mm	490mm
Height:	680mm	800mm
Capacity:	60 litres	80 litres
Weight:	2kg	2.4kg

### Material

Bin Body: Duraplene™## material

### Colours

Bin Body: Metallic Silver Finish.

Lid: Black.

Apertures: Blue (Paper only), Grey (Handle/General Waste).



# Vista™ Recycling Bins

The Vista range have a stylish metallic silver finish. Vista recycling bins are available as a round, 50 litre capacity bin with an open top lid, a square, 65 litre capacity bin with an open top lid and a square, 65 litre capacity bin with a swing top lid.

## Specifications

### Design Features

- Available in three models:-
  - Round, 50 litre capacity bin with an open top lid.
  - Square, 65 litre capacity bin with an open top lid.
  - Square, 65 litre capacity bin with a swing top lid.
- Sack Retaining Feature.
- Metallic silver finish, will not dent or rust.

### Optional Extras

- Personalisation.
- Plastic sacks for use with sack retaining feature.

### Dimensions

	Round Model (Open Top)	Square Model (Open Top)	Square Model (Swing Top)
Width:	380mm	390mm	390mm
Depth:	380mm	390mm	390mm
Height:	730mm	730mm	730mm
Capacity:	50 litres	65 litres	65 litres
Weight:	2kg	2.2kg	2.9kg

### Material

Bin Body: Duraplene

### Colours

Bin Body: Metallic Silver Finish.

Open Topped Lid: Black, Blue.

Swing Lid: Black.



##Duraplene™ material comprises a range of polymers which have been formulated for internal applications offering reliability and low maintenance.



# Nexus® Shuttle Food Waste Recycling Bin

Nexus Shuttle is a dedicated food waste recycling bin ideal for use in commercial kitchens, canteens, cafes and any other areas where food is prepared and/or consumed. Available with a solid liner or a sack retention system, Nexus Shuttle offers flexibility for the different collection methods of waste.

Nexus Shuttle is a robust unit that will withstand knocks when in service. The smooth surfaces ensure that it is easy to clean and that there are no areas for germs to harbour. With a slimline design it takes up minimal space and the ergonomic height of the unit means it can be stored under worktops when not in use.

The foot pedal operated lid enables a hands free operation to comply with Environmental Health Standards and provides ease and speed of disposing food waste.

## Specifications

### Design Features

- Allows for different methods of collecting food waste.
- Quick and easy to empty – reduces manual handling problems.
- Manufactured from Durapol®\* material, offering exceptional strength and durability.
- Smooth contours ensure there are no dirt traps and allow for easy cleaning and disinfecting.
- Lid overlaps the bin body to help contain any odours from within the bin.
- Anti-slip rubber feet.
- Lid override mechanism allows the lid to be propped open during busy shifts.
- Robust stainless steel hinge rod and mechanism.
- Lid stay mechanism enables quick and easy access for cleaning and emptying.
- Slow closing lid mechanism ensures the lid closes with minimal sound.

### Solid Liner Model

#### Design Features

- Large 60 litres capacity liner.
- Liner lid seals the liner and ensures waste is contained until emptying.
- Liners can be stacked for ease of storage and transportation.
- Curved base and smooth surfaces offer an easy to clean hygienic design.
- Moulded liner handles provide a comfortable grip for the user.
- Liner wheels allow the unit to be easily manoeuvred.

### Sack Retention Model

#### Design Features

- Corn starch sacks available in 50 litres and 80 litres.
- Capacity can be reduced to 30 litres and/or 40 litres.
- Quick and easy to empty/replace the sack.
- Sack retention bands hold the sack neatly in place.
- Removable sack support shelf.
- A sack retaining bar protects the sack and helps to contain it within the bin body.

### Optional Extras

- Recessed Food Waste Graphic.
- A4 Sign Kit.
- Corn Starch Sacks.
- Bungee Cord (Solid Liner Model only).
- Available as a hand operated model for other waste stream collection.

### Dimensions

Width: 452mm

Depth: 441mm

Height: 862mm

Liner Capacity: 60 litres

Weight: Solid Liner model: 8kg

Weight: Sack Retention model: 5.5kg

### Materials

Bin Body, Aperture and Lid:

Durapol® material

Foot Pedal: Glass Reinforced

Nylon

Solid Liner and Lid: Durapol

Sack Retention Bands: PVC

### Colours

Bin Body: Pastel Grey.

Bin Lid: Green or Pastel Grey.

Foot Pedal: Black.



30 litre capacity

40 litre capacity

\*Durapol® material is a polymer formulated to withstand extremes of temperature and is impact-tested in our Quality Assurance Laboratory as part of our BS EN ISO 9001:2008 test procedure. Durapol® material will not chip or rust, is easy to clean and never needs painting.

# Nexus® Shuttle Recycling Bin



Nexus Shuttle is also available as a hand operated model for collecting other recyclable waste streams.



Nexus Shuttle co-ordinates with the Nexus range of recycling bins, and can provide an additional waste stream and uniformity across any scheme.

## Combo™ Catering Waste Recycling Bin

Combo is a large capacity catering waste bin ideal for busy food service areas. Two new models are available:-

**Combo with Tray Shelf** - allows customers to put their tray down in front of the aperture and use both hands to segregate waste into the correct bin.

**Combo with Liquid Reservoir** - collects liquid separately, preventing other waste streams from contamination. The unit features a funnel aperture and two 8 litre reservoirs.

### Specifications

#### Design Features

- Open front aperture.
- Easy to clean hygienic design.
- Recycle Now Graphic Options.

#### Tray Shelf Model

- Allows easy disposal and segregation of catering waste for recycling.
- Tray Shelf pivots upwards to allow easy access to the door for emptying and cleaning.

#### Liquid Reservoir Model

- Prevents build up of liquid in other recycling bins.
- Liquid is poured into the funnel aperture and collected in one of the reservoirs.
- Features two 8 litre reservoirs.
- Filter caps in the funnel aperture prevent other items entering the reservoir.

#### Optional Extras

- Rear Wheels and Handle.
- Personalisation.

#### Tray Shelf Model

- Tray Restricting Bar.
- Plastic Sacks, size: 508mm (20") diameter x 1143mm.

#### Liquid Reservoir Model

- Tray Shelf.
- Spare Reservoir.

#### Dimensions

Width: 595mm

Depth (without Tray Shelf): 606mm

Depth (with Tray Shelf): 870mm

Height: 1195mm Liner Capacity: 140 litres Weight: 23kg

#### Material

Bin Body, Door, Tray Shelf, Aperture Funnel and Reservoir: Durapol®\* material

#### Colours

Bin Body & Door: Red, Dark Blue, Deep Green, Cool Light Grey, Black.

(Available as any single colour or 2 colour combination.)

Tray Shelf: Cool Light Grey.

Aperture Funnel, Filter Caps & Reservoir: Black.



Combo with Tray Shelf



Combo with Liquid Reservoir

\*Durapol® material is a polymer formulated to withstand extremes of temperature and is impact-tested in our Quality Assurance Laboratory as part of our BS EN ISO 9001:2008 test procedure. Durapol® material will not chip or rust, is easy to clean and never needs painting.



# Envoy™ Recycling Bin

Envoy D-shaped recycling bins are designed to take up minimal space. With a variety of apertures, dividers and applications, the Envoy recycling bin range provides a co-ordinated one-stop solution for your recycling needs. With the option of either a 110 litre or 90 litre bin throughout the range, Envoy can accommodate a large volume of waste to reduce the need for frequent emptying. Available in a wide range of colours to co-ordinate with any environment.



Envoy Duo



## Specifications

### Design Features

- Choice of Apertures – Confidential Waste (supplied complete with key-lock), Paper, Cans or Duo Recycling.
- Standard or Recycle Now Graphic Options for single aperture Envoyos.
- Choice of Standard Height or Desk Height.
- Sack Holding Divider (Envoy Duo only).

### Optional Extras

- Standard or Recycle Now Graphic Options for Envoy Duo – you can customise the bin to meet your requirements.
- Personalisation.
- A4 Sign Kit.
- Plastic sacks – 380mm (15") diameter x 712mm available in packs of 200.
- Zinc-coated steel liner (single aperture Envoyos only).
- Key-Lock.
- Glasdon Recycling Stand (see page 18).

### Dimensions

	Standard Height	Desk Height
Width:	540mm	540mm
Depth:	375mm	375mm
Height:	860mm	730mm
Capacity (without liner):	110 litres	90 litres
Capacity (with liner):	82 litres	67 litres

### Materials

Bin Body: Durapol®\* material  
Metal Liner: Zinc-coated steel

### Colours

Millstone, Sandstone, Red, Deep Green, Dark Blue, Black.



BS 8470:2006  
Support your waste management contractor's compliance with BS 8470:2006  
- Code of Practice for the Secure Destruction of Confidential Material.  
"Confidential material to be collected should remain protected from unauthorised access from the point of collection to complete destruction."

\*Durapol® material is a polymer formulated to withstand extremes of temperature and is impact-tested in our Quality Assurance Laboratory as part of our BS EN ISO 9001:2008 test procedure. Durapol® material will not chip or rust, is easy to clean and never needs painting.



Select your choice of tops and apertures

Cans



Paper



Confidential



Non Recyclables - swing top



Non Recyclables - open top



Optional Sign Kit



Envoy™ Duo Recycling Bin



Can be personalised to meet your requirements (examples below)



Recycle Now Graphic Options for base and lid



Personalisation

To help maintain a high profile, many organisations are benefiting from our special product personalisation service. Most Glasdon recycling bins can be personalised with your name, logo or message to create a stylish and effective promotional medium. For more information please telephone 01253 600410.



Envoy Configurations

The unique D-shape of Envoy recycling bins offers the choice of siting them flush against walls and surfaces or back-to-back to form a mini recycling centre. This option makes Envoy an extremely versatile choice for recycling collection.

# Envoy™ Cup Bank

Envoy Cup Bank is a purpose-designed, stylish unit to collect used drinks cups for recycling and store waste liquid separately. The Envoy Cup Bank co-ordinates with Envoy units to create a range of recycling bins for any environment. A cup stacking liner enables up to 700 cups to be neatly stacked in a single sack whilst in the cup bank. Cups remain stacked even during emptying, maintaining a clean and hygienic emptying procedure.



## Easy to Use – How the cup bank works

The waste liquid is poured into the integral funnel, which runs directly into the reservoir unit contained within the cup bank. The empty plastic cups can then be dropped into one of the five cup disposal apertures. Envoy Cup Bank is at a user-friendly height therefore minimal bending/stooping is required. The easy to use apertures make the cup bank a clean and easy way to collect liquid and cups. Envoy Cup Bank can accommodate more than one user at a time.



## Specifications

### Dimensions

Width: 540mm  
 Depth: 375mm  
 Height: 870mm  
 Weight (bank with empty reservoir unit): 8.2kg  
 Weight (bank with full reservoir unit): 17.2kg  
 Bank Capacity: 110 litres  
 Reservoir Capacity: 9 litres

### Materials

Bin Body and Lid: Durapol®\* material  
 Reservoir: Translucent Durapol

### Colours

Millstone, Red, Deep Green, Dark Blue, Black (contains recycled material).



## Easy to Empty

Envoy Cup Bank with cup stacking liner has a very easy emptying procedure which can be carried out by one person.



Remove the lid and lift the plastic sack out of the cup bank.



Remove the reservoir unit located at the back of the cup bank for emptying. Re-position the reservoir unit against the back wall of the cup bank.



Place a new sack inside the cup bank. The sack fits inside the liner and wraps over the top, within the bank. Replace the lid. The aperture holes help to hold the sack in place.

# Nexus™ 2.5 Desktop Recycling Bin

Nexus 2.5 is a compact desktop recycling bin that allows for waste collection of small recyclable items, prior to segregation into the main office recycling point. Supplied in a box of 6 recycling bins.

## Specifications

### Design Features

- Compact design with a small capacity, ideal for desktop waste.
- D-shaped design takes up minimal space.
- Flip lid hides any unsightly waste and helps contain any odours from within the bin.

### Optional Extra

- Personalisation.

### Dimensions

Width: 140mm  
 Depth: 161.5mm  
 Height: 217.5mm  
 Capacity: 2.5 litres

### Material

Bin Body: Durapol

### Colours

Bin Body and Flip Lid: Mid Grey.  
 Lid: Pastel Grey.

Supplied in a box of 6 units



\*Durapol® material is a polymer formulated to withstand extremes of temperature and is impact-tested in our Quality Assurance Laboratory as part of our BS EN ISO 9001:2008 test procedure. Durapol® material will not chip or rust, is easy to clean and never needs painting.

# Nexus<sup>®</sup> 130 Recycling Bin

The Nexus 130 recycling bin has a large 130 litre capacity and a robust locking hood for the collection of a range of recyclable waste.

## Specifications

### Design Features

- Sack Retention System.
- Key-Lock.
- Tapered Design for Stacking and Storage.

### Optional Extras

- Recycle Now Graphics for Lid and Body.
- Lid Without Lock.
- Ground Fixing Holes.
- Clear Plastic Sacks - 521mm (20.5") diameter x 1245mm (49") length available in packs of 100.

### Dimensions

Maximum Diameter: 590mm  
Height: 940mm Capacity: 130 litres  
Weight: 5kg

### Material

Bin Body and Hood: Durapol<sup>®</sup>\* material

### Colours

Body: Pastel Grey.  
Hood: Light Blue (Paper only), Red (Cans or Bottles only), Dark Grey (Cans or Bottles only), Black (General Waste) (100% recycled material).



# Nexus<sup>®</sup> 130 Trio Recycling Bins

Nexus 130 Trio collects three segregated recycling streams within a single, space-saving unit. The unique sack retention system allows flexible waste stream capacities to maximise bin volume.

## Specifications

### Design Features

- A Trio Recycling Hood is available to allow the segregation of three waste streams within one unit.
- Two models are available, an Open Top model which is ideal for indoor use and a Hooded Top model, which provides weather-resistance for outdoor use.
- Choice of Apertures for the collection of Newspapers and Magazines, Plastic Bottles, Cans, Mixed Glass or General Waste.
- Clear graphics provide easy identifiable waste streams and help to prevent cross-contamination.
- Keyed-lock prevents unauthorised removal of hood.
- A unique sack retention system supports three sacks within the bin, and allows flexible waste stream capacities to maximise bin volume.
- The sack retention system is removable for easy emptying.
- The Trio Hood features Zintec galvanised steel dividers to prevent cross-contamination of waste.

### Optional Extras

- Stubber Plate for the Hooded Top model.
- Clear Plastic Sacks - 508mm (20") diameter x 851mm (34") length available in packs of 250.

### Colours

Open Top/Hooded Top: Black, Anthracite Grey.

### Aperture Options and Recycling Graphics

Black and White (General Waste), Red (Plastic Bottles only), Grey (Cans only), Blue (Newspapers and Magazines only). Other options are available. Please contact our Sales Office for details.

Please specify your choice for apertures and sets of Recycle Now Graphics at point of order.



Hooded Top



Open Top

## Easy to Empty

Sack retention system separates three streams of recycling within one unit.



Recycle Now Sticker Kits for Trio Hoods. Other options are available. Please contact our sales office for details.



\*Durapol<sup>®</sup> material is a polymer formulated to withstand extremes of temperature and is impact-tested in our Quality Assurance Laboratory as part of our BS EN ISO 9001:2008 test procedure. Durapol<sup>®</sup> material will not chip or rust, is easy to clean and never needs painting.



# C-Thru™ 5, 10 & 15 Recycling Bin Range

C-Thru Recycling Bin is a compact bin available in three sizes. The unit is clear which encourages recycling of specific waste streams and reduces contamination of waste. It also allows the operator to see when the bin needs emptying.

## Specifications

### Design Features

- Available as a 5 litre, 10 litre or 15 litre capacity unit.
- Choice of lid – funnel top or open top.
- Choice of lid and base colour.
- Robust construction – 2.5mm thick polycarbonate body.
- Funnel-shaped aperture reduces contamination of waste.
- Lid can be removed when emptying the bin.
- Handles on the top and bottom of the unit aid easy emptying.
- Cushioned rubber internal base protects the base and reduces noise by softening the landing.
- Free-standing foot provides stability.

### Optional Extras

- Recycle Now Graphic Options.

### Dimensions

	C-Thru 5	C-Thru 10	C-Thru 15
Diameter:	220mm	220mm	220mm
Height:	400mm	650mm	900mm
Capacity:	5 litres	10 litres	15 litres
Weight:	1.41kg	1.82kg	2.16kg

### Materials

Body: Polycarbonate

Flute, Funnel, Foot and Handles: Duratec™\* material

Internal Base: Rubber

### Colours

Flute, Funnel and Base: Magenta, Blue, Red, Black.

Handles: Grey.



\*Duratec™ material has been specifically created for use in internal environments. In addition to its attractive appearance it offers a blend of toughness, rigidity and dimensional stability.

# C-Thru™ 180 Recycling Bin

A large 180ltr capacity container with a clear body to enable viewing of contents to ensure that there is no contamination of waste. C-Thru 180 Recycling Bin is available with four different hood options all with a keyed locking mechanism. The clear body can be flat-packed for ease of storage when the bin is not in use.

## Specifications

### Design Features

- Key-Lock.
- Choice of apertures - Cans/Plastic Bottles, Paper and General Waste.
- Recycle Now Graphic Options.

### Optional Extras

- Blank Security Hood.
- Blanking Plate Kit for Paper Aperture.
- Clear Plastic Sacks - 521mm (20.5") diameter x 1245mm (49") length available in packs of 100.
- Glasdon Recycling Stand (see page 18).

### Dimensions

Diameter: 590mm Height: 970mm  
Weight: 8kg Capacity: 180 litres

### Materials

Hood and Plinth: Durapol®\* material  
Body: Clear Polycarbonate

### Colours

Body: Clear. Plinth: Dark Grey.  
Hood: Light Blue (Paper only), Red (Cans or Bottles only),  
Dark Grey (Cans or Bottles only), Black (General Waste).



# C-Thru™ 180 Trio Recycling Bins

C-Thru 180 Trio offers three streams of recycling collection within a single, large capacity unit. The clear body enables viewing of contents to ensure that there is no contamination of waste. The unique sack retention system allows flexible waste stream capacities to maximise bin volume.

## Specifications

### Design Features

- A Trio Recycling Hood is available to allow the segregation of three waste streams within one unit.
- Two models are available, an Open Top model which is ideal for indoor use and a Hooded Top model, which provides weather-resistance for outdoor use.
- Choice of Apertures for the collection of Newspapers and Magazines, Plastic Bottles, Cans, Mixed Glass or General Waste.
- Clear graphics provide easy identifiable waste streams and help to prevent cross-contamination.
- Keyed-lock prevents unauthorised removal of hood.
- Unique sack retention system supports three sacks within the bin, and allows flexible waste stream capacities to maximise bin volume.
- Sack retention system is removable for easy emptying.
- The Trio Hood features Zintec galvanised steel dividers, to prevent cross-contamination of waste.

### Optional Extras

- Stubber Plate for the Hooded Top model.
- Clear Plastic Sacks - 508mm (20") diameter x 851mm (34") length available in packs of 250.
- Glasdon Recycling Stand (see page 18).

### Colours

Open Top/Hooded Top: Black, Anthracite Grey.

### Aperture Options and Recycling Graphics

Black and White (General Waste), Red (Plastic Bottles only), Grey (Cans only), Blue (Newspapers and Magazines only). Other options are available.

Please contact our Sales Office for details.

Please specify your choice for apertures and sets of Recycle Now Graphics at point of order.



Open Top



Hooded Top

## Easy to Empty

Unique sack retention system separates three streams of recycling within one unit.



Recycle Now Sticker Kits for Trio Hoods. Other options are available. Please contact our sales office for details.



\*Durapol® material is a polymer formulated to withstand extremes of temperature and is impact-tested in our Quality Assurance Laboratory as part of our BS EN ISO 9001:2008 test procedure. Durapol® material will not chip or rust, is easy to clean and never needs painting.



# Orbis™ Recycling Sack Holder

The Orbis Recycling Sack Holder is highly robust, with a strong sack retention system which securely holds the sack neatly in position, creating a tidy unit. Orbis can be wall or post mounted.

## Specifications

### Design Features

- Recycle Now Graphic Options.
- Choice of co-ordinating lid colours (can fit any colour body).
- Strong and robust moulding.
- Weather and vandal resistant – does not corrode.
- Neat, tidy and strong sack retention system.
- Robust two stop knuckle hinge.
- Available with or without lid.
- Anti-flyposting and easy graffiti removal finish.
- Fixing points for wall or post mounting.

### Optional Extras

- Surface Mounting Post.
- Free-Standing Post.
- Extended Post.
- Mobile Base Kit.
- Mounting bracket (2, 3 or 4 units).
- Rail Mounting Bracket.
- Polycarbonate Cage.
- Steel Mesh Cage with Armortec®### coating for Wall or Post Mounting.
- Sack Retention Bungee Cord.
- Choice of Fixing Options.
- External Ballast for Free Standing Unit.
- Extended Beach Post Kit.

### Dimensions

Diameter: 412mm Overall Depth: 456mm  
 Height: (without lid): 135mm Height: (with lid): 184mm  
 Capacity: 110 litres (depending on sack size)

### Material

Body and Lid: Durapol®\* material

### Colours

Body: Black (100% recycled material), Millstone, Sandstone, Anthracite Grey.  
 Lid: Black (100% recycled material), Millstone, Sandstone, Anthracite Grey, Blue, Green, Yellow, Red.



Wall Mounting



Free-Standing

## Optional Extras



Mounting brackets for two, three or four units.



Orbis with free standing post, ideal for indoor environments.



Armortec coated steel mesh cage is available if required.



Transparent polycarbonate cage is also available.

\*Durapol® material is a polymer formulated to withstand extremes of temperature and is impact-tested in our Quality Assurance Laboratory as part of our BS EN ISO 9001:2008 test procedure. Durapol® material will not chip or rust, is easy to clean and never needs painting.

\*\*Armortec® corrosion resistant coating is specially formulated to extend the life of Glasdon metal products and components used externally.



# Glasdon Jubilee™ & Streamline Jubilee™ Outdoor Recycling Bins

Glasdon Jubilee Recycling Bin range combines a host of unique design features. Glasdon Jubilee is supplied with four purpose-designed aperture panels and large, clear signage to help with the efficient collection and segregation of recyclable waste. Streamline Jubilee offers all the great features of the Glasdon Jubilee Bin in a slimmer footprint. This 70-litre unit is designed to suit narrow footpaths, bus stops or any outdoor location where floor space needs to be maximised.



Glasdon Jubilee



Streamline Jubilee

## Specifications

### Design Features

- Domed hood.
- Anti-flyposting finish.
- Robust 3 point interlocking slam shut door.
- Concealed knuckle hinges.
- Keyed or foot activated keyless lock.
- Liner tray/bait box area.
- Choice of recycling aperture panels and Recycle Now graphics.
- Mild steel or moulded plastic liner.
- Coloured banding.

### Optional Extras

- Recycling Poster Frame.
- Liner Elastic Sack Retention.
- A5 Personalisation (supplied as self adhesive vinyl or polycarbonate plaque).
- Aperture Blanking Panels.
- Aperture Flap Kit.
- Choice of Ground Fixing Options.

### Dimensions

	Glasdon Jubilee	Streamline Jubilee
Width:	598mm	583mm
Depth:	553mm	406mm
Height:	1158mm	1170mm
Weight:	28kg	23kg
Bin volume:	130 litres	85 litres
Liner capacity (Mild steel):	110 litres	70 litres
Liner capacity (Durapol®** material):	100 litres	65 litres

### Materials

Bin Body, Door, Apertures & Poster Frame: Durapol  
 Liner: Mild Steel or Durapol  
 Keyed & Keyless Operation: Glass-filled Nylon  
 Graphics: Vinyl

### Colours

Millstone, Dark Blue, Deep Green, Anthracite Grey, Black (100% recycled material).

### Recycling Aperture Panels



Glasdon Jubilee

## Recycle Now Graphic Options

### Top Area



### Central Area



Newspapers & Magazines (Azure Blue), Cans (Grey), Plastic Bottles (Warm Red), Mixed Glass (Dark Aqua), Mixed Recyclables (Lime Green or Orange).

(Any combination of personalisation & recycling graphics can be used e.g. 2 x A5 self adhesive vinyl and 2 x poster frames)

\*Durapol® material is a polymer formulated to withstand extremes of temperature and is impact-tested in our Quality Assurance Laboratory as part of our BS EN ISO 9001:2008 test procedure. Durapol® material will not chip or rust, is easy to clean and never needs painting.

# Nexus<sup>®</sup> City 240 & Nexus<sup>®</sup> City 140 Food

Nexus City 240 is a robust, attractive recycling bin. The unit features a soft-close aperture flap that keeps vermin out and odours in. Nexus City 240 is ideal for use particularly where large volumes of food waste are generated. Nexus City 140 offers all the great features of the Nexus City 240 in a smaller footprint. The 140-litre unit is designed to suit areas restricted by space and offers a solution to those concerned with manual handling issues.

## Specifications

### Design Features

- Houses a 240 or 140 litre wheeled container.
- Manufactured from robust Durapol<sup>®</sup>\* material.
- Curved sloping hood prevents waste being left on top of the bin.
- Very robust, large handled aperture flap, with a durable stainless steel hinge.
- Aperture flap has a soft close mechanism to ensure lid always closes with minimal sound after opening and minimises risk of vermin entering housing.
- Aperture flap shut off creates a seal to help keep odours contained.
- Aperture size is large enough to allow easy disposal of food waste items, but small enough to minimise contamination.
- Graphics help to encourage correct usage.
- Smooth surfaces, both internally and externally for ease of cleaning.
- Features a double skinned 5-point interlocking slam shut door.
- Base ramp aids insertion/removal of the wheeled container.
- Wheeled container location points ensure the container is sited correctly. (Nexus City 240 only)

### Optional Extras

- Interchangeable A3 poster frame kit.
- Aperture flap graphic personalisation.
- Choice of ground fixings.
- Internal ballast.
- Glasdon FireSafe<sup>™</sup> Automatic Suppression Device (Nexus City 240 only).

### Dimensions

	Nexus City 240	Nexus City 140
Height:	1400mm	1365mm
Width:	805mm	735mm
Depth:	900mm	735mm
Weight Bin:	32kg	25kg
Weight Bin and Ballast:	51kg	65kg
Liner Capacity:	240 litres/140 litres	140 litres

### Materials

Bin Body, Door and Aperture Flap: Durapol  
Soft Close Mechanism: Carbon Steel  
Aperture Hinge Rod: Stainless Steel

### Colours

Bin Body, Door: Black, Anthracite Grey.  
Aperture Flap: Black, Anthracite Grey.



Nexus City 240 in Anthracite Grey



Nexus City 140 in Black

\*Durapol<sup>®</sup> material is a polymer formulated to withstand extremes of temperature and is impact-tested in our Quality Assurance Laboratory as part of our BS EN ISO 9001:2008 test procedure. Durapol<sup>®</sup> material will not chip or rust, is easy to clean and never needs painting.



## Easy to use 5-point interlocking door



## Nexus City 240 houses a 240 or 140 litre wheeled container



## Recessed Graphics

- Clear and easy to understand.
- Reduces cross contamination of waste.
- Robust and hardwearing.
- Mark resistant.
- Jet washer resistant.
- Recess prevents picking.



## Optional Extras

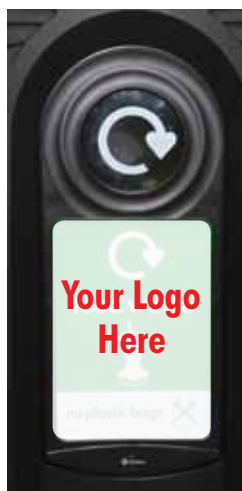

Large robust handle



Nexus City 240 in Anthracite Grey and Nexus City 140 in Black sited back-to-back to show difference in footprint.



The A3 poster frame kit, aperture flap and recessed graphics can be easily personalised with your local authority or organisation name, logo or crest as an optional extra.



# Nexus® City 240 & Nexus® City 140 Outdoor Recycling Bins

Nexus City 240 and Nexus City 140 Recycling Bins can help reduce the amount of waste being sent to landfill. The units are robust, attractive and feature a brightly coloured hood, dedicated waste stream apertures and graphics that make them instantly identifiable and encourage recycling.

Nexus City 240 is ideal for use where large volumes of waste are generated. Nexus City 140 offers all the great features of the Nexus City 240 in a smaller footprint. The 140-litre unit is designed to suit areas restricted by space and offers a solution to those concerned with manual handling issues.



## Specifications

### Design Features

- Houses a 240 or 140 litre wheeled container.
- Manufactured from robust Durapol®\* material.
- Curved sloping hood prevents waste being left on top of the bin.
- Vandal and weather resistant hood.
- Graphics and dedicated apertures encourage correct usage and minimise contamination of waste streams.
- Smooth surfaces, both internally and externally for ease of cleaning.
- Features a double skinned 5-point interlocking slam shut door.
- Base ramp aids insertion/removal of the wheeled container.
- Wheeled container location points ensure the container is sited correctly. (Nexus City 240 only)

### Optional Extras

- Interchangeable A3 poster frame kit.
- Choice of ground fixings.
- Internal ballast.
- Glasdon FireSafe™ Automatic Suppression Device (Nexus City 240 only).



### Dimensions

	Nexus City 240	Nexus City 140
Height:	1585mm	1565mm
Width:	805mm	735mm
Depth:	900mm	735mm
Weight Bin:	32kg	25kg
Weight Bin and Ballast:	51kg	65kg
Liner Capacity:	240 litres	140 litres

### Materials

Bin Body, Door and Hood: Durapol

### Colours

Bin Body and Door: Black, Anthracite Grey.

Hood:

Cans: Grey.

Plastic Bottles: Red.

General Waste: Black.

Newspapers & Magazines: Blue.

Mixed Glass: Aqua Green.

Mixed Recyclables: Lime Green.



\*Durapol® material is a polymer formulated to withstand extremes of temperature and is impact-tested in our Quality Assurance Laboratory as part of our BS EN ISO 9001:2008 test procedure. Durapol® material will not chip or rust, is easy to clean and never needs painting.

# Gemini™ Outdoor Recycling Bin

## Specifications

### Design Features

- Choice of liner options:-
  - Two x 90ltr steel liners
  - Two x 80ltr polyethylene liners
  - Two x 100ltr sack retention units
- Or mix and match to suit your requirements.
- Coloured aperture panels and Recycle Now Graphics on a polycarbonate plaque.
- Coloured banding.
- Bolt-down fixing (for existing concrete or suitable paving slabs).

### Optional Extras

- Personalisation (8 panels available) please telephone 01253 600410 to discuss your requirements.
- Firexpire® Fire Extinguishing Device.
- Hood Plaques.
- Choice of Ground Fixing Options.

### Dimensions

Width: 1020mm  
 Depth: 492mm  
 Height: 1100mm  
 Weight c/w moulded plastic liner: 32.5kg  
 Weight without liner: 26kg

### Material

Durapol®\* material

### Colours

Millstone, Black.



Gemini is a multi-purpose, twin-liner recycling bin, which is ideal for use on streets and in town centres, where there is a need for the collection of more than one waste stream. The narrow footprint of Gemini Recycling Bin means that pedestrian flow will not be disturbed, but provision for waste collection is still highly noticeable.

## Aperture Panels and Recycle Now Graphics

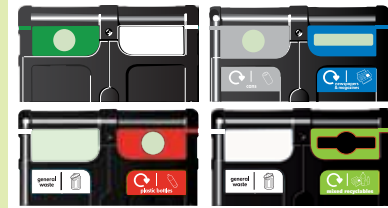

Clear Glass (Green on White), Mixed Glass (Green), Newspapers & Magazines (Blue), Cans (Red, Light Grey, White, Green), Plastic Bottles (Red, Light Grey, White, Green), General Waste (Black on White), Mixed Recyclables (Lime Green or Orange).



Optional Extra - Hood Plaques

# Grampian™ Outdoor Recycling Bin Housing

## Specifications

### Design Features

- Choice of five liner options:-
  - 240ltr sack retention system, Two x 65ltr zinc-coated steel liners, Two x 90ltr moulded plastic liners, 120ltr wheeled container, 140ltr wheeled container.
- Twin-walled moulded unit.
- Strong knuckle-hinge door.
- Two-point locking system door.
- Stainless steel lock components – square key to open, slam to lock.
- Ground fixings for existing suitable concrete surfaces.
- Matching coloured banding.
- Choice of Aperture Panels and Recycle Now Graphics on a polycarbonate plaque.

### Optional Extras

- Firexpire Fire Extinguishing Device.
- A3 Poster Frame, for laminated A3 sheet (one or two).
- Internal Divider (The option of two liners means two waste streams can be segregated within the same housing).
- Choice of Ground Fixing Options.

### Dimensions

Width: 674mm Depth: 704mm Height: 1402mm  
 Weight without liner: 35kg

### Material

Durapol

### Colour

Bin Body: Black.

#### Siting Recommendations

We recommend that a risk assessment is undertaken to identify an appropriate location for your recycling units. In order to reduce risk, some organisations decide to place the units a minimum of 5 metres away from buildings. Any potential risk can be further reduced by maintaining a regime of regularly emptying the unit.

Grampian Recycling Bin Housing is ideal for waste collection in areas where a high volume of recyclable litter is created. It is extremely robust and is twin-walled with a strong knuckle-hinge door. Lock components are in stainless steel and the locking mechanism is a secure two-point system, with a key-to-open, slam-to-lock action.



## Clearly identifiable graphics and wording help encourage use



Aperture panel/banding colours: Black, Blue, Green, Grey, Red, White

Aperture Shape: Two x 90mm diameter holes      One x 90mm diameter hole  
 320 x 30mm slot      320 x 90mm slot

Any coloured panel can be customised with your own recycling message. (Subject to a minimum order quantity.) Please phone to discuss your personal requirements.

\*Durapol® material is a polymer formulated to withstand extremes of temperature and is impact-tested in our Quality Assurance Laboratory as part of our BS EN ISO 9001:2008 test procedure. Durapol® material will not chip or rust, is easy to clean and never needs painting.



# Nexus<sup>®</sup> 200 Outdoor Recycling Bin

Nexus 200 is a contemporary styled, twin-liner recycling bin, ideal for use on streets and in town centres. The distinctive graphics displayed on the unit are visible from all angles allowing more productive waste collection. The elliptical shape and narrow footprint of Nexus 200 recycling bin means that pedestrian flow will not be disturbed.



## Specifications

### Design Features

- Supplied with 2 x 100 litre zinc-coated steel liners.
- Slimline design; will not obstruct pedestrian flow.
- Robust construction - double skinned body and doors.
- Features two 3-point interlocking slam shut doors.
- Colour-coded apertures and clear graphics can be seen from all angles.
- Curved hood prevents littering.
- Single keyed twin door opening system allows easy access to the liner for emptying and cleaning.
- Extended aperture ledges help to ensure litter enters the liner, preventing spillage between the liner and the bin.
- Anti-flyposting finish.
- Includes four A3 poster frames with Recycle Now Graphics.
- Stubby Plate in Gun Metal Grey or Gold colour.

### Optional Extras

- Ashtray in Gun Metal Grey or Gold colour.
- 2 x Glasdon FireSafe™ Automatic Suppression Device.
- 2 x 100 litre Moulded Plastic Liner.
- Aperture Blanking Panel.
- Sack Retention.
- Base Tray.
- Choice of Ground Fixing Options.

### Dimensions

Width: 1169mm  
Depth: 591mm  
Height: 1177mm  
Weight c/w steel liners: 51kg  
Weight c/w Durapol®\* material liners: 46kg  
Bin volume: 2 x 136 litres  
Liner capacity: 2 x 100 litres

### Material

Bin Body and Door: Durapol

### Colours

Black, Anthracite Grey.

## Twin Door Opening System

With a twin door opening system and separate body compartments, Nexus 200 allows easy and quick access to both liners whilst minimising cross contamination between them.



## Secure 3-point Locking System

The unique lift and lock mechanism engages the door with the bin body at three separate points, to provide a highly secure, vandal-resistant locking system. The door rises and self-returns to the locked position with a simple slam lock operation.



\*Durapol® material is a polymer formulated to withstand extremes of temperature and is impact-tested in our Quality Assurance Laboratory as part of our BS EN ISO 9001:2008 test procedure. Durapol® material will not chip or rust, is easy to clean and never needs painting.



# Nexus<sup>®</sup> 200 Recycling Bin Colour, Aperture & Graphic Options

## Select your choice of colour and aperture

### Paper Aperture



Azure Blue

### Cans & Bottles Apertures



Warm Red  
(Plastic Bottles)



Grey  
(Cans)



Dark Aqua  
(Mixed Glass)

### Mixed Recyclables Aperture



Lime Green

OR



Orange

### General Waste Aperture



Black

OR



Grey

## Recycle Now Graphic Options

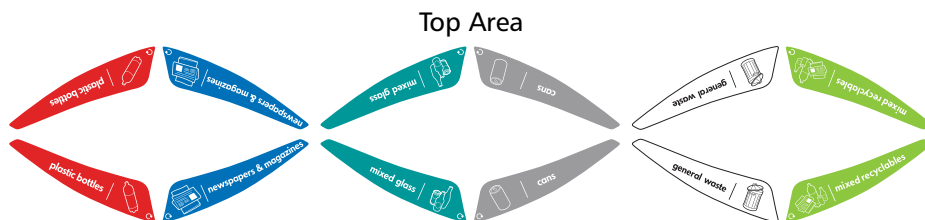

Top Area



A3 Poster

Plastic Bottles (Warm Red), Newspapers & Magazines (Azure Blue), Mixed Glass (Dark Aqua), Cans (Grey), General Waste (Black on White), †Mixed Recyclables (Lime Green or Orange).

## Extended Aperture Ledge

Minimises cleaning inside the bin as the extended aperture ledge ensures that litter will fall directly in to the liner.



## Interchangeable A3 Poster Frame Kit

The easy to personalise A3 poster frame kit is colour matched to the Recycle Now Graphics for added impact.



## Optional Extras

### Ashtray



Cigarette ashtray with a 5ltr liner in Gun Metal Grey or Gold colour.

### Aperture Blanking Panel



Ideal for use when the bin needs to be sealed from public use temporarily.

### Sack Retention



An elastic sack retention belt securely holds the sack inside the liner.

### Base Tray



Provides a smooth base for easy cleaning

## Glasdon FireSafe™ Automatic Suppression Device (600g)



Glasdon FireSafe automatic fire suppression device is fitted within the hood of the bin. Should a fire break out inside the bin the device is activated. Glasdon FireSafe is an effective low cost auxiliary device and must never replace primary fire prevention measures. A regular inspection/maintenance programme should be introduced to ensure the device is in working condition or has discharged and therefore needs replacing.

# Nexus® 360 Outdoor Recycling Bin

The aesthetically designed Nexus 360 recycling bin housing is ideal for waste collection in areas where a high volume of recyclable litter is created. This instantly recognisable recycling housing is extremely robust with a unique 5-point interlocking door.



## Specifications

### Design Features

- Houses a 240 litre or 360 litre wheeled container.
- Features a double skinned 5-point interlocking slam shut door.
- Curved sloping body and hood prevents littering.
- Integrally moulded ridges deter fly-posting and graffiti.
- Available with colour-coded apertures and clear Recycle Now Graphics.
- Extended aperture ledge helps to ensure litter enters the liner, preventing spillage between the liner and the bin.
- Base ramp aids insertion/removal of the wheeled container.
- Includes an A3 poster frame with Recycle Now Graphics.

### Optional Extras

- Glasdon FireSafe™ Automatic Suppression Device.
- Choice of Ground Fixing Options.
- Side Connecting Kit (2 bins).

### Dimensions

Width: 835mm

Depth: 1071mm

Height: 1512mm

Weights: Housing: 39kg (no wheeled container)

Door: 11kg

Liner Capacity: either a 240 litre or 360 litre wheeled container

### Material

Bin Body and Door: Durapol®\* material

### Colours

Black, Anthracite Grey.

## Double Skinned Door & Concealed Knuckle Hinge

The strong and robust double skinned door has concealed hinges for added durability.



## Secure 5-point Locking System

The unique lift and lock mechanism engages the door with the bin body at five separate points, to provide a highly secure, vandal-resistant locking system. The door rises and self-returns to the locked position with a simple slam lock operation.



### Siting Recommendations

We recommend that a risk assessment is undertaken to identify an appropriate location for your recycling units. In order to reduce risk, some organisations decide to place the units a minimum of 5 metres away from buildings. Any potential risk can be further reduced by maintaining a regime of regularly emptying the unit. You may also wish to consider installing a Glasdon FireSafe.

\*Durapol® material is a polymer formulated to withstand extremes of temperature and is impact-tested in our Quality Assurance Laboratory as part of our BS EN ISO 9001:2008 test procedure. Durapol® material will not chip or rust, is easy to clean and never needs painting.



# Nexus<sup>®</sup> 360 Recycling Colour, Aperture & Graphic Options

## Select your choice of colour and aperture

### Paper Aperture



Azure Blue

### Cans & Bottles Apertures



Warm Red  
(Plastic Bottles)



Grey  
(Cans)



Dark Aqua  
(Mixed Glass)

### Mixed Recyclables Aperture    General Waste Aperture



Lime Green



Black

## Recycle Now Graphic Options

### Top Area

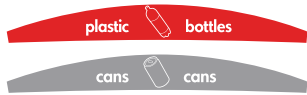

### A3 Poster

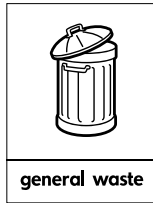

Plastic Bottles (Warm Red), Newspapers & Magazines (Azure Blue), Mixed Glass (Dark Aqua), Cans (Grey), General Waste (Black on White), †Mixed Recyclables (Lime Green or Orange).

## Optional Extra

### Glasdon FireSafe<sup>™</sup> Automatic Suppression Device (1kg)



Glasdon FireSafe automatic fire suppression device is fitted within the hood of the bin. Should a fire break out inside the bin the device is activated. Glasdon FireSafe is an effective low cost auxiliary device and must never replace primary fire prevention measures. A regular inspection/maintenance programme should be introduced to ensure the device is in working condition or has discharged and therefore needs replacing.

## Aperture Shelf

Minimises cleaning inside the bin as the aperture shelf ensures that litter will fall directly in to the liner.



## Interchangeable A3 Poster Frame Kit

The easy to personalise A3 poster frame kit is colour matched to the Recycle Now Graphics for added impact.



## Anti Littering Feature

Multiple units can be sited together as a bank of recycling housings without litter being deposited between the units.



# Modus™ Housing

A high capacity recycling bin housing, which securely contains a wheeled bin in a tidy manner. Modus creates a focal recycling point, ideal for areas such as housing developments, bring sites, parks and also for commercial use. Modus transforms any old/unsightly recycling containers into an attractive recycling centre.

## Specifications

### Design Features

- Choice of Modus 770 which can house a 600 litre, 660 litre or 770 litre wheeled bin or Modus 1280 which can house a 1100 litre or 1280 litre wheeled bin.
- Vandalex®+ material frame provides exceptional strength and is vandal and weather resistant.
- Recycling apertures and clear Recycle Now graphics help to encourage recycling.
- Durapol®\*\* material hood encloses the wheeled bin inside the unit and provides security and weather protection.
- Hood peak provides extra weather protection to the apertures.
- Chute behind the aperture ensures that litter always enters the wheeled bin.
- Front door opening design with door stay feature provides easy access to the wheeled bin inside.
- Features a 3-point locking system.
- The door features a handle and stainless steel hinge.
- An adjustable door wheel enables easy opening of the door and levels the door on uneven surfaces.
- Base skirting provides a guard around the base of the housing, to minimise the risk of pests entering the housing and also conceal the door wheel.
- Supplied fully assembled.

### Optional Extras

- Food Waste Aperture and Chute.
- Blanking Aperture – for secure storage of equipment.
- Aperture Brushes (round aperture only – glass recycling).
- Wing Lock.
- Glasdon FireSafe™ Automatic Suppression Device.
- Personalisation.

### Dimensions

	Modus 770	Modus 1280
Width:	1614mm	1614mm
Depth:	923mm	1257mm
Height:	1660mm	1660mm
Capacity:	600, 660 or 770 litre wheeled bin	1100 or 1280 litre wheeled bin

### Materials

Frame: Vandalex  
 Panelling: Ecoboard™# material  
 Hood: Durapol

### Colours

Frame: Silver.  
 Hood: Anthracite Grey.  
 Panelling: Dark Grey.  
 Spigot Leg, Door Waste Guide: Anthracite Grey.  
 Skirting: Black.  
 Handle: Grey.



## Personalisation

Modus can be personalised with your own artwork or logo to promote your recycling message, or disguised to complement your environment.

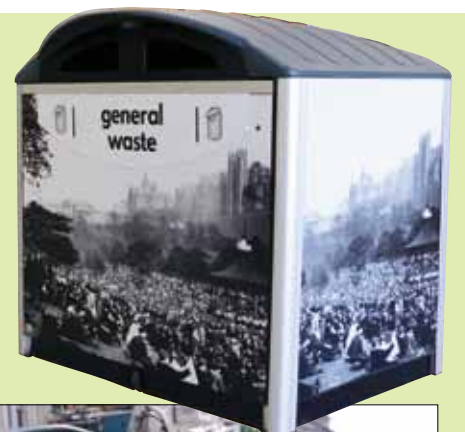

## Aperture Panels and Recycle Now Graphic Options

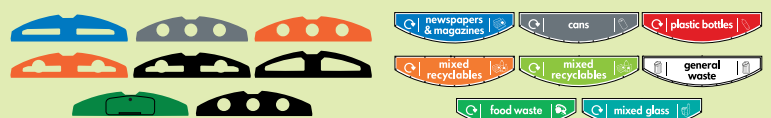

### Siting Recommendations for Modus and Visage

For Modus and Visage, we recommend that a risk assessment is undertaken to identify an appropriate location for your recycling units.  
 In order to reduce risk, some organisations decide to place the units a minimum of 5 metres away from buildings. Any potential risk can be further reduced by maintaining a regime of regularly emptying the unit.  
 You may also wish to consider installing a Glasdon FireSafe on Modus.

\*Durapol® material is a polymer formulated to withstand extremes of temperature and is impact-tested in our Quality Assurance Laboratory as part of our BS EN ISO 9001:2008 test procedure.  
 Durapol® material will not chip or rust, is easy to clean and never needs painting.

†Vandalex® material is an aluminium alloy engineered to produce a high modulus of elasticity, which offers increased impact absorption properties. Its anodised finish will not rust, is easy to clean and never needs painting.  
 #Ecoboard™ material is manufactured using a combination of virgin polymer and post consumer plastic waste to create a very robust and strong panel. Ecoboard will not chip or rust, is easy to clean and never needs painting.



# Visage™ Screen System

The Visage Screen System is ideal for commercial use, housing developments, bring sites, parks and open spaces, to conceal recycling containers in areas where large capacity is high priority.

The Visage Screen System creates a secure, aesthetically pleasing recycling centre and large polycarbonate graphics can be added to encourage recycling.

The modular construction of the Visage Screen System allows units to be built up to form two sided, three sided and four sided (complete with door) screens.

## Specifications

### Design Features

- Units can screen 600 litre, 660 litre, 1100 litre or 1280 litre wheeled bins.
- Low panels provide easy access to open the lid of the wheeled bin behind the screen.
- Vandalex®+ material frame provides exceptional strength and is vandal and weather resistant.
- An adjustable door wheel enables easy opening of the door and levels the door on uneven surfaces (four sided screen only).
- The door features a Tri-Lock, handle and stainless steel hinge (four sided screen only).

### Optional Extras

- Polycarbonate Recycle Now Graphics Kit.
- Base Skirting.
- Wing Lock (four sided screen only).
- Joining Vandalex Extrusion (for alternative screen layouts).
- Personalisation.

### Dimensions

#### Visage 770

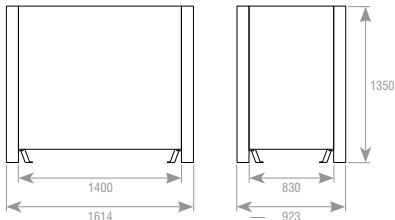

#### Visage 1280

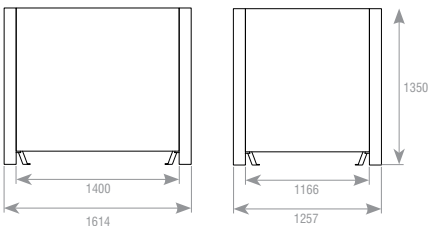

### Materials

Frame: Vandalex  
Panelling: Ecoboard

### Colours

Frame: Silver.  
Hood: Anthracite Grey.  
Panelling: Dark Grey.  
Spigot Leg, Door Waste Guide: Anthracite Grey.  
Skirting: Black.



See Page 38 for siting recommendations.



## Personalisation

Visage can be personalised with your own artwork or logo to promote your recycling message, or disguised to complement your environment.



## Recycle Now Graphic Options

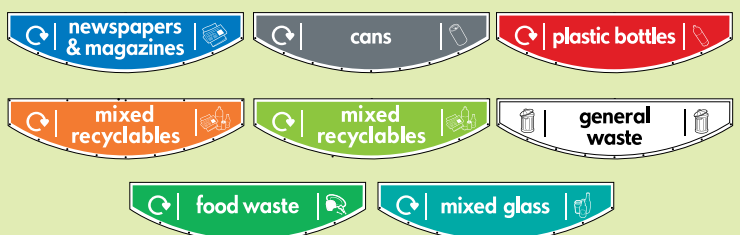

\*Vandalex® material is an aluminium alloy engineered to produce a high modulus of elasticity, which offers increased impact absorption properties. Its anodised finish will not rust, is easy to clean and never needs painting.



---

## HOW TO ORDER

To order direct from this brochure, please telephone 01253 600410, fax 01253 792558 or post to us at our address shown below.

---

## FREE DELIVERY IN MAINLAND UK & NORTHERN IRELAND

Our national distribution network ensures prompt delivery in mainland UK and Northern Ireland. All our prices are carriage free on the mainland and Northern Ireland for orders over £50 value, only VAT will be added.

However, to help offset the cost of packing, administration and delivery, there is a small charge of £5 on orders below the value of £50.

---

[www.glasdon.com](http://www.glasdon.com)



**Glasdon U.K. Limited**

Preston New Road  
BLACKPOOL  
Lancashire  
FY4 4UL

Tel: (01253) 600410

Fax: (01253) 792558

e-mail: [sales@glasdon-uk.co.uk](mailto:sales@glasdon-uk.co.uk)

web: [www.glasdon.com](http://www.glasdon.com)

glasdon, Armortec, Combo, Combo Delta, C-Thru, Duraplene, Durapol, Duratec, Ecoboard, Eco Nexus, Envoy, Firexpire, Glasdon FireSafe, Gemini, Glasdon Jubilee, Grampian, Mirage, Modus, Nexus, Orbis, Streamline Jubilee, Vandalex, Visage and Vista are trademarks or registered trademarks of Glasdon Group or its subsidiaries in the UK and other countries.



Glasdon Group Limited Is An Equal Opportunities Employer.

© Glasdon UK Ltd. 10/2016 Glasdon reserve the right to alter price and specification without prior notice.

PN/PP



GT304/00