

NWC608 Functional Training



COMBINATIONS

Norwell Functional Training combines several training stations into one big frame. This station gives endless training possibilities to strengthen a wide range of muscles and train the whole body. Functional Training provides space for a social and efficient training session.

HOW TO USE:

Endless rope: Stand in front of the rope, feet a shoulder width apart. Place both hands on the rope and pull down towards the ground in one motion. Pull the rope continuously for a few minutes. This exercise can be enhanced by going down in a squat simultaneously while pulling the rope, and up while placing a higher grip on the rope, hereby using the whole body strength.

Triceps: Stand with your back towards the rope and arms over your head. Pull the rope up or down to train your triceps.

The Norwell App and the ID-bands, including training instructions and QR codes, on each fitness station inspire to exercise and give full instruction of use.

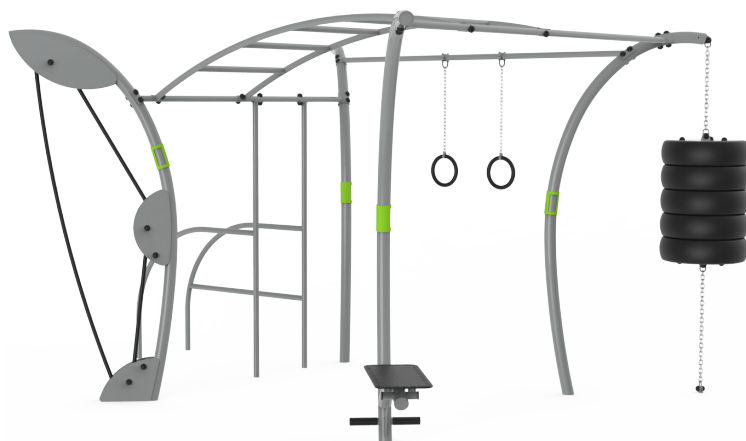
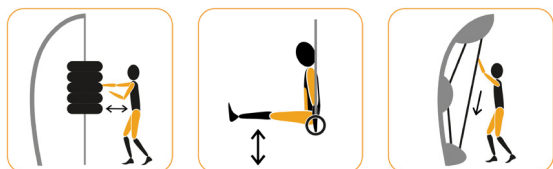

POSITION AND TRAINING ZONE:

Trainingzone = 42,6m² / 458,5 ft²

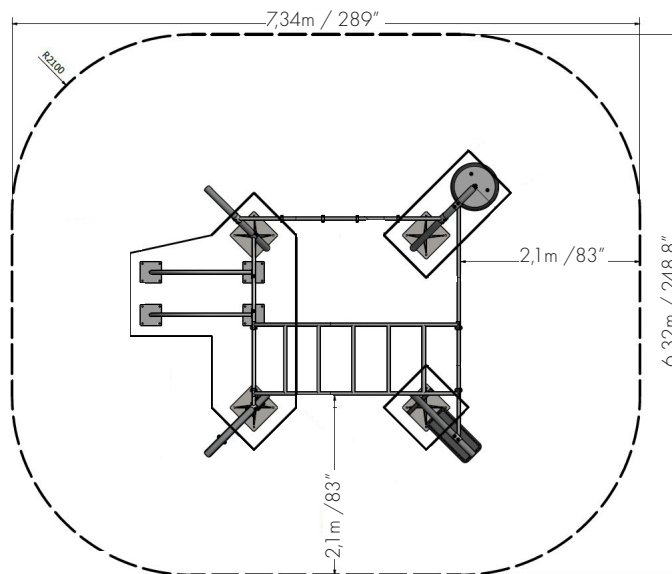

DESIGN FOR ALL

All Norwell fitness stations utilize the users own body weight as resistance, therefore the exercises can be performed without risk of injuries. As a result, Norwell fitness stations are challenging and effective regardless of fitness level.

SAFE DESIGN

The Norwell Outdoor Fitness stations are tested and approved by TÜV Product Service GmbH according to DIN79000, EN16630 and AfPS GS 2014:01 PA.

10 YEAR WARRANTY

10 years against failure due to material or manufacturing defects and corrosion breakthrough on pipes, foundations and welds. Please contact us for more information about warranty coverage, and for sites within 5 km of saltwater.

2 YEAR WARRANTY

2 years against failure due to material or manufacturing defects and corrosion breakthrough on all moving parts, plastic and rubber parts.