

Play value

Water play installations become even more attractive when they help to experience water in different ways. Children particularly enjoy damming water. On one hand, they are momentarily the „Master“ of the element water when stemming the flood water and on the other hand, they experience, through play, the water power when opening the lock of the dam.

Fundamental characteristics

- different ways of damming and collecting water
- incentive for playing: technical appearance

Suitable

- for children from 3 years
- for all water play areas in playgrounds and adventure areas



Order No. 5.20910 Damming Wedge



Order No. 5.20905 Water Flap



Order No. 5.20900 Dam of Wood

Dam of Wood Water Flap Damming Wedge

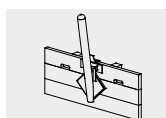

5.20900

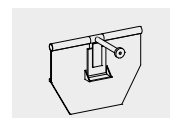

5.20905

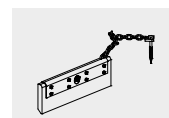

5.20910

Order No. 5.20900 Dam of Wood

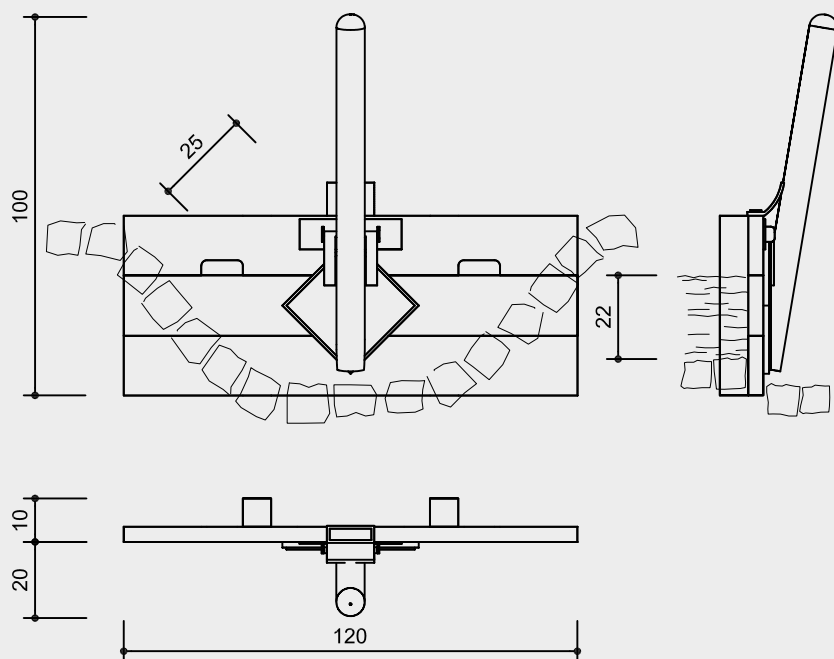

Order No. 5.20905 Water Flap

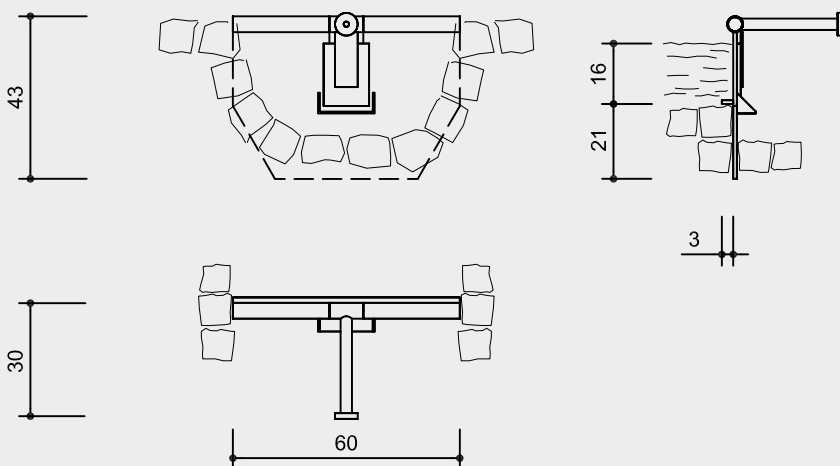

Order No. 5.20910 Damming Wedge

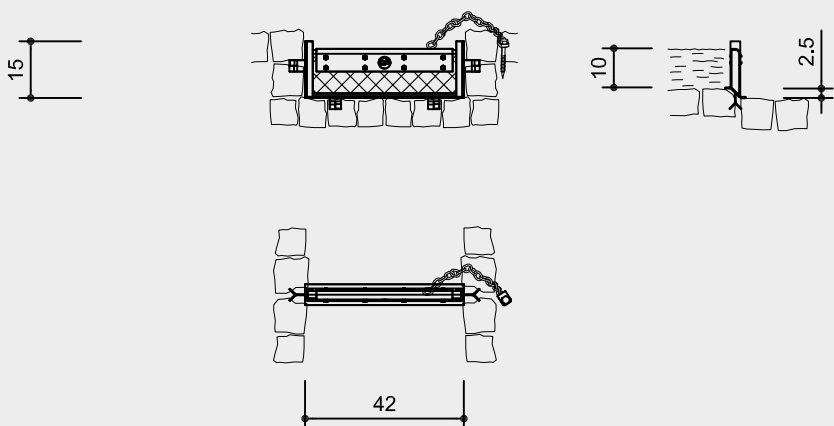

scale 1:20

Safety check according to EN 1176

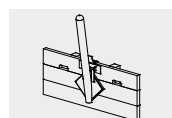

5.20900

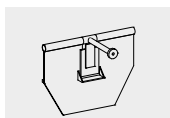

5.20905

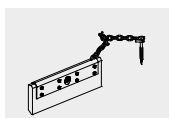

5.20910

Technical information

Order No. 5.20900 Dam of Wood

tongue and groove

plate of 45 mm tongue and groove
boarding, of non-impregnated
mountain larch



metal parts of stainless steel,
glass bead blasted

seal of 15 mm rubber plate, opening
sealed with sealing tape

Dimensions

(small deviations possible)
height 1.00 m
width 1.20 m
damming height 0.22 m
weight 27 kg

Order No. 5.20905 Water Flap

basic construction of stainless steel,
glass bead blasted

seal of 10 mm rubber plate

Dimensions

(small deviations possible)
height 0.43 m
width 0.60 m
damming height 0.16 m
weight 20 kg

Order No. 5.20910 Damming Wedge

damming wedge of industrial rubber,
holding device of stainless steel,
glass bead blasted

chain of stainless steel with swivel

Dimensions

(small deviations possible)
height of wedge 0.15 m
width 0.42 m
length of chain 0.30 m
height of threshold 0.025 m
damming height 0.10 m

Order No. 5.20915

damming height 0.20 m
weight 3 kg

Components

Dam of Wood and Water Flap

1 part

Damming Wedge

1 Damming Wedge

1 Guide Frame

Installation information

hard surface

Foundations depending on installation
situation; the Dam of Wood is bricked
in the channel and can be installed
optionally in flow direction or against
flow direction.

Attention:

**Exact measurements may vary, for
all installation dimensions refer to
current installation instructions.**
Technical changes reserved.

**For use in chlorine water the equip-
ment is also available with a special
steel alloy.**

For more detailed explanation of the
quality characteristics see price list.