

Savill Gardens—The Crown Estates

Details

Client: Kings Landscapes for Crown Estates

Location: Savill Gardens, Surrey

Length: 34.75m

Width 3m at bottom tapering in a spiral to a point

Form: Curved Bespoke Walkway

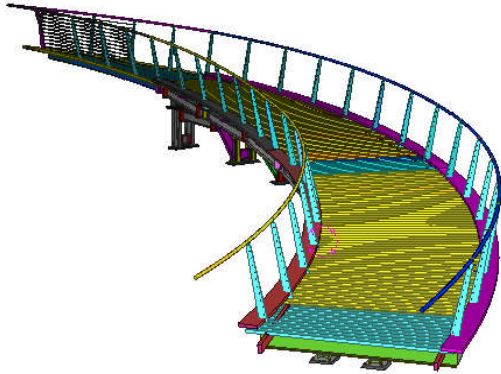

Project Description

A unique structure that forms the focal point of the Rose Garden in Savill Garden, Surrey for the Crown Estates.

The architects plan was to have a rising curved feature that elevates the public over the garden to give an aerial view of the roses and other plants.

CTS was approached to design, manufacture and install the structure because of their expertise in both steel and timber construction and their in-house design capability and quality of work.

CTS design engineers began by modelling the structure using Tekla 3D system prior to carrying out a full design with calculations. As public safety was paramount, the structure was designed to incorporate two level platform areas to encourage disabled visitors but when viewed in elevation, the structure would appear to have a continual spiral rise.

The steel frame was manufactured at CTS's factory in Huddersfield before transporting to site and being clad with prime quality FSC oak. The deck comprises CTS's unique Hi-Grip Excel non-slip inserts. The parapet has steel posts with stainless steel wires. The structure comes to a point that resembles the prow of a ship. This cantilevered feature was designed to give an open feel and incorporates steel grill on the walkway.

The new Savill Garden was officially opened by the Her Majesty the Queen on 19th June 2010 with CTS's Director John Terry in attendance.

Top Photograph: CTS's 3D Tekla Model of structure

Middle Photo: Manufacture of steelwork in CTS Factory

Bottom Photo: Completed structure on site in Savill Garden, Surrey

