

2.4m High Two Seat Swing

Bumper seats and Antiwrap Bearings Ref SWB082

Pod seats and Antiwrap Bearings Ref SWP082

Installation Instructions

Good design
for children

SutcliffePlay

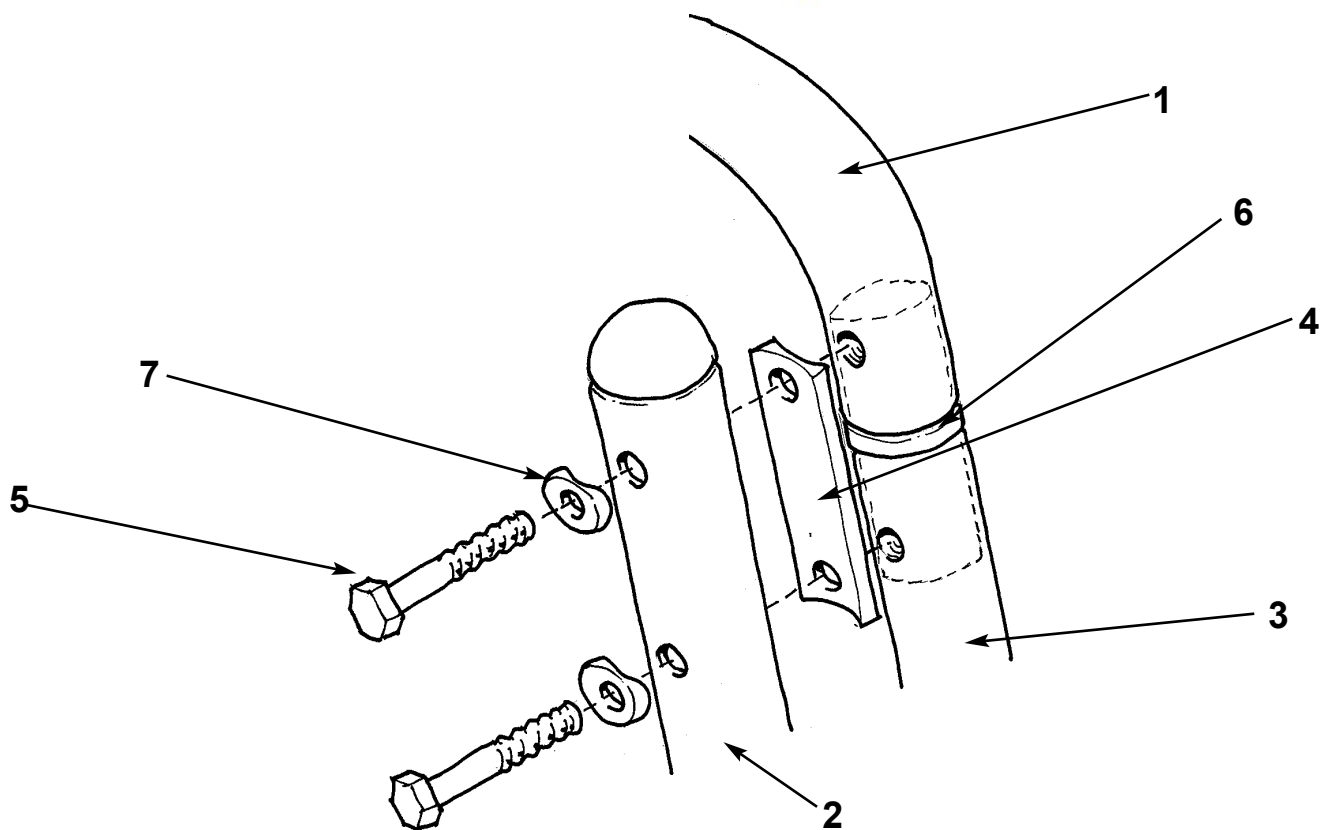

Swing Installation procedure

1. Plan the final position of the swing ensuring that there is enough space*.
2. Excavate the foundation holes in accordance with the plan**.
3. Assemble the swing frame on the ground. Ensure the fixing bolts are tightened evenly
4. Carefully lift the frame into the foundation holes ensuring it is not twisted. It is important that the top tube is horizontal, use a spirit level to check this.
5. The height from the centre of the top bar to the play level is 2.4 m.
6. When the frame is positioned correctly in the foundation holes, fit the spragging irons and fill with concrete. Ensure that the concrete foundations slope away slightly from each leg to prevent water collecting.
7. Do not allow the equipment to be used until the concrete has set (2-3 days) and the required safety surface has been installed.
8. Check that all the fixing bolts are tightened. and hang the swing seats.

Follow the maintenance instructions supplied.

* Care should be taken when installing to reduce the hazard for the user.

** Care should be taken if conditions are not normal.

Minimum ground clearance at rest position to be 350 mm from underside of flat/cradle seats.

Parts list

Item	Description	Qty.	Stock No.
1	Top tube assembly	1	SSW132
2	Rear legs	2	SSW085
3	Front legs	2	SSW086
4	Clamp Plate	2	SSW115
5	Fixing Bolt	4	HHB638
6	Joining bar	2	SSW111
7	Saddle Washer	4	WSR436

Required tools:

19mm ring spanner or socket

13mm socket

Tape measure

Spirit level

Digging implements

Step ladder

Good design
for children

SutcliffePlay

Waggon Lane
Upton Pontefract
West Yorkshire WF9 1JS
Telephone +44 (0)1977 653200
Facsimile +44 (0)1977 653222
info@ sutcliffeplay.co.uk
www. sutcliffeplay.co.uk

SWB082/SWP082

Swing

Maintenance Instructions

Good design
for children
SutcliffePlay

Recommended Regular Inspection and Maintenance

	Interval (Days)				
	7	14	28	56	365
Check stability of structure, tighten connections if required.	<input type="checkbox"/>	<input type="checkbox"/>	<input type="checkbox"/>	<input checked="" type="checkbox"/>	<input type="checkbox"/>
Check all uprights at ground level for corrosion and/or rot. Replace any defective parts.	<input type="checkbox"/>	<input type="checkbox"/>	<input type="checkbox"/>	<input checked="" type="checkbox"/>	<input type="checkbox"/>
Check all painted elements for damage, rub down and repaint or replace as required.	<input type="checkbox"/>	<input type="checkbox"/>	<input type="checkbox"/>	<input checked="" type="checkbox"/>	<input type="checkbox"/>
Check chain/ropework assemblies for wear and damage, replace if required.	<input type="checkbox"/>	<input checked="" type="checkbox"/>	<input type="checkbox"/>	<input type="checkbox"/>	<input type="checkbox"/>
Check rotating and pivot points for wear and smooth running lubricate or replace if required.	<input type="checkbox"/>	<input checked="" type="checkbox"/>	<input type="checkbox"/>	<input type="checkbox"/>	<input type="checkbox"/>
Check rubber parts for wear and/or damage, replace if required.	<input type="checkbox"/>	<input checked="" type="checkbox"/>	<input type="checkbox"/>	<input type="checkbox"/>	<input type="checkbox"/>
Check tension cables, adjust if required.	<input type="checkbox"/>	<input type="checkbox"/>	<input type="checkbox"/>	<input type="checkbox"/>	<input type="checkbox"/>
Check wear of cables, replace if required.	<input type="checkbox"/>	<input type="checkbox"/>	<input type="checkbox"/>	<input type="checkbox"/>	<input type="checkbox"/>
Check slide chutes for smoothness and any foreign elements, remove any found.	<input type="checkbox"/>	<input type="checkbox"/>	<input type="checkbox"/>	<input type="checkbox"/>	<input type="checkbox"/>
Check rubber safety surfaces for damage and poor performance, repair or replace if required.	<input type="checkbox"/>	<input type="checkbox"/>	<input type="checkbox"/>	<input checked="" type="checkbox"/>	<input type="checkbox"/>
Check loose fill safety surfaces, remove any foreign elements, rake level and top up if required.	<input type="checkbox"/>	<input type="checkbox"/>	<input checked="" type="checkbox"/>	<input type="checkbox"/>	<input type="checkbox"/>

Disposal Instructions

All components should be broken down into categories of:-

- 1 **Mild Steel** - all Swing Frames, Playzone, Toddlerzone, Teenzone activities, Deck Frames and Springie Frames.
- 2 **Stainless Steel** - all Slides, Mirror Panels.
- 3 **Aluminium** - all Playzone and Toddlerzone Posts.
- 4 **Galvanised Steel** - all Chains and Teenzone Posts.
- 5 **Moulded Rubber Products without steel inserts** - all Toddlerzone Caps and edge details.
- 6 **Timber** - all natural timber, plywood, and MDF panels.

Wherever possible these materials should be taken to specialist recycling organisations and recycled.

In some cases where composite materials are used, then disposal at land fill sites is the only alternative such as:

- 7 **Moulded Rubber Products encasing steel inserts** - all Swing Seats, Deck Tops, Duo/Dizzy Disc Tops.
- 8 **High Pressure Laminate** - all Toddlerzone, Playzone and Teenzone Panels.
- 9 **Steel Core Polypropylene Rope** - all Scramble Nets, Space Nets, Playzone/Toddlerzone Ropes.