

FOCAL



Schröder Group GIE



CHARACTERISTICS – FLOODLIGHT

Tightness level:	IP 66 (*)
Impact resistance (glass):	IK 08 (**)
Electrical insulation class:	I or II (*)
Weight (empty):	4 kg

(*) according to standard IEC – EN 60598

(**) according to standard IEC – EN 62262

DESCRIPTION

Waterproof floodlight (IP 66) for lamps up to 150 W offering a wide choice of light distributions (peak intensities from 300 to 32,000 cd/klm).

It consists of a painted die cast aluminium alloy enclosure and cover.

The enclosure contains the removable control gear plate and lampholder support.

The optical compartment consists of partially screen-printed tempered glass, sealed onto the enclosure and a reflector made of deep drawn, polished and anodised aluminium (3 reflectors available). A painted die cast aluminium bracket facilitates the mounting of the floodlight and the adjustment of its position.

Coating: polyester powder

Colour: AKZO grey 900 sand-blasted

DIMENSIONS – MOUNTINGS

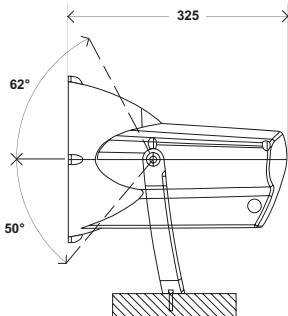
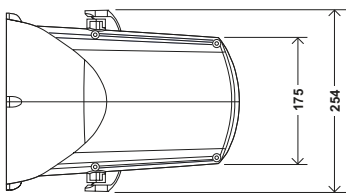

Mounting by means of 1 to 3 M10 bolts.

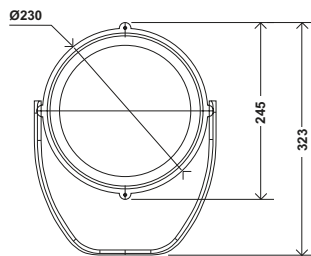

ADVANTAGES

- Compact floodlight
- Wide choice of reflectors, lamps and accessories
- Adjustable beam while switched on
- IP 66 tightness level

OPTIONS

- Anti-vandal screws
- Long bracket enabling orientation through 360°
- Other RAL or AKZO colours on request

IP 66 TIGHTNESS

Optical compartment closed with a highly resistant tempered glass, sealed onto the body of the floodlight. The absence of a rim prevents the accumulation of water.

PHOTOMETRIC ADJUSTMENT WHILE SWITCHED ON

An adjustment screw allows continuous fine adjustment of the focusing of the lamp when switched on. The selected position is locked.

OVERLAYABLE AND ADJUSTABLE ACCESSORIES

Any combination of accessories is possible. Each accessory, inserted in a standard frame by means of clips, can be adjusted through 360° by simple manual rotation. The frames can be overlaid and are held in place on the body of the floodlight by 2 screws.

MAINTENANCE BY ACCESS AT THE BACK

Access to the lamp and the control gear plate via a die cast aluminium alloy cover. Access at the back avoids removing the photometric accessories during maintenance operations.

After loosening two mounting screws and disconnecting the electrical connection, the lamp support can be extracted easily. After loosening one mounting screw, the control gear plate can be removed. Two studs ensure its correct positioning.

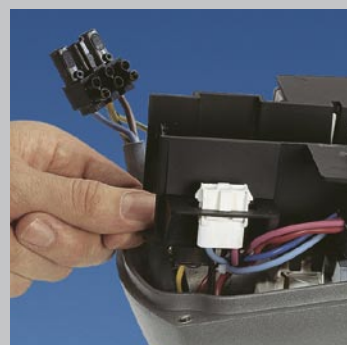

FOCAL

Cover giving access to the lamp and the control gear. Access at the back avoids removing the photometric accessories during maintenance operations.

Lamp support allowing continuous fine adjustment of the focusing of the lamp, when switched on. The selected position is locked.

Optical compartment (IP 66) closed with a highly resistant tempered glass, sealed onto the floodlight enclosure.

Standard frame in which any type of accessory can be inserted (louvers, refracting glass, etc.). Once they are inserted in the frames, the accessories can be overlaid and adjusted through 360°.

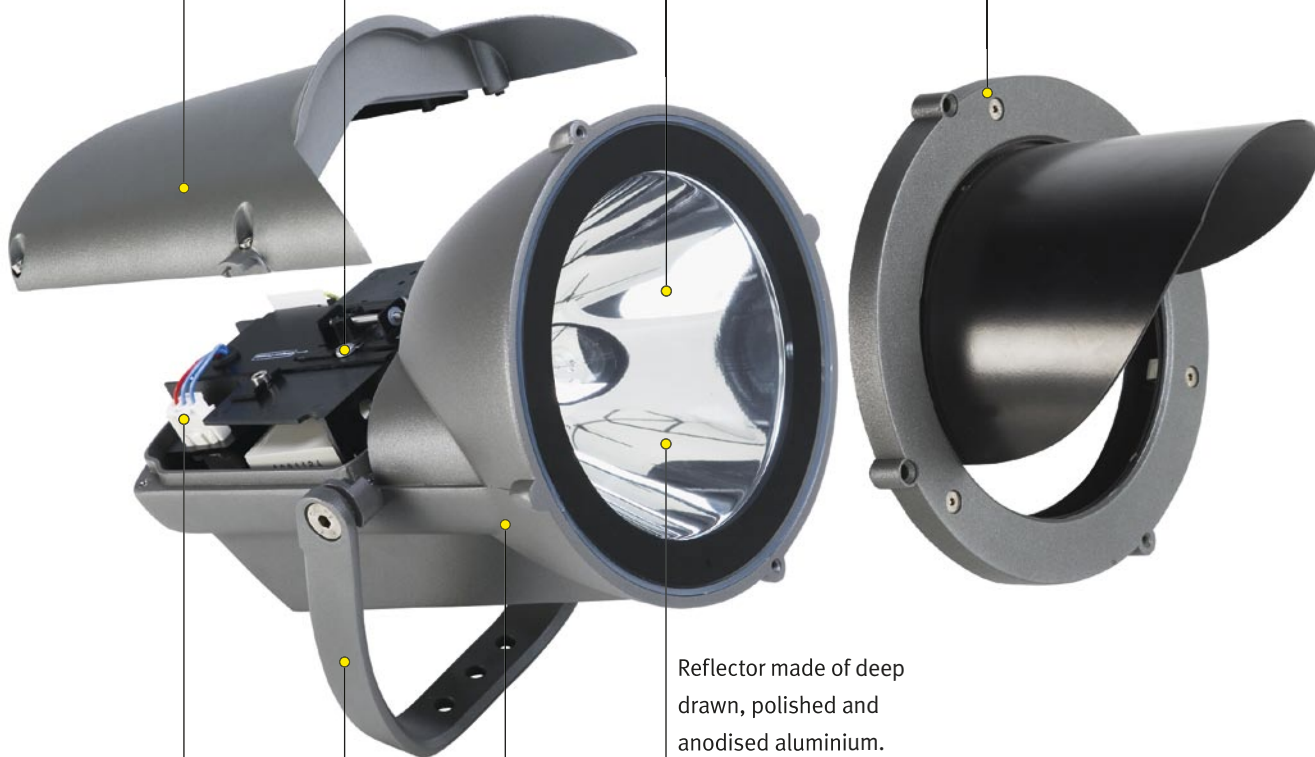

Removable control gear plate.

Floodlight enclosure in painted die-cast aluminium alloy.

Reflector made of deep drawn, polished and anodised aluminium. Three different reflectors are available.

Bracket made of painted die cast aluminium alloy allows the floodlight to be adjusted.

PHOTOMETRY

INTENSIVE PHOTOMETRY: 32.000 CD/KLM

For intensive photometric applications – narrow beam angle – the Focal floodlight is perfectly suited for illuminating an architectural feature mounted on a plinth, a façade, a monument, etc.

I max: 32.000 cd/klm
I max/2: 2x2,5° – 2x2,5°

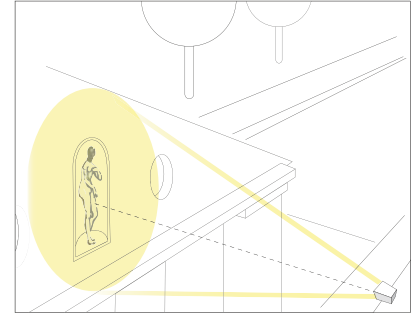
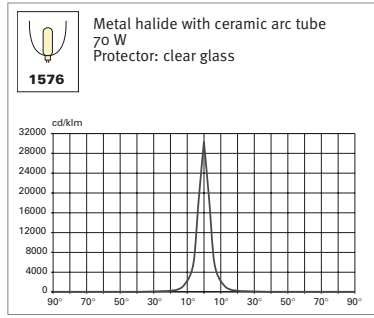

SEMI-INTENSIVE PHOTOMETRY: VARIABLE FROM 10,500 TO 3,500 CD/KLM, DETERMINED BY THE FOCUS SETTING

Four refracting glasses are available. These glasses make it possible to obtain wider beams with an oblong or square section. In addition, the frame supporting the refracting glass can be adjusted through 360°, which makes it possible to adjust the geometric shape of the beam.

Maximum value:
— I max: 10.500 cd/klm
I max/2: 2x4,5° – 2x4,5°
Minimum value:
— I max: 3.500 cd/klm
I max/2: 2x7,5° – 2x7,5°

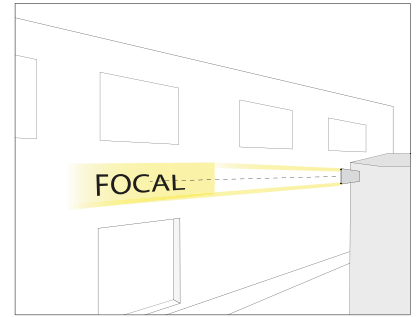
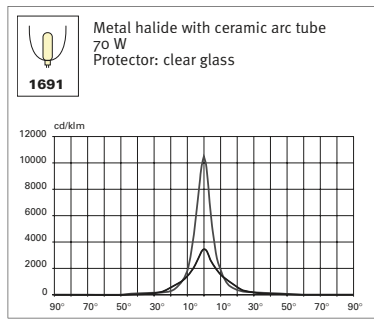

EXTENSIVE PHOTOMETRY: VARIABLE FROM 3,300 TO 420 CD/KLM, DETERMINED BY THE FOCUS SETTING

For extensive photometric applications – wide beam angle – the Focal floodlight can be used for illuminating façades.

Maximum value:
— I max: 3.300 cd/klm
I max/2: 2x9° – 2x9°
Minimum value:
— I max: 420 cd/klm
I max/2: 2x40° – 2x40°

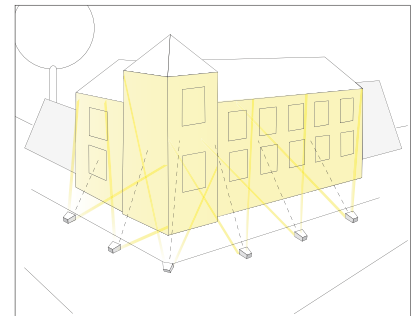
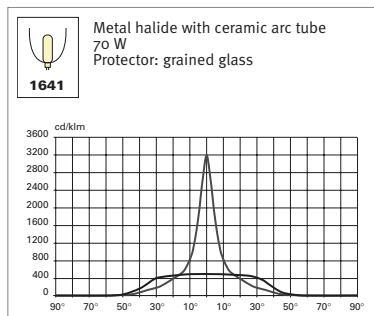



FOCAL LAMPS – REFLECTORS

Reflector	Metal halide with ceramic arc tube		White sodium		High-pressure sodium
	70 W	150 W	50 W	100 W	70W
1576	✓	✓	✓	✓	✓
1691	✓	✓	✓	✓	✓
1641	✓	✓	✓	✓	✓

G12/PG12 | E27

LIGHT DISTRIBUTION

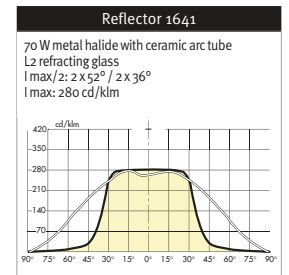
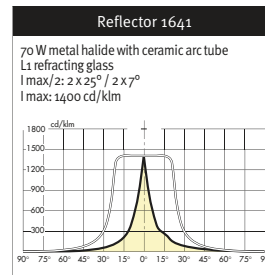
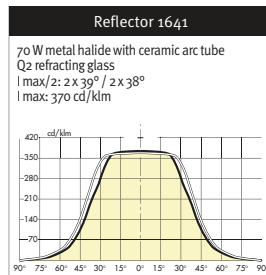
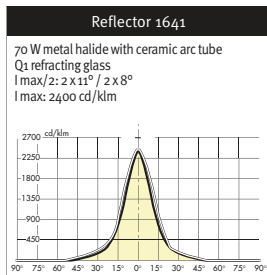
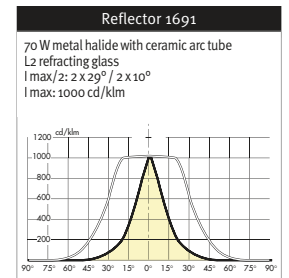
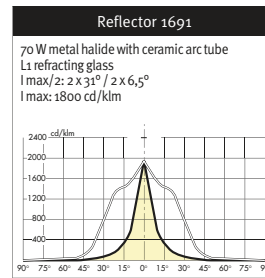
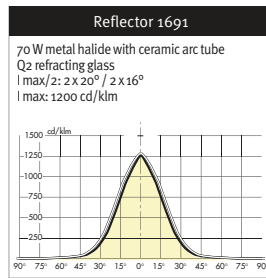
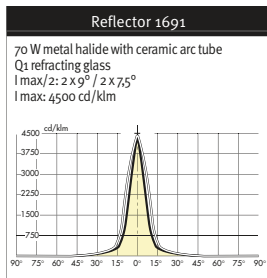
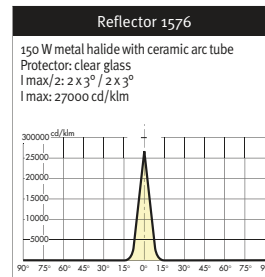
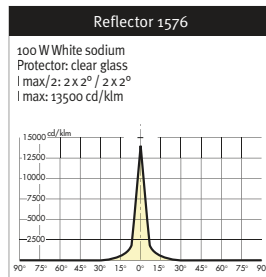
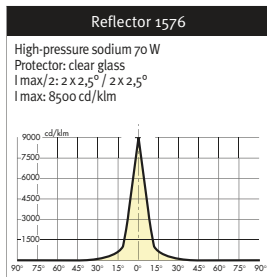

REFRACTING GLASSES



Q1 type refracting glass



Q2 type refracting glass



L1 type refracting glass



L2 type refracting glass

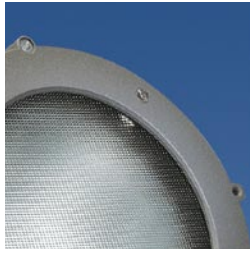

ACCESSORIES

Each accessory is inserted into a standard frame and held in place by means of clips. Two screws fix the frame to the floodlight enclosure.



Protection grid



Visor



Light channel



Louvers

COLOURED GLASSES

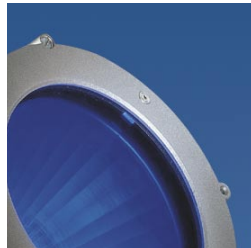

Five standard colours available: red, orange, blue, yellow, green.

360° ADJUSTMENT OF ACCESSORIES

The frames are held in a frame by means of clips and can be adjusted through 360° by simple manual rotation.





PERFORMANCE AND FLEXIBILITY OF ILLUMINATION

FOCAL
Antwerp
Belgium









THE RIGHT LIGHTING